

# DIXIE DISTRIBUTION CENTER II

GREATER CINCINNATI  
NORTHERN KENTUCKY

8171 DIXIE HIGHWAY  
FLORENCE, KY 41042



FOR LEASE

59,000 SF

MODERN DISTRIBUTION



LEASED BY



# DIXIE DISTRIBUTION CENTER II

GREATER CINCINNATI  
NORTHERN KENTUCKY

8171 DIXIE HIGHWAY  
NORTHERN KENTUCKY

## BUILDING SPECIFICATIONS

County	Boone County
Available Space	59,000 SF
Office Size	1,329 SF
Clear Height	24'
Dock Doors	10 Docks
Drive-in Doors	1 Drive-in Door
Zoning	I-2, Heavy Industrial
Est. OPEX	\$1.66/SF

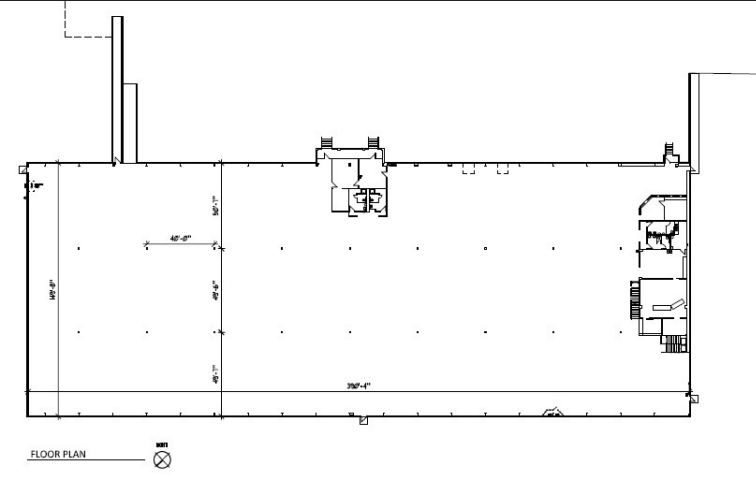

FOR LEASE

59,000 SF

8171 Dixie Highway sits in a well-established industrial corridor on Northern Kentucky's major commercial spine, US-25/US-42/US-127. It offers direct frontage on Dixie Highway with high daily traffic counts. It is within mere minutes of major interstates I-71/I-75 and close to CVG Airport, which enhances distribution potential for industrial users.

**Seattle Stein**  
Seattle.stein@cushwake.com  
(513) 763 3027

**Jeff Bender, SIOR, CCIM**  
Jeff.bender@cushwake.com  
(859) 653 1346

**Dave Kelly, CCIM**  
Dave.kelly@cushwake.com  
(513) 290 4651



This is not an offer or acceptance of an offer to lease space. A lease will only be offered or made in a written agreement signed by landlord. No representation or warranty of any kind is made by landlord unless set forth in a written definitive lease executed by the landlord.