



470

ST. JOHN'S CHURCH RD
CAMP HILL, PENNSYLVANIA

FOR SALE / LEASE

±176,762 SF

AVAILABLE

Gerry Blinebury
Executive Vice Chair
+1 717 231 7291
gerry.blinebury@cushwake.com

Allie Gaeta
Senior Director
+1 717 231 7461
allie.gaeta@cushwake.com

 **Hager Pacific**
Properties

 **CUSHMAN &
WAKEFIELD**

Cushman & Wakefield Copyright 2025. No warranty or representation, express or implied, is made to the accuracy or completeness of the information contained herein, and same is submitted subject to errors, omissions, change of price, rental or other conditions, withdrawal without notice, and to any special listing conditions imposed by the property owner(s). As applicable, we make no representation as to the condition of the property (or properties) in question.

LOCATION



1.5 MILES to RT 581
1.2 MILES to RT 15
3.5 MILES to I-83
3.7 MILES to I-76
4.9 MILES to I-81



BUILDING SPECS

±176,762 SQUARE FEET **15'-17'** CLEAR HEIGHT **±15** DOCK DOORS

BUILDING AREA ±176,762 SF

BUILDING DIMENSIONS 404'x477'

AVAILABLE AREA ±176,762 SF

COLUMN SPACING 30'x30'

CLEAR HEIGHT 15'-17'

DOCK DOORS 15

TRAILER PARKING 25

HVAC GAS FIRED CEILING MOUNTED HEAT A/C IN OFFICE

LIGHTING METAL HALIDE

FIRE PROTECTION 100% WET SYSTEM

Saint Johns Church Rd.

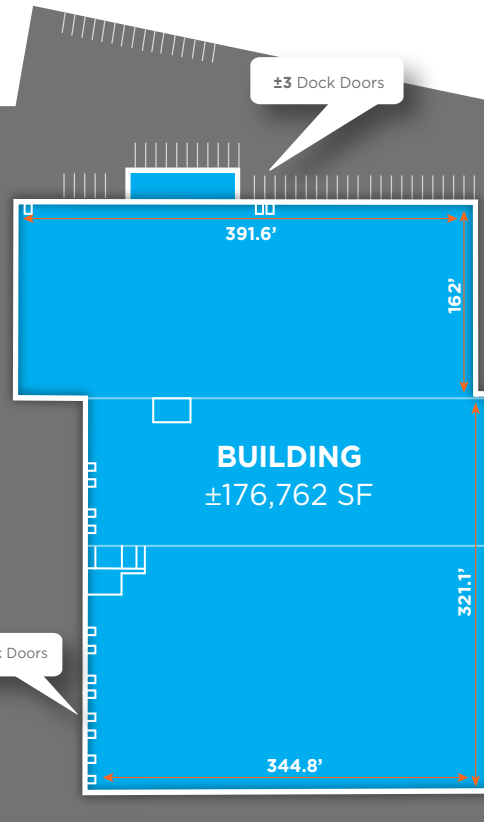

Gerry Blinebury
Executive Vice Chair
+1 717 231 7291
gerry.blinebury@cushwake.com

Allie Gaeta
Senior Director
+1 717 231 7461
allie.gaeta@cushwake.com

Hager Pacific
Properties

CUSHMAN & WAKEFIELD

Cushman & Wakefield Copyright 2025. No warranty or representation, express or implied, is made to the accuracy or completeness of the information contained herein, and same is submitted subject to errors, omissions, change of price, rental or other conditions, withdrawal without notice, and to any special listing conditions imposed by the property owner(s). As applicable, we make no representation as to the condition of the property (or properties) in question.