



**FOR LEASE**

# ENTERPRISE INDUSTRIAL PARK

325 HABERSHAM RD, HIGH POINT, NC 27260





# ENTERPRISE INDUSTRIAL PARK

325 HABERSHAM RD., HIGH POINT, NC 27260

SPACE AVAILABLE

SUITE 105  
± 10,748 SF

SUITE 105	
Size:	± 10,748 SF
Drive-In Doors:	One (1) front-load - 12' x 14'
Dock-High Doors:	Two (2) dock-high - 8' x 9'
Clear Height:	24'
Column Spacing:	25' x 48'
Electrical:	200 Amps
Lighting:	LED in the warehouse
Additional SF:	± 885 SF of office / restrooms

● Dock-High Door  
■ Drive-In Door

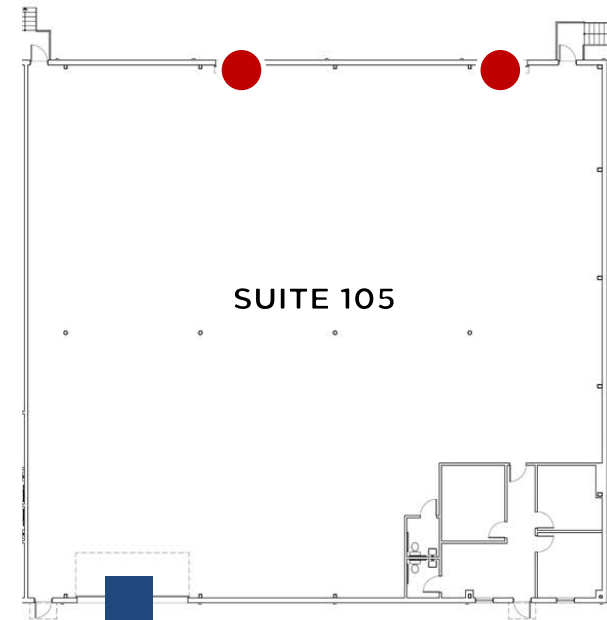



# ENTERPRISE INDUSTRIAL PARK

325 HABERSHAM RD., HIGH POINT, NC 27260

AVAILABILITY





# ENTERPRISE INDUSTRIAL PARK

325 HABERSHAM RD., HIGH POINT, NC 27260

LOCATION AERIAL

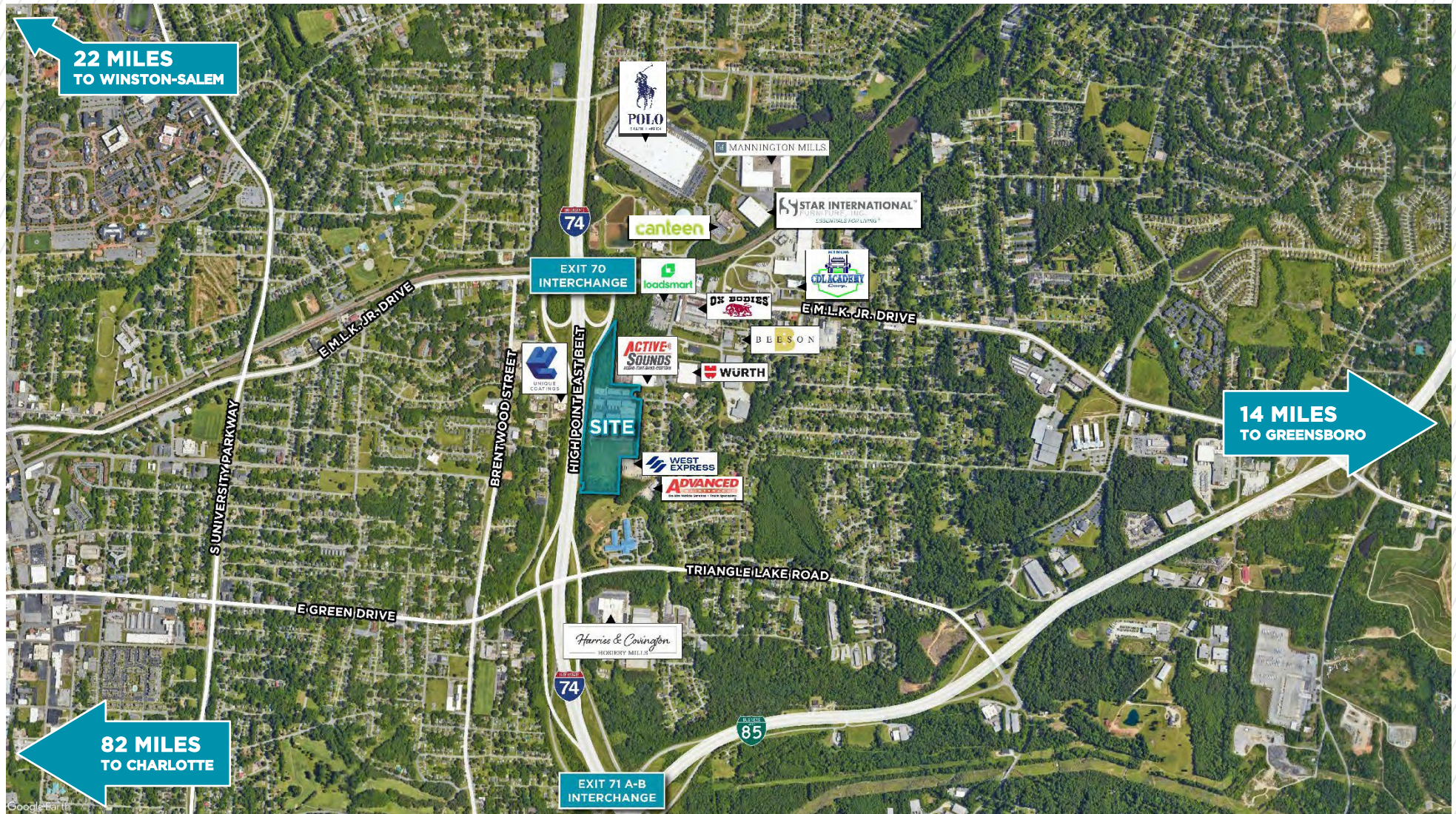



# ENTERPRISE INDUSTRIAL PARK

325 HABERSHAM RD., HIGH POINT, NC 27260

LOCATOR MAP

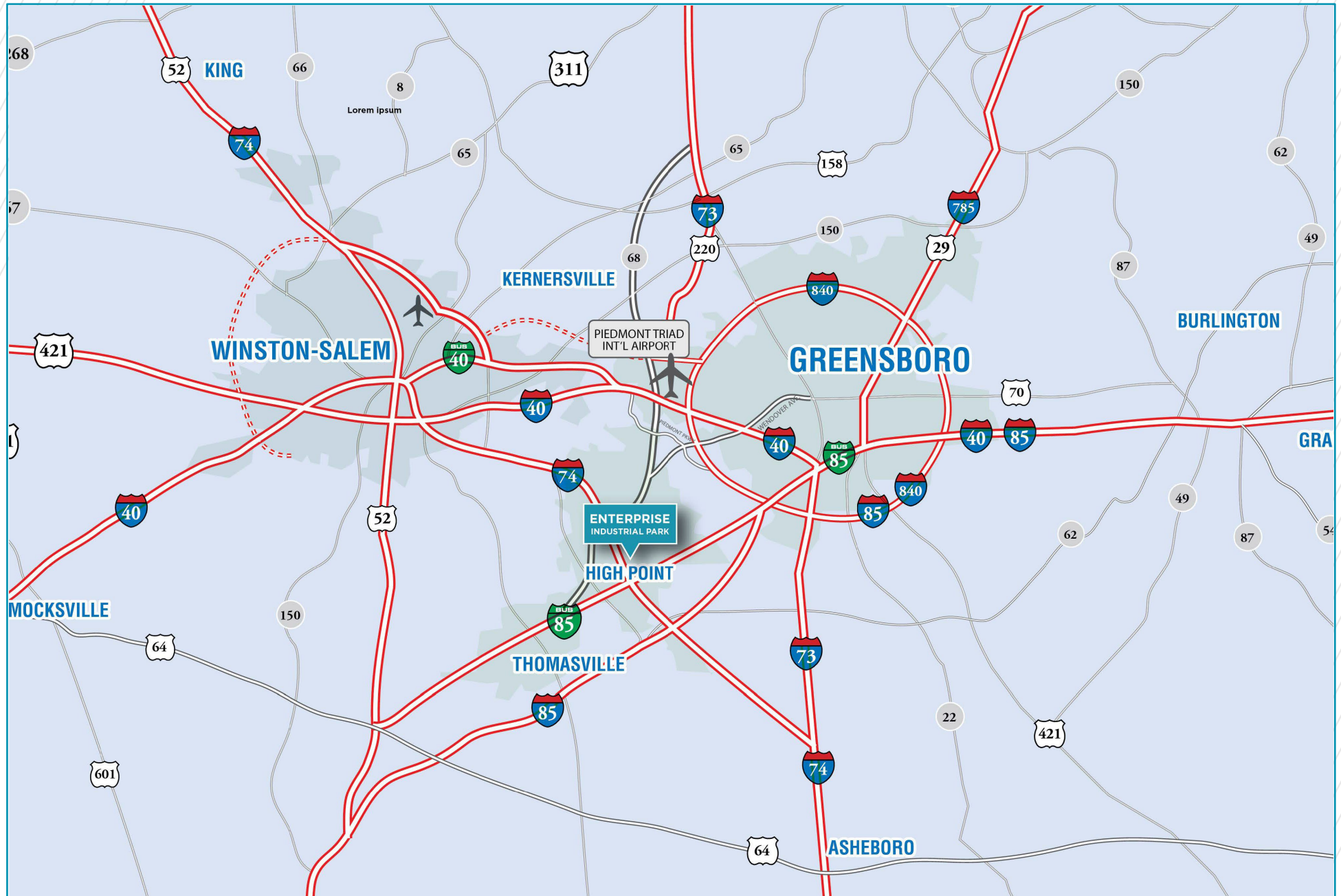

# ENTERPRISE INDUSTRIAL PARK

325 HABERSHAM ROAD, HIGH POINT, NC 27260

## FOR MORE INFORMATION, CONTACT:

**JORDAN MITCHELL**

Senior Director  
+1 336 201 0495  
[jordan.mitchell@cushwake.com](mailto:jordan.mitchell@cushwake.com)

**RYAN CONBOY, SIOR**

Managing Director  
+1 336 821 3832  
[ryan.conboy@cushwake.com](mailto:ryan.conboy@cushwake.com)

628 Green Valley Road, Suite 202  
Greensboro, NC 27408  
+1 336 668 9999  
[cushmanwakefield.com](http://cushmanwakefield.com)

©2025 Cushman & Wakefield. All rights reserved. The information contained in this communication is strictly confidential. This information has been obtained from sources believed to be reliable but has not been verified. NO WARRANTY OR REPRESENTATION, EXPRESS OR IMPLIED, IS MADE AS TO THE CONDITION OF THE PROPERTY (OR PROPERTIES) REFERENCED HEREIN OR AS TO THE ACCURACY OR COMPLETENESS OF THE INFORMATION CONTAINED HEREIN, AND SAME IS SUBMITTED SUBJECT TO ERRORS, OMISSIONS, CHANGE OF PRICE, RENTAL OR OTHER CONDITIONS, WITHDRAWAL WITHOUT NOTICE, AND TO ANY SPECIAL LISTING CONDITIONS IMPOSED BY THE PROPERTY OWNER(S). ANY PROJECTIONS, OPINIONS OR ESTIMATES ARE SUBJECT TO UNCERTAINTY AND DO NOT SIGNIFY CURRENT OR FUTURE PROPERTY PERFORMANCE.

