

360 INDUSTRIAL ROAD

SAN CARLOS, CA 94070

360industrialroad.com

22,805 SF
R&D/OFFICE SPACE
RARE DOCK HIGH AND GRADE LEVEL

Ben Paul
Vice Chairman
+1 650 401 2123
ben.paul@cushwake.com
LIC #01210872

Dave Dove
Director
+1 650 320 0212
david.dove@cushwake.com
LIC #01035766

Anthony Kamm
Principal
+1 650 556 8660
ak@seq-rs.com
LIC #01783456

1350 Bayshore Hwy., Suite 900
Burlingame, CA
main +1 650 347 3700
fax +1 650 347 4307
cushmanwakefield.com



©2025 Cushman & Wakefield. All rights reserved. The information contained in this communication is strictly confidential. This information has been obtained from sources believed to be reliable but has not been verified. NO WARRANTY OR REPRESENTATION, EXPRESS OR IMPLIED, IS MADE AS TO THE CONDITION OF THE PROPERTY (OR PROPERTIES) REFERENCED HEREIN OR AS TO THE ACCURACY OR COMPLETENESS OF THE INFORMATION CONTAINED HEREIN, AND SAME IS SUBMITTED SUBJECT TO ERRORS, OMISSIONS, CHANGE OF PRICE, RENTAL OR OTHER CONDITIONS, WITHDRAWAL WITHOUT NOTICE, AND TO ANY SPECIAL LISTING CONDITIONS IMPOSED BY THE PROPERTY OWNER(S). ANY PROJECTIONS, OPINIONS OR ESTIMATES ARE SUBJECT TO UNCERTAINTY AND DO NOT SIGNIFY CURRENT OR FUTURE PROPERTY PERFORMANCE.

360 INDUSTRIAL ROAD

SAN CARLOS, CA 94070

PROPERTY HIGHLIGHTS

- $\pm 22,805$ RSF
- Very Heavy Power - 2,900 amps @ 208/120V
- Class A Furnished Office Space
- 2 Electronics Labs
- $\pm 4,500$ SF of Shipping Receiving Warehouse (Dock and Grade Loading)
- ± 125 Parking Stalls ($\pm 4/1,000$ Ratio)
- ± 20 EV Charging Stations
- Easy Access to Highway 101
- Across the Street From Sutter Health
- Click Here for [Zoning](#)

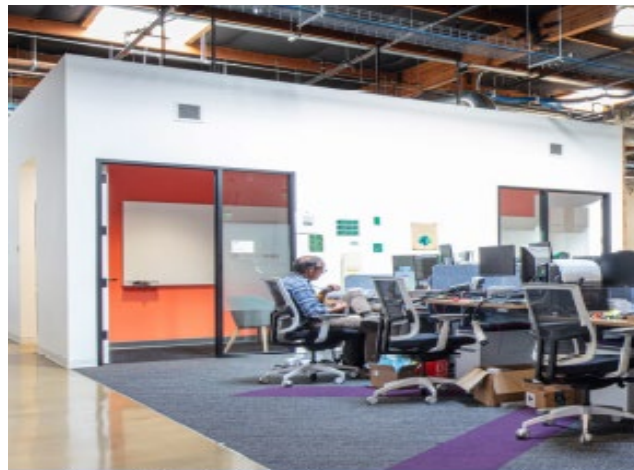
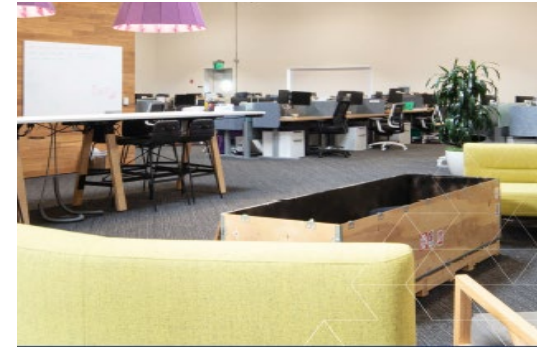

360 INDUSTRIAL ROAD

SAN CARLOS, CA 94070

SITE PLAN

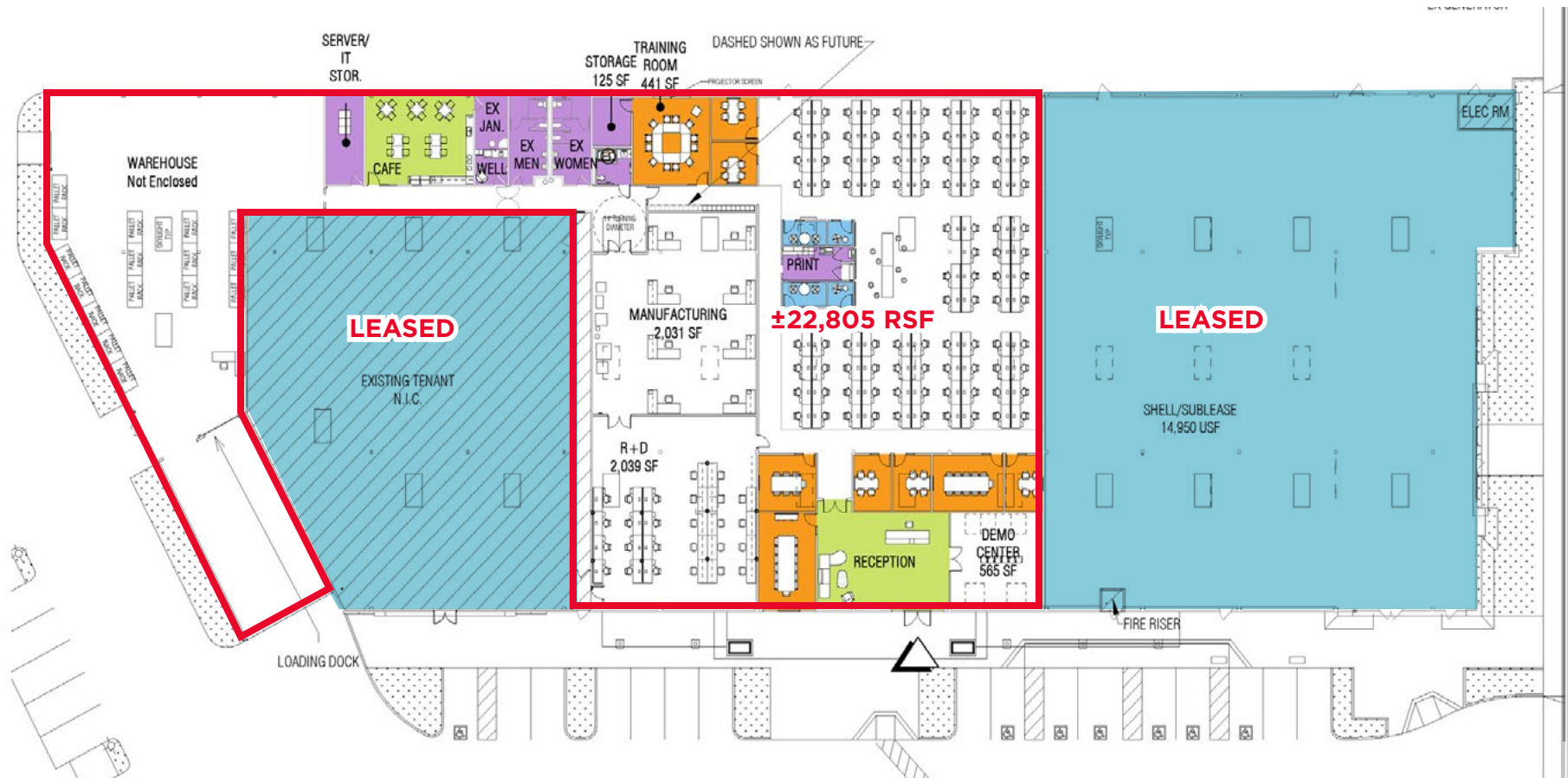

360 INDUSTRIAL ROAD

SAN CARLOS, CA 94070

FLOOR PLAN

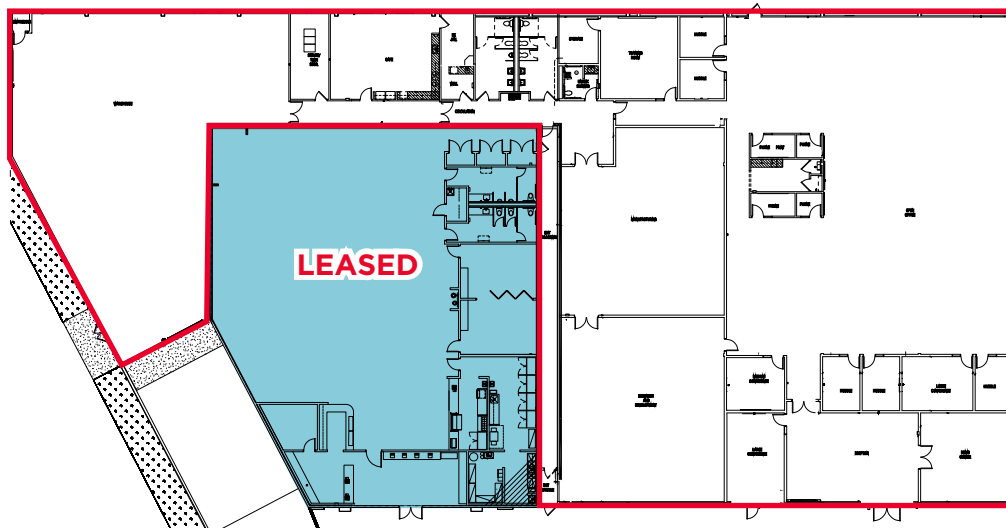

- $\pm 22,805$ SF
- Class A Furnished Office Space Available
- Built out Huddle and Conference Rooms
- Large Open Office
- Break Area
- Training Room
- $\pm 4,500$ SF of Shipping Receiving Warehouse (Dock and Grade Loading)



360 INDUSTRIAL ROAD

SAN CARLOS, CA 94070

AERIAL

360 INDUSTRIAL ROAD

- Half mile/10 min walk to San Carlos Caltrain Station
- Half mile to Holly Street exit





Ben Paul

Vice Chairman
+1 650 401 2123
ben.paul@cushwake.com
LIC #01210872

Dave Dove

Director
+1 650 320 0212
david.dove@cushwake.com
LIC #01035766

Anthony Kamm

Principal
+1 650 556 8660
ak@seq-rs.com
LIC #01783456

1350 Bayshore Hwy., Suite 900
Burlingame, CA
main +1 650 347 3700
fax +1 650 347 4307
cushmanwakefield.com



©2025 Cushman & Wakefield. All rights reserved. The information contained in this communication is strictly confidential. This information has been obtained from sources believed to be reliable but has not been verified. NO WARRANTY OR REPRESENTATION, EXPRESS OR IMPLIED, IS MADE AS TO THE CONDITION OF THE PROPERTY (OR PROPERTIES) REFERENCED HEREIN OR AS TO THE ACCURACY OR COMPLETENESS OF THE INFORMATION CONTAINED HEREIN, AND SAME IS SUBMITTED SUBJECT TO ERRORS, OMISSIONS, CHANGE OF PRICE, RENTAL OR OTHER CONDITIONS, WITHDRAWAL WITHOUT NOTICE, AND TO ANY SPECIAL LISTING CONDITIONS IMPOSED BY THE PROPERTY OWNER(S). ANY PROJECTIONS, OPINIONS OR ESTIMATES ARE SUBJECT TO UNCERTAINTY AND DO NOT SIGNIFY CURRENT OR FUTURE PROPERTY PERFORMANCE.