



GATEWAY

LOGISTICS CENTER



Gandy Blvd. &
Interstate 275



GREYSTAR®



VIEW WEBSITE

Site Plan



All buildings have a 15 ft finished floor elevation, and all truck courts have a 11 ft elevation.

Gateway Logistics Center is strategically located at the corner of I-275 and Gandy Blvd., one of the best sites in the heart of the Gateway submarket. The location provides **immediate access to the Howard Frankland and Gandy Bridges**. In addition to an excellent labor force, the location also benefits from proximity to:



3 separate I-275 interchanges within 3 miles



1 mile to U.S. Highway 19 N.



10 minutes to St. Pete/Clearwater Airport and only 20 minutes to TIA



6 miles to Downtown St. Petersburg

Building Specs



Building H	
Square Footage	20,000 - 146,539
Clear Height	32'
Building Dimensions	810'x180'
Loading	Rear-load
Truck Court Depth	130'
Car Parking	374
Parking Ratio	2.55
Dock Doors	51
Drive-in Doors	2
Construction	Tilt-wall
Roof System/Age	New, R19
Sprinkler System	ESFR
Column Spacing	54' x 54'
Slab Thickness	6"
Delivery	Available Now

Building C	
Square Footage	25,000 - 119,481
Clear Height	32'
Building Dimensions	594' x 200'
Loading	Rear-load
Truck Court Depth	120'
Car Parking	173
Parking Ratio	1.45
Dock Doors	37
Drive-in Doors	2
Construction	Tilt-wall
Roof System/Age	New, R19
Sprinkler System	ESFR
Column Spacing	54' x 54'
Slab Thickness	6"
Delivery	Q1 2026

Building B	
Square Footage	25,000 - 92,841
Clear Height	32'
Building Dimensions	512' x 180'
Loading	Rear-load
Truck Court Depth	120'
Car Parking	133
Parking Ratio	1.43
Dock Doors	31
Drive-in Doors	2
Construction	Tilt-wall
Roof System/Age	New, R19
Sprinkler System	ESFR
Column Spacing	54' x 54'
Slab Thickness	6"
Delivery	Q1 2026

Building D	
Square Footage	25,000 - 119,481
Clear Height	32'
Building Dimensions	594' x 200'
Loading	Rear-load
Truck Court Depth	120'
Car Parking	169
Parking Ratio	1.41
Dock Doors	37
Drive-in Doors	2
Construction	Tilt-wall
Roof System/Age	New, R19
Sprinkler System	ESFR
Column Spacing	54' x 54'
Slab Thickness	6"
Delivery	Q2 2026

Office Floor Plan

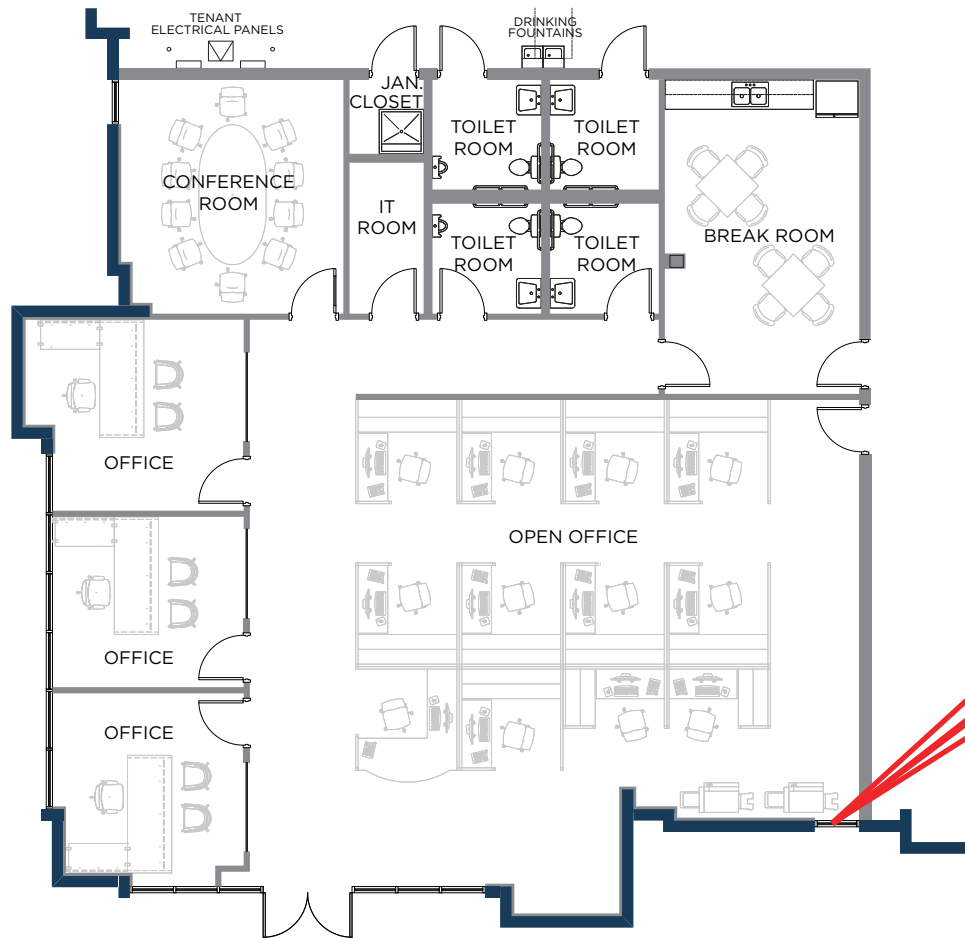

Spec Office 2,918 SF

Location Overview

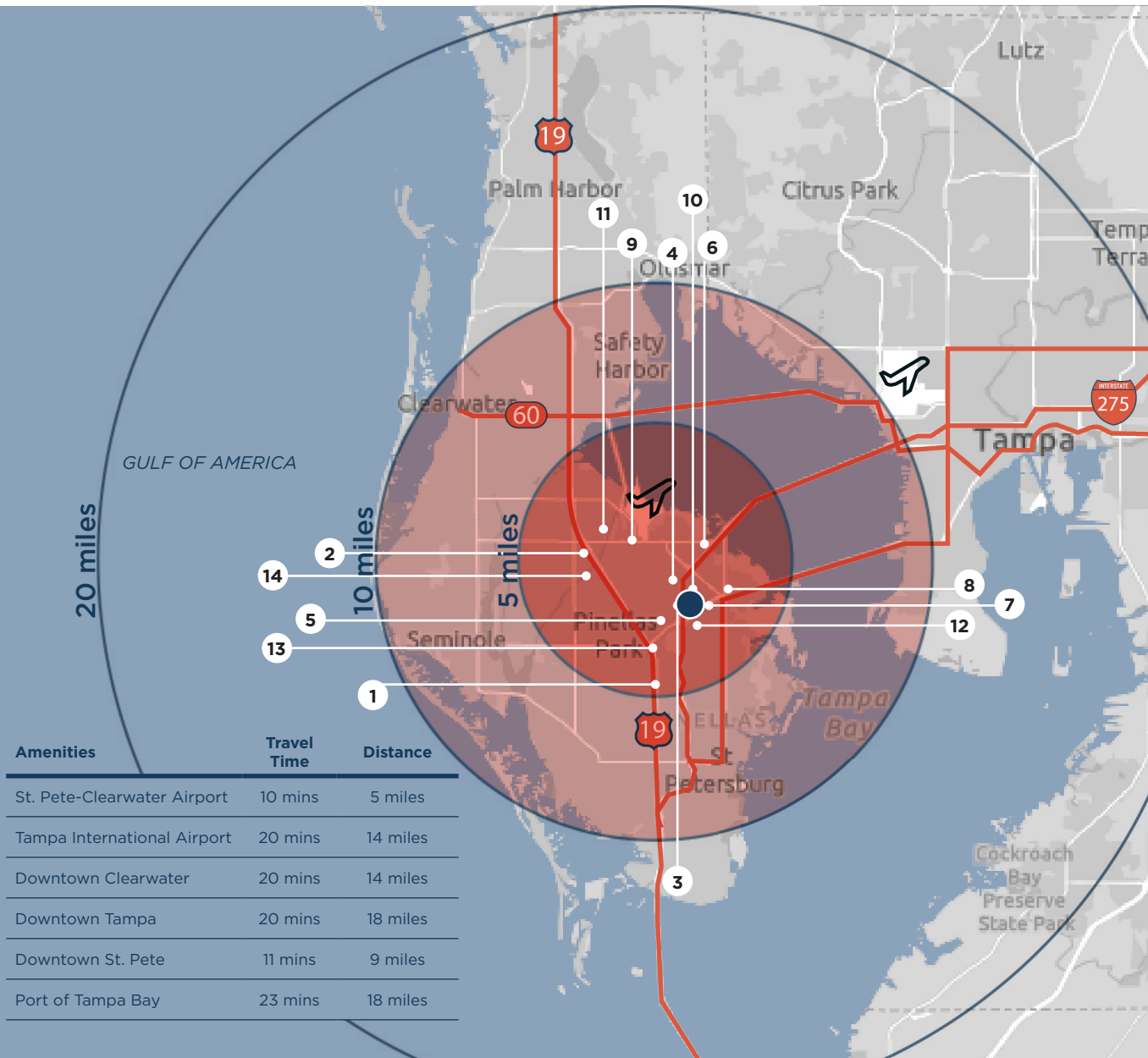

Corporate Neighbors

- | | |
|--------------------------|--------------|
| 1 Tesla | 8 Jabil |
| 2 Home Depot | 9 UPS |
| 3 Great Bay Distributors | 10 Omnicell |
| 4 Valpak | 11 Daiken |
| 5 Power Design | 12 FedEx |
| 6 Raymond James | 13 Amazon |
| 7 Lockheed Martin | 14 Honeywell |



Total Population

5 miles	243,359
10 miles	683,635
20 miles	1,655,382



Workforce

5 miles	206,808
10 miles	586,122
20 miles	1,392,346



GIVE US A CALL TO LEARN MORE ABOUT GATEWAY LOGISTICS CENTER



[VIEW WEBSITE](#)

JOHN JACKSON, CCIM, SIOR
EXECUTIVE DIRECTOR
727 643 7316
JOHN.JACKSON@CUSHWAKE.COM

JT FAIRCLOTH, SIOR
DIRECTOR
813 833 3242
JT.FAIRCLOTH@CUSHWAKE.COM

CASEY PERRY
SENIOR ASSOCIATE
813 233 6564
CASEY.G.PERRY@CUSHWAKE.COM



©2025 Cushman & Wakefield. All rights reserved. The information contained in this communication is strictly confidential. This information has been obtained from sources believed to be reliable but has not been verified. NO WARRANTY OR REPRESENTATION, EXPRESS OR IMPLIED, IS MADE AS TO THE CONDITION OF THE PROPERTY (OR PROPERTIES) REFERENCED HEREIN OR AS TO THE ACCURACY OR COMPLETENESS OF THE INFORMATION CONTAINED HEREIN, AND SAME IS SUBMITTED SUBJECT TO ERRORS, OMISSIONS, CHANGE OF PRICE, RENTAL OR OTHER CONDITIONS, WITHDRAWAL WITHOUT NOTICE, AND TO ANY SPECIAL LISTING CONDITIONS IMPOSED BY THE PROPERTY OWNER(S). ANY PROJECTIONS, OPINIONS OR ESTIMATES ARE SUBJECT TO UNCERTAINTY AND DO NOT SIGNIFY CURRENT OR FUTURE PROPERTY PERFORMANCE. COE-PM-CENTRAL- 09/09/25