

FOR SALE



CITY CENTRE 1

SUITE 302

13737 96 AVENUE

SURREY, BC



PRIME LOCATION. UNMATCHED ACCESS.

A STRATEGIC ADDRESS FOR FORWARD-THINKING BUSINESSES
AVAILABLE NOW FOR SALE!

MAX ZESSEL | Personal Real Estate Corporation | Senior Vice President | +1 604 640 5824 | max.zessel@cushwake.com

ROGER LEGGATT | Personal Real Estate Corporation | Executive Vice President | +1 604 640 5882 | roger.leggatt@cushwake.com

ETHAN REGAN | Associate | Commercial Sales & Leasing | +1 604 902 4649 | ethan.regan@cushwake.com

Suite 1200 - 700 West Georgia Street / PO Box 10023, Pacific Centre / Vancouver, BC V7Y 1A1 / +1 604 683 3111 / www.cushmanwakefield.com

OPPORTUNITY

Rare opportunity to purchase a fully improved medical office in the prestigious City Centre 1. This third-floor unit spans 3,663 square feet and is designed to an exceptional standard for healthcare and professional use. The layout includes a welcoming reception and waiting area, 10 private offices/exam rooms, multiple storage rooms, a staff room with kitchenette, and a spacious boardroom/ staff office. The space offers a functional, patient-friendly flow and is ideally suited for medical, dental, or allied health practitioners. The property also benefits from ample on-site parking for staff and visitors, as well as access to numerous retail and dining amenities within the building and nearby.



SALIENT DETAILS

AVAILABLE SPACE
UNIT 302

AREA SIZE
3,663 SF

PID
029-313-473



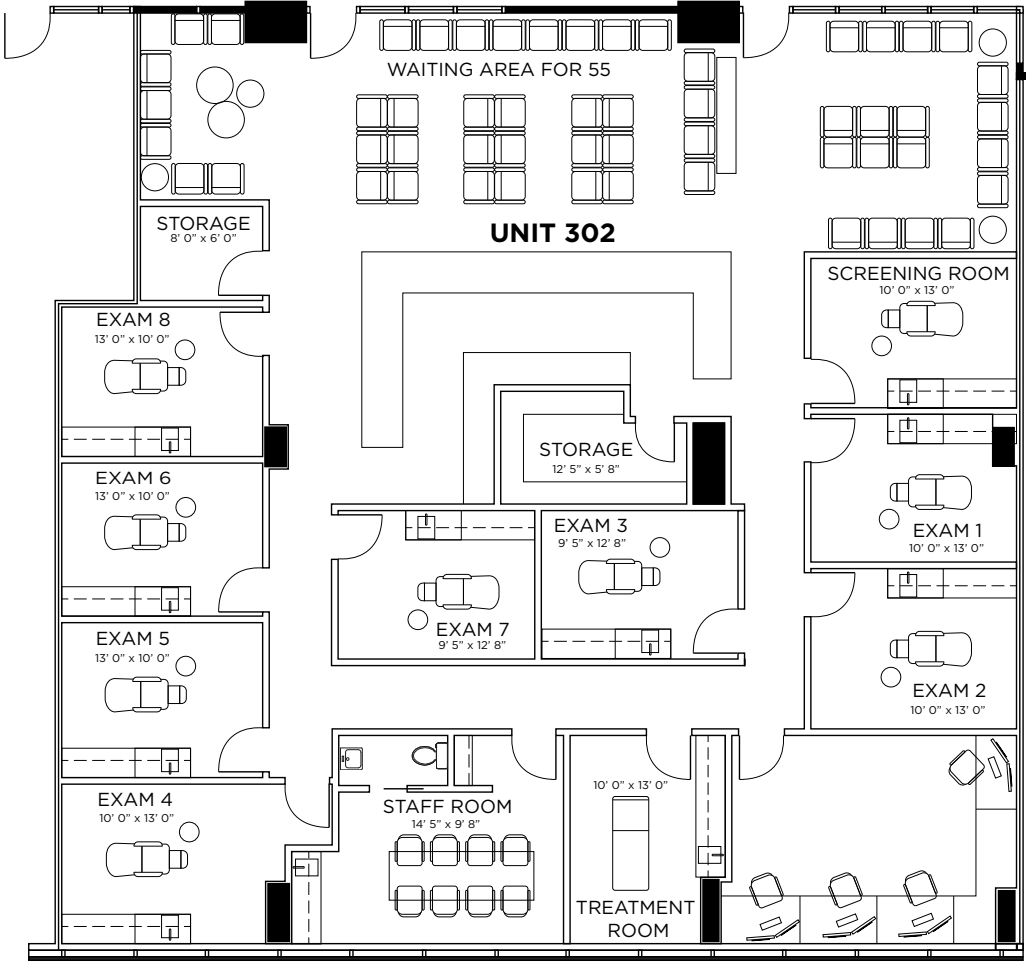

LISTING PRICE
\$3,846,000

STRATA FEES
\$1,570.99 / Month (Including GST)

GROSS TAXES
\$34,485.14 (2025)



SUITE 302
FEATURES

-  RECEPTION/WAITING AREA
-  PRIVATE EXAM ROOMS/OFFICES
-  STAFF ROOM/KITCHEN
-  STORAGE ROOMS
-  BOARDROOM/STAFF OFFICE

BUILDING
AMENITIES

-  LEED GOLD CERTIFIED
-  ON-SITE FITNESS FACILITY
-  MULTI-FLOOR UNDERGROUND PARKING GARAGE
-  EXCELLENT PUBLIC TRANSIT SERVICE NEARBY
-  RETAIL SPACE ON THE GROUND FLOOR

FOR SALE

CITY CENTRE 1

SUITE 302
13737 96 AVENUE
SURREY, BC

LOCATION

Positioned at 13737 96 Avenue, City Centre 1 is in the heart of Surrey's thriving Health & Technology District - directly across from Surrey Memorial Hospital and steps from the BC Cancer Agency. Just a short walk to King George SkyTrain Station, the building offers seamless transit connectivity and quick access to major routes.

Surrounded by medical, educational, and corporate hubs, this LEED Gold-certified, 12-storey landmark features street-level retail, ample parking, on-site fitness and bike facilities, and high-quality professional space ideal for medical or office use. With retail, dining, and essential services at your doorstep, City Centre 1 delivers a vibrant, amenity-rich environment to attract clients and talent alike.



6 MINUTES TO
KING GEORGE
SKYTRAIN STATION



ADJACENT TO
SURREY MEMORIAL HOSPITAL IN THE
HEALTH & TECHNOLOGY DISTRICT



EXCELLENT TRANSIT
80% TRANSIT SCORE



VERY BIKEABLE
70% BIKE SCORE



MAX ZESSEL | Personal Real Estate Corporation | Senior Vice President | +1 604 640 5824 | max.zessel@cushwake.com

ROGER LEGGATT | Personal Real Estate Corporation | Executive Vice President | +1 604 640 5882 | roger.leggatt@cushwake.com

ETHAN REGAN | Associate | Commercial Sales & Leasing | +1 604 902 4649 | ethan.regan@cushwake.com

©2025 Cushman & Wakefield. All rights reserved. The information contained in this communication is strictly confidential. This information has been obtained from sources believed to be reliable but has not been verified. NO WARRANTY OR REPRESENTATION, EXPRESS OR IMPLIED, IS MADE AS TO THE CONDITION OF THE PROPERTY (OR PROPERTIES) REFERENCED HEREIN OR AS TO THE ACCURACY OR COMPLETENESS OF THE INFORMATION CONTAINED HEREIN, AND SAME IS SUBMITTED SUBJECT TO ERRORS, OMISSIONS, CHANGE OF PRICE, RENTAL OR OTHER CONDITIONS, WITHDRAWAL WITHOUT NOTICE, AND TO ANY SPECIAL LISTING CONDITIONS IMPOSED BY THE PROPERTY OWNER(S). ANY PROJECTIONS, OPINIONS OR ESTIMATES ARE SUBJECT TO UNCERTAINTY AND DO NOT SIGNIFY CURRENT OR FUTURE PROPERTY PERFORMANCE.

