

FOR LEASE
±7,000 SF



- Fully Sprinklered • Quick and Easy access to Hwy 50 •
- Frontage on Trade Center Dr. • Close to Retail and other Amenities •

2689 CITRUS RD | SUITE C
RANCHO CORDOVA, CA 95742

2989 Citrus Rd | Rancho Cordova, CA

PROPERTY HIGHLIGHTS

Building Size: 30,800 SF

Space Available: 7,000 SF **Available 11/1/2025*

Office Area: 1,200 SF

Site Area: 1.92 AC

Clear Height: 18' - 19'

Grade Level Doors: 1 Oversized doors (12' w x 14' h)

Power: 100a/240v 3 Phase

Zoning: M-1 (Light Industrial)

Lease Rate: \$0.76 PSF NNN
(Net Expenses Estimated at \$0.267 PSF)



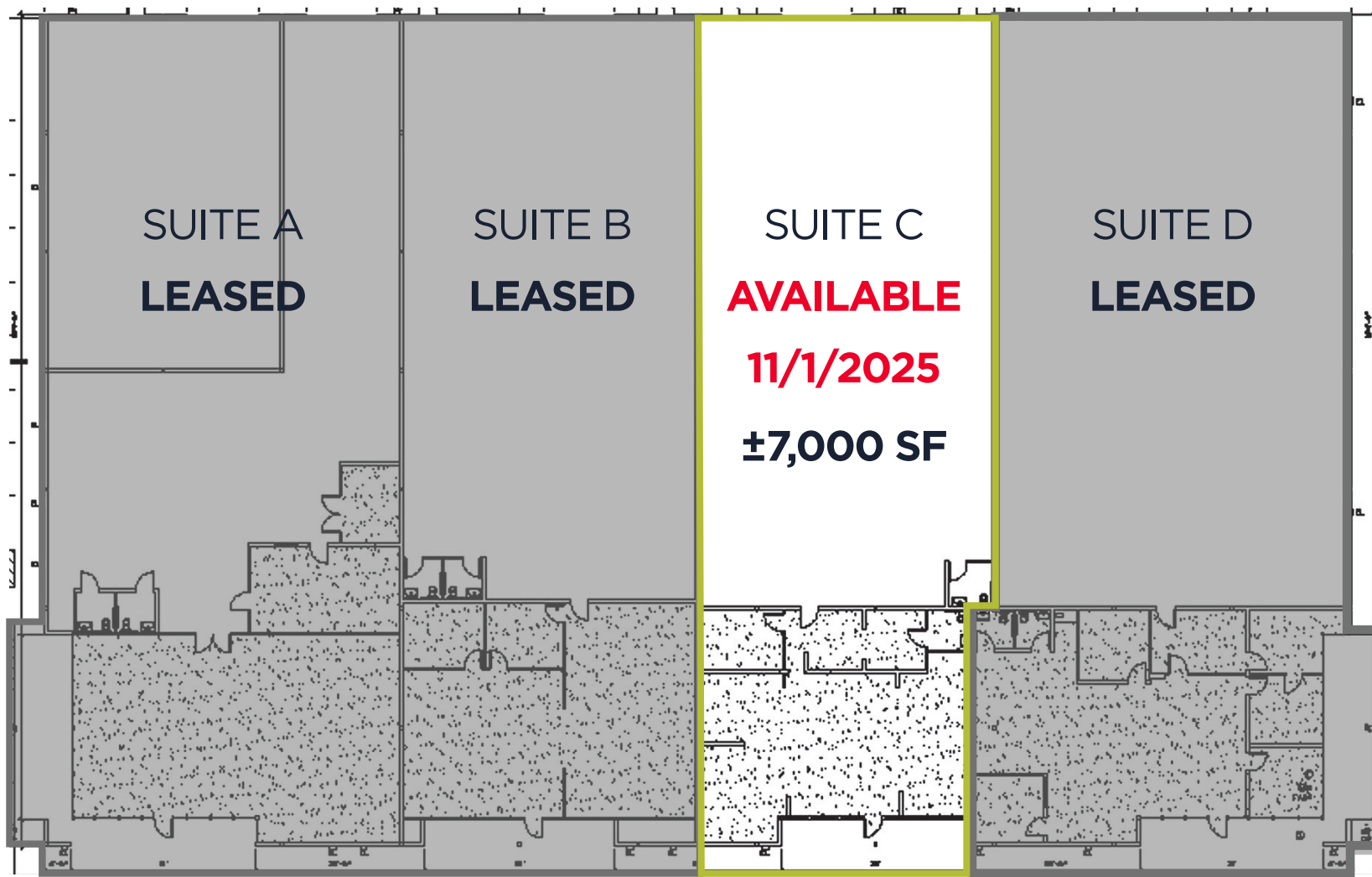

SITE PLAN

CONTACT INFORMATION

LENNY GOLD

Director

lenny.gold@cushwake.com

+1 916 288 4443

CA Lic #02055534



©2025 Cushman & Wakefield. All rights reserved. The information contained in this communication is strictly confidential. This information has been obtained from sources believed to be reliable but has not been verified. NO WARRANTY OR REPRESENTATION, EXPRESS OR IMPLIED, IS MADE AS TO THE CONDITION OF THE PROPERTY (OR PROPERTIES) REFERENCED HEREIN OR AS TO THE ACCURACY OR COMPLETENESS OF THE INFORMATION CONTAINED HEREIN, AND SAME IS SUBMITTED SUBJECT TO ERRORS, OMISSIONS, CHANGE OF PRICE, RENTAL OR OTHER CONDITIONS, WITHDRAWAL WITHOUT NOTICE, AND TO ANY SPECIAL LISTING CONDITIONS IMPOSED BY THE PROPERTY OWNER(S). ANY PROJECTIONS, OPINIONS OR ESTIMATES ARE SUBJECT TO UNCERTAINTY AND DO NOT SIGNIFY CURRENT OR FUTURE PROPERTY PERFORMANCE.