

for lease

# 5245 commonwealth ave



**±50,000 SF - ±403,428 SF AVAILABLE**

- 28 Acre Site
- 20' - 30' Clear Height
- Abundant Auto and Trailer Parking
- Short and Long Term Deal Options (3+ Years)
- Great Westside Location, 1.5 miles from I-10 & I-295
- Multiple Configurations for Divisibility
- No State or Local Personal Income Tax
- No Inventory Tax
- Strong Area Labor Base
- Located in FTZ #64

# property highlights



## ±50,000 SF - 403,428 SF AVAILABLE

**Available SF:** ±403,428 SF

**Suite 3:** ±116,224 SF

**Suite 4:** ±86,164 SF

**Suite 5:** ±114,666 SF

**Suite 6:** ±86,374 SF

**Building Size:** ±560,688 SF

**Office Area:** To-suit

**Mezzanine & Common Area:** ±4,704 SF

**Clear Height:** 20' - 30'

**Dock Loading:** 45  
(Existing & Knock Outs)

**Utilities:** City Water & Sewer JEA

**Year Built:** 1960 / 1990

**Column Spacing:** 28' x 56' and 56' x 40'

**Construction:** Concrete Tilt Wall & Precast Panel

**Sprinkler:** Wet Pipe

**Roof:** TPO Roof Completed in 2015

**Lighting:** LED & Fluorescent

**Power:** 6,000 Amp, 277/480 v  
3 phase

**Zoning:** IL  
(Industrial Light)

**Frontage:** Commonwealth Ave

# asking rates

**Suite 3:** \$5.50 / SF

**Suite 4:** \$5.75 / SF

**Suite 5:** \$6.00 / SF

**Suite 6:** \$6.25 / SF



# site plan



click on suite to see larger image

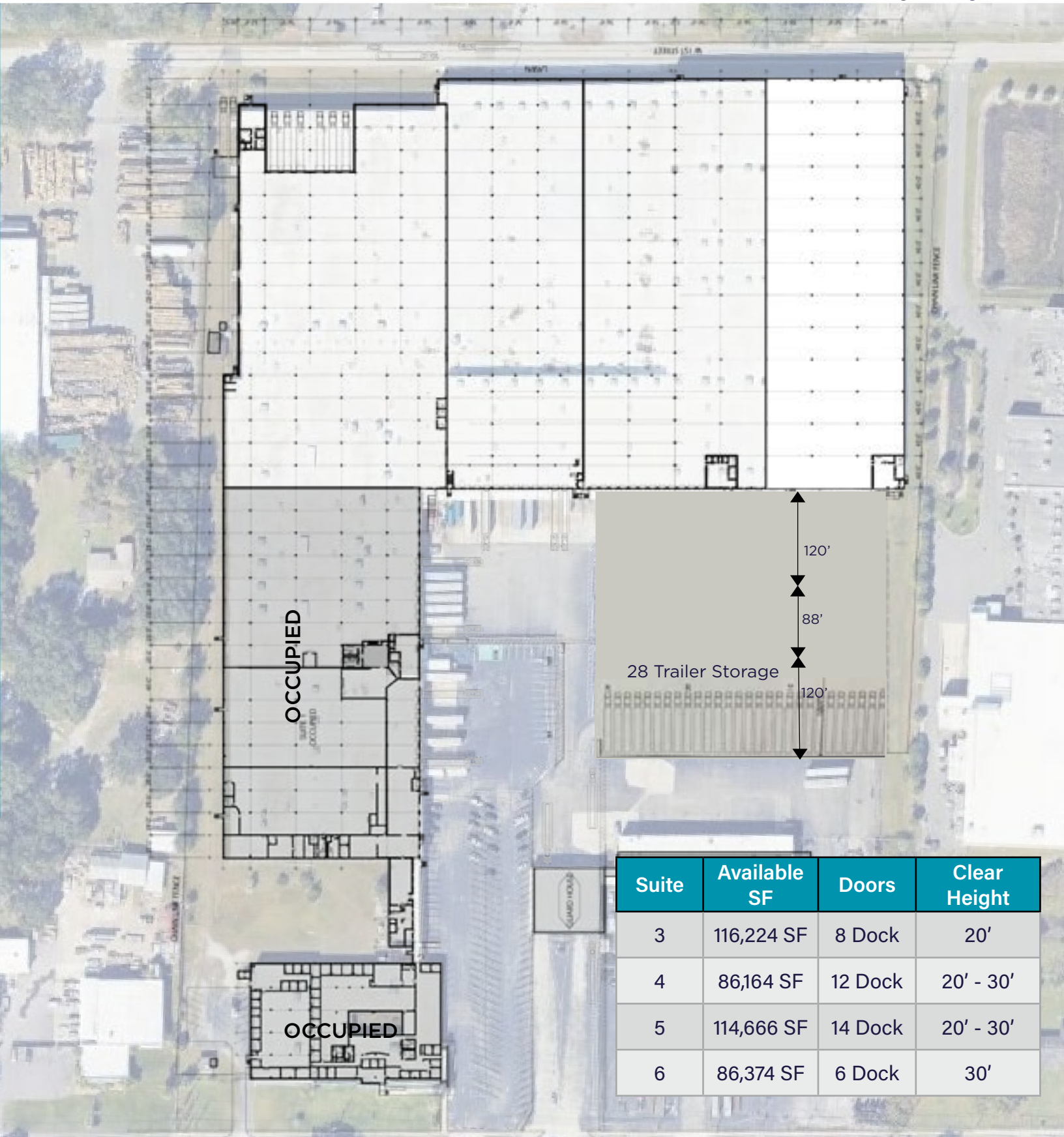

Suite	Available SF	Doors	Clear Height
3	116,224 SF	8 Dock	20'
4	86,164 SF	12 Dock	20' - 30'
5	114,666 SF	14 Dock	20' - 30'
6	86,374 SF	6 Dock	30'

\*Conceptual Plan

# site plan

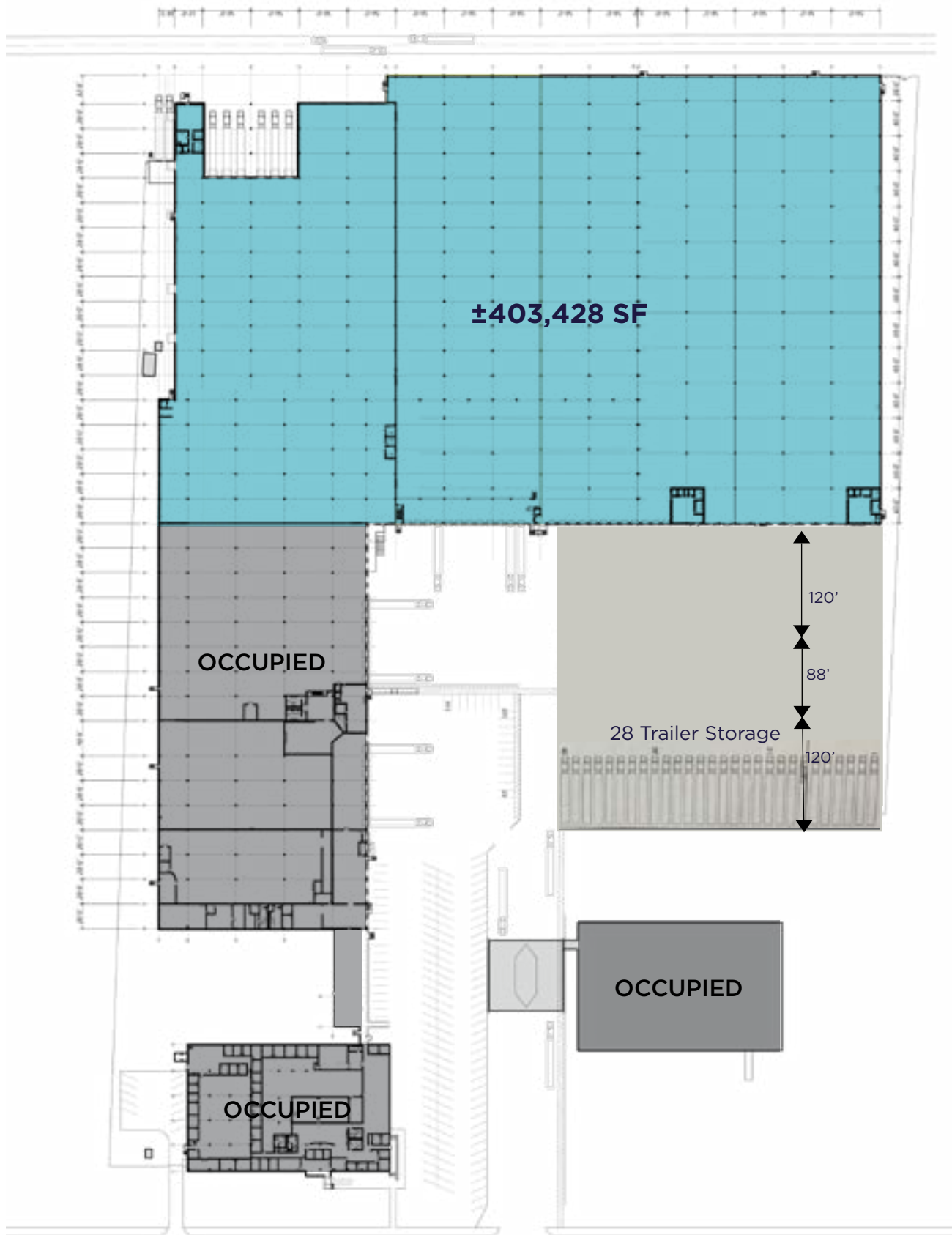

\*Conceptual Plan

# location highlights



## strategic location

- Outstanding Westside Location
- Easy Access to I-10, I-295 and I-95
- Close to ports and airports
- 56+ Mil consumers in an 8 hour drive
- Minutes to downtown Jacksonville

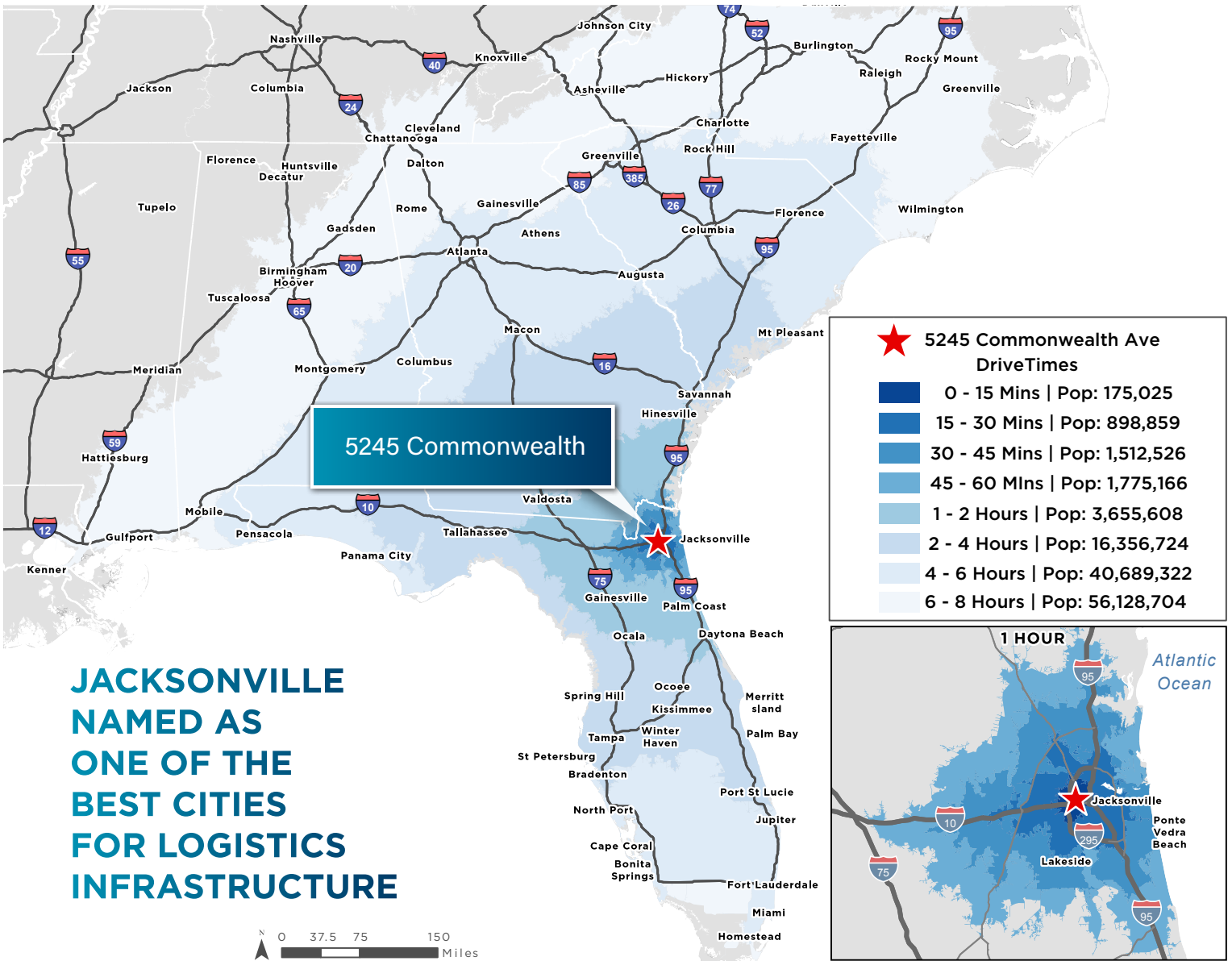

1.5 MILES



4 MILES



1.5 MILES

**JACKSONVILLE CBD**

4 MILES



15 MILES



15 MILES

# property photos



for lease  
**5245 commonwealth ave**



**For more information, please contact:**

**TYLER NEWMAN**

Executive Managing Director  
tyler.newman@cushwake.com  
(904) 380 8336

**JACOB HORSLEY**

Executive Managing Director  
jacob.horsley@cushwake.com  
(904) 380 8335

**Cushman & Wakefield of Florida, LLC**

121 West Forsyth Street, Suite 900  
Jacksonville, FL 32202  
cushmanwakefield.com

**Property Website: [www.5245commonwealth.com](http://www.5245commonwealth.com)**

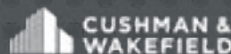

©2025 Cushman & Wakefield. All rights reserved. The information contained in this communication is strictly confidential. This information has been obtained from sources believed to be reliable but has not been verified. NO WARRANTY OR REPRESENTATION, EXPRESS OR IMPLIED, IS MADE AS TO THE CONDITION OF THE PROPERTY (OR PROPERTIES) REFERENCED HEREIN OR AS TO THE ACCURACY OR COMPLETENESS OF THE INFORMATION CONTAINED HEREIN, AND SAME IS SUBMITTED SUBJECT TO ERRORS, OMISSIONS, CHANGE OF PRICE, RENTAL OR OTHER CONDITIONS, WITHDRAWAL WITHOUT NOTICE, AND TO ANY SPECIAL LISTING CONDITIONS IMPOSED BY THE PROPERTY OWNER(S). ANY PROJECTIONS, OPINIONS OR ESTIMATES ARE SUBJECT TO UNCERTAINTY AND DO NOT SIGNIFY CURRENT OR FUTURE PROPERTY PERFORMANCE.