



**CUSHMAN &  
WAKEFIELD**



## OFFICE SPACE FOR LEASE

# MOUNTAIN VIEW CORPORATE CENTER I

756 EAST WINCHESTER / SALT LAKE CITY, UT

### *HIGH PROFILE, CLASS A PROPERTY*

- Excellent secured, underground parking
- High profile, Class A building
- Immediate access to I-215
- Close to restaurants, banks, business services and shopping
- I-215 visibility
- Abundant window lines provide for great natural light
- Great location with unmatched freeway visibility
- 1,979 RSF to 13,891 RSF Available
- **\$27.00/RSF, Full Service**

#### AVAILABLE SUITES

|           |           |
|-----------|-----------|
| SUITE 300 | 5,633 RSF |
| SUITE 302 | 2,353 RSF |
| SUITE 303 | 3,926 RSF |
| SUITE 305 | 1,979 RSF |

**SUITES CAN BE COMBINED  
FOR 13,891 RSF CONTIGUOUS**

#### CONTACT

**Dana Baird, CCIM**  
Executive Managing Director  
+1 801 303 5526  
dana.baird@cushwake.com

**Mike Richmond**  
Executive Managing Director  
+1 801 303 5434  
mike.richmond@cushwake.com

**Hannah King**  
Associate  
+1 801 303 5440  
hannah.king1@cushwake.com



# MOUNTAIN VIEW CORPORATE CENTER I

756 EAST WINCHESTER / SALT LAKE CITY, UT

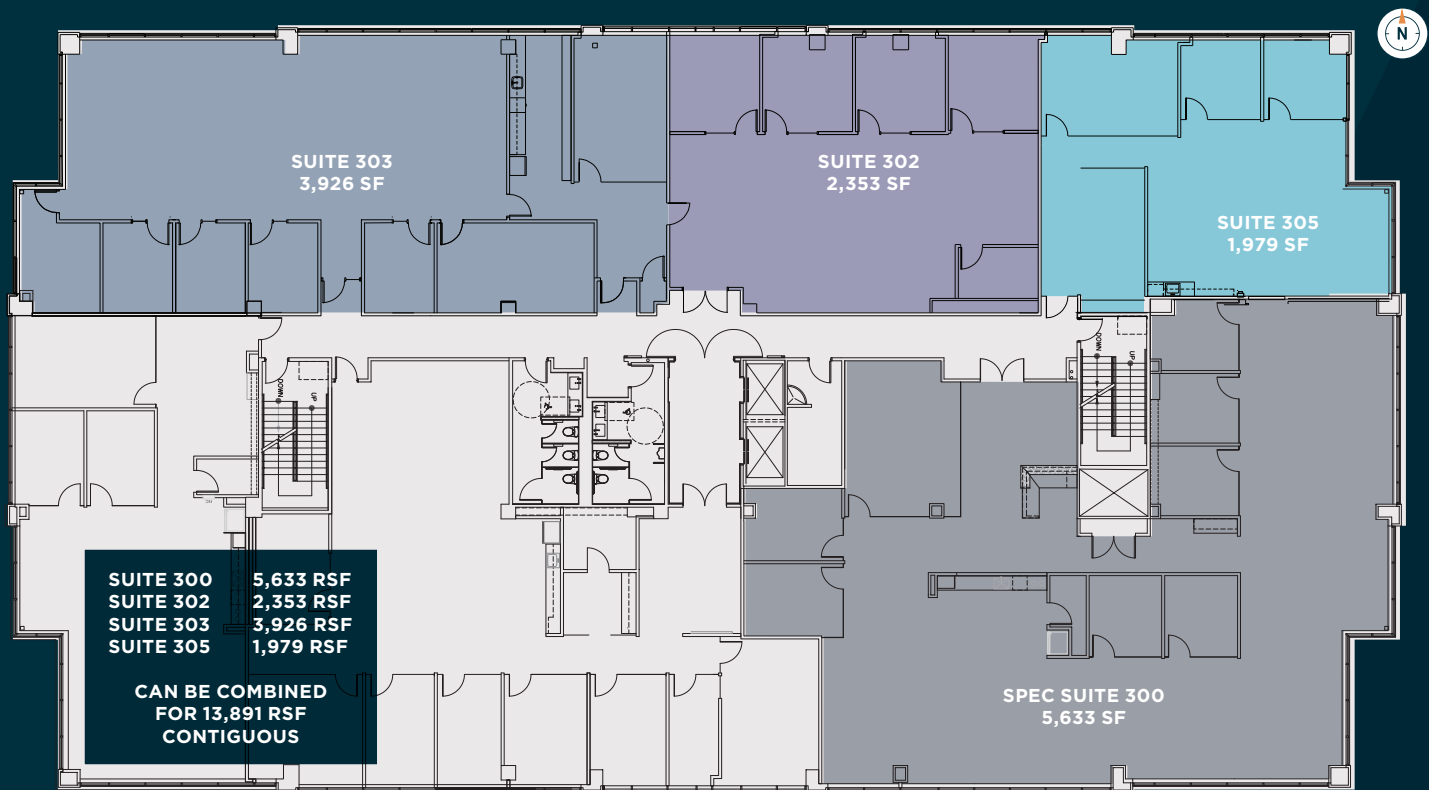

THIRD FLOOR



## CONTACT

**Dana Baird, CCIM**  
 Executive Managing Director  
 +1 801 303 5526  
 dana.baird@cushwake.com

**Mike Richmond**  
 Executive Managing Director  
 +1 801 303 5434  
 mike.richmond@cushwake.com

**Hannah King**  
 Associate  
 +1 801 303 5440  
 hannah.king1@cushwake.com

170 South Main Street, Suite 1600 • Salt Lake City, UT 84101 • +1 801 322 2000 • [cushmanwakefield.com](http://cushmanwakefield.com)

Cushman & Wakefield Copyright 2021. No warranty or representation, express or implied, is made to the accuracy or completeness of the information contained herein, and same is submitted subject to errors, omissions, change of price, rental or other conditions, withdrawal without notice, and to any special listing conditions imposed by the property owner(s). As applicable, we make no representation as to the condition of the property (or properties) in question. (path: G:\SLI\Shared\Apps\G:\UT\SLI\Shared\Apps\Gigas\1 - Projects\Richmond, Mike\1 - Flyers\MountainView-Corp)