

SILO BEND V

EAST TAMPA SUBMARKET

915-933 Chad Lane
Tampa, FL 33619



FOR LEASE

SUITE B & C

±33,000 - 130,205 SF



LEASED BY



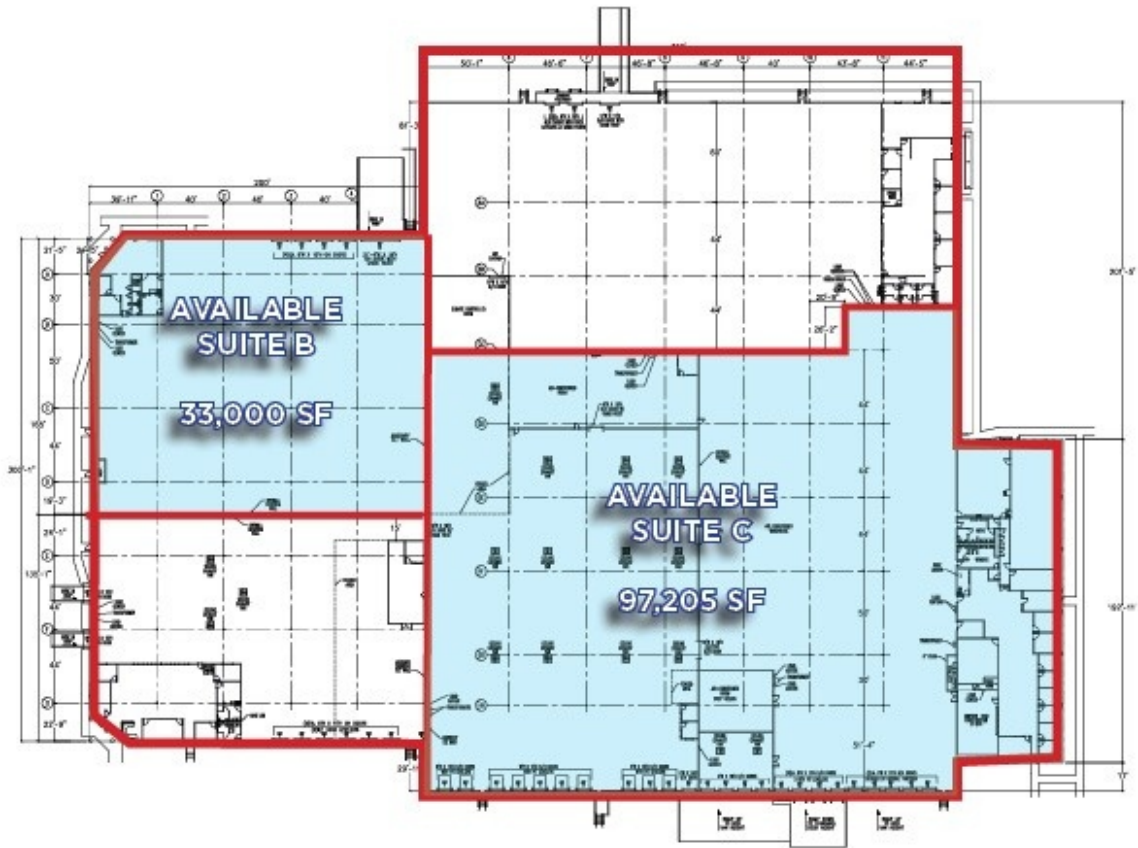

PROPERTY HIGHLIGHTS

- 24' - 30' CLEAR HEIGHT
- DOCK HIGH AND RAMPED LOADING
- CLASS 'A', DOCK HIGH MULT-TENANT DISTRIBUTION FACILITY
- OUTSTANDING STREET VISIBILITY FROM THE HEAVILY TRAVELED SELMON-EXPRESSWAY AND PALM RIVER ROAD
- EXCELLENT DISTRIBUTION SITE IN WELL ESTABLISHED BUSINESS PARK
- AVAILABLE JULY 1, 2026

CONTACT INFORMATION

915-933 Chad Lane
Tampa, FL 33619

Trey Carswell, SIOR

trey.carswell@cushwake.com
813-230-6131

Lisa Ross, SIOR

lisa.ross@cushwake.com
813-760-3209

Sam Korolos

sam.korolos@cushwake.com
704-989-1327

Melissa Watterworth

melissa.watterworth@cushwake.com
813-599-2190

This is not an offer or acceptance of an offer to lease space. A lease will only be offered or made in a written agreement signed by landlord. No representation or warranty of any kind is made by landlord unless set forth in a written definitive lease executed by the landlord.



LEASED BY

