



254,736 SF AVAILABLE FOR LEASE AND SALE

# 3045 REDLANDS AVE

PERRIS, CA



PROUDLY OWNED BY A  
JOINT VENTURE BETWEEN

**LAKE CREEK INDUSTRIAL LLC**



TAL SIGLAR, CCIM, SIOR  
909 942 4680  
tal.siglar@cushwake.com  
Lic. #01229412

PATRICK CASANI  
909 942 4664  
patrick.casani@cushwake.com  
Lic. #02223488

# PROPERTY



## PROPERTY FEATURES

- 254,736 SF Building
- 8,667 SF Deluxe Office Area
- 40' Minimum Clear Height
- ESFR Sprinkler System (K-25@45 psi)
- 1,200 Amps (4,000 UGPS)
- LED Warehouse Lights
- 31 Dock High Doors (9'x10')
- 2 Ground Level Doors (12'x14')
- 60'x56' Column Spacing
- 108 Auto Parking Stalls
- 2% Acrylic Dome Skylight
- 47 Trailer Stalls
- 185' Secured & Gated Concrete Truck Court
- White Scrim Ceiling Foil



# PROPERTY



## AERIAL MAP

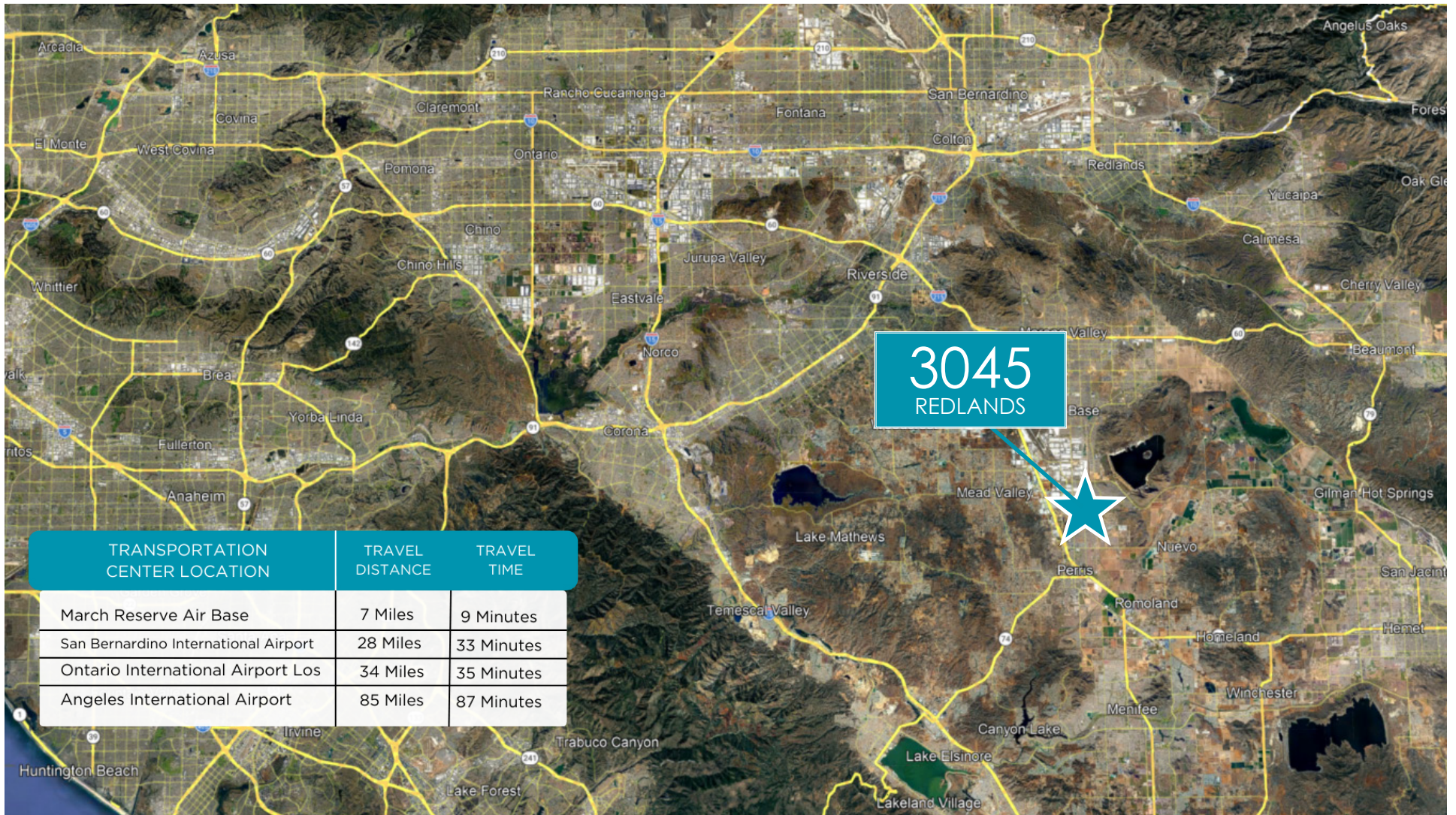

# PROPERTY

## SITE PLAN

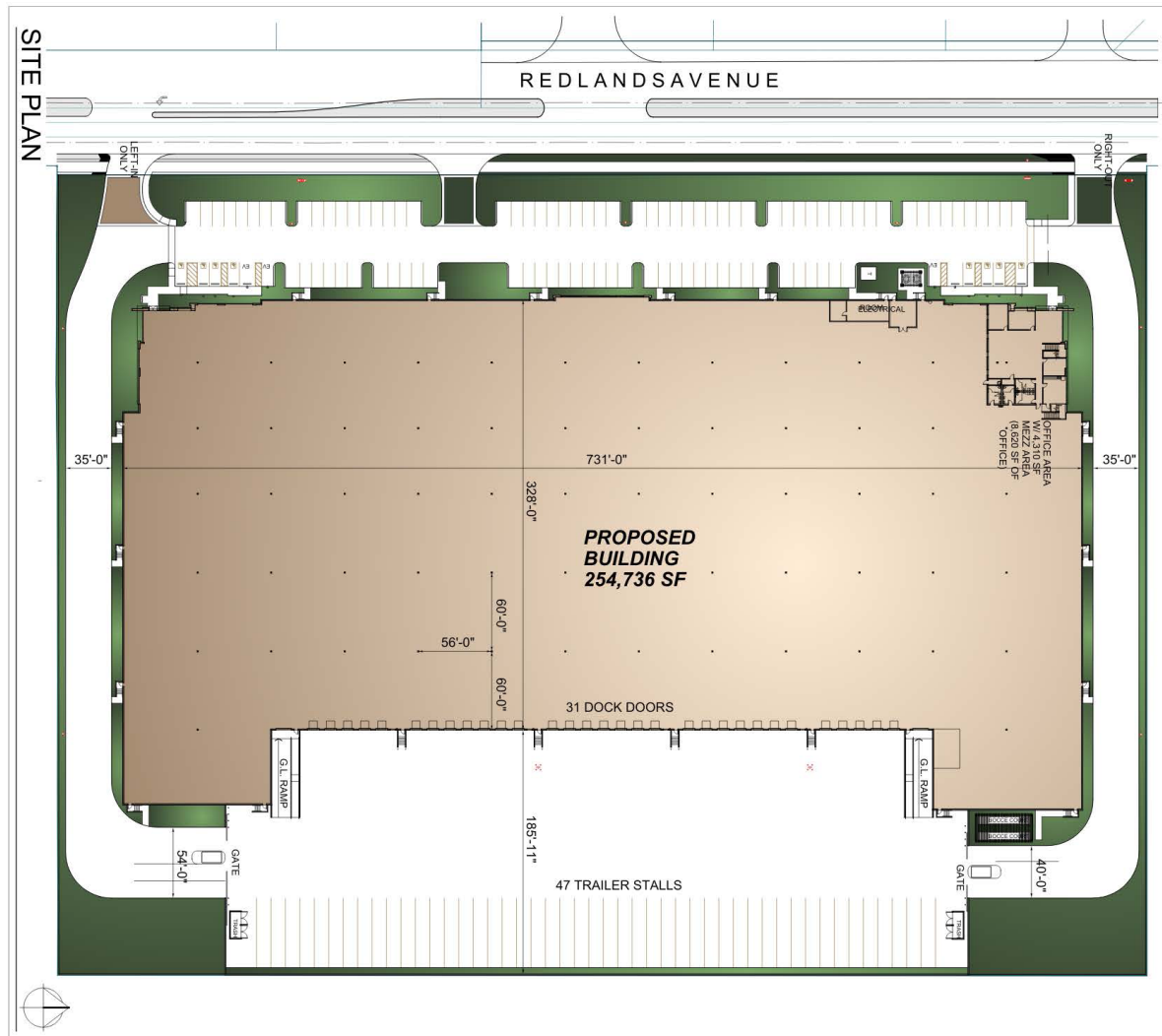



## SURROUNDING PROJECTS



# PROPERTY



## CORPORATE NEIGHBORS



Corporate Neighbors	
1	NewAge Products
2	IDC Logistics
3	Sketchers
4	Wayfair
5	Inland Empire Truss
6	GPA Logistics
7	J&B Materials
8	Lecangs
9	Ritchie Bros Auctioneers
10	El Dorado Stone
11	Star Milling Company
12	FedEx Freight
13	NFI Industries
14	American Standard
15	JM Eagle
16	KPower Global Logistics
17	National Archives
18	Genesis Supreme RV
19	Home Depot
20	Zodiac Pool Systems
21	Builders First Source
22	Ross Stores
23	Wayfair
24	Building Material Distributors
25	NFI Industries
26	Whirlpool Corporation
27	Kenco Group
28	Lowe's Home Improvement





For more information  
please contact:

**TAL SIGLAR, CCIM, SIOR**  
909 942 4680  
tal.siglar@cushwake.com  
Lic. #01229412

**PATRICK CASANI**  
909 942 4664  
patrick.casani@cushwake.com  
Lic. #02223488

©2023 Cushman & Wakefield. All rights reserved. The information contained in this communication is strictly confidential. This information has been obtained from sources believed to be reliable but has not been verified. NO WARRANTY OR REPRESENTATION, EXPRESS OR IMPLIED, IS MADE AS TO THE CONDITION OF THE PROPERTY (OR PROPERTIES) REFERENCED HEREIN OR AS TO THE ACCURACY OR COMPLETENESS OF THE INFORMATION CONTAINED HEREIN, AND SAME IS SUBMITTED SUBJECT TO ERRORS, OMISSIONS, CHANGE OF PRICE, RENTAL OR OTHER CONDITIONS, WITHDRAWAL WITHOUT NOTICE, AND TO ANY SPECIAL LISTING CONDITIONS IMPOSED BY THE PROPERTY OWNER(S). ANY PROJECTIONS, OPINIONS OR ESTIMATES ARE SUBJECT TO UNCERTAINTY AND DO NOT SIGNIFY CURRENT OR FUTURE PROPERTY PERFORMANCE.

