

AVAILABLE FOR LEASE – LIGHT INDUSTRIAL/FLEX SPACE

±4,550 SF FLEXIBLE SPACE LAYOUT FOR A VARIETY OF USES



2268 Research Drive
LIVERMORE, CA



PROPERTY FEATURES

- Available: January 1, 2026
- Ample office space with three (3) private offices, conference room, open area, reception.
- Drop ceiling “Dry” Lab areas (can be removed)
- Balance warehouse
- One (1) Grade Level loading door
- Clear Height: +/-16’
- Close to Lawrence Livermore National Lab and Livermore Wine Country
- Call broker for pricing information and to arrange tour

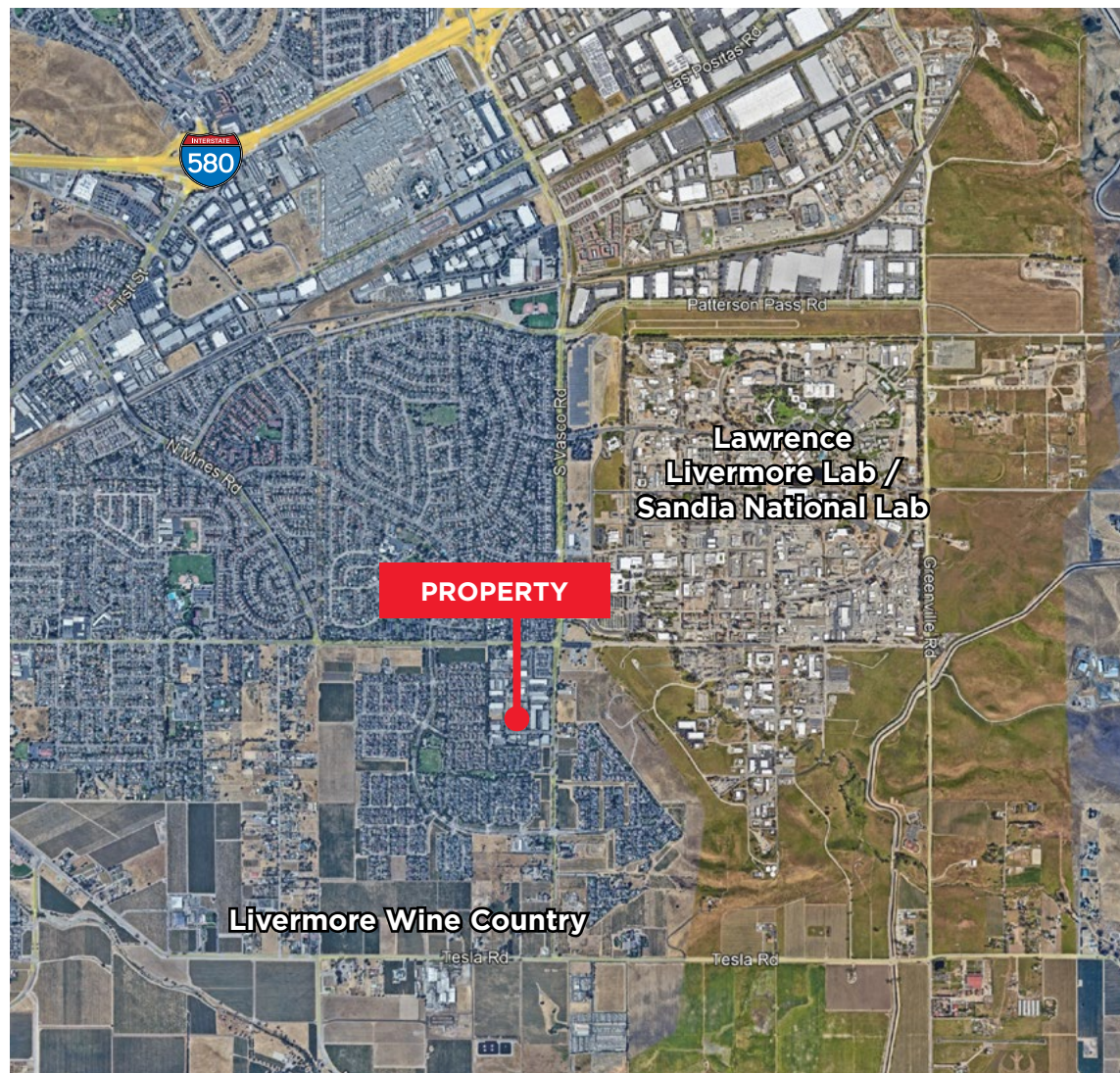

Mark Dowling
Managing Director
925.621.3844
mark.dowling@cushwake.com
Lic#01107108

Cushman & Wakefield
1333 N California Blvd, Suite 500
Walnut Creek, CA 94596

PROPERTY OVERVIEW

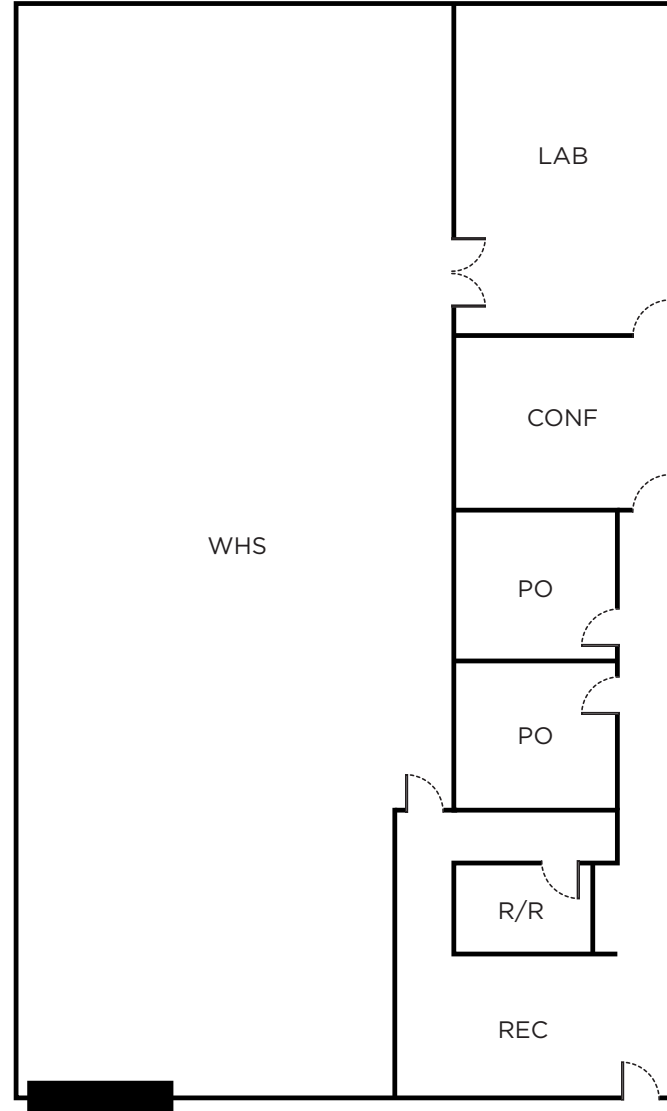

Disclaimer: *Not to scale



©2025 Cushman & Wakefield. All rights reserved. The information contained in this communication is strictly confidential. This information has been obtained from sources believed to be reliable but has not been verified. NO WARRANTY OR REPRESENTATION, EXPRESS OR IMPLIED, IS MADE AS TO THE CONDITION OF THE PROPERTY (OR PROPERTIES) REFERENCED HEREIN OR AS TO THE ACCURACY OR COMPLETENESS OF THE INFORMATION CONTAINED HEREIN, AND SAME IS SUBMITTED SUBJECT TO ERRORS, OMISSIONS, CHANGE OF PRICE, RENTAL OR OTHER CONDITIONS, WITHDRAWAL WITHOUT NOTICE, AND TO ANY SPECIAL LISTING CONDITIONS IMPOSED BY THE PROPERTY OWNER(S). ANY PROJECTIONS, OPINIONS OR ESTIMATES ARE SUBJECT TO UNCERTAINTY AND DO NOT SIGNIFY CURRENT OR FUTURE PROPERTY PERFORMANCE.

Mark Dowling
Managing Director
925.621.3844
mark.dowling@cushwake.com
Lic#01107108

Cushman & Wakefield
1333 N California Blvd, Suite 500
Walnut Creek, CA 94596

**PROPERTY
AERIAL**