



RADICE

CORPORATE CENTER



RADICE III
1000 Corporate Drive



RADICE I
600 Corporate Drive



RADICE II
800 Corporate Drive

Class A Office Available for Lease

New Spec Suites Completed

VISIT OUR WEBSITE AT: WWW.RADICECORPORATECENTER.COM



RADICE III

1000 Corporate Drive



HIGHLIGHTS

TOTAL SQUARE FEET	129,000 SF
FLOOR SIZE	±20,000 SF
PARKING	4:1,000/SF surface parking Limited canopied parking available

PROPERTY FEATURES

- Renovated common areas
- 7 story Class "A" office building located in the heart of Cypress Creek just east of the Interstate 95/Cypress Creek Exchange
- New landscaping and monument signage
- Atrium lobby with marble accents
- Floor to ceiling windows
- Visible from I-95
- On-site property management and roaming 24/7 security
- Westin Hotel - on-site cafe located in Corporate Park
- New Starbucks opened 2024
- New EV Charging stations

NEW SPEC SUITES AT RADICE CORPORATE CENTER I UNDERWAY!





CAFE RENOVATIONS COMING Q3 2025

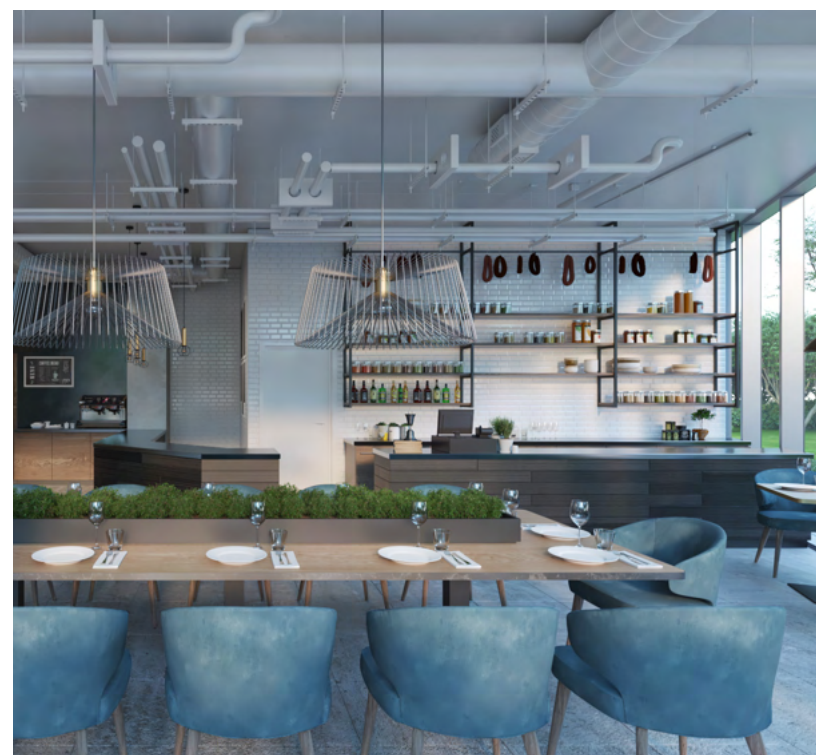



RADICE II

800 Corporate Drive

HIGHLIGHTS

TOTAL SQUARE FEET	122,625 SF
FLOOR SIZE	18,000 SF
PARKING	4:1,000/SF surface parking Limited canopied parking available

PROPERTY FEATURES

- 7 story Class “A” office building located in the heart of Cypress Creek, just east of the Interstate 95/Cypress Creek exchange
- Renovated common areas & bathrooms
- New landscaping and monument signage
- New elevator systems & HVAC
- Prominent building signage available
- Westin Hotel - on-site cafe located in Corporate Park
- Korner Cafe (Delivery & Catering) located in building
- Visible from I-95
- On-site property management and roaming 24/7 security
- 5 1/2 acre nature preserve and a jogging trail





RADICE I

600 Corporate Drive

HIGHLIGHTS

TOTAL SQUARE FEET	102,350 SF
FLOOR SIZE	18,000 SF
	4:1,000/SF surface parking
PARKING	Limited canopied parking available

PROPERTY FEATURES

- 6 story Class “A” office building located in the heart of Cypress Creek, just east of the Interstate 95/ Cypress Creek exchange
- Renovated common areas & bathrooms
- New landscaping and monument signage
- Westin Hotel - on-site cafe located in Corporate Park
- Dominant I-95 building signage available
- Korner Cafe (Delivery)
- On-site property management and roaming 24/7 security
- 5 1/2 acre nature preserve and a jogging trail
- New Starbucks opened 2024
- New EV Charging stations

NEW SPEC SUITES UNDERWAY





AREA INFORMATION

Cypress Creek Submarket

SHOPPING CENTERS

- 1 Cypress Creek Station
- 2 Pompano Marketplace
- 3 Northridge Shopping Center
- 4 Palm Aire Plaza
- 5 Cypress Lakes Town Center
- 6 Lakewood Mall

RESTAURANTS

- 1 Fat Boyz BBQ
- 2 Boston Bagel
- 3 Lazo Empanadas
- 4 Beehive Kitchen
- 5 Blaze Pizza
- 6 Chipotle Mexican Grill
- 7 Five Guys
- 8 Gyroville
- 9 LongHorn Steakhouse
- 10 Black Rock Bar & Grill
- 11 Outback Steakhouse
- 12 Bonefish Grill
- 13 McDonalds
- 14 Smokey Bones
- 15 Tee Jay Thai & Sushi
- 16 Panera Bread
- 17 Einstein Bros. Bagels
- 18 Subway
- 19 Dairy Queen Grill & Chill

HOTELS

- 1 The Westin
- 2 Hampton Inn
- 3 Fort Lauderdale Marriott
- 4 Sheraton Suites

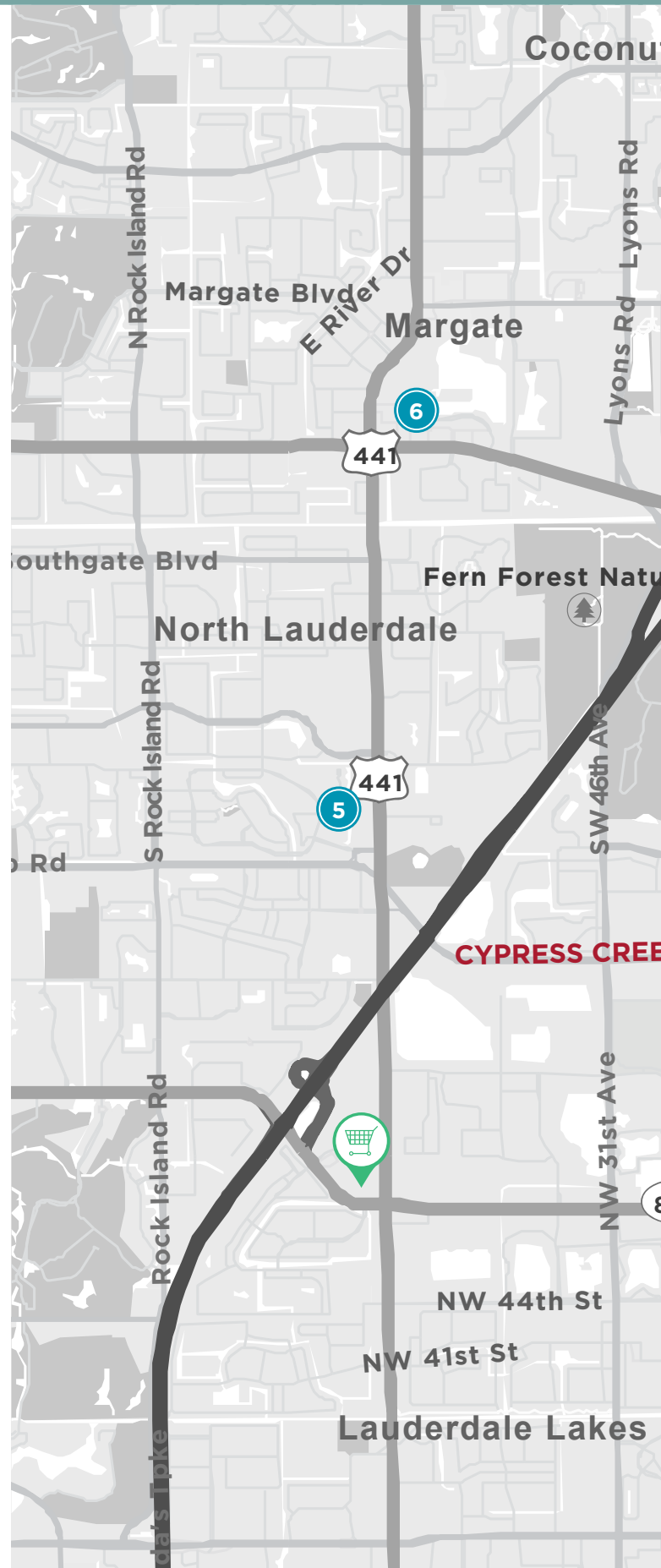

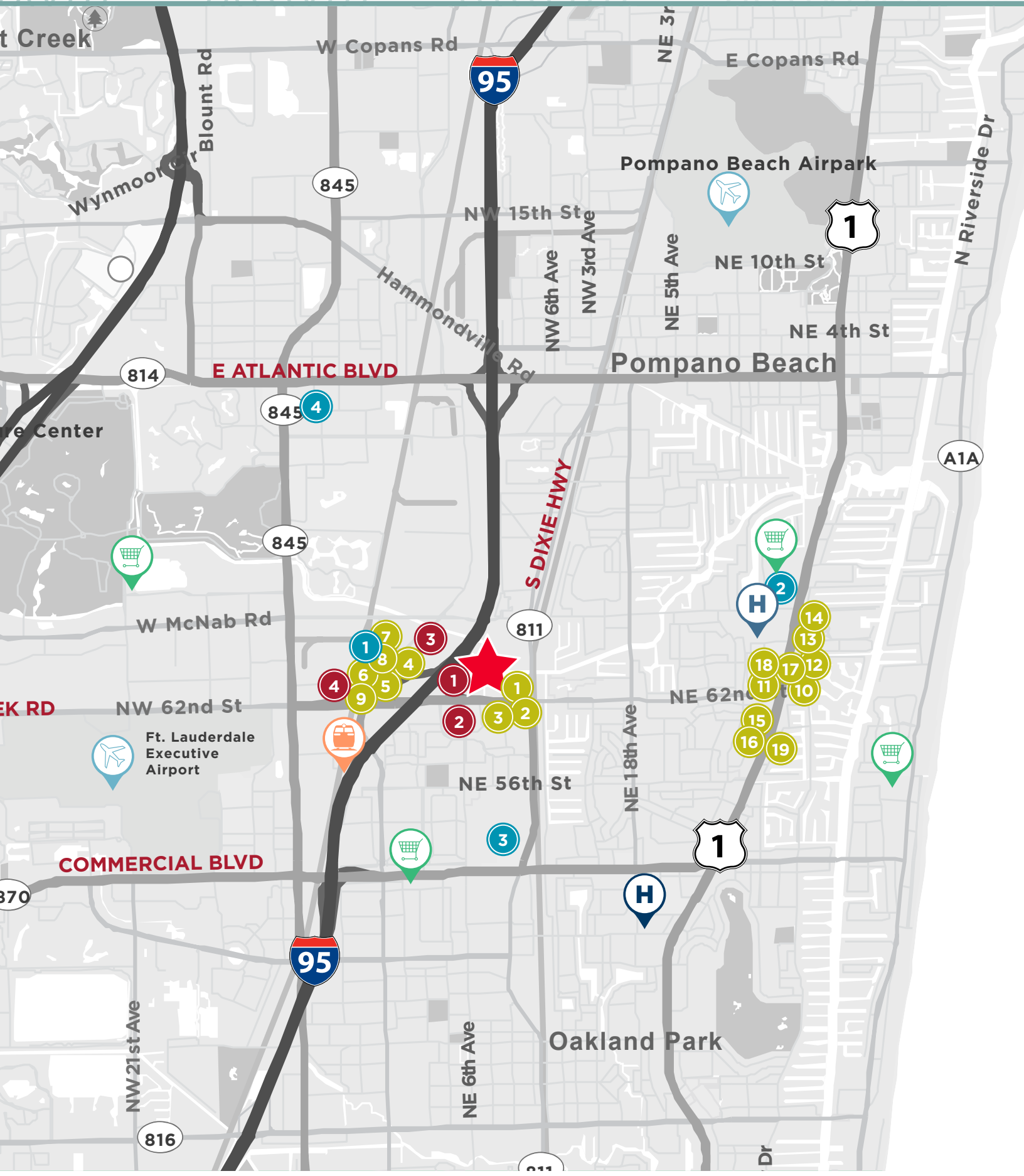



RADICE CORPORATE CENTER



LOCATION ADVANTAGES

- Easy access to all major South Florida roadways
- Corporate location and identity
- Prominent I-95 building signage available
- Westin Hotel located within Corporate Park
- On-site cafe and a two minute drive to many national restaurant chains

For more information, please contact:

DEANNA LOBINSKY
Executive Director
+1 954 377 0489
deanna.lobinsky@cushwake.com

CHASE KULP
Senior Director
+1 954 377 0494
chase.kulp@cushwake.com

CUSHMAN & WAKEFIELD OF FLORIDA, LLC
515 E. Las Olas Boulevard, Suite 900
Fort Lauderdale, Florida 33301
cushmanwakefield.com

©2025 Cushman & Wakefield. All rights reserved. The information contained in this communication is strictly confidential. This information has been obtained from sources believed to be reliable but has not been verified. NO WARRANTY OR REPRESENTATION, EXPRESS OR IMPLIED, IS MADE AS TO THE CONDITION OF THE PROPERTY (OR PROPERTIES) REFERENCED HEREIN OR AS TO THE ACCURACY OR COMPLETENESS OF THE INFORMATION CONTAINED HEREIN, AND SAME IS SUBMITTED SUBJECT TO ERRORS, OMISSIONS, CHANGE OF PRICE, RENTAL OR OTHER CONDITIONS, WITHDRAWAL WITHOUT NOTICE, AND TO ANY SPECIAL LISTING CONDITIONS IMPOSED BY THE PROPERTY OWNER(S). ANY PROJECTIONS, OPINIONS OR ESTIMATES ARE SUBJECT TO UNCERTAINTY AND DO NOT SIGNIFY CURRENT OR FUTURE PROPERTY PERFORMANCE.

