



FOR SUBLEASE

468

**KING STREET WEST
TORONTO, ON**

DETAILS



AVAILABLE SPACE:
5th Floor - 9,427 SF



SUBLEASE EXPIRY:
March 30, 2030
(Sublandlord may consider a shorter term)



Open space with 40+ desks
9 Meeting rooms
1 Boardroom
Large kitchen
Large open area



Video walk through

FLOOR PLAN

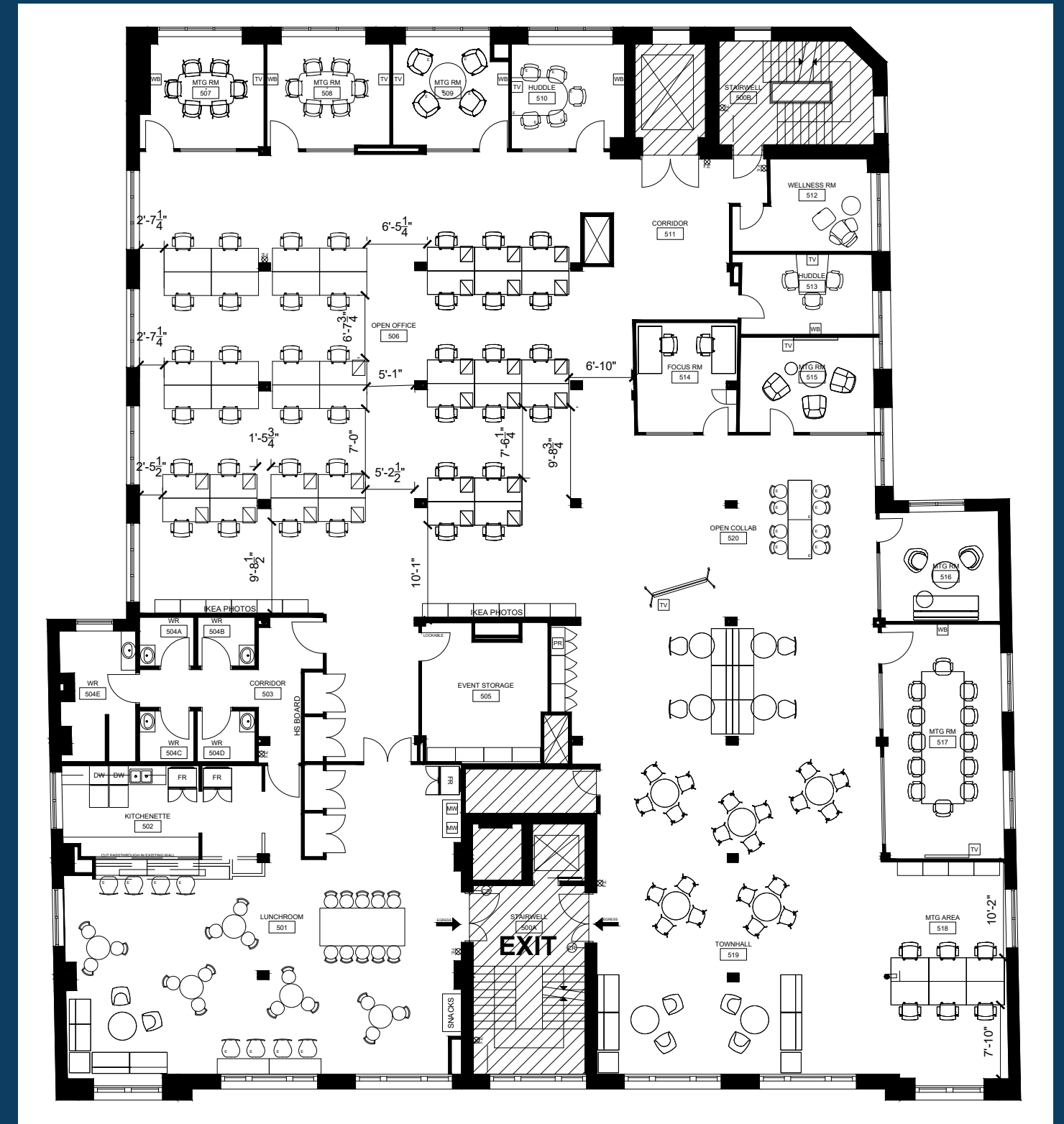

5TH FLOOR
9,427 SF



468 KING STREET WEST



468 KING STREET WEST CONNECTED



BILLY BISHOP
AIRPORT

LEGEND

||||| GO TRANSIT | UP EXPRESS | VIA RAIL



STREET CAR ROUTE



BUS ROUTE

LAKE ONTARIO

FREDERICK G. GARDINER EXPRESS WAY



468 KING
STREET
WEST

KING STREET

ADELAIDE STREET

RICHMOND STREET

QUEEN STREET

BATHURST STREET

KING STREET

ADELAIDE STREET

RICHMOND STREET

QUEEN STREET

SPADINA AVENUE

DUNAS STREET



FOR MORE INFORMATION PLEASE CONTACT:

Cushman & Wakefield ULC, Brokerage

161 Bay Street, Suite 1500

Toronto, ON M5J 2S1

+1 416 862 0611

SCOTT STONEBURGH*

Vice President

Direct: +1 416 359 2373

Mobile: +1 416 704 9490

scott.stoneburgh@cushwake.com

MATTHEW STESCO*

Vice President

Direct: +1 416 359 2353

Mobile: +1 647 222 5873

matthew.stesco@cushwake.com

KATIE MCCROSSAN*

Associate

Direct: +1 416 359 2574

Mobile: +1 705 817 0721

katie.mccrossan@cushwake.com

Cushman & Wakefield ULC, Brokerage

©2026 Cushman & Wakefield ULC. All rights reserved. The information contained in this communication is strictly confidential. This information has been obtained from sources believed to be reliable but has not been verified. NO WARRANTY OR REPRESENTATION, EXPRESS OR IMPLIED, IS MADE AS TO THE CONDITION OF THE PROPERTY (OR PROPERTIES) REFERENCED HEREIN OR AS TO THE ACCURACY OR COMPLETENESS OF THE INFORMATION CONTAINED HEREIN, AND SAME IS SUBMITTED SUBJECT TO ERRORS, OMISSIONS, CHANGE OF PRICE, RENTAL OR OTHER CONDITIONS, WITHDRAWAL WITHOUT NOTICE, AND TO ANY SPECIAL LISTING CONDITIONS IMPOSED BY THE PROPERTY OWNER(S). ANY PROJECTIONS, OPINIONS OR ESTIMATES ARE SUBJECT TO UNCERTAINTY AND DO NOT SIGNIFY CURRENT OR FUTURE PROPERTY PERFORMANCE. *Sales Representative **Broker

