



AVAILABLE FOR SALE OR LEASE

# 33390 TRANSIT AVE

UNION CITY, CA 94587



CUSHMAN &  
WAKEFIELD





## BUILDING SUMMARY

33390 Transit Avenue is a 40,862 square foot industrial building located in the Central Bay Industrial Park in Union City, CA. Located at the corner of Pacific and Transit Avenues, the building benefits from its prominent position, and excellent access to I-880 via Alvarado Niles Road to the South, or Whipple Avenue to the North. It is surrounded by contemporary warehouse and manufacturing buildings in a sub-market characterized by high-tech manufacturing, food production and bio-medical manufacturing and storage facilities.

2 33390 Transit Ave | Union City, CA 94587



# Property Highlights



**±40,802 SF**

WAREHOUSE/  
MANUFACTURING BUILDING



**TWO (2)**

GRADE LEVEL DOORS



**1,000 AMPS**

277/480V POWER  
(TENANT TO CONFIRM)



**±2.08**

ACRE SITE



**±28'**

CEILING HEIGHTS



**±110'**

TRUCK COURT DEPTH



**±2,000 SF**

OFFICE SPACE



**SPRINKLERED**



**OFF STREET**

PARKING



**SIX (6)**

LOADING DOCKS WITH END  
OF DOCK LEVELERS



**SKYLIGHTS**

THROUGHOUT



**CALL FOR PRICING**

DO NOT DISTURB TENANT



# Office Plan

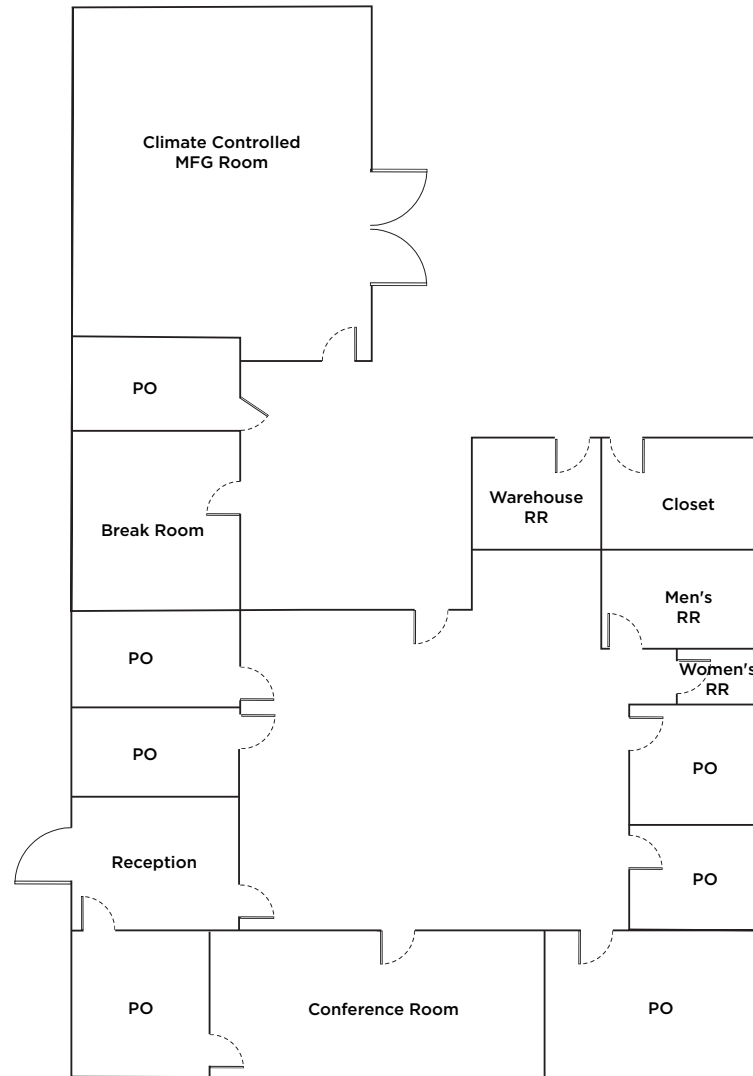

\*Not to Scale

# Floor Plan

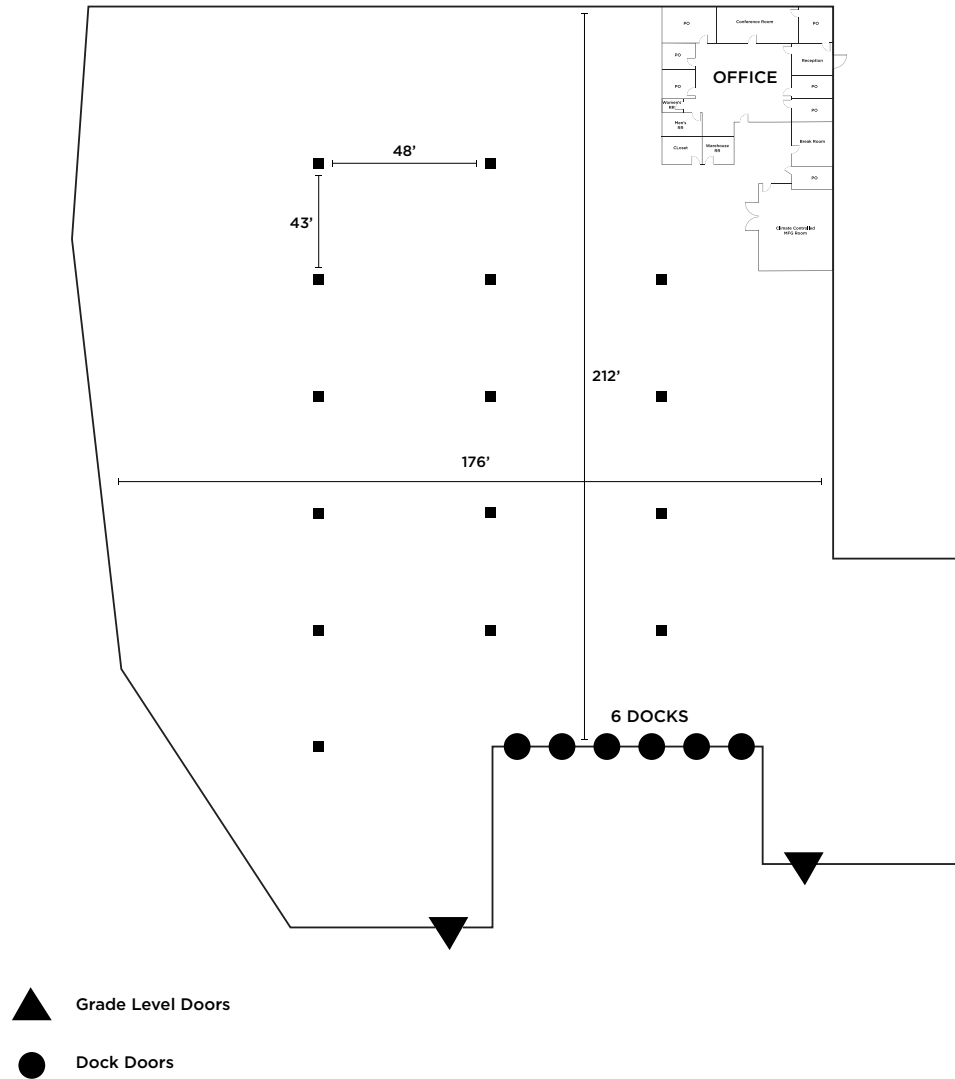

\*Not to Scale



# Property Photos







## CONTACT

### **JEFF POWERS**

*Managing Director*

+1 510 891 5821

[jeff.powers@cushwake.com](mailto:jeff.powers@cushwake.com)

Lic #02021074

### **MICHAEL KARP**

*Managing Director*

+1 510 813 0113

[michael.karp@cushwake.com](mailto:michael.karp@cushwake.com)

Lic #01010085

555 12th Street, Suite 100

Oakland, CA 94607

+1 510 465 8000

[cushmanwakefield.com](http://cushmanwakefield.com)



©2025 Cushman & Wakefield. All rights reserved. The information contained in this communication is strictly confidential. This information has been obtained from sources believed to be reliable but has not been verified. NO WARRANTY OR REPRESENTATION, EXPRESS OR IMPLIED, IS MADE AS TO THE CONDITION OF THE PROPERTY (OR PROPERTIES) REFERENCED HEREIN OR AS TO THE ACCURACY OR COMPLETENESS OF THE INFORMATION CONTAINED HEREIN, AND SAME IS SUBMITTED SUBJECT TO ERRORS, OMISSIONS, CHANGE OF PRICE, RENTAL OR OTHER CONDITIONS, WITHDRAWAL WITHOUT NOTICE, AND TO ANY SPECIAL LISTING CONDITIONS IMPOSED BY THE PROPERTY OWNER(S). ANY PROJECTIONS, OPINIONS OR ESTIMATES ARE SUBJECT TO UNCERTAINTY AND DO NOT SIGNIFY CURRENT OR FUTURE PROPERTY PERFORMANCE.