

FOR SUBLEASE

6872 Santa Teresa Boulevard

San Jose, California

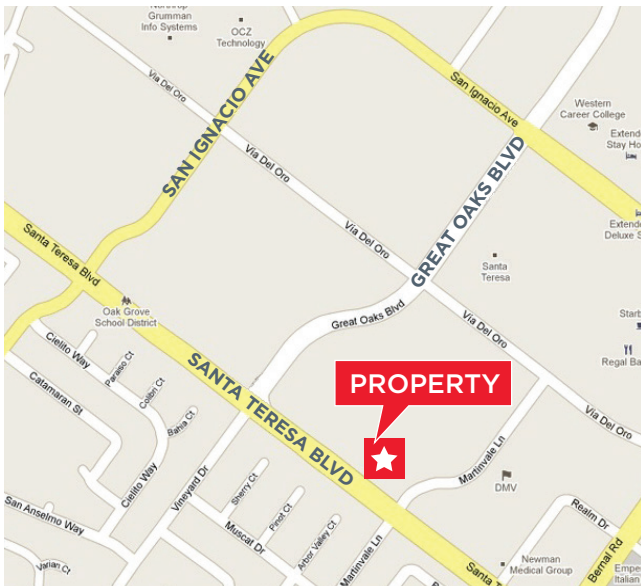

PROPERTY HIGHLIGHTS:

- Abundant Glassline
- 100% Heating Ventilation & Air Conditioning
- Office Area Includes 10' Ceilings & 9' Doors w/ 2' Sidelights
- Manufacturing Area Includes HVAC, VCT Flooring, Skylights & Painted Walls
- 200 Amps @ 120/208 Volt, 3-Phase
- High Identity Building on Santa Teresa Boulevard
- Grade Level Loading Door
- \$1.80 PSF NNN + (\$0.49 PSF NNN's)
- LED July 31, 2026
- Direct Lease with Landlord Available
- **PLEASE CONTACT LISTING BROKER TO TOUR**
- **DO NOT DISTURB TENANT**

±3,447 SF
R&D Flex Space

For more information, contact:

Kevin Sweatt
Senior Director
P +1 408 436 3644
kevin.sweatt@cushwake.com
LIC #00966186

300 Santana Row, Fifth Floor
San Jose, CA 95128

T +1 408 615 3400
www.cushmanwakefield.com

FOR SUBLEASE

6872 Santa Teresa Boulevard

San Jose, California



FLOOR PLAN: $\pm 3,447$ SF

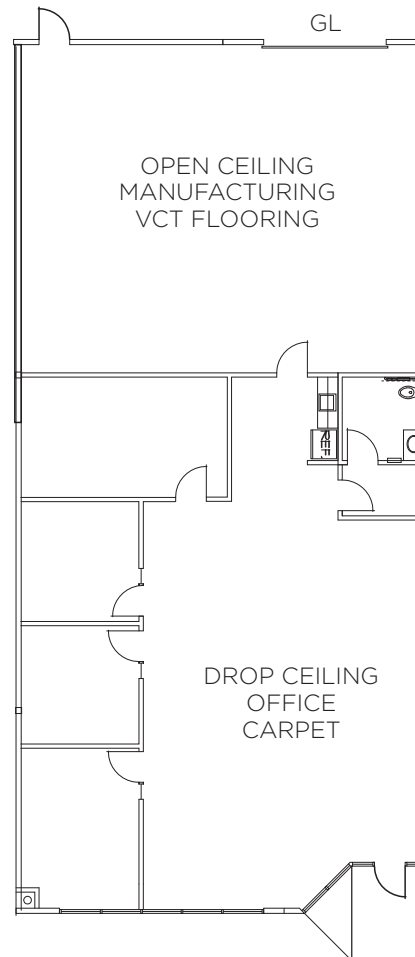

NOT TO SCALE

For more information, please contact:

Kevin Sweatt
Senior Director
P +1 408 436 3644
kevin.sweatt@cushwake.com
LIC #00966186

300 Santana Row, Fifth Floor
San Jose, CA 95128
T +1 408 615 3400
www.cushmanwakefield.com

FOR SUBLEASE

6872 Santa Teresa Boulevard

San Jose, California



SITE PLAN:

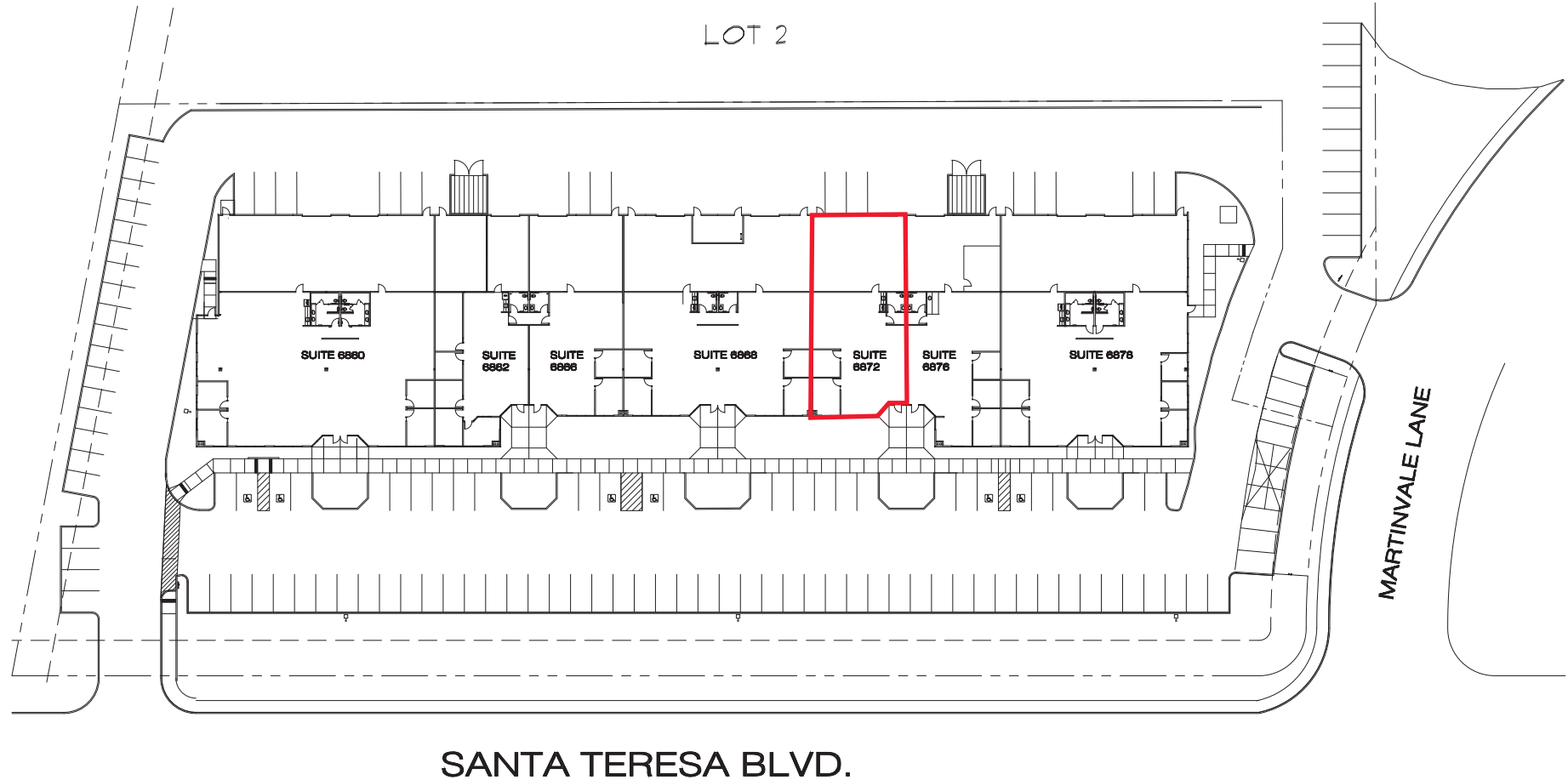

For more information, please contact:

Kevin Sweatt
Senior Director
P +1 408 436 3644
kevin.sweatt@cushwake.com
LIC #00966186

300 Santana Row, Fifth Floor
San Jose, CA 95128
T +1 408 615 3400
www.cushmanwakefield.com

FOR SUBLEASE

6872 Santa Teresa Boulevard

San Jose, California

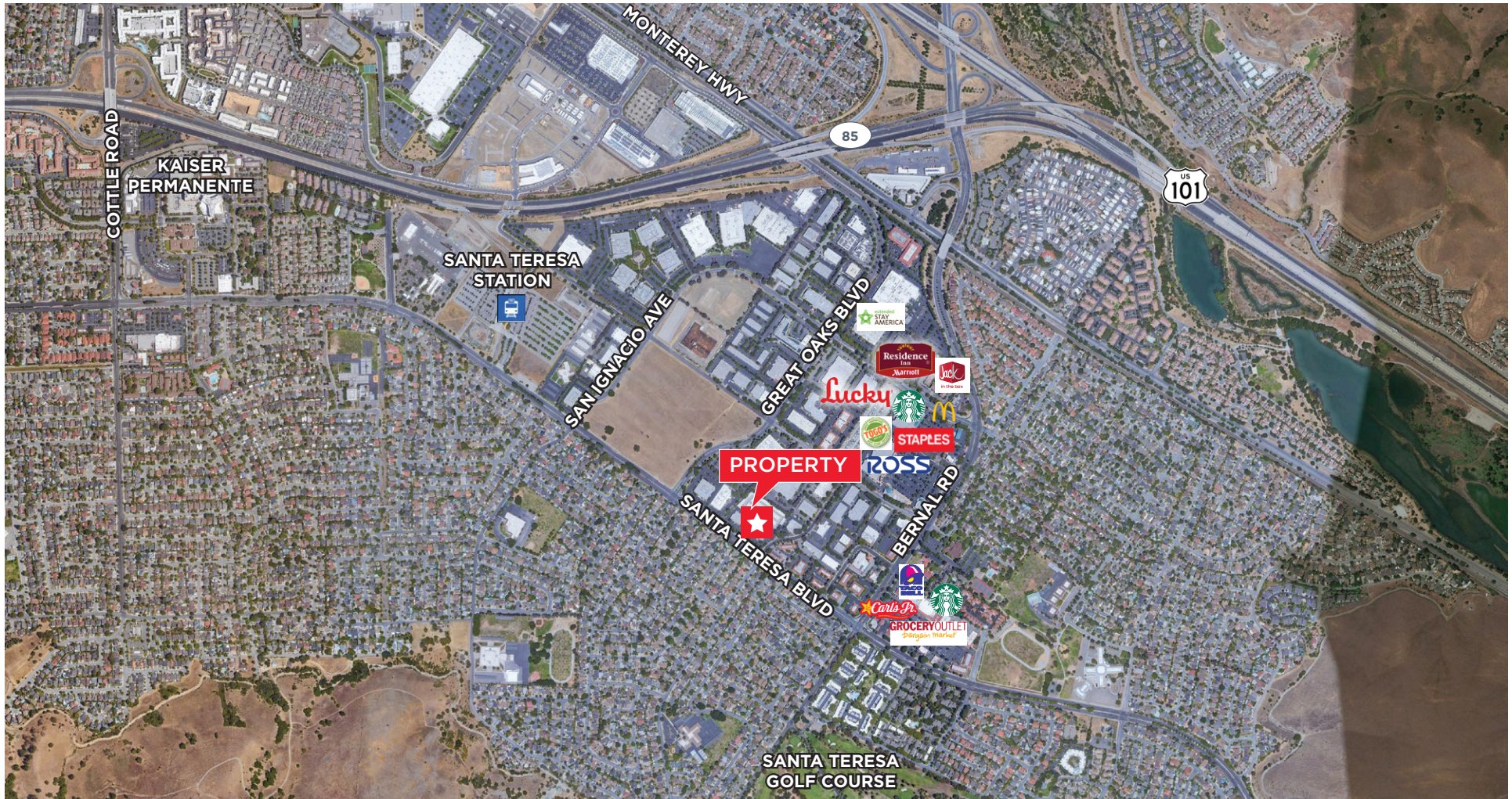

For more information, please contact:

Kevin Sweatt
Senior Director
P +1 408 436 3644
kevin.sweatt@cushwake.com
LIC #00966186

300 Santana Row, Fifth Floor
San Jose, CA 95128
T +1 408 615 3400
www.cushmanwakefield.com