



**CUSHMAN &
WAKEFIELD**



FOR LEASE

**NATHAN 54
PLYMOUTH, MN**

22,036 - 29,901 SF FOR LEASE

3500 American Blvd W, Suite 200
Minneapolis, MN
Main +1 952 831 1000
cushmanwakefield.com

FOR LEASE

NATHAN 54

5400 Nathan Lane, Plymouth, Minnesota

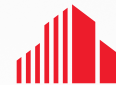

CUSHMAN &
WAKEFIELD



22,036 - 29,901 SF AVAILABLE - BOTH END CAPS

Property Highlights

- Beautifully designed office space
- Ample parking
- Located directly off a full interchange (169 & Bass Lake Road)
- Potential for office furniture to stay in Suite 100

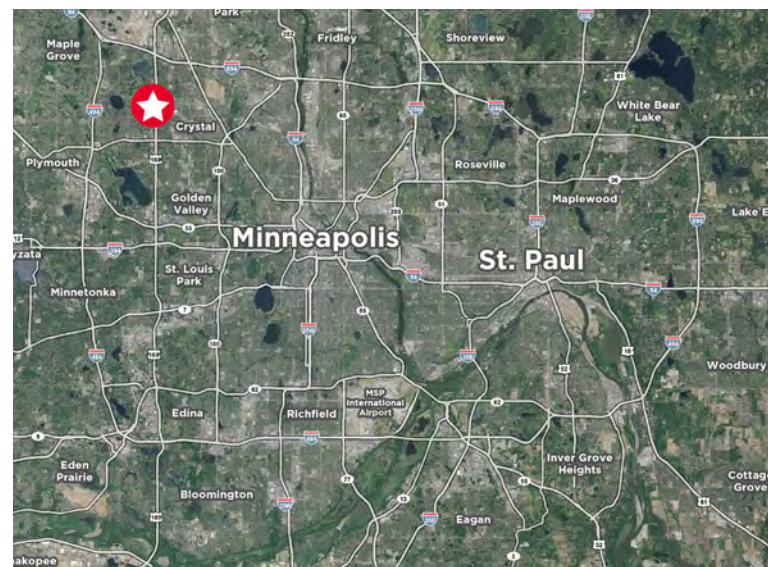

Contact

BRENT MASICA
Executive Managing Director
+1 952 893 8231
brent.masica@cushwake.com

DANNY MCNAMARA
Managing Director
+1 952 893 8895
danny.mcnamara@cushwake.com

JASON MEYER
Executive Director
+1 952 994 8918
jason.j.meyer@cushwake.com

FOR LEASE

NATHAN 54

5400 Nathan Lane, Plymouth, Minnesota

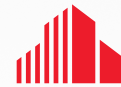

CUSHMAN &
WAKEFIELD

Building Features

BUILDING SIZE 72,089 SF

AVAILABLE SF 22,036 - 29,901 SF Total

AVAILABLE SF 22,036 - 29,901 SF Total

CLEAR HEIGHT 18'

POWER Heavy

2025 TAX/CAM \$6.83 psf Total

LOADING
Suite 100:
4 dock doors
3 van high doors
2 drive-in doors
Suite 150
3 dock doors

LEASE RATES Negotiable



©2025 Cushman & Wakefield. NO WARRANTY OR REPRESENTATION, EXPRESS OR IMPLIED, IS MADE TO THE ACCURACY OR COMPLETENESS OF THE INFORMATION CONTAINED HEREIN, AND SAME IS SUBMITTED SUBJECT TO ERRORS, OMISSIONS, CHANGE OF PRICE, RENTAL OR OTHER CONDITIONS, WITHDRAWAL WITHOUT NOTICE, AND TO ANY SPECIAL LISTING CONDITIONS IMPOSED BY THE PROPERTY OWNER(S). AS APPLICABLE, WE MAKE NO REPRESENTATION AS TO THE CONDITION OF THE PROPERTY (OR PROPERTIES) IN QUESTION.

Suite 100

AVAILABLE
JUNE 1, 2026

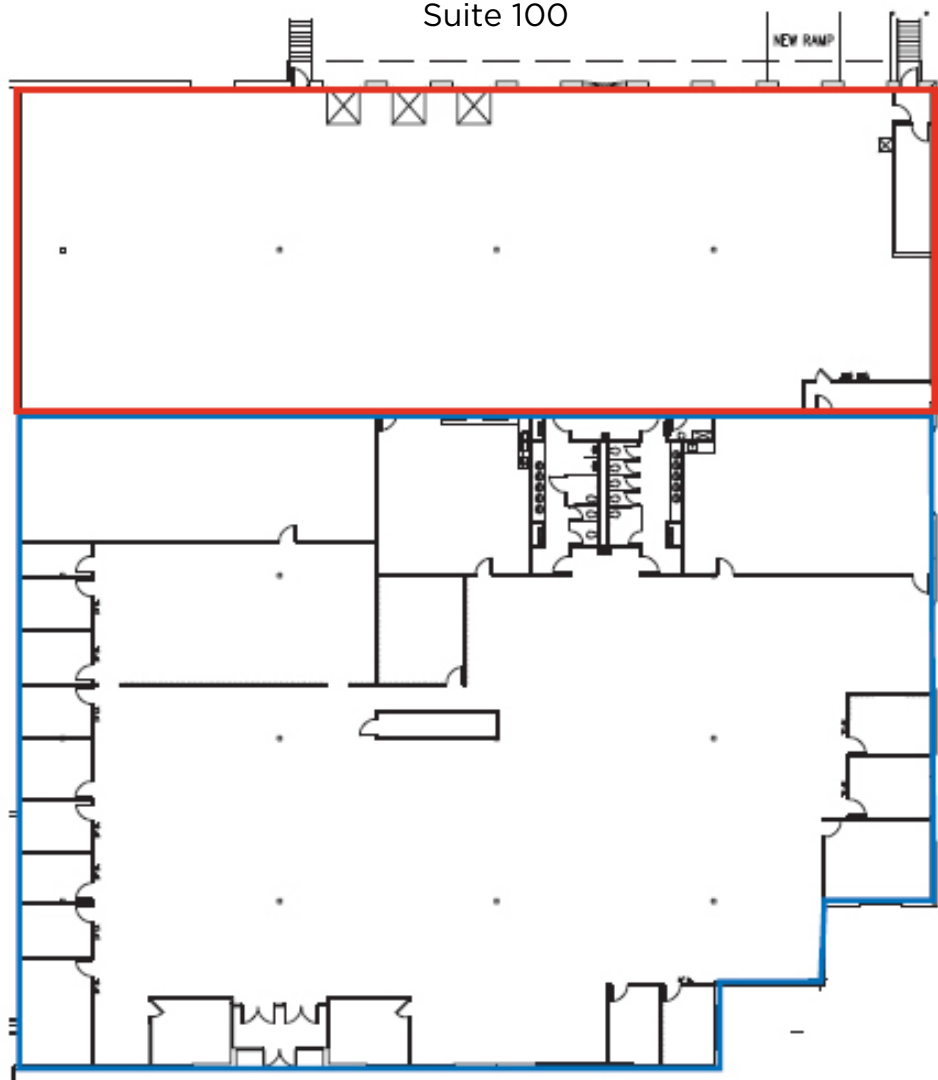

WAREHOUSE = 11,956 SF



OFFICE = 17,945 SF

4 DOCK DOORS
3 VAN HIGH DOORS
2 DRIVE-IN DOORS

Contact

BRENT MASICA
Executive Managing Director
+1 952 893 8231
brent.masica@cushwake.com

DANNY MCNAMARA
Managing Director
+1 952 893 8895
danny.mcnamara@cushwake.com

JASON MEYER
Executive Director
+1 952 994 8918
jason.j.meyer@cushwake.com

Suite 150- Available June 1, 2026

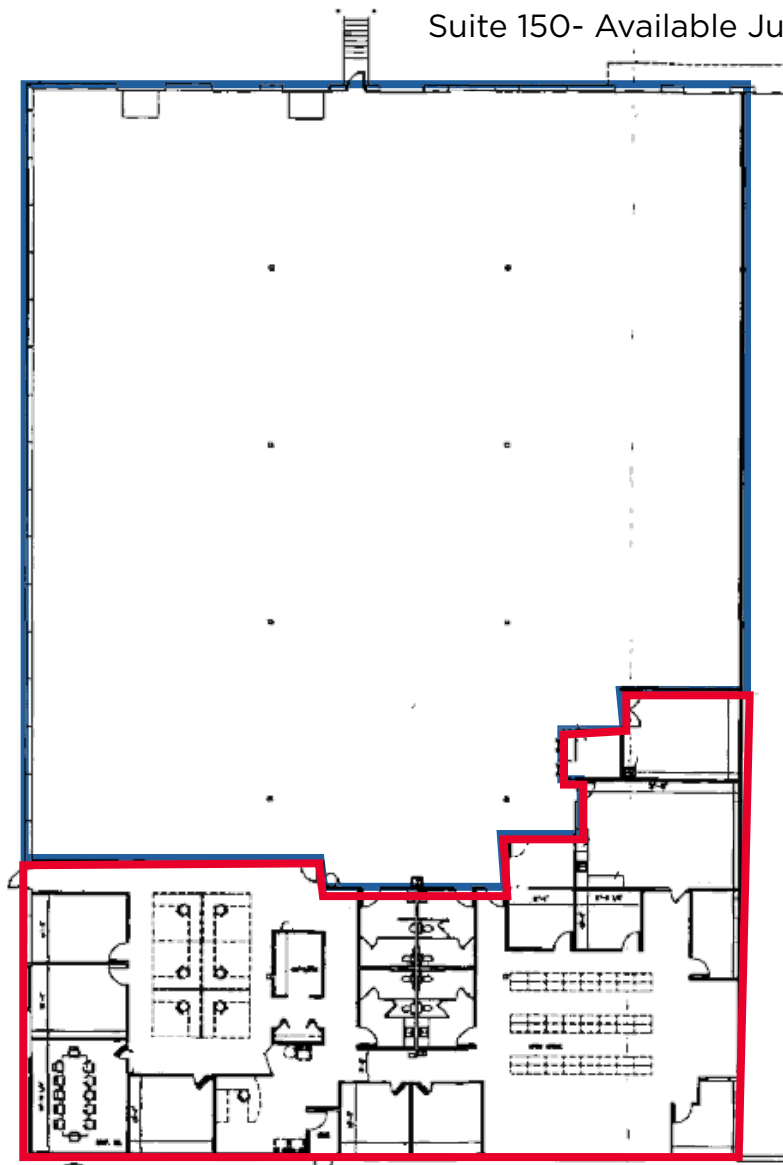

WAREHOUSE = 15,638 SF



OFFICE = 6,398 SF

3 DOCK DOORS
100% A/C
HEAVY POWER

Contact

BRENT MASICA
Executive Managing Director
+1 952 893 8231
brent.masica@cushwake.com

DANNY MCNAMARA
Managing Director
+1 952 893 8895
danny.mcnamara@cushwake.com

JASON MEYER
Executive Director
+1 952 994 8918
jason.j.meyer@cushwake.com