

540

PEDRICKTOWN ROAD SWEDESBORO, NEW JERSEY

FOR LEASE



IMMEDIATE ROUTE 322 & I-295 ACCESS

108,000 SF

AVAILABLE

 **Invesco**

John Gartland
Executive Managing Director
+1 856 403 9535
john.gartland@cushwake.com

Sean Duncan
Senior Associate
+1 610 484 4793
sean.duncan@cushwake.com

 **CUSHMAN &
WAKEFIELD**

Cushman & Wakefield Copyright 2025. No warranty or representation, express or implied, is made to the accuracy or completeness of the information contained herein, and same is submitted subject to errors, omissions, change of price, rental or other conditions, withdrawal without notice, and to any special listing conditions imposed by the property owner(s). As applicable, we make no representation as to the condition of the property (or properties) in question.

SITE SPECIFICATIONS

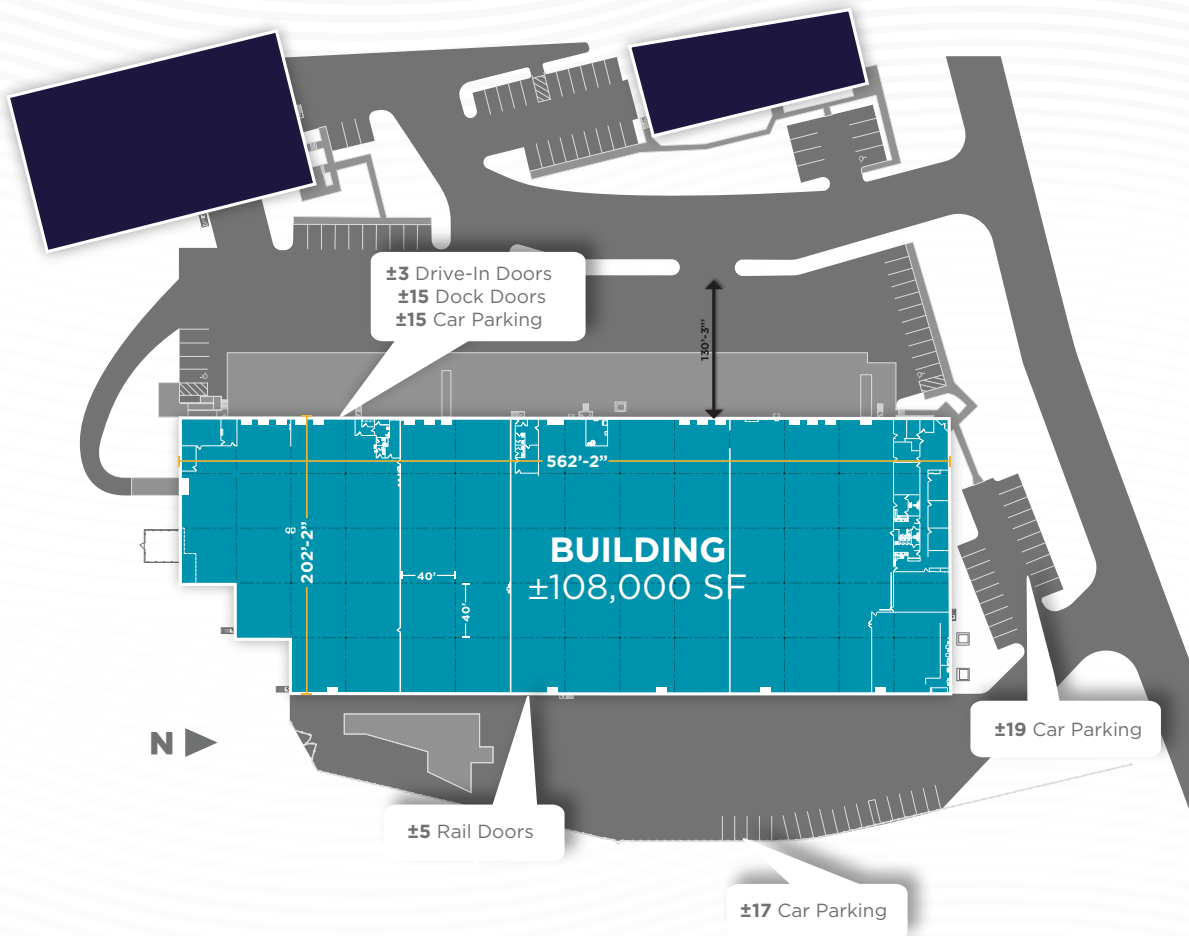

LEASABLE AREA:

108,000 SF

BUILDING DIMENSIONS:

202'-2" x 562'

OFFICE SF:

11,122 SF

COLUMN SPACING:

40' x 40'

DOCK DOORS:

15 Doors

DRIVE-IN DOORS:

3 Doors

CLEAR HEIGHT:

24'

POWER:

2000 amps, 3 phase,
480/277 volt

FIRE PROTECTION:

Wet System

AUTO PARKING:

51 Spaces

RAIL DOORS:



5 Doors



MAJOR CITIES

PHILADELPHIA, PA	20 MILES	20 MINS
NEW YORK, NY	110 MILES	1 HR 55 MINS
WASHINGTON DC	115 MILES	2 HRS

INTERSTATES

	1.0 MILES	3 MINS
	3.0 MILES	5 MINS
	6.0 MILES	12 MINS



Invesco



CUSHMAN & WAKEFIELD

John Gartland

Executive Managing Director
+1 856 403 9535
john.gartland@cushwake.com

Sean Duncan

Senior Associate
+1 610 484 4793
sean.duncan@cushwake.com