



FOR LEASE | 3,050 SF WITH 0.31 ACRES OF YARD

3450 - 48 AVENUE SE

CALGARY, AB



**CUSHMAN &
WAKEFIELD**

3450 - 48 AVENUE SE

CALGARY, AB

Property Details

District:	Golden Triangle
Zoning:	I-G (Industrial General)
Ceiling Height:	22' 11"
Heating:	Radiant in warehouse; HVAC in office

Lease Particulars

Available Area:	± 3,050 sf
Office Area:	± 1,250 sf (second floor)
Warehouse Area:	± 1,800 sf
Yard Area:	± 13,550 sf (0.31 acres)
Loading:	1 (14' x 14') drive-in door
Asking Rate:	\$15.00 psf
Op. Costs:	\$10.81 psf (2025 est.)
Available:	March 1, 2026

Comments

- Fenced, paved and gated yard area
- Main floor warehouse and second floor office
- Good access onto Peigan Trail, Barlow Trail and 52nd Street SE



3450 - 48 AVENUE SE
CALGARY, AB

Floor Plan

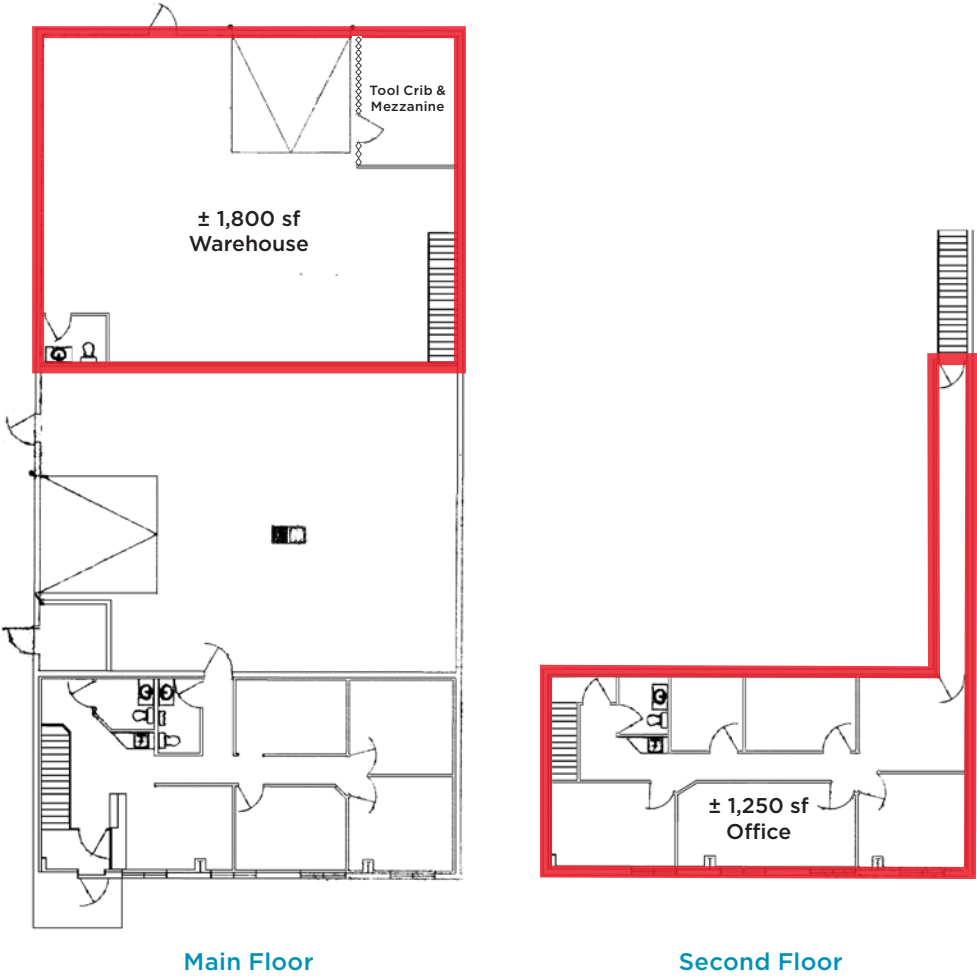

*Not to scale, not exactly as shown.



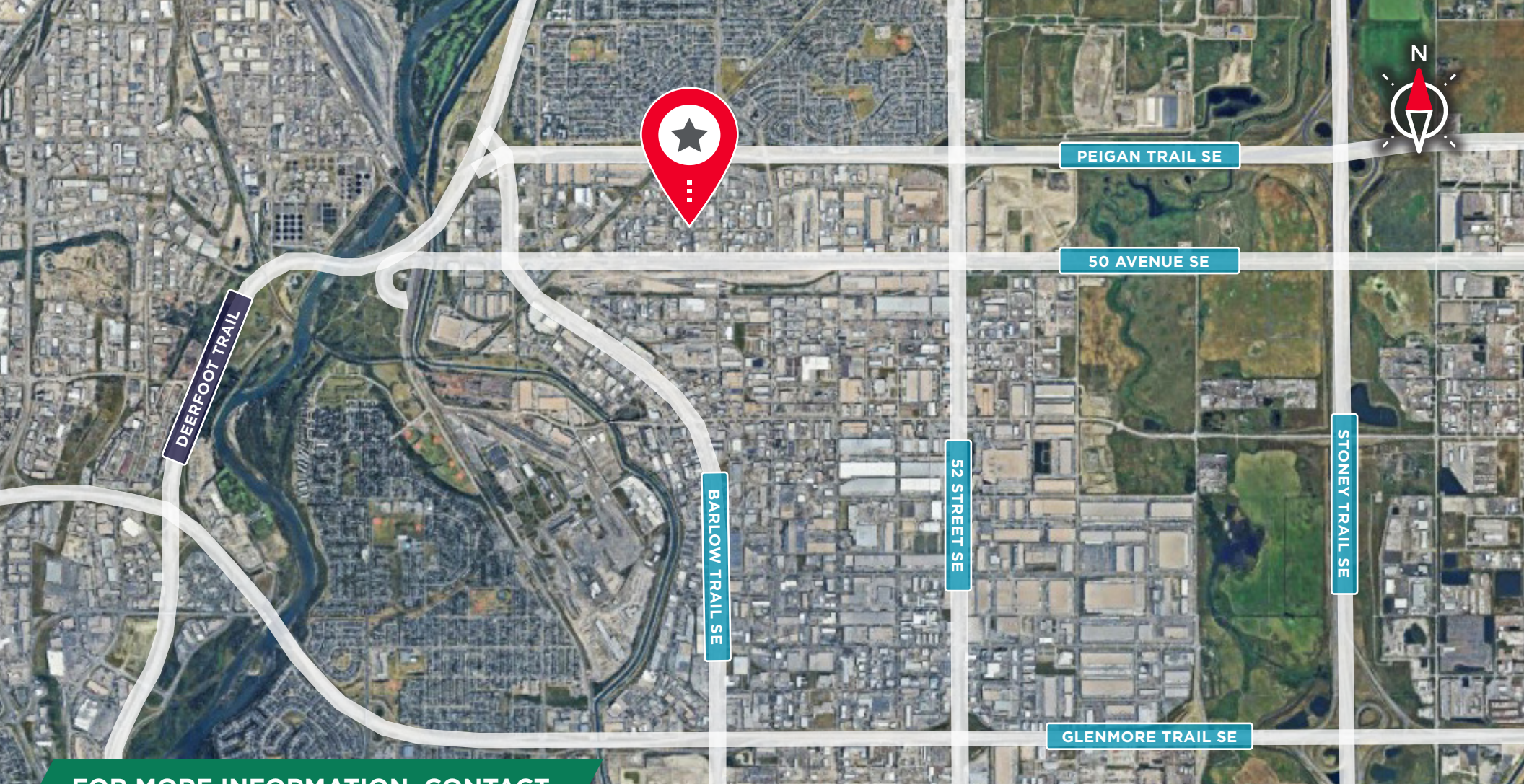

FOR MORE INFORMATION, CONTACT

SEAN FERGUSON
Associate Vice President
Industrial Sales & Leasing
+1 403 615 1893
sean.ferguson@cushwake.com

ALAN FARLEY
Associate Vice President
Industrial Sales & Leasing
+1 403 797 5024
alan.farley@cushwake.com

Cushman & Wakefield ULC
Bow Valley Square IV
250 - 6th Ave SW, Suite 2400
Calgary, AB T2P 3H7
cushmanwakefield.com

©2025 Cushman & Wakefield. All rights reserved. The information contained in this communication is strictly confidential. This information has been obtained from sources believed to be reliable but has not been verified. NO WARRANTY OR REPRESENTATION, EXPRESS OR IMPLIED, IS MADE AS TO THE CONDITION OF THE PROPERTY (OR PROPERTIES) REFERENCED HEREIN OR AS TO THE ACCURACY OR COMPLETENESS OF THE INFORMATION CONTAINED HEREIN, AND SAME IS SUBMITTED SUBJECT TO ERRORS, OMISSIONS, CHANGE OF PRICE, RENTAL OR OTHER CONDITIONS, WITHDRAWAL WITHOUT NOTICE, AND TO ANY SPECIAL LISTING CONDITIONS IMPOSED BY THE PROPERTY OWNER(S). ANY PROJECTIONS, OPINIONS OR ESTIMATES ARE SUBJECT TO UNCERTAINTY AND DO NOT SIGNIFY CURRENT OR FUTURE PROPERTY PERFORMANCE.

