



FOR LEASE

30450 Whipple Road

Alvarado Business Park | Union City, California



Property Highlights

- ±13,481 SF
- ±650 SF Office
- Clear Height: 24' Minimum
- Two (2) Dock High Doors
- Sprinklers: ±0.33 GPM/3,000 SF
- Column Spacing: ±24' x ±60' (±226' Depth)
- High Image Business Park
- Close Proximity to I-880
- Available May 2026 (Possibly Sooner)

Call Broker For Rate & Touring Instructions

ALVARADO BUSINESS PARK is a 10 building 1.2 million square foot business park with close access to I-880 and HWY 92 offering solutions for today and expansion for future growth.

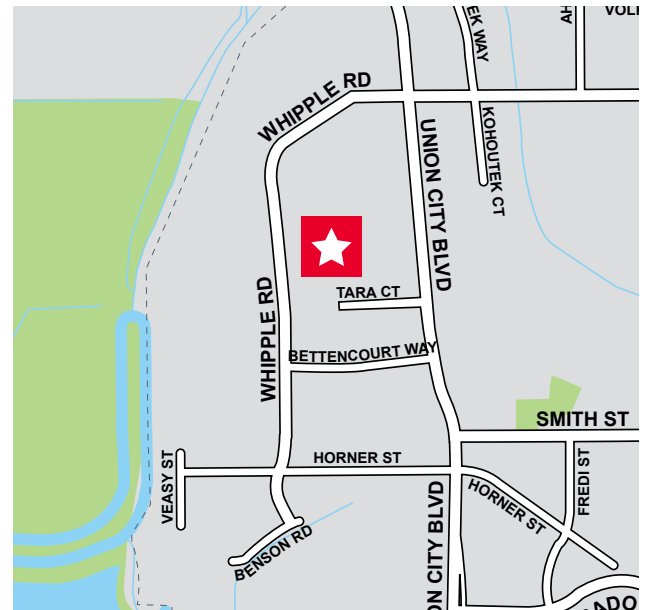

Jeff Starkovich, SIOR
Executive Managing Director
+1 510 409 1111
jeff.starkovich@cushwake.com
LIC #00644571 | cushmanwakefield.com



Mark Maguire
Executive Vice President
+1 510 433 5835
mark.maguire@colliers.com
LIC #01190597 | www.colliers.com



Floor Plan

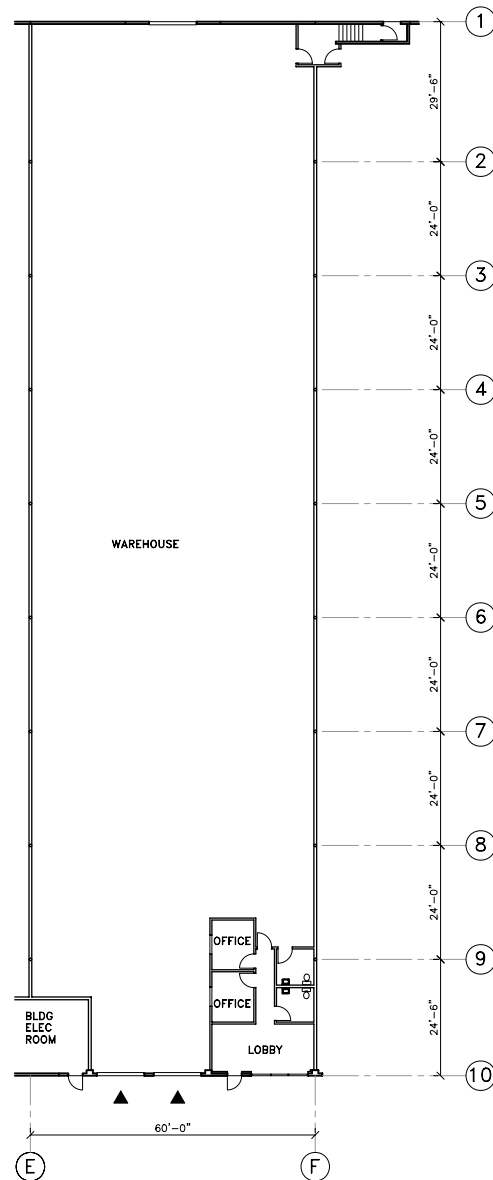

Jeff Starkovich, SIOR
Executive Managing Director
+1 510 409 1111
jeff.starkovich@cushwake.com
LIC #00644571 | cushmanwakefield.com



**CUSHMAN &
WAKEFIELD**

Mark Maguire
Executive Vice President
+1 510 433 5835
mark.maguire@colliers.com
LIC #01190597 | www.colliers.com

