



CUSHMAN &
WAKEFIELD

FOR LEASE

COMMERCE PARK DISTRIBUTION CENTER #3

1212 N 39th St.
Tampa, FL 33605



AVAILABLE 9/1/2020

COMMERCE PARK DISTRIBUTION CENTER #3

1212 N 39th St. Tampa, FL 33605



PROPERTY HIGHLIGHTS

- Suite #300 available 9/1/2020
- 10,665 SF W/ Approx. 2,247 SF Office Space
- 3 Dock High Doors, 2 Van High Doors, 1 Drive In Ramp
- 18' Clear Height
- 150' Shared Truck Court
- 90' Approximate Building Depth
- Fully Sprinklered
- Concrete Tilt-Up Construction with Aggregate Finish
- Located off of Adamo Dr. (SR 60) and Visible from the Selmon Expressway
- Proximity to US Hwy 41 and Interstate 4



Suite 300

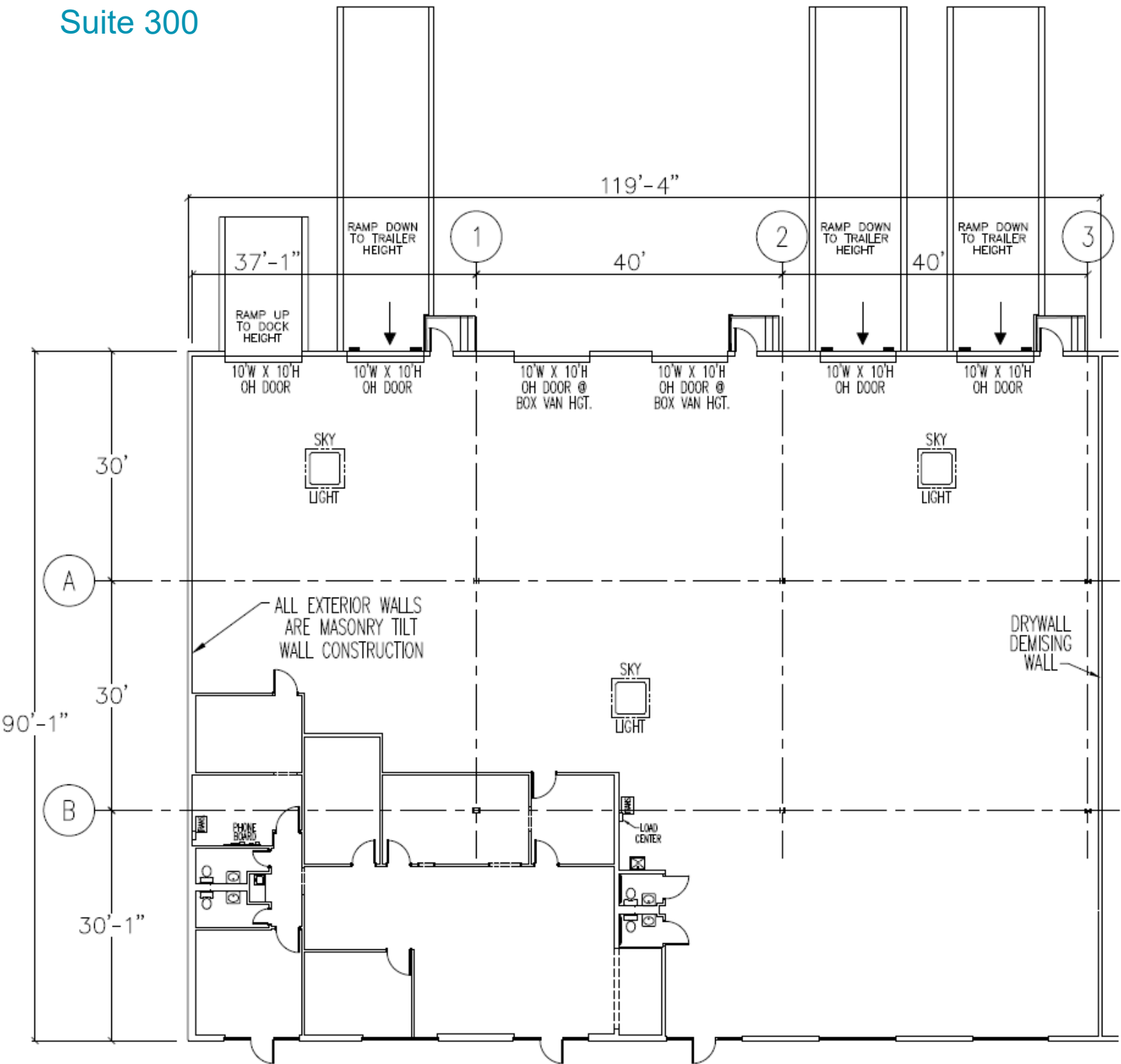

FOR ADDITIONAL INFORMATION, PLEASE CONTACT:

LISA ROSS, SIOR

Senior Director
+1 813 424 3211
lisa.ross@cushwake.com

TREY CARSWELL, SIOR

Senior Director
+1 813 204 5314
trey.carswell@cushwake.com

One Tampa City Center
Suite 3300
Tampa, FL 33602
cushmanwakefield.com

