

4300 OLD GREENSBORO ROAD

WINSTON SALEM, NC 27101



4300 Old Greensboro Road | Winston Salem, NC 27101

Available For Lease $\pm 25,315$ - $\pm 65,625$ SF

Jason Ofsanko
Executive Director
+1 336 812 3300
jason.ofsanko@cushwake.com

Jordan Mitchell
Senior Director
+1 336 201 0495
jordan.mitchell@cushwake.com



PROPERTY OVERVIEW

| | |
|----------------------------|-------------------|
| CLEAR HEIGHT: | 28' |
| ADDITIONAL PARKING: | 29 Parking Spaces |
| NEW SPEC OFFICE: | ± 3,160 SF |
| DOCK DOORS: | Six (6) |
| GRADE-LEVEL: | One (1) |
| DRIVE-IN RAMP: | Two (2) |

| | |
|-------------------------|---------------------------|
| SPRINKLERS: | ESFR |
| POWER: | 400 amps, 3-Phase |
| COLUMN SPACING: | 25'x50' |
| TRUCK COURT: | Fenced & Secured |
| OUTSIDE STORAGE: | Available |
| PAVED PARKING: | 1 additional lot complete |

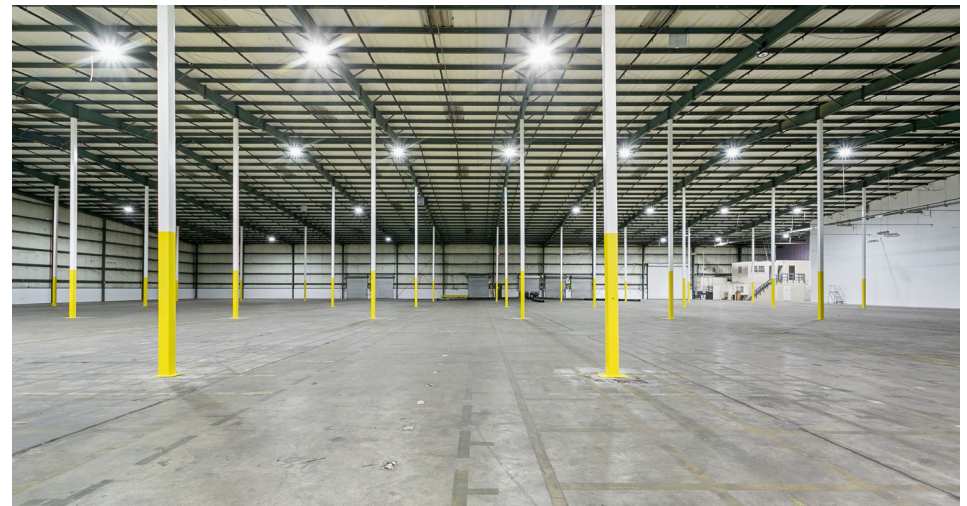

FLOORPLAN

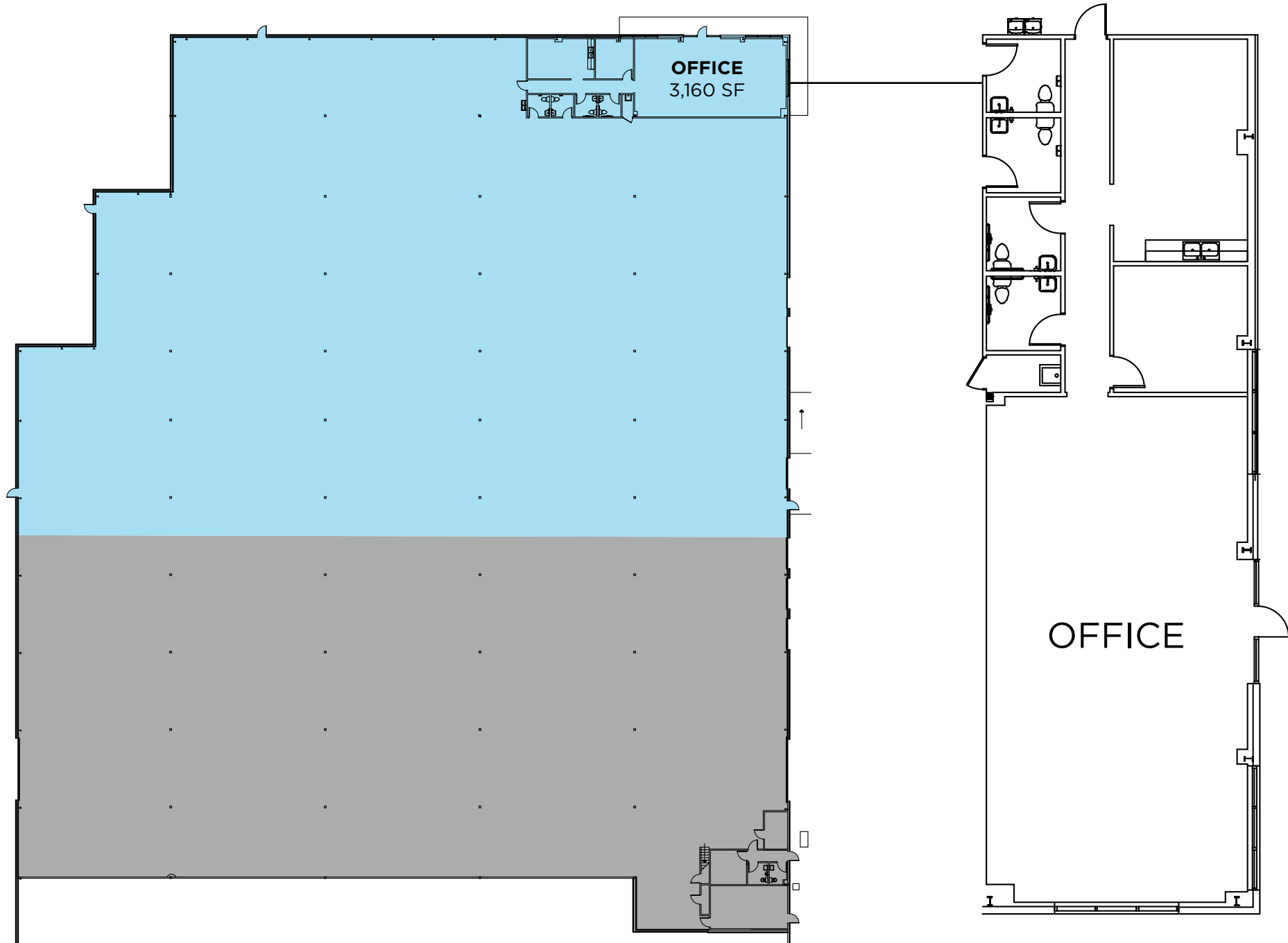

OUTSIDE STORAGE AVAILABLE



NEARBY NEIGHBORS



Greensboro
24 Miles

EXPREZIT



Wheeling Village

Winston Salem
5 Miles

MOUNTAIN STREET



NEW GREENSBORO ROAD



OLD GREENSBORO ROAD NE

4300 Old
Greensboro Road



DRIVE TIMES

I-40
10 min / 7.2 miles

I-840
27 min / 28.4 miles

I-73
18 min / 12.8 miles

PIEDMONT TRIAD INT'L AIRPORT
21 min / 19 miles

I-85
35 min / 31.6 miles

DOWNTOWN GREENSBORO
26 min / 24.1 miles

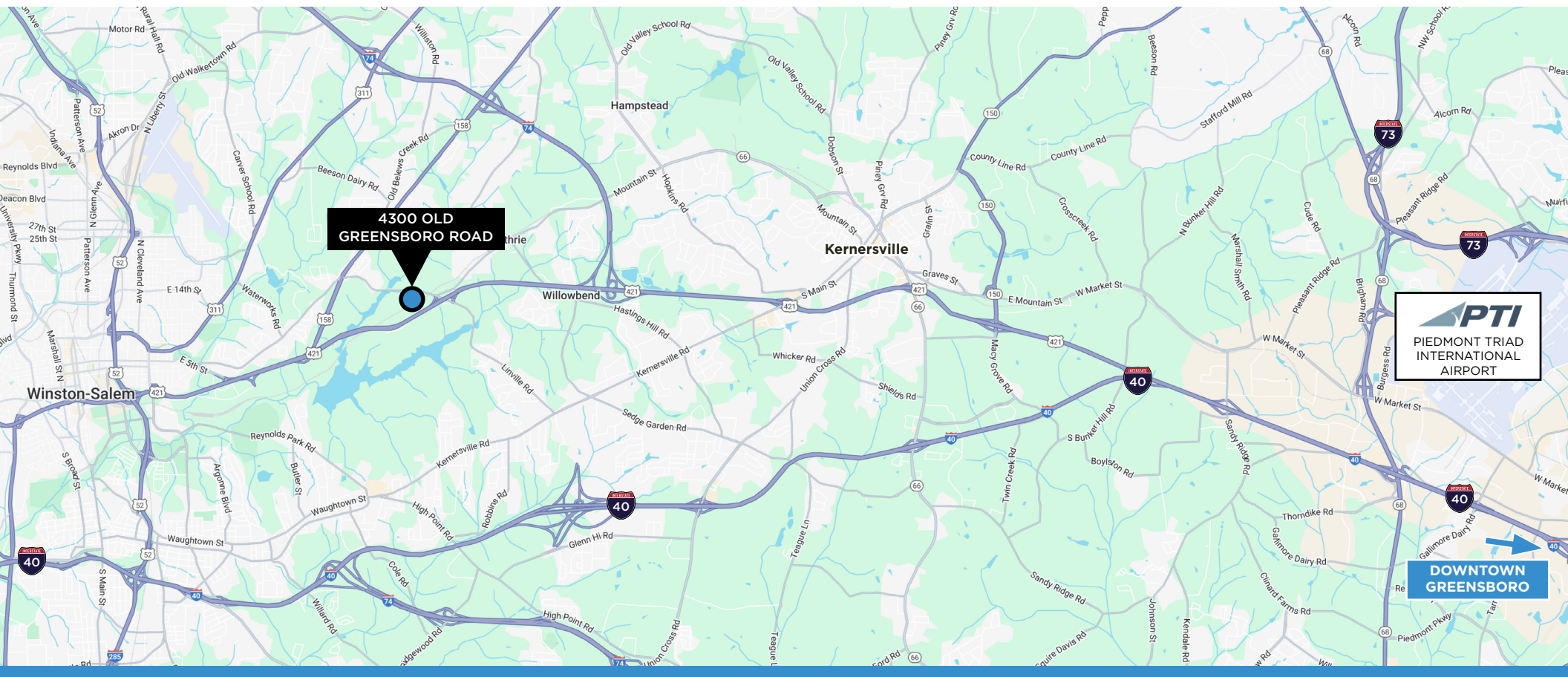

4300 OLD GREENSBORO ROAD

WINSTON SALEM, NC 27101



For More Information, Please Contact:

Jason Ofsanko

Executive Director

+1 336 812 3300

jason.ofsanko@cushwake.com

Jordan Mitchell

Senior Director

+1 336 201 0495

jordan.mitchell@cushwake.com



©2026 Cushman & Wakefield. All rights reserved. The information contained in this communication is strictly confidential. This information has been obtained from sources believed to be reliable but has not been verified. NO WARRANTY OR REPRESENTATION, EXPRESS OR IMPLIED, IS MADE AS TO THE CONDITION OF THE PROPERTY (OR PROPERTIES) REFERENCED HEREIN OR AS TO THE ACCURACY OR COMPLETENESS OF THE INFORMATION CONTAINED HEREIN, AND SAME IS SUBMITTED SUBJECT TO ERRORS, OMISSIONS, CHANGE OF PRICE, RENTAL OR OTHER CONDITIONS, WITHDRAWAL WITHOUT NOTICE, AND TO ANY SPECIAL LISTING CONDITIONS IMPOSED BY THE PROPERTY OWNER(S). ANY PROJECTIONS, OPINIONS OR ESTIMATES ARE SUBJECT TO UNCERTAINTY AND DO NOT SIGNIFY CURRENT OR FUTURE PROPERTY PERFORMANCE.