

16,800 SF AVAILABLE FOR LEASE

9743 KENT STREET

ELK GROVE, CA 95624



9743 KENT ST
Elk Grove, CA



PROPERTY HIGHLIGHTS

PROPERTY FEATURES

Building Size:	16,800 SF	Sprinkler:	Yes	Year Built:	2016
Warehouse Area:	13,800 SF	Power:	277a/480v 3p	Parking:	20 Surface Spaces
Office Area:	3,000 SF	Clear Height:	16'	Zoning:	M-1
Site Area:	0.96 AC	Loading Doors:	5 GL (10'x16')	Lease Rate:	\$1.10/SF NNN

* Available with 30 days notice * Small Secured Fenced Yard * Drive Through Capability



FLOOR PLAN

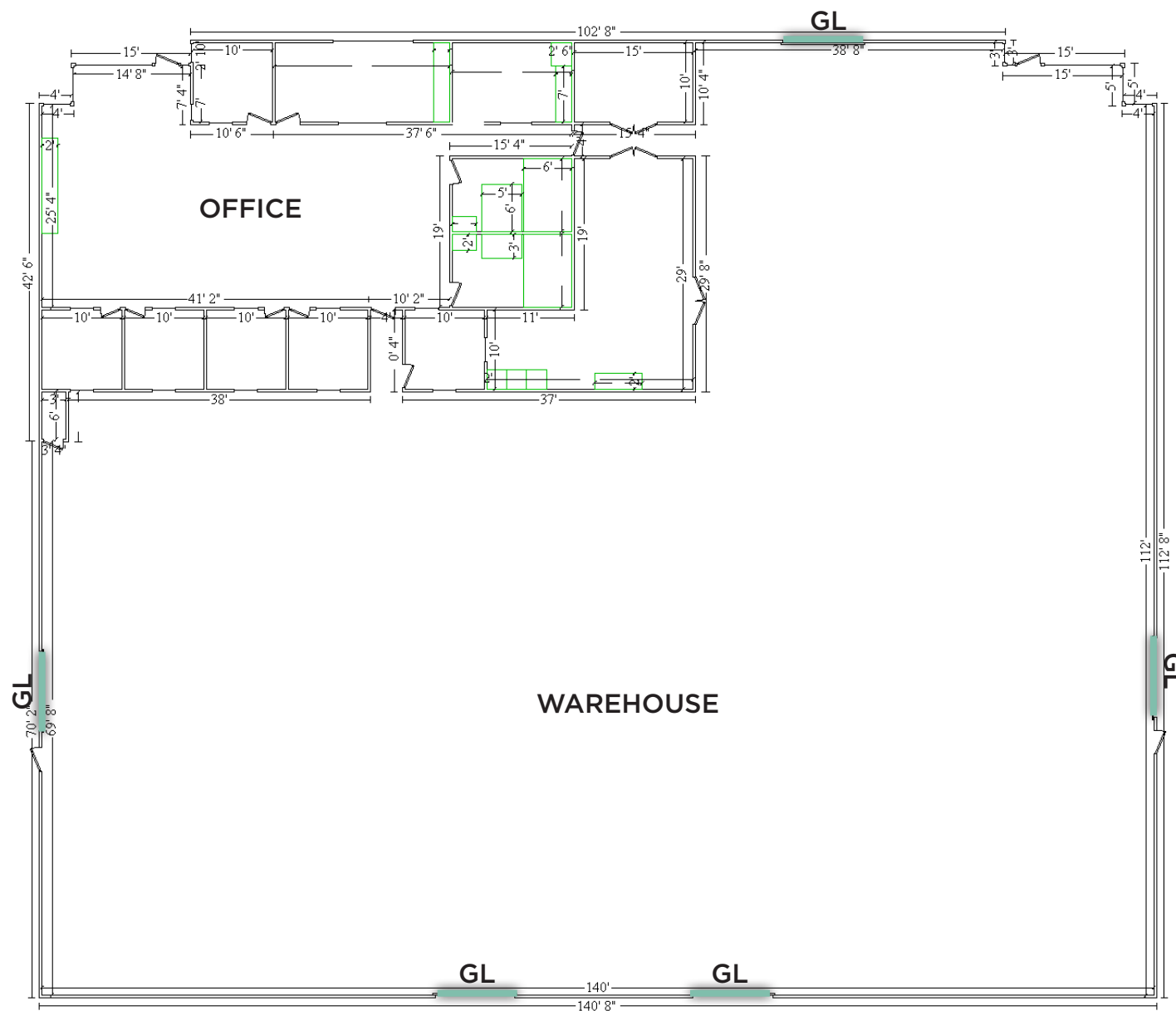

9743 KENT ST Elk Grove, CA



PROPERTY HIGHLIGHTS

Positioned in one of Elk Grove's most accessible industrial corridors, 9743 Kent St offers a versatile opportunity for businesses seeking functional space with excellent regional connectivity. This well-located property features a practical layout ideal for warehousing, light manufacturing, logistics, or service-oriented operations. With convenient access to major routes—including Hwy 99 and I-5—tenants benefit from efficient distribution throughout the Sacramento region and beyond.

SITE MAP

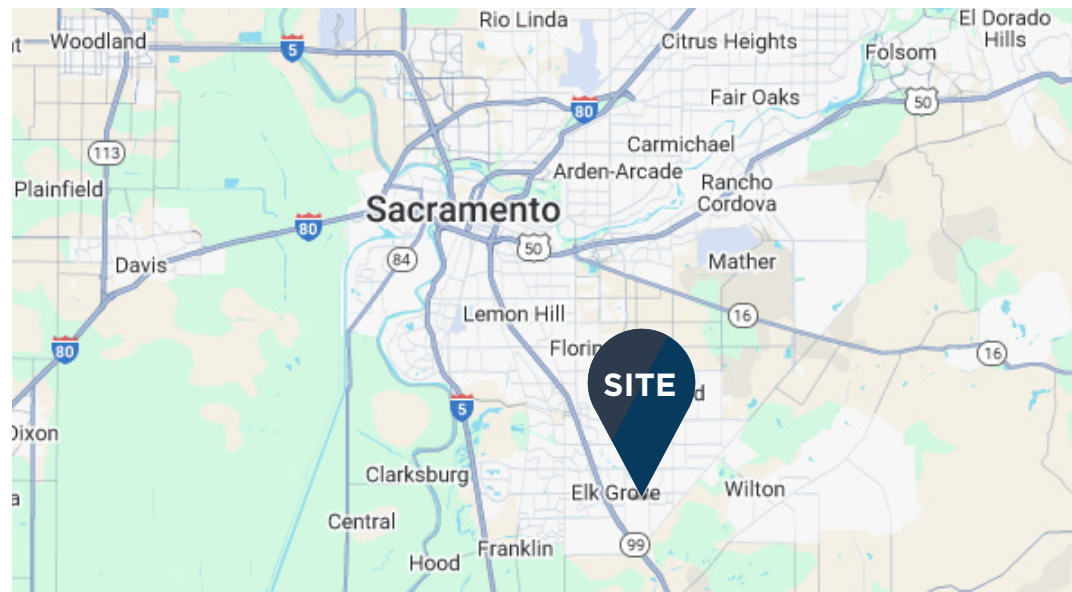



FOR MORE INFORMATION, CONTACT:

LENNY GOLD

Director

+1 916 288 4443

lenny.gold@cushwake.com

CA LIC# 02055534

BRYCE MACDONALD

Executive Director

+1 916 288 4806

bryce.macdonald@cushwake.com

CA LIC# 01422174



**CUSHMAN &
WAKEFIELD**

400 Capitol Mall, Suite 1800
Sacramento, CA 95814
main +1 916 288 4800
cushmanwakefield.com

©2025 Cushman & Wakefield. All rights reserved. The information contained in this communication is strictly confidential. This information has been obtained from sources believed to be reliable but has not been verified. NO WARRANTY OR REPRESENTATION, EXPRESS OR IMPLIED, IS MADE AS TO THE CONDITION OF THE PROPERTY (OR PROPERTIES) REFERENCED HEREIN OR AS TO THE ACCURACY OR COMPLETENESS OF THE INFORMATION CONTAINED HEREIN, AND SAME IS SUBMITTED SUBJECT TO ERRORS, OMISSIONS, CHANGE OF PRICE, RENTAL OR OTHER CONDITIONS, WITHDRAWAL WITHOUT NOTICE, AND TO ANY SPECIAL LISTING CONDITIONS IMPOSED BY THE PROPERTY OWNER(S). ANY PROJECTIONS, OPINIONS OR ESTIMATES ARE SUBJECT TO UNCERTAINTY AND DO NOT SIGNIFY CURRENT OR FUTURE PROPERTY PERFORMANCE.