

# 40737

**ENCYCLOPEDIA CIRCLE**

FREMONT, CALIFORNIA

**YOUR NAME  
HERE**

**For Sublease  
±81,485 SF**



**CUSHMAN &  
WAKEFIELD**



# // PROPERTY FEATURES

-  SUBLEASE THROUGH **8/30/28**
-  **22-24'** CLEAR HEIGHT
-  **±16,000** OFFICE SPACE
-  **1 DH & 6 GL** DOORS
-  **2,000A @ 277/480V** POWER
-  **213** PARKING SPACES
-  **I-T** ZONING
-  **.495 GPM/2,000** SPRINKLERS
-  **EASY ACCESS** TO FREEWAYS
-  **IMMEDIATE PROXIMITY** TO RETAIL AMENITIES

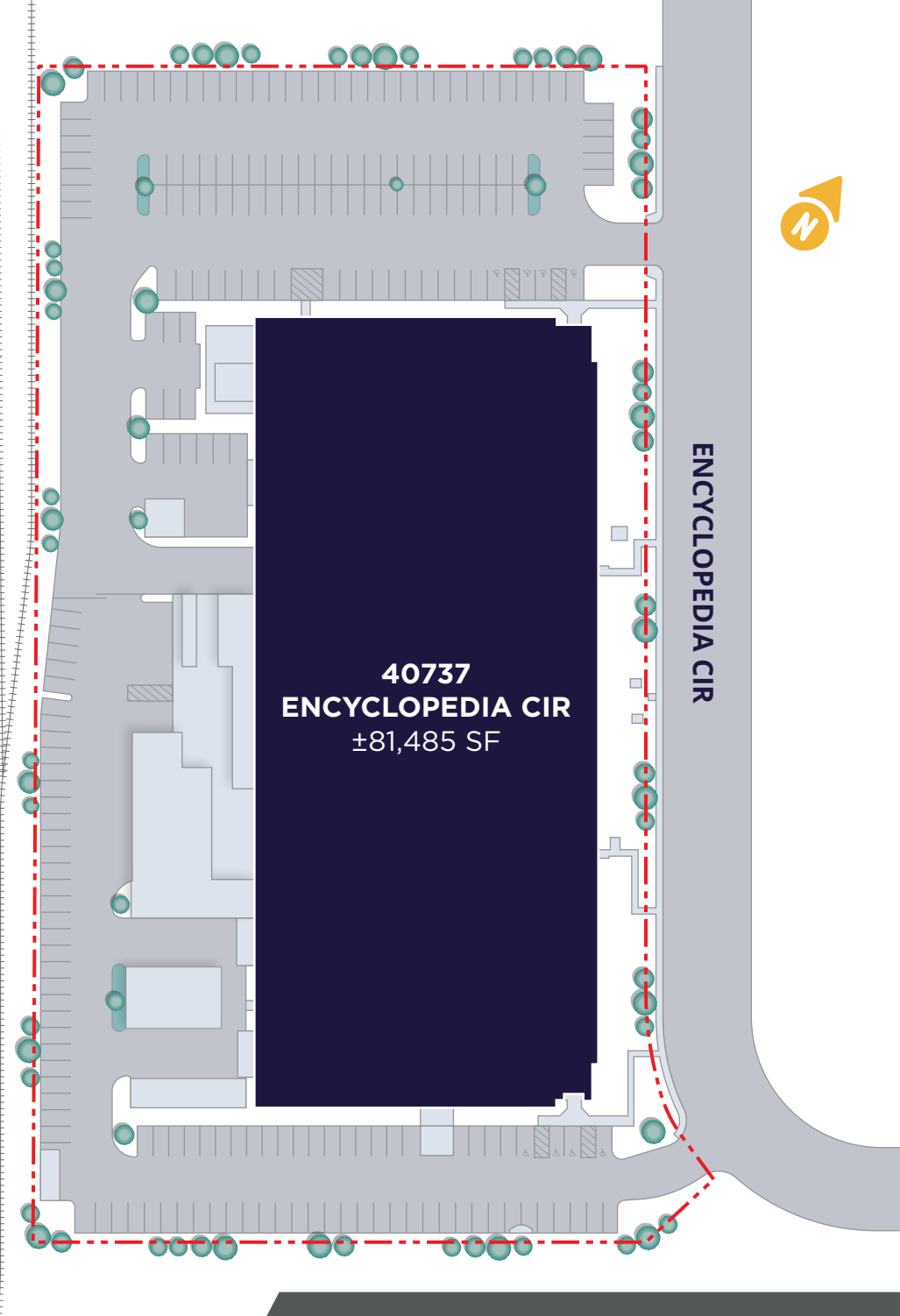

**40737 ENCYCLOPEDIA CIRCLE**  
Fremont, California

# // FLOOR PLAN

- 6 GL plus 1 DH doors
- ISO 7 (Clean Room)
- 22-24ft Clear Height
- 2,000 Amps 277/480V
- 2 Separate Office Areas
- Secure Fenced Yard/Outdoor Storage
- Skylights
- Building and Monument Signage

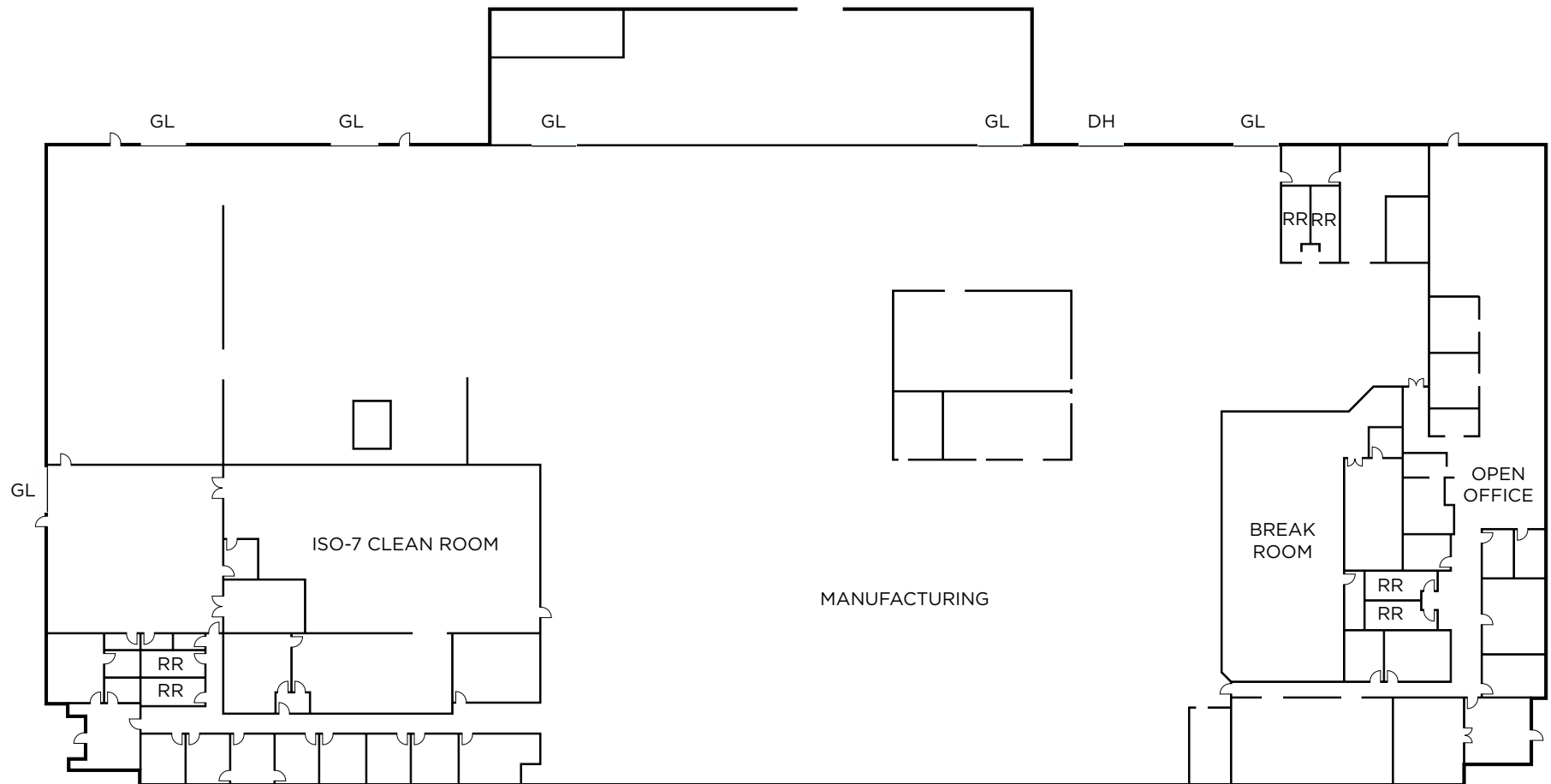



## // AREA AMENITIES



# 40737

## ENCYCLOPEDIA CIRCLE

### FREMONT, CALIFORNIA



#### CONTACT

WALT STEPHENSON  
Executive Director  
+1 408 615 3458  
walt.stephenson@cushwake.com  
Lic. #01793438

JACOB BIDER  
Senior Associate  
+1 408 572 4138  
jacob.bider@cushwake.com  
Lic. #02110355

©2025 Cushman & Wakefield. All rights reserved. The information contained in this communication is strictly confidential. This information has been obtained from sources believed to be reliable but has not been verified. NO WARRANTY OR REPRESENTATION, EXPRESS OR IMPLIED, IS MADE AS TO THE CONDITION OF THE PROPERTY (OR PROPERTIES) REFERENCED HEREIN OR AS TO THE ACCURACY OR COMPLETENESS OF THE INFORMATION CONTAINED HEREIN, AND SAME IS SUBMITTED SUBJECT TO ERRORS, OMISSIONS, CHANGE OF PRICE, RENTAL OR OTHER CONDITIONS, WITHDRAWAL WITHOUT NOTICE, AND TO ANY SPECIAL LISTING CONDITIONS IMPOSED BY THE PROPERTY OWNER(S). ANY PROJECTIONS, OPINIONS OR ESTIMATES ARE SUBJECT TO UNCERTAINTY AND DO NOT SIGNIFY CURRENT OR FUTURE PROPERTY PERFORMANCE.