

BUILDING 300-LIBERTY PARK

IRREPLACEABLE OWNER USER OFFICE BUILDING



300 NE GILMAN BLVD | ISSAQUAH, WA

AVAILABLE FOR SALE

6,022 RSF
AVAILABLE FOR
OCCUPANCY

ASKING PRICE
\$3,800,000



BUILDING FEATURES



BUILDING 300 - LIBERTY PARK

Address	300 NE Gilman Blvd
Building Size	6,022 RSF
Lot Size (per King County)	17,151 Square Feet
Floors	One (1) plus basement/parking/storage
Year Built	1986
Construction Type	Wood frame
Occupancy	100% Lease includes 6 month termination clause
Parking	18 stalls (3.0/1,000 RSF) 12 surface and 6 garage – plus shared parking

BUILDING 300 | SITEPLAN

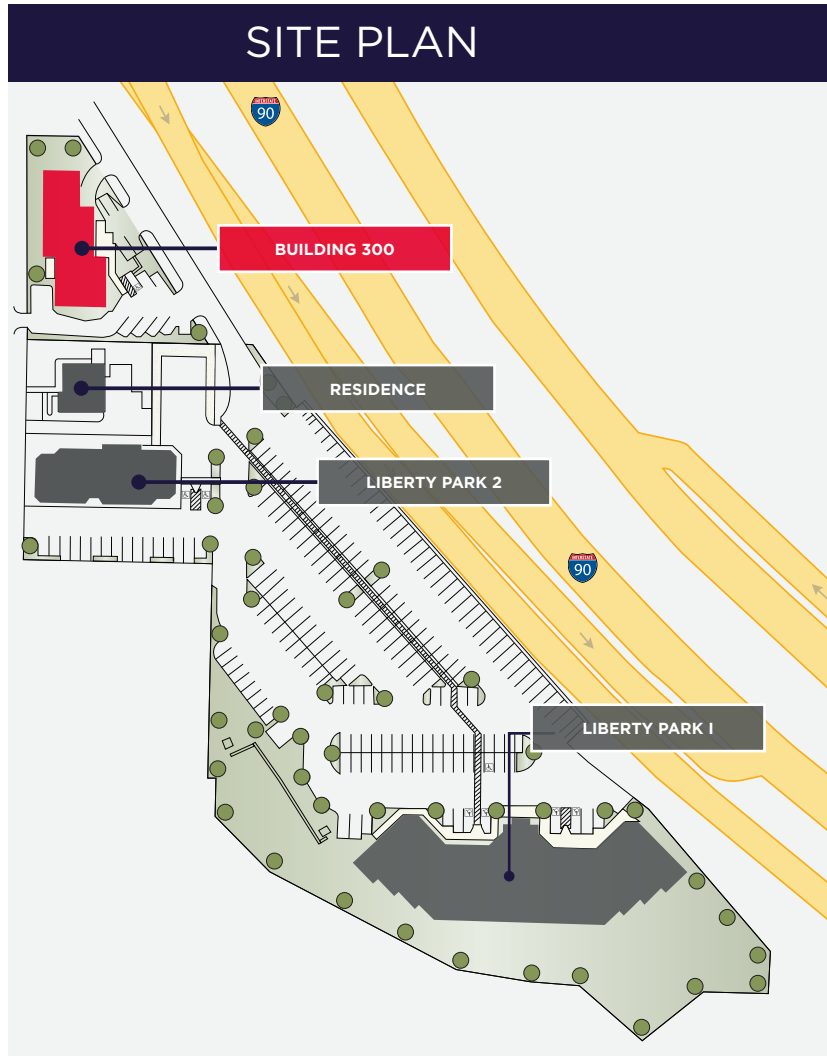

FLOOR 1

TOTAL | 5,251 RSF

Suite #	Rentable Area
SUITE 101	1,817 SF
SUITE 102	2,390 SF
SUITE 103	1,044 SF

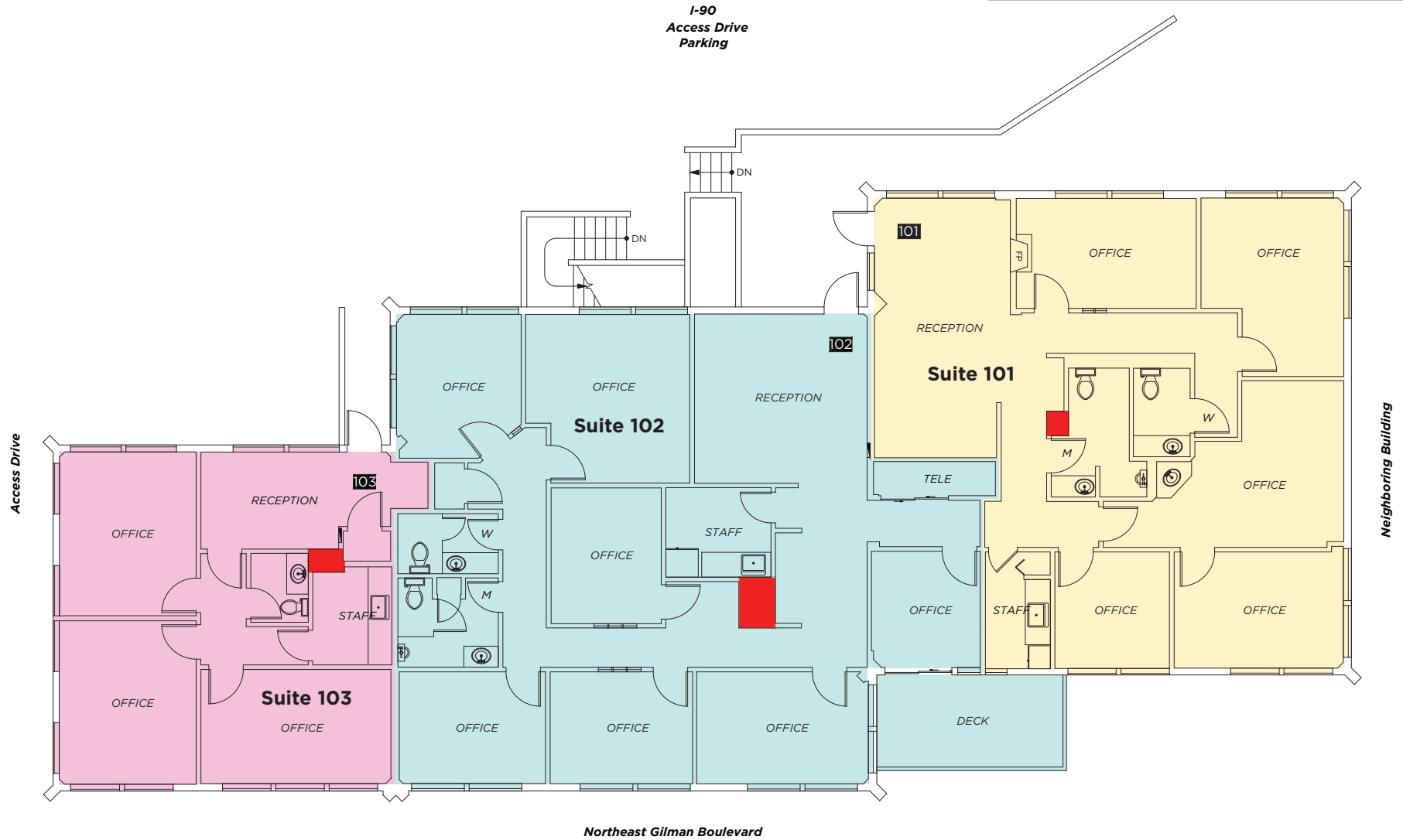

GARAGE

TOTAL | 2,143 RSF

Suite #	Rentable Area
STORAGE A	558 SF
STORAGE B	211 SF
PARKING	2,143 SF

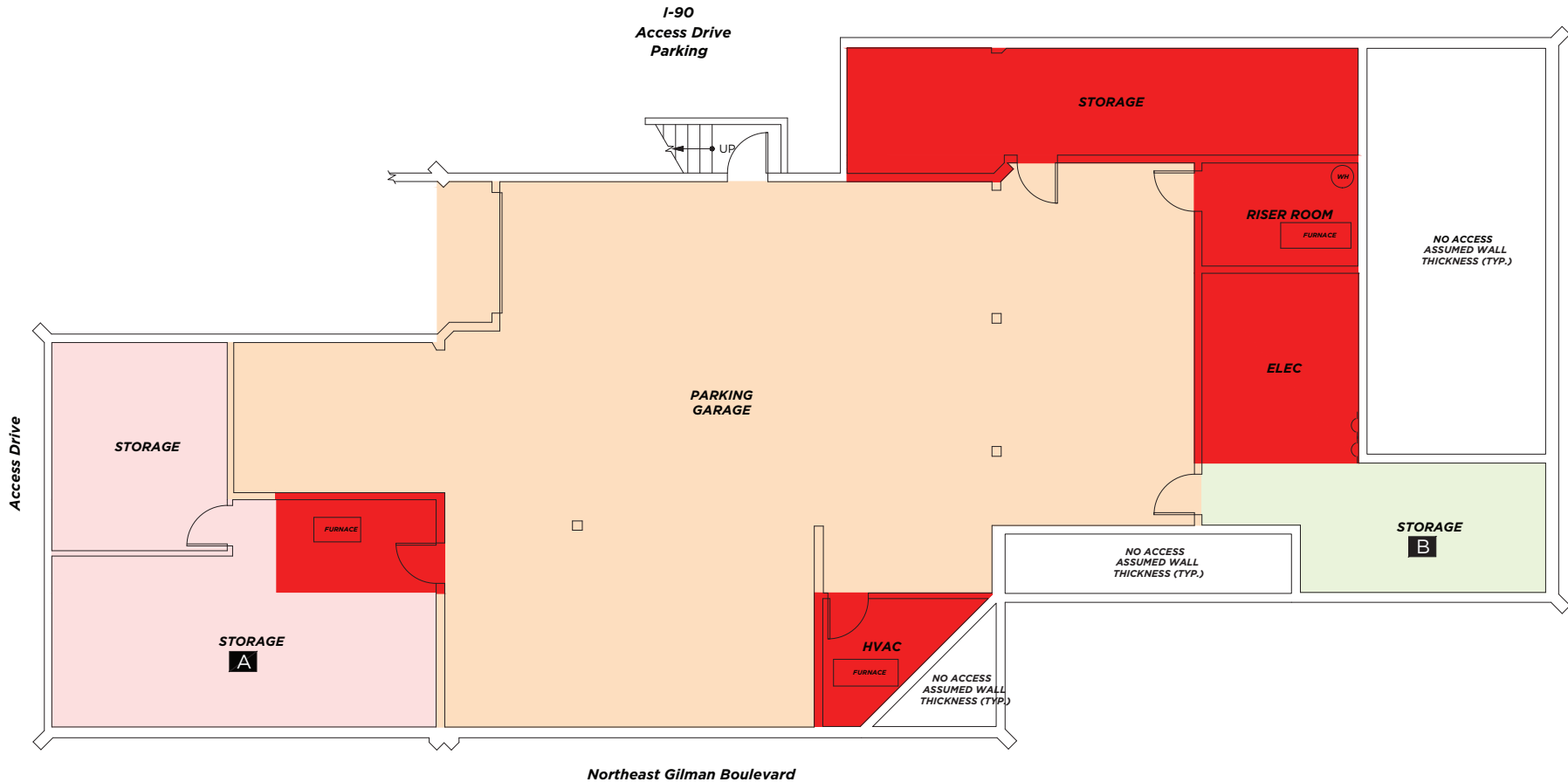

LOCATION HIGHLIGHTS

EASY ACCESS TO TOP RATED AMENITIES

ISSAQUAH HIGHLANDS

SWEDISH MEDICAL GROUP
575,000 SF

BUILDING 300 LIBERTY PARK

HISTORIC DOWNTOWN ISSAQUAH

ISSAQUAH COMMONS

GLOBAL HEADQUARTERS
COSTCO WHOLESALE
5,000 EMPLOYEES

LAKE SAMMAMISH CENTER

BIG LOTS!

425 FITNESS

ISSAQUAH TRANSIT CENTER

Target, **MREI CO-OP**, **TRADER JOE'S**, **SAFeway**, **POTBELLY SANDWICH SHOP**, **petco**, **BED BATH & BEYOND**, **Panera BREAD**, **Starbucks**, **SEPHORA**, **FedEx Office**, **CHIPOTLE MEXICAN GRILL**, **ROSS DRESS FOR LESS**, **ME Massage Envy**, **Bath & Body Works**

BEST BUY, **Fred Meyer**, **PANDA EXPRESS**, **QDOBA MEXICAN EATS**, **Krispy Kreme DOUGHNUTS**, **THE HONEY DIP**, **Jamba**, **Starbucks**, **AT&T**, **indigo URGENT CARE**, **Walgreens**

LOWE'S, **WU**, **HOBBY LOBBY**

COSTCO WHOLESALE, **PET SMART**, **QFC Quality Food Centers**, **Shell**

Michaels, **MREI CO-OP SATELLITE OFFICE**

BUILDING 300-LIBERTY PARK

300 NE GILMAN BLVD | ISSAQUAH, WA



BRIAN TOY

Director
+1 425 985 6706
Brian.Toy@cushwake.com

DAN CHHAN

Managing Director
+1 206 321 2047
Dan.Chhan@cushwake.com

Cushman & Wakefield | 11235 SE 6th Street | Suite 200 | Bellevue, WA 98004