



FOR LEASE / 27,734 SF / MAIN STREET FRONTAGE

642 DENISON STREET
MARKHAM, ON



642 DENISON STREET

MARKHAM, ON

BUILDING SPECS



Total Premises Size: 27,734 SF

Office Area: 4,000 SF (est.)

Warehouse Area: 23,734 SF

Warehouse Clear Height: 15 FT

Shipping Facilities: 4 Truck Level Doors
Can be expanded an additional 3 doors

Asking Net Rent: \$19.95 PSF

TMI: \$4.59 PSF (2025)

Occupancy: Available April 1, 2026

Position your business at the heart of one of Markham's most recognized commercial corridors. 642 Denison Street is a rarely offered size and location right in the middle of this vibrant retail and service focused street.

The property is ideally suited for companies that manufacture, service, or distribute products while also selling directly to the public, benefiting from a surrounding mix of complementary, retail-oriented businesses. Strong daily traffic flow provides excellent visibility, while ample street frontage allows for prominent signage and brand exposure.

The warehouse is equipped with energy-efficient LED lighting and closed flame heating, helping reduce operating costs. Well-provided rear loading facilities support efficient operations, deliveries, and logistics, offering a functional and highly visible business location.

642 DENISON STREET

MARKHAM, ON



MAIN STREET EXPOSURE



REAR SHIPPING AREA

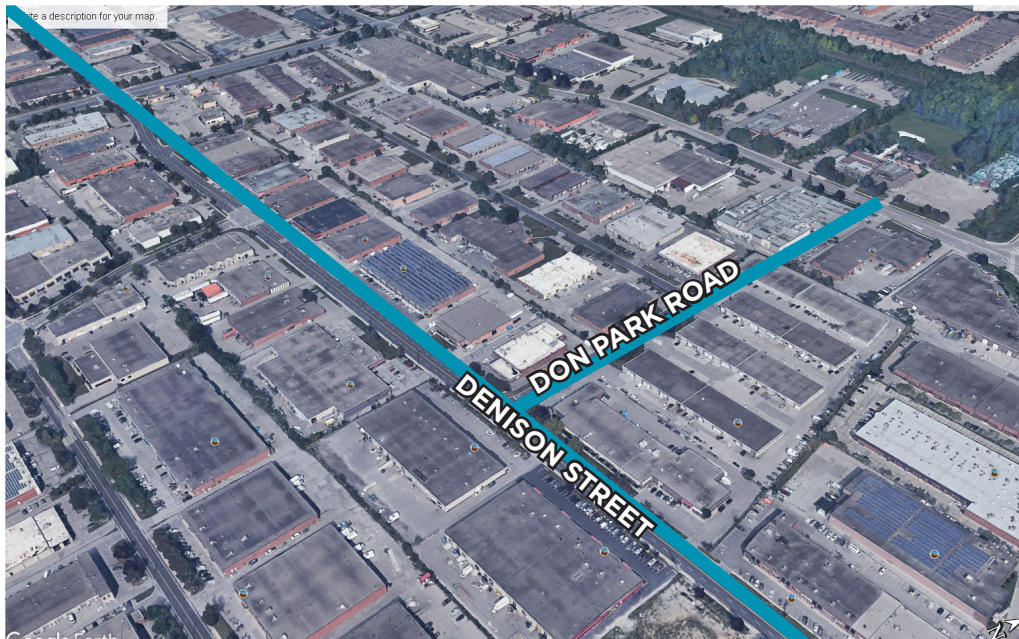

642 DENISON STREET MARKHAM, ON



FLOOR PLAN

(NOTE - INTERIOR PARTITIONS ARE NOT EXACT)

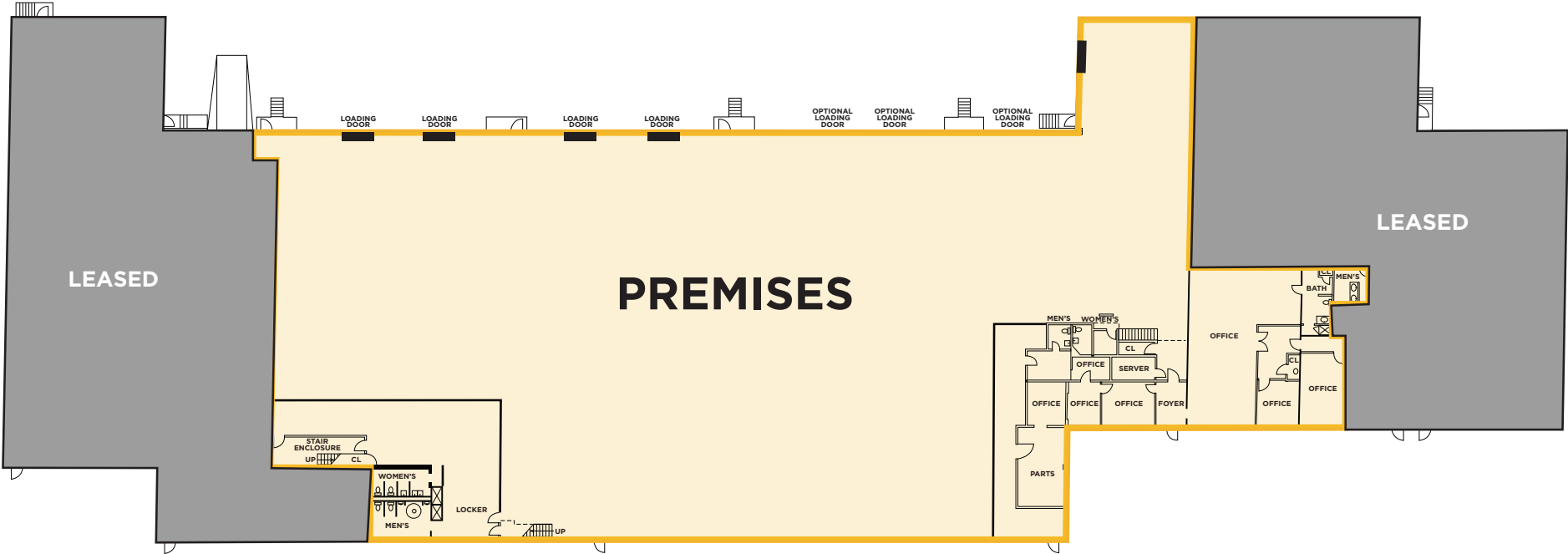

642 DENISON STREET

MARKHAM, ON



SITE PLAN AND PARKING PLAN

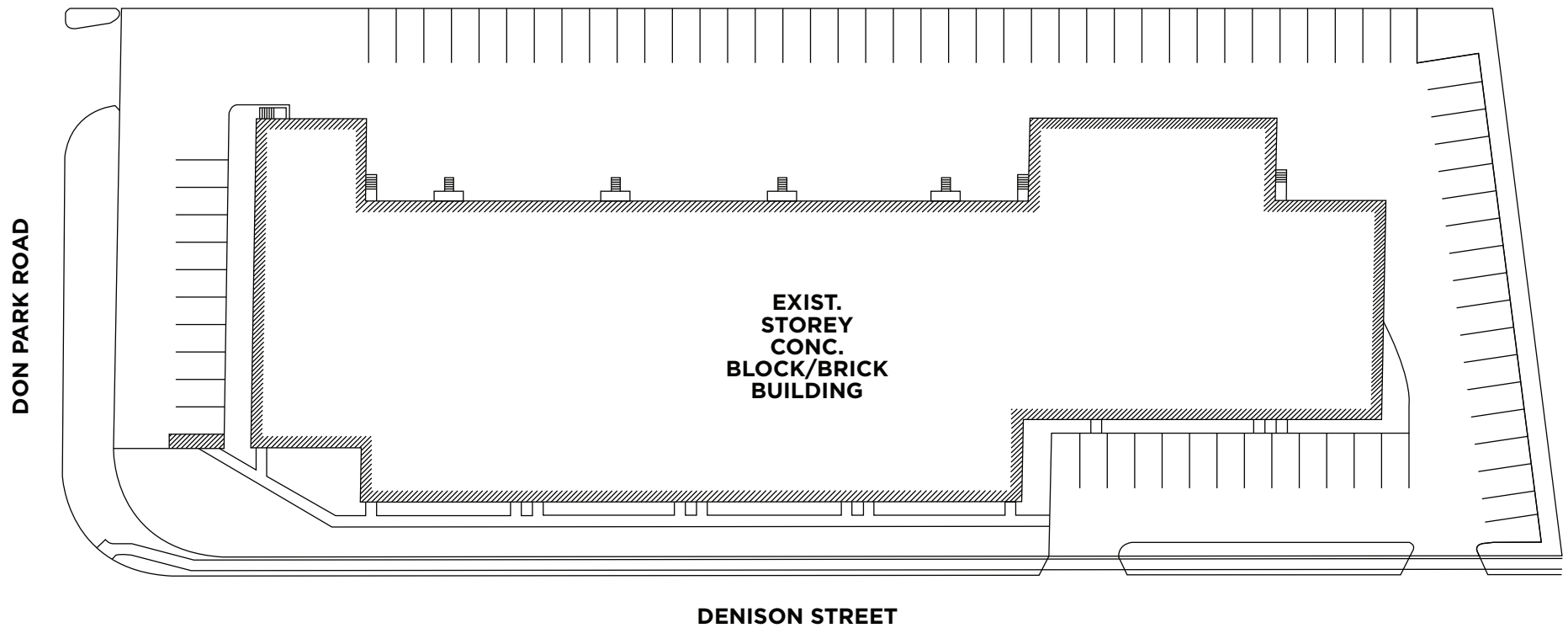

642 DENISON STREET

MARKHAM, ON



LOCATION MAP

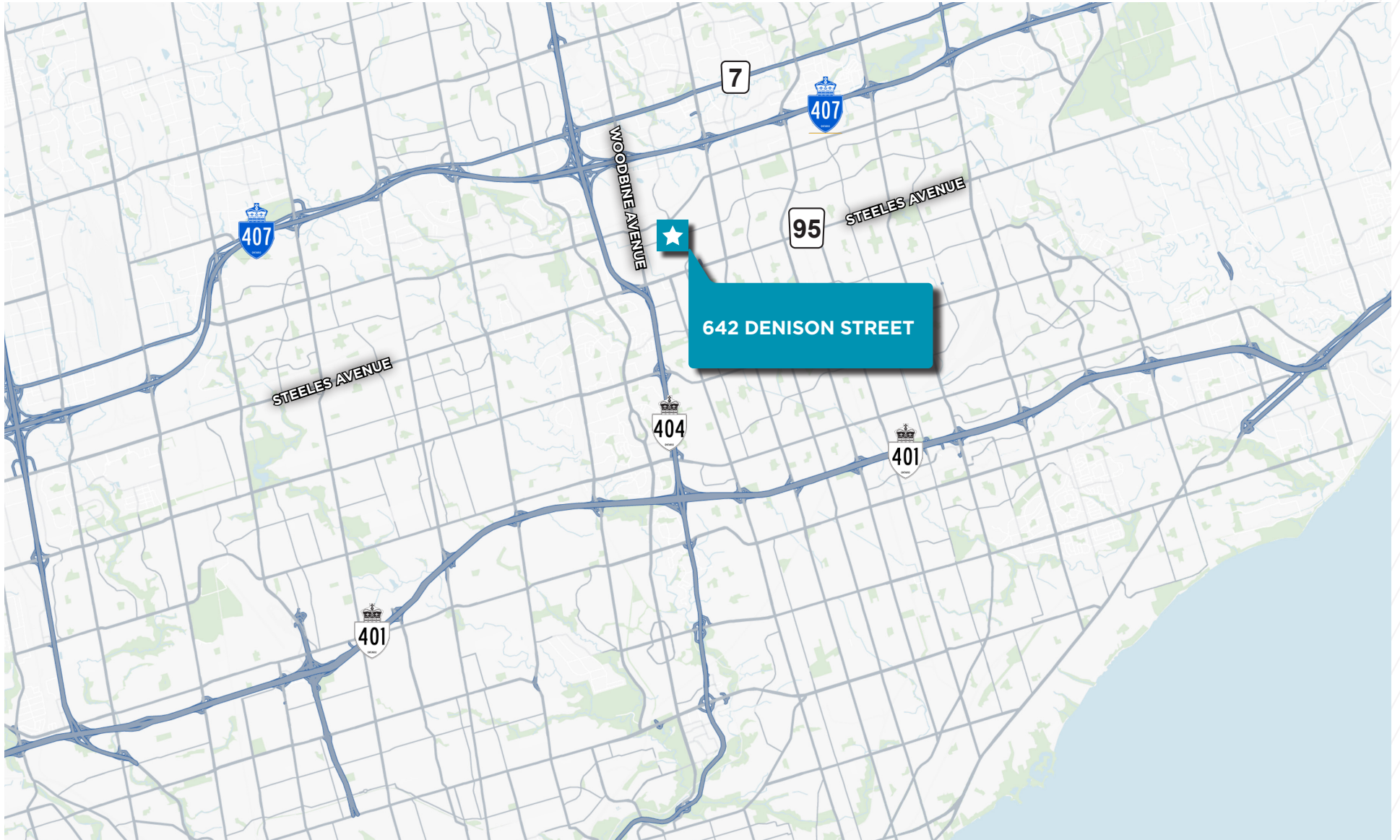

642 DENISON STREET MARKHAM, ON



IMMEDIATE NEIGHBOURS



642 DENISON STREET

MARKHAM, ON





FOR MORE INFORMATION, CONTACT:

GREG RACIC*

Vice President

Direct: +1 416 756 5465

Mobile: +1 416 629 4734

greg.racic@cushwake.com

1500 Don Mills Rd., Suite 401

Toronto, Ontario M3B 3K4

Direct: +1 416 494 9500

cushmanwakefield.com

©2026 Cushman & Wakefield ULC. All rights reserved. The information contained in this communication is strictly confidential. This information has been obtained from sources believed to be reliable but has not been verified. NO WARRANTY OR REPRESENTATION, EXPRESS OR IMPLIED, IS MADE AS TO THE CONDITION OF THE PROPERTY (OR PROPERTIES) REFERENCED HEREIN OR AS TO THE ACCURACY OR COMPLETENESS OF THE INFORMATION CONTAINED HEREIN, AND SAME IS SUBMITTED SUBJECT TO ERRORS, OMISSIONS, CHANGE OF PRICE, RENTAL OR OTHER CONDITIONS, WITHDRAWAL WITHOUT NOTICE, AND TO ANY SPECIAL LISTING CONDITIONS IMPOSED BY THE PROPERTY OWNER(S). ANY PROJECTIONS, OPINIONS OR ESTIMATES ARE SUBJECT TO UNCERTAINTY AND DO NOT SIGNIFY CURRENT OR FUTURE PROPERTY PERFORMANCE. *Sales Representative

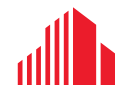

**CUSHMAN &
WAKEFIELD**