

**106,500 SF  
FOR SALE**

**CONTACT BROKERS FOR PRICING**



 **CUSHMAN &  
WAKEFIELD**

**14001 SOUTH LAKES DRIVE**

CHARLOTTE, NC



# PROPERTY HIGHLIGHTS



**11.55 Acres**

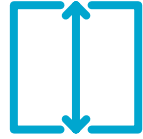

**23' Clear Height**



**Zoning ML-1**



**1 Drive-In Door**  
(8' x 10')



**5 Dock  
High Doors**



**40' x 40'  
Column  
Spacing**



**Fully  
Conditioned  
Warehouse**



**180  
Parking  
Spaces**



**Power +/-2400  
AMPS 480/3  
Phase**



**Wet  
Sprinkler  
System**



# FLOORPLAN

Total SF: 106,500  
Warehouse: 67,200 SF  
Office: 38,400 SF

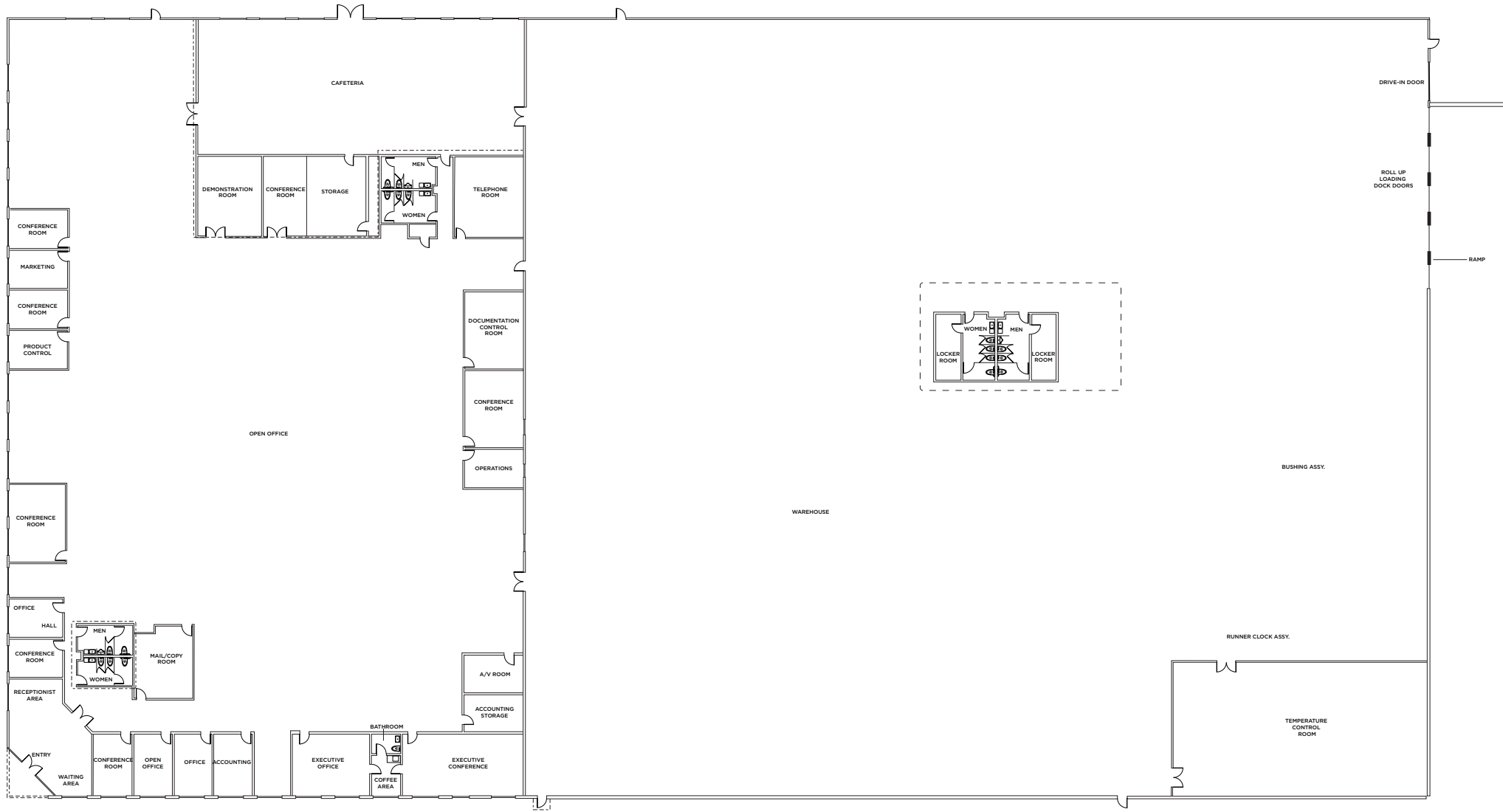

\*not reflective of recent office renovations



# LOCATION OVERVIEW



## DRIVE TIMES (approximate)

### DOWNTOWN CHARLOTTE

29 min (12.9 mi)

### CHARLOTTE DOUGLAS INTERNATIONAL AIRPORT

21 min (13.1 mi) via I-485

### I-77

6 min (2.1 mi)

### I- 485

10 min (5.0 mi) via I-77 N

### I-277

27 min (12.1 mi) via S Tryon St

### I-85

22 min (12.3 mi) via I-485



# PROPERTY PHOTOS

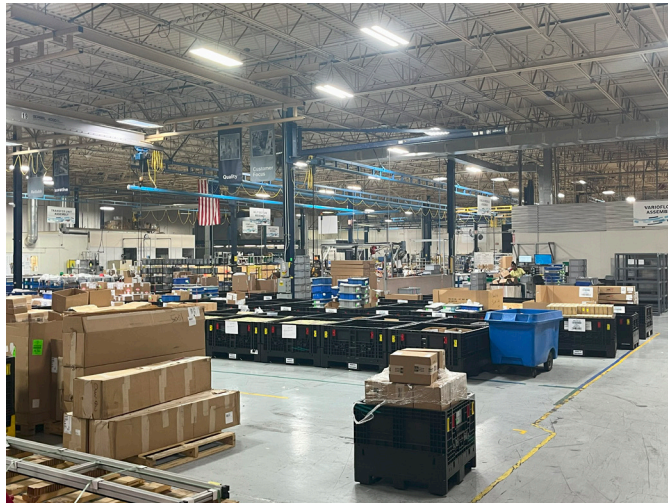





For more information, contact us:

**Matt Treble**  
Executive Managing Director  
704 335 4430  
[matt.treble@cushwake.com](mailto:matt.treble@cushwake.com)

**Patrick McGrath**  
Senior Director  
704 887 3038  
[patrick.mcgrath@cushwake.com](mailto:patrick.mcgrath@cushwake.com)

**Erin Turulski**  
Senior Associate  
704 916 1565  
[erin.turulski@cushwake.com](mailto:erin.turulski@cushwake.com)



300 South Tryon Street, Suite 1110  
Charlotte, NC 28202  
+1 704 375 7771  
[cushmanwakefield.com](http://cushmanwakefield.com)

©2025 Cushman & Wakefield. All rights reserved. The information contained in this communication is strictly confidential. This information has been obtained from sources believed to be reliable but has not been verified. NO WARRANTY OR REPRESENTATION, EXPRESS OR IMPLIED, IS MADE AS TO THE CONDITION OF THE PROPERTY (OR PROPERTIES) REFERENCED HEREIN OR AS TO THE ACCURACY OR COMPLETENESS OF THE INFORMATION CONTAINED HEREIN, AND SAME IS SUBMITTED SUBJECT TO ERRORS, OMISSIONS, CHANGE OF PRICE, RENTAL OR OTHER CONDITIONS, WITHDRAWAL WITHOUT NOTICE, AND TO ANY SPECIAL LISTING CONDITIONS IMPOSED BY THE PROPERTY OWNER(S). ANY PROJECTIONS, OPINIONS OR ESTIMATES ARE SUBJECT TO UNCERTAINTY AND DO NOT SIGNIFY CURRENT OR FUTURE PROPERTY PERFORMANCE.