



**CUSHMAN &
WAKEFIELD**

FOR LEASE

4005 Whipple Road

Alvarado Business Park | Union City, California



Property Highlights

- ±25,646 SF Warehouse
- ±2,200 SF Office Space
- Clear Height: 24'
- Five (5) Dock-High Doors
- One (1) Drive-In Door
- .60 GPM/3,000 SF Sprinklers
- ±40' x 64' Column Spacing
- Available: May 2026

Call Broker for Touring Instructions and Rental Rate

ALVARADO BUSINESS PARK is a 10 building 1.2 million square foot business park with close access to I-880 and HWY 92 offering solutions for today and expansion for future growth.

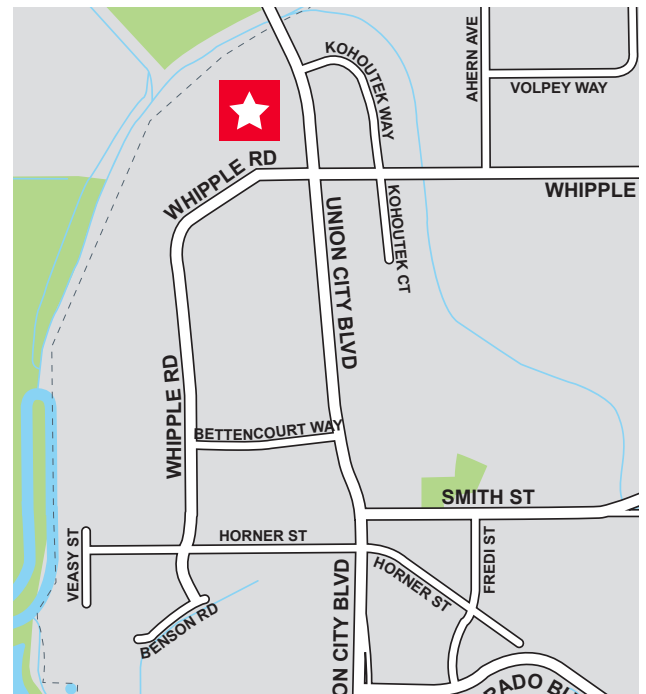

Jeff Starkovich, SIOR
Executive Managing Director
+1 510 409 1111
jeff.starkovich@cushwake.com
LIC #00644571 | cushmanwakefield.com



**CUSHMAN &
WAKEFIELD**

Mark Maguire
Executive Vice President
+1 510 219 7854
mark.maguire@colliers.com
LIC #01190597 | www.colliers.com





**CUSHMAN &
WAKEFIELD**

FOR LEASE

4005 Whipple Road

Alvarado Business Park | Union City, California

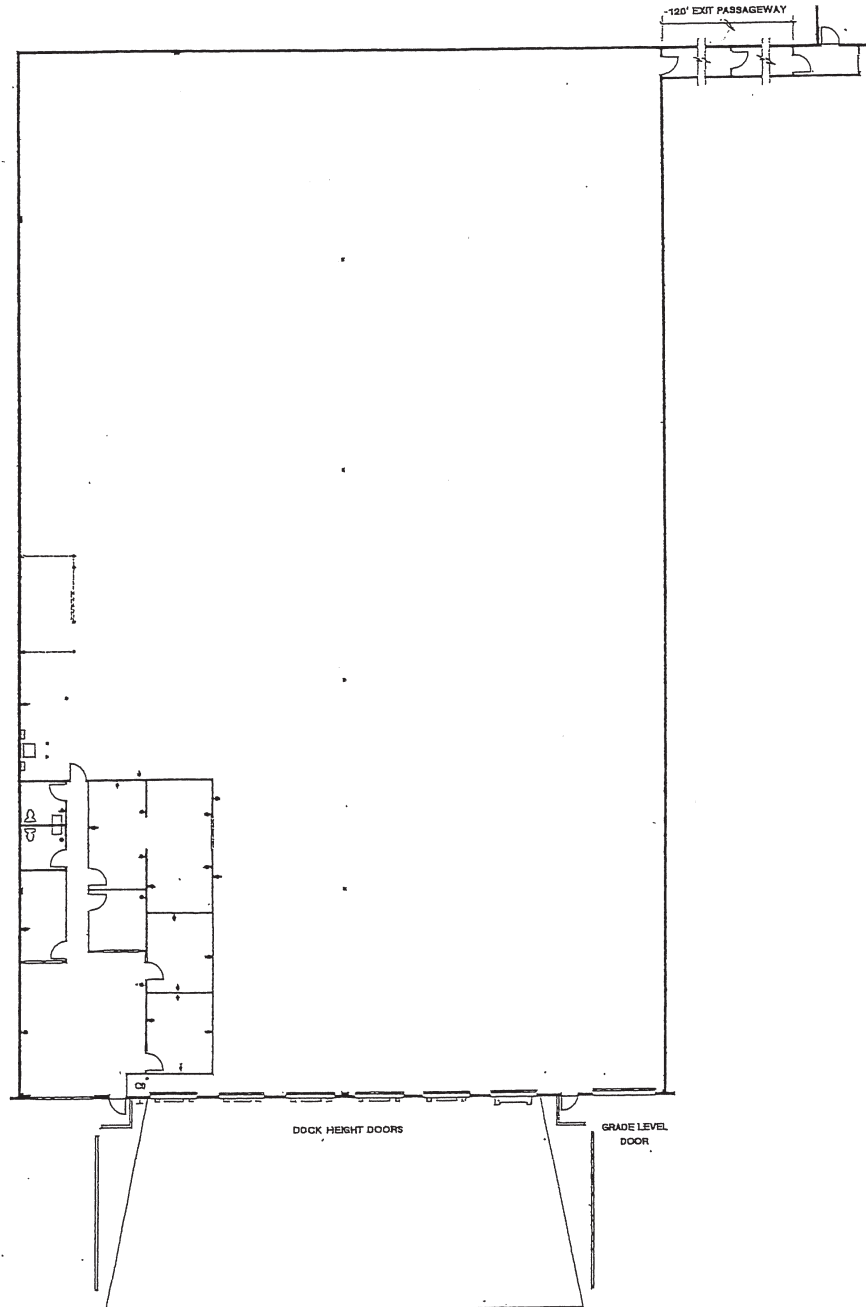

Jeff Starkovich, SIOR
Executive Managing Director
+1 510 409 1111
jeff.starkovich@cushwake.com
LIC #00644571 | cushmanwakefield.com



**CUSHMAN &
WAKEFIELD**

Mark Maguire
Executive Vice President
+1 510 219 7854
mark.maguire@colliers.com
LIC #01190597 | www.colliers.com

