

3875 FABER PLACE DRIVE  
NORTH CHARLESTON, SC 29405

---

±4,000 - 19,669 SF  
AVAILABLE







± 4,000 - 19,669 SF

# Property Highlights

---

3875 Faber Place Drive presents a versatile leasing opportunity within a well-maintained office building. The entire first floor is available and can be leased in its entirety or subdivided to accommodate users as small as +/- 4,000 SF. This economical office space features an efficient layout for both general office and select medical office users.

- Quick access to I-526
- Excellent visibility
- Prominent building signage
- Abundant free surface parking
- Nature trails and running paths

#### AVAILABILITIES:

- First Floor: ±4,000-19,669 SF

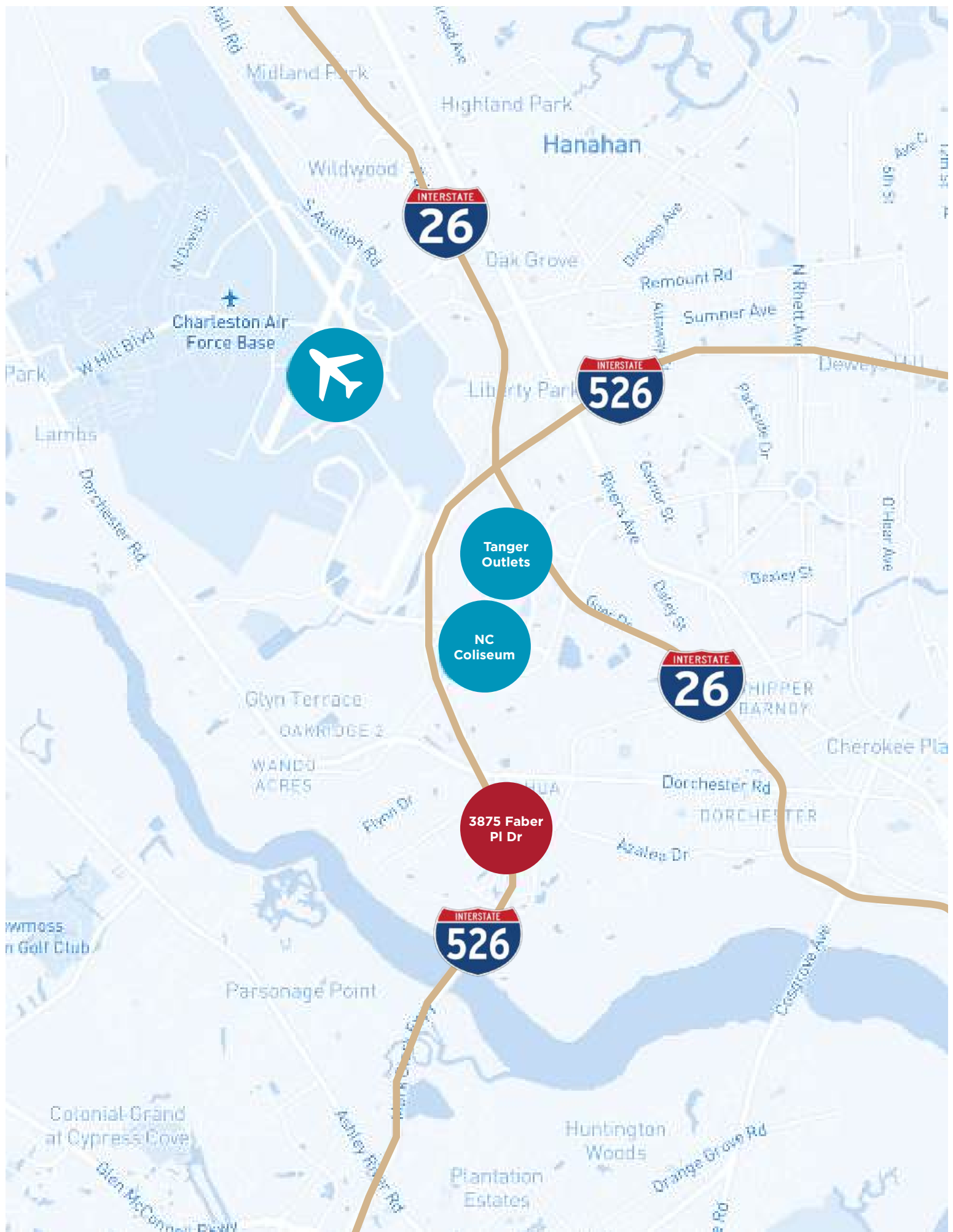

Tanger  
Outlets

NC  
Coliseum

3875 Faber  
PI Dr

## 1st Floor

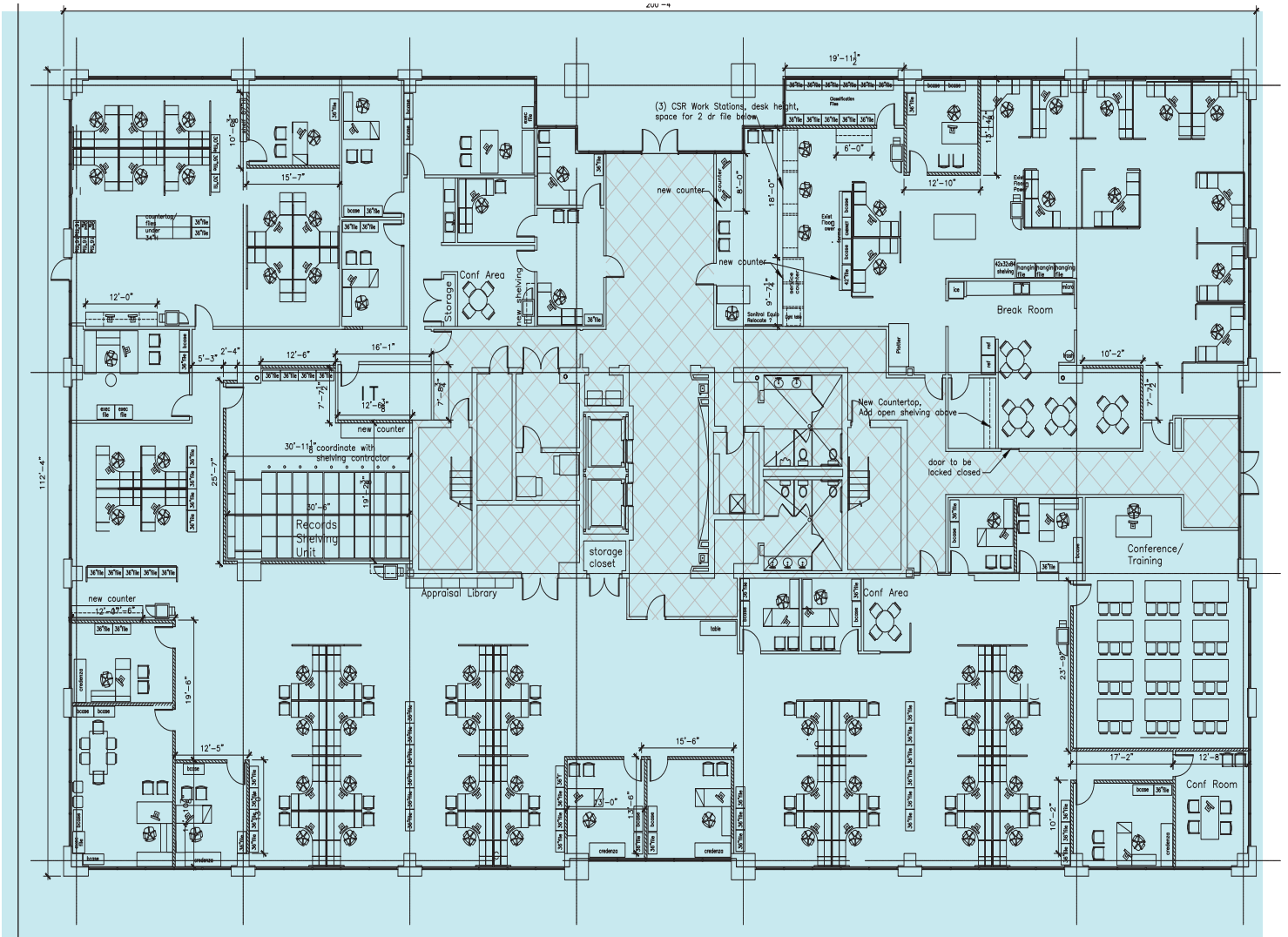









## CONTACT INFORMATION

### NICK TANANA

Senior Director

+1 843 724 0109

[nick.tanana@cushwake.com](mailto:nick.tanana@cushwake.com)

### BRADY DASHIELL

Senior Associate

+1 843 724 0106

[brady.dashiell@cushwake.com](mailto:brady.dashiell@cushwake.com)



©2024 Cushman & Wakefield. All rights reserved. The information contained in this communication is strictly confidential. This information has been obtained from sources believed to be reliable but has not been verified. NO WARRANTY OR REPRESENTATION, EXPRESS OR IMPLIED, IS MADE AS TO THE CONDITION OF THE PROPERTY (OR PROPERTIES) REFERENCED HEREIN OR AS TO THE ACCURACY OR COMPLETENESS OF THE INFORMATION CONTAINED HEREIN, AND SAME IS SUBMITTED SUBJECT TO ERRORS, OMISSIONS, CHANGE OF PRICE, RENTAL OR OTHER CONDITIONS, WITHDRAWAL WITHOUT NOTICE, AND TO ANY SPECIAL LISTING CONDITIONS IMPOSED BY THE PROPERTY OWNER(S). ANY PROJECTIONS, OPINIONS OR ESTIMATES ARE SUBJECT TO UNCERTAINTY AND DO NOT SIGNIFY CURRENT OR FUTURE PROPERTY PERFORMANCE.