



±6,918 SF
AVAILABLE FOR LEASE

TASMAN INDUSTRIAL CENTER

1147 - 1155 TASMAN DRIVE // SUNNYVALE



CUSHMAN &
WAKEFIELD

SOUTH BAY
DEVELOPMENT CO.

TASMAN INDUSTRIAL CENTER

AVAILABLE NOW:

1153 Tasman: ±6,918 SF

BUILDING HIGHLIGHTS



CENTRAL LOCATION AT LAWRENCE EXPWY. & TASMAN DR.



COMCAST AVAILABLE



GRADE LEVEL DOOR IN EACH SPACE



±2.76/1,000 PARKING



EASY ACCESS TO MAJOR HIGHWAYS 237, 101 AND 880



LIGHT RAIL ACCESSIBLE



WALKING DISTANCE TO RESTAURANTS

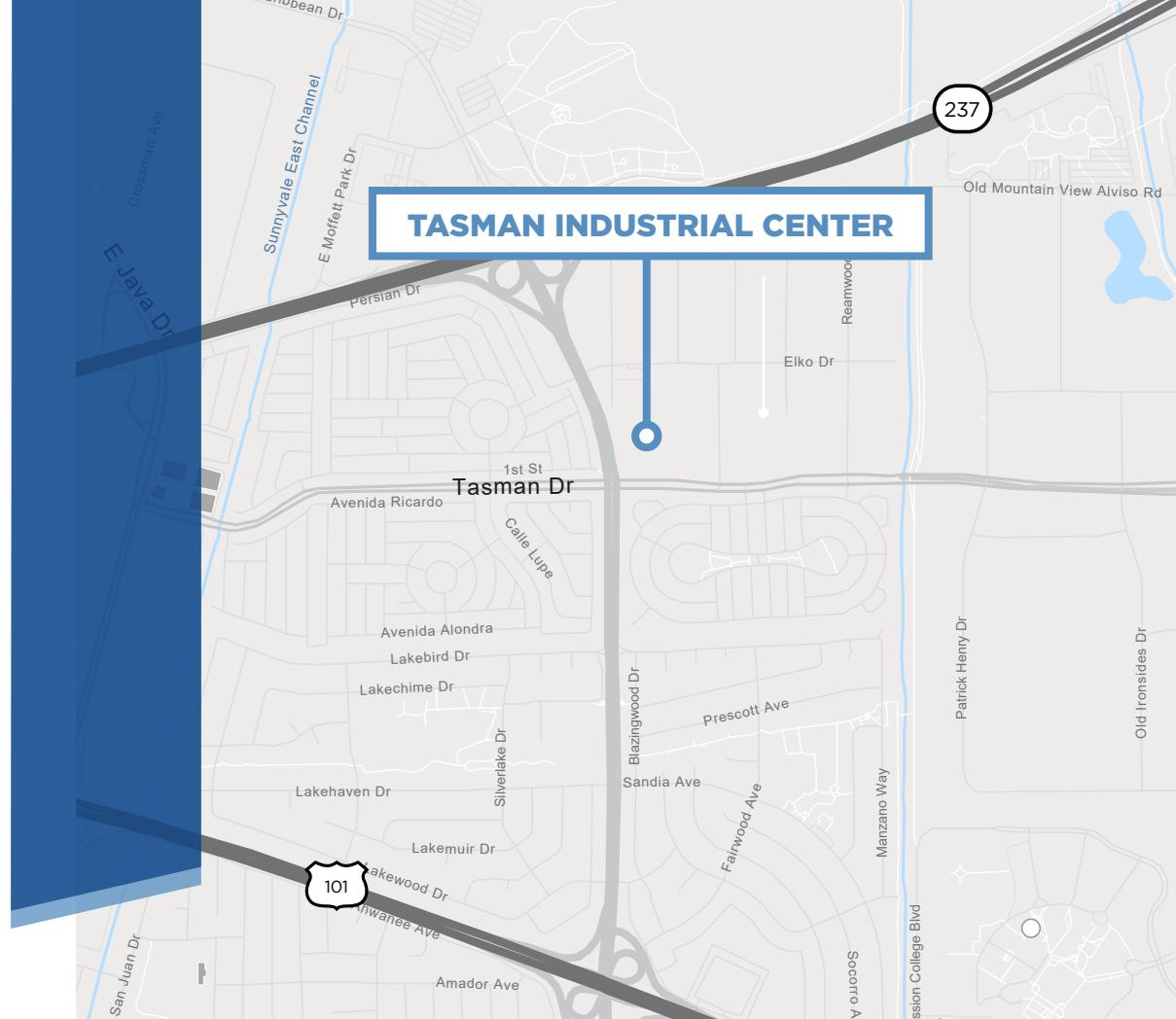

TASMAN INDUSTRIAL CENTER

TASMAN INDUSTRIAL CENTER

1153 TASMAN: ±6,918 SF - AVAILABLE NOW

- 400 AMPS AT 120/208V
- 2 OFFICES
- 1 CONFERENCE ROOM
- BREAK ROOM
- WAREHOUSE AREA
(100% HVAC)

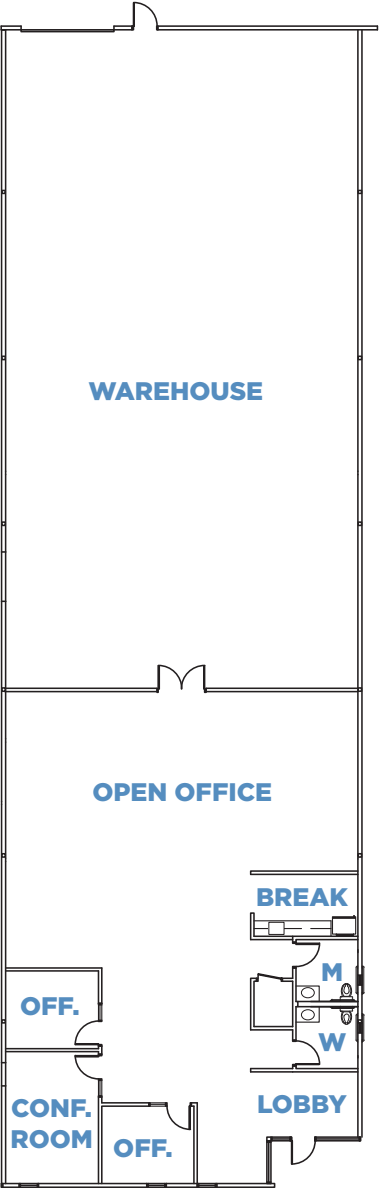

TASMAN INDUSTRIAL CENTER

AMENITIES & TRANSPORTATION



TASMAN INDUSTRIAL CENTER

1147 - 1155 TASMAN DRIVE // SUNNYVALE

±6,918 SF

AVAILABLE FOR LEASE

Nick Lazzarini
408.615.3410
nick.lazzarini@cushwake.com
LIC #01788935

Jacob Bider
408.572.4138
jacob.bider@cushwake.com
LIC #02110355

SOUTH BAY
DEVELOPMENT CO.

