



**±6,809 SF or ±6,918 SF  
AVAILABLE FOR LEASE**

# **TASMAN INDUSTRIAL CENTER**

1147 - 1155 TASMAN DRIVE // SUNNYVALE



# TASMAN INDUSTRIAL CENTER

## AVAILABLE NOW:

1147 Tasman:  $\pm 6,809$  SF

1153 Tasman:  $\pm 6,918$  SF

## BUILDING HIGHLIGHTS



**CENTRAL LOCATION AT  
LAWRENCE EXPWY. & TASMAN DR.**



**COMCAST AVAILABLE**



**GRADE LEVEL DOOR IN  
EACH SPACE**



**$\pm 2.76/1,000$  PARKING**



**EASY ACCESS TO MAJOR  
HIGHWAYS 237, 101 AND 880**



**LIGHT RAIL ACCESSIBLE**



**WALKING DISTANCE  
TO RESTAURANTS**

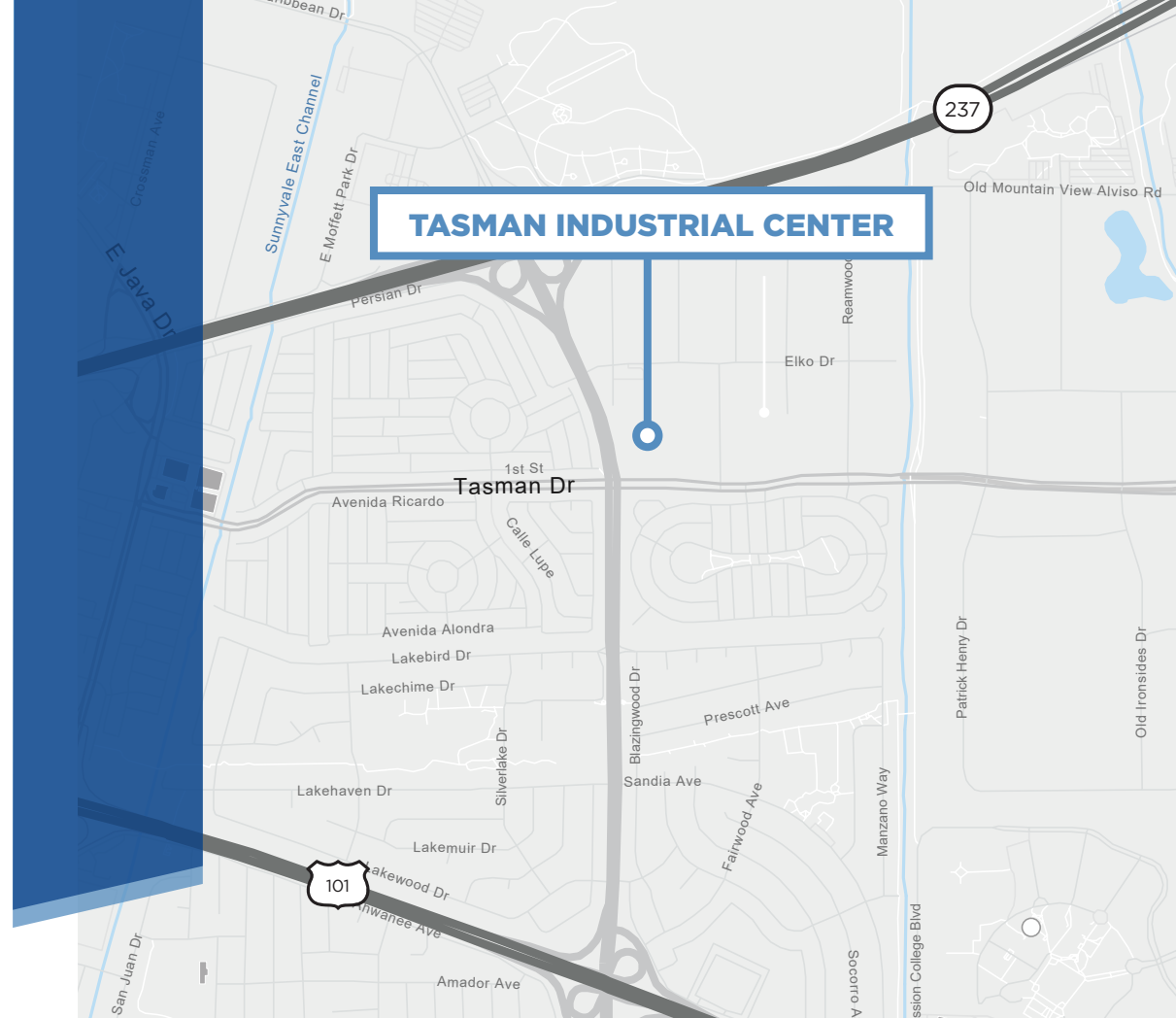

**TASMAN INDUSTRIAL CENTER**



# TASMAN INDUSTRIAL CENTER

1147 TASMAN: ±6,809 SF - AVAILABLE NOW

- 300 AMPS AT 120/208V
- 2 OFFICES
- 1 CONFERENCE ROOM
- BREAK ROOM
- LAB/MANUFACTURING AREA (100% HVAC)
- SHIPPING/RECEIVING
- 1 GRADE LEVEL DOOR

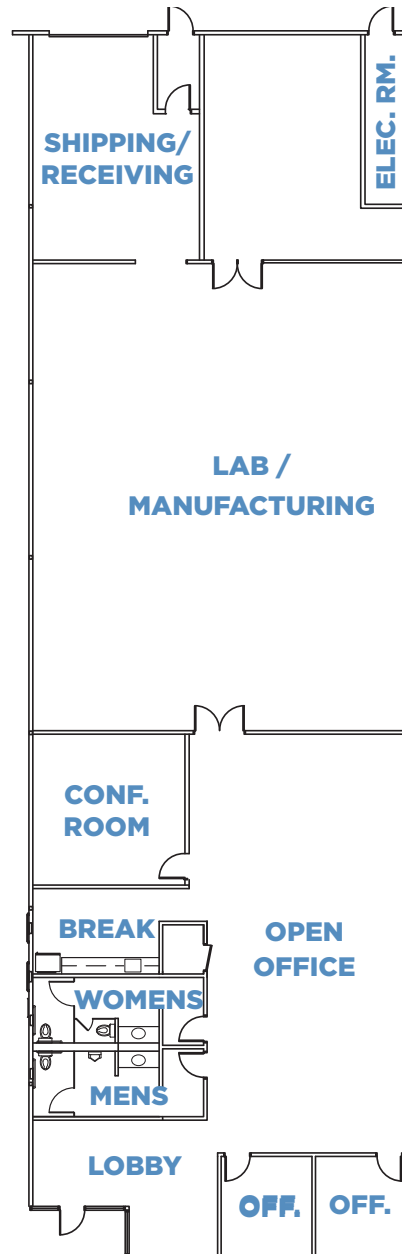

TASMAN INDUSTRIAL CENTER

# TASMAN INDUSTRIAL CENTER

1153 TASMAN: ±6,918 SF - AVAILABLE NOW

- 400 AMPS AT 120/208V
- 2 OFFICES
- 1 CONFERENCE ROOM
- BREAK ROOM
- WAREHOUSE AREA  
(100% HVAC)

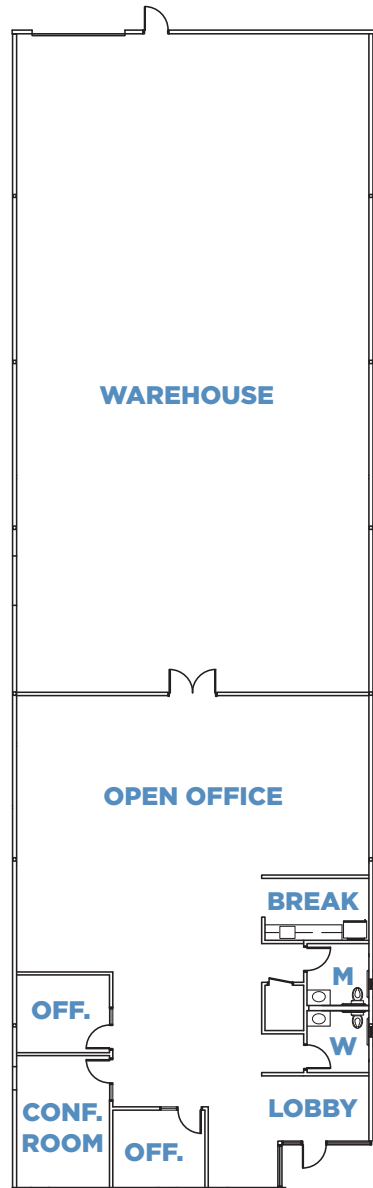

# TASMAN INDUSTRIAL CENTER

## AMENITIES & TRANSPORTATION



TASMAN INDUSTRIAL CENTER



# TASMAN INDUSTRIAL CENTER

1147 - 1155 TASMAN DRIVE // SUNNYVALE

±6,809 or ±6,918 SF

AVAILABLE FOR LEASE

**Nick Lazzarini**

408.615.3410  
nick.lazzarini@cushwake.com  
LIC #01788935

**Clark Steele**

408.436.3653  
clark.steele@cushwake.com  
LIC #01995379

**Jacob Bider**

408.572.4138  
jacob.bider@cushwake.com  
LIC #02110355

**SOUTH BAY**  
DEVELOPMENT CO.

