

FOR LEASE

6898 Engle Road

Middleburg Heights, Ohio 44130



MULTI-TENANT INDUSTRIAL FACILITY

24,025 SF AVAILABLE FOR LEASE

FRED W. CHRISTIE / Executive Vice President & Partner Emeritus / +1 216 525 1468 / fchristie@crescorealestate.com

PROPERTY FEATURES



24,025 SF

TOTAL UNIT SIZE

6.0 ACRES

TOTAL SITE SIZE

3,500 SF

TOTAL OFFICE SF

\$10.50/SF NNN

OFFICE LEASE RATE

20,525 SF

TOTAL WAREHOUSE SF

\$5.25/SF NNN

WAREHOUSE LEASE RATE

NNN = \$2.62/SF

COMMENTS

- 24,025 SF end unit immediately available
- Fully sprinklered
- 2 docks & 1 drive-in door
- 3,500 SF of newly renovated offices

PROPERTY SPECIFICATIONS

CONSTRUCTION:	Tilt Up	CEILING HEIGHT:	18'7"
LIGHTING:	LED	DOCKS:	2
ROOF:	Flat	DRIVE-IN DOORS:	1
FLOOR:	Concrete	PARKING:	Ample parking

PROPERTY PHOTOS

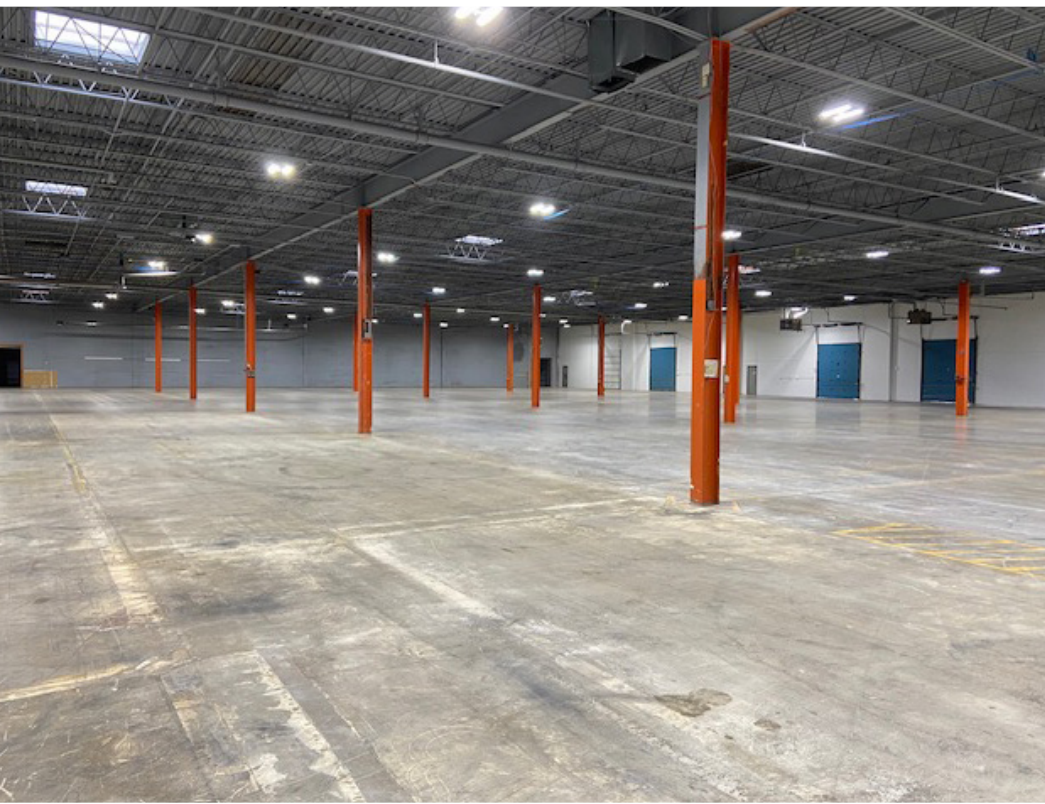

PROPERTY FLOOR PLAN

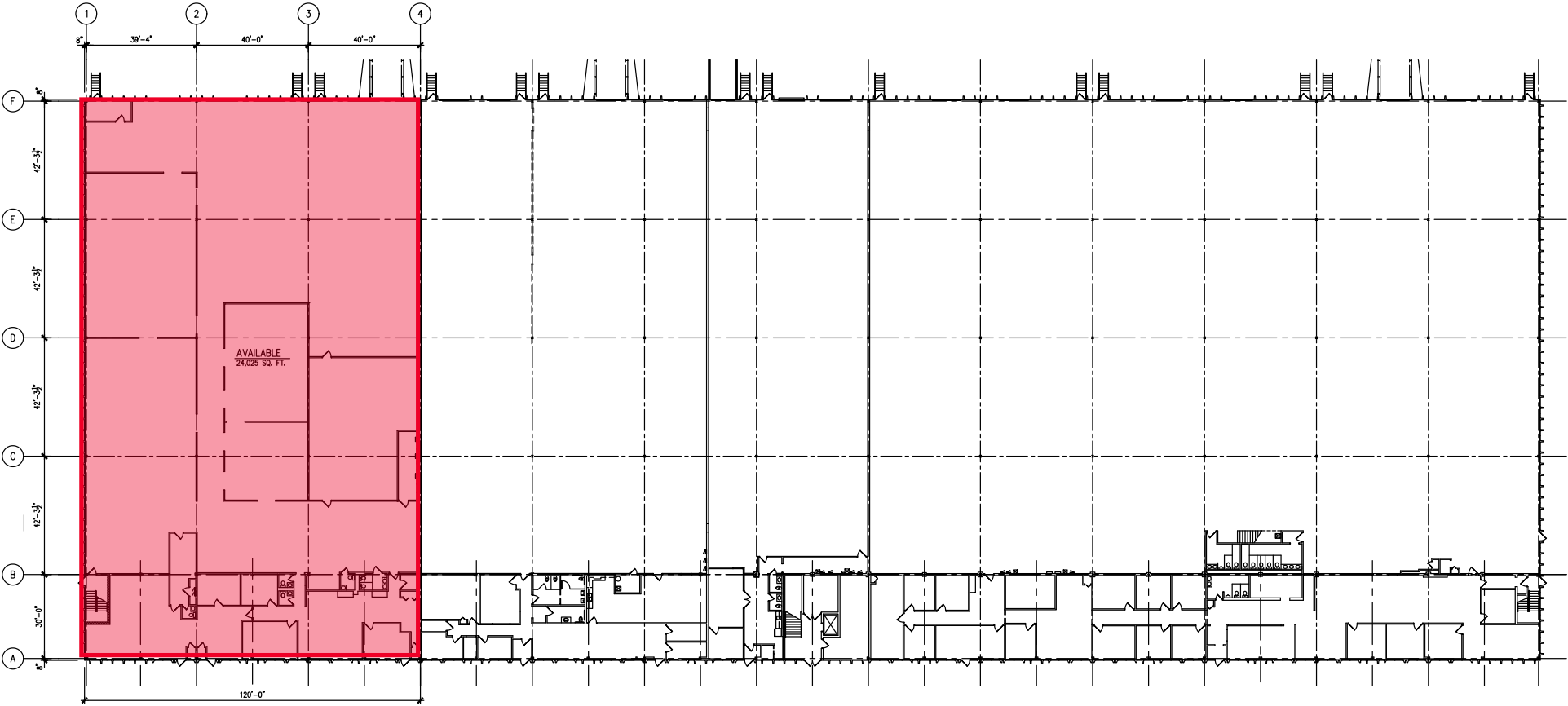

FLOOR PLAN
SCALE: N.T.S.



NORTH

PROPERTY AERIAL MAP

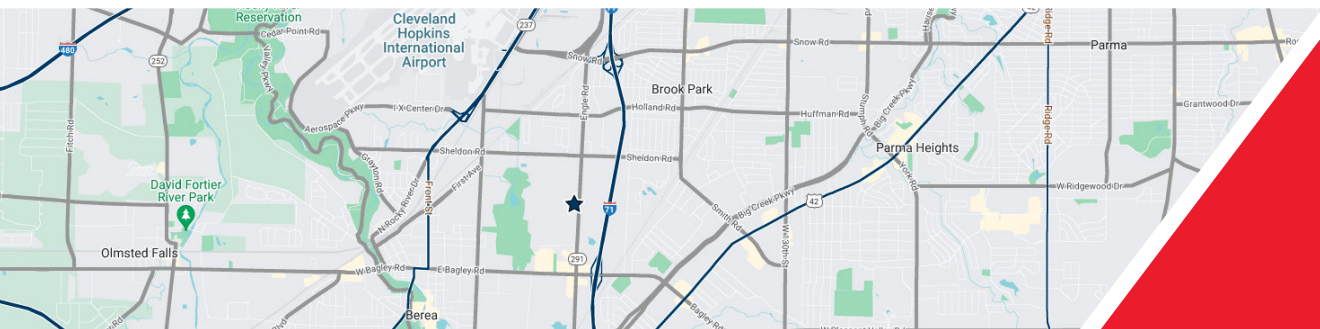

Easy access
to I-480 and I-71

**FRED W. CHRISTIE**

Executive Vice President & Partner Emeritus
+1 216 525 1468
fchristie@crescorealestate.com

Independently Owned and Operated / A Member of the Cushman & Wakefield Alliance

Cushman & Wakefield Copyright 2026. No warranty or representation, express or implied, is made to the accuracy or completeness of the information contained herein, and same is submitted subject to errors, omissions, change of price, rental or other conditions, withdrawal without notice, and to any special listing conditions imposed by the property owner(s). As applicable, we make no representation as to the condition of the property (or properties) in question. A licensee at Cushman & Wakefield | CRESCO may have an interest in the client entity offering this property for sale.

6100 Rockside Woods Blvd, Suite 200
Cleveland, Ohio 44131
Main +1 216 520 1200
crescorealestate.com