



FOR LEASE

3468 BRIDGEWAY ST

VANCOUVER, BC

**12,459 square feet of warehouse and office space
within the Hastings-Sunrise area of Vancouver.**

Owned and managed by

**bosa
properties**

**CUSHMAN &
WAKEFIELD**

HIGHLIGHTS

OPPORTUNITY

To lease a functional warehouse facility within 10 minutes of downtown Vancouver and direct access to the Trans-Canada Highway (Highway #1). The property is ideally situated in Vancouver, at the south end of the Ironworkers Memorial Bridge.

AVAILABLE AREA

Warehouse	11,259 SF
Office	1,200 SF
Total Available	12,459 SF

BUILDING FEATURES

- Located at the south end of the Ironworkers Memorial Bridge
- Fully sprinklered (warehouse)
- Two (2) covered dock level loading doors with levellers
- 3-phase 400 Amps at 480 Volts electrical service
- Ample on-site parking
- Great loading access/egress
- 18' ceiling heights in the warehouse
- Four (4) total washrooms - Two (2) in each the warehouse and office areas

ZONING

I-2 (General Industrial District) Allowing a wide variety of warehousing, wholesale, manufacturing, distribution, ancillary showroom/offices and certain commercial and service uses.

ASKING LEASE RATE

\$19.95 psf, NNN

OPERATING EXPENSES

Approximately \$8.45/SF (2026 estimate)

AVAILABILITY

Immediate

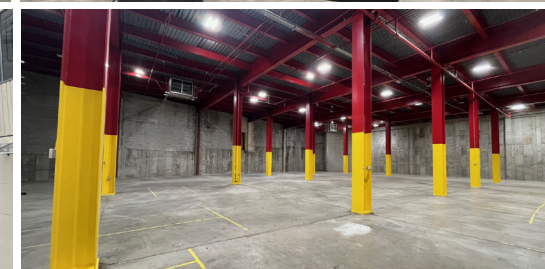
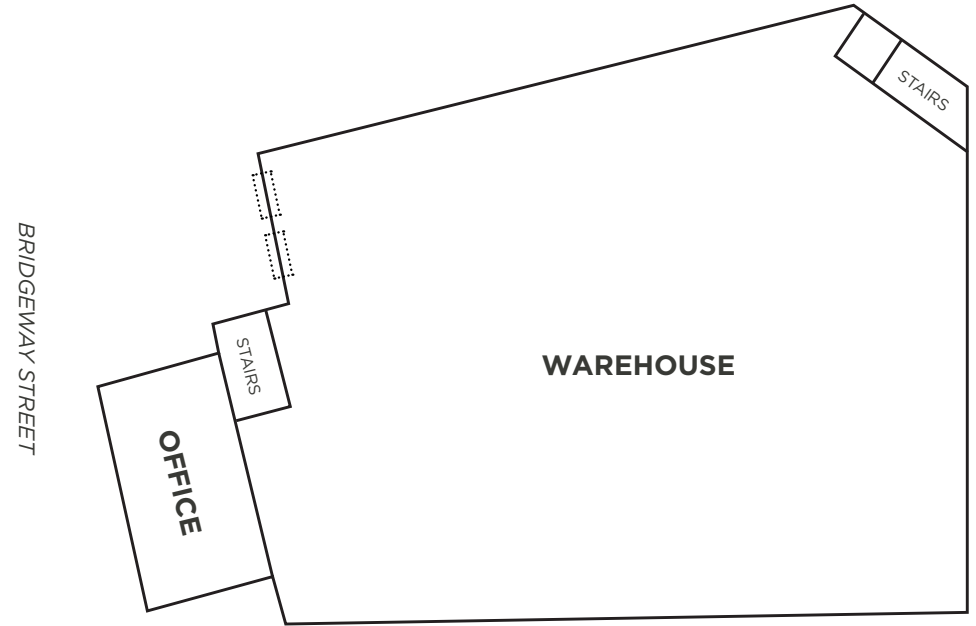

LOCATION



3468 BRIDGEWAY ST

Owned and managed by

**bosa
properties**

**CUSHMAN &
WAKEFIELD**

JORDAN SENGARA | Personal Real Estate Corporation | Vice President | +1 604 640 5845 | jordan.sengara@cushwake.com
GREG MILES | Personal Real Estate Corporation | Associate Vice President | +1 604 640 5814 | greg.miles@cushwake.com
ERIC RICE | Personal Real Estate Corporation | Vice President, Industrial | +1 604 640 5877 | eric.rice@cushwake.com

700 West Georgia St, Suite 1200 | Vancouver, BC | +1 604 683 3111 | cushmanwakefield.com

©2026 Cushman & Wakefield. All rights reserved. The information contained in this communication is strictly confidential. This information has been obtained from sources believed to be reliable but has not been verified. NO WARRANTY OR REPRESENTATION, EXPRESS OR IMPLIED, IS MADE AS TO THE CONDITION OF THE PROPERTY (OR PROPERTIES) REFERENCED HEREIN OR AS TO THE ACCURACY OR COMPLETENESS OF THE INFORMATION CONTAINED HEREIN, AND SAME IS SUBMITTED SUBJECT TO ERRORS, OMISSIONS, CHANGE OF PRICE, RENTAL OR OTHER CONDITIONS, WITHDRAWAL WITHOUT NOTICE, AND TO ANY SPECIAL LISTING CONDITIONS IMPOSED BY THE PROPERTY OWNER(S). ANY PROJECTIONS, OPINIONS OR ESTIMATES ARE SUBJECT TO UNCERTAINTY AND DO NOT SIGNIFY CURRENT OR FUTURE PROPERTY PERFORMANCE.