

# Wood-Mizer

## INDUSTRIAL CAMPUS

8180 W 10<sup>th</sup> St, Indianapolis, IN 46214



# FOR SALE



### CONTACTS

**KEVIN W. ARCHER**  
Managing Director  
Mobile: +1 317 809 4142  
kevin.archer@cushwake.com

**FRITZ KAUFFMAN, SIOR**  
Executive Director  
Mobile: +1 317 753 4444  
fritz.kauffman@cushwake.com

- **±150,000 SF**
- **±12.6 ACRES**
- **175 CAR PARKING**

PROPERTY OVERVIEW

# OFFERING SUMMARY

The Wood-Mizer Facility at 8180 West 10<sup>th</sup> Street in Indianapolis is a multi-building industrial campus featuring a mix of pre-engineered steel and post-and-beam construction. The property offers a wide range of building sizes, clear heights from 10' up to 20', predominantly free-span layouts, and multiple dock and drive-in configurations.

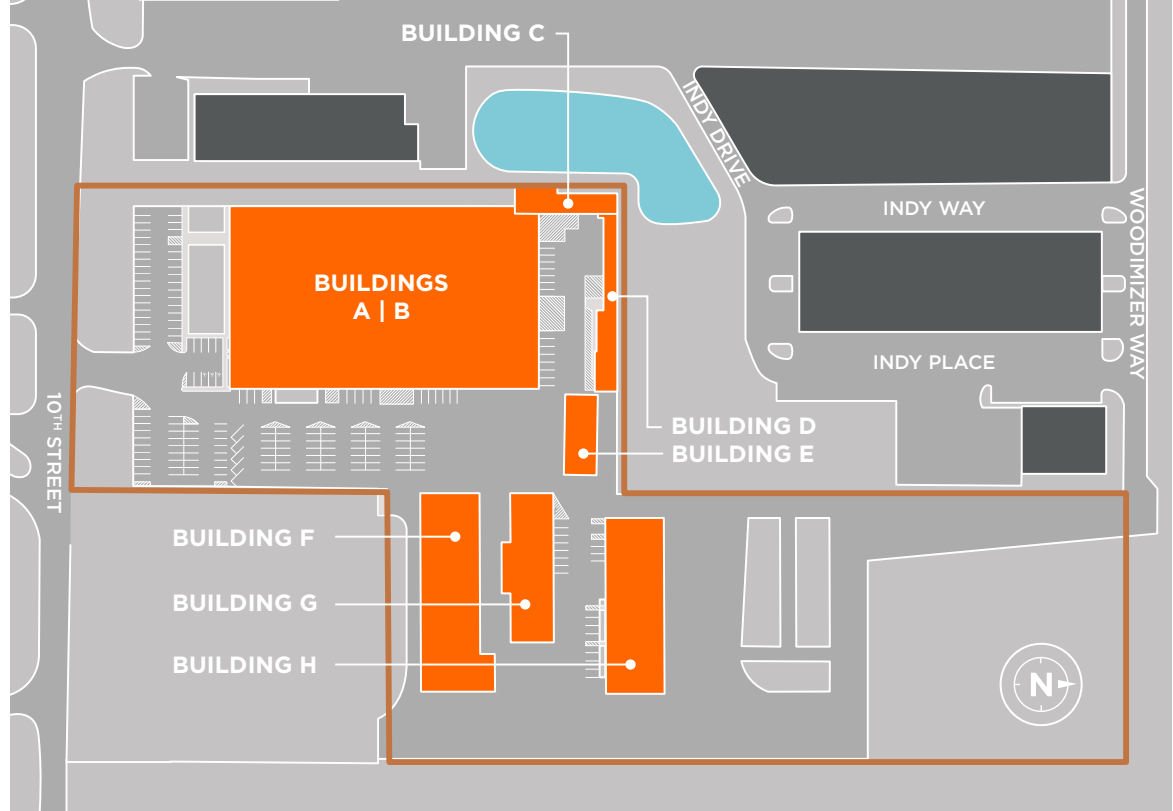

## WOOD-MIZER FACILITY BUILDING SPECS

|                               | BLDG A/B                                    | BLDG C                                    | BLDG D      | BLDG E           | BLDG F           | BLDG G           | BLDG H  |
|-------------------------------|---|---|-------------|------------------|------------------|------------------|---|
| <b>Total SF</b>               | 96,940                                      | 2,595<br>(600 SF - 2 <sup>nd</sup> Floor) | 2,147       | 3,585            | 17,422           | 9,951            | 18,900  |
| <b>Office SF</b>              | 28,270 (2 floors)                           | -   | 0           | 0                | 0                | 960              | 4,200 (second floor)                                    |
| <b>Ceiling Height</b>         | 14' & 19'                                   | 10'                                       | 10'         | 12'              | 17'              | 18'              | 10'/20'   |
| <b>Docks / Drive-in Doors</b> | 5/5   | 0/0                                       | 0/7         | 0/3              | 0/5              | 1/3              | 2/3   |
| <b>Column Spacing</b>         | -   | Free span                                 | Free span   | Free span        | Free span        | Free span        | Free span   |
| <b>Power</b>                  | 2400A, 480V, 3 Ph<br>2000A, 240V, 3 Ph      | -   | Minimal     | 225A, 240V, 3 Ph | 800A, 480V, 3 Ph | 225A, 480V, 3 Ph | 400A, 480V, 3 Ph  |
| <b>HVAC</b>                   | Heat & A/C<br>Throughout<br>(Rooftop Units) | Heat & A/C<br>Throughout                  | Unheated    | Gas Unit Heaters | Gas Unit Heaters | Gas Unit Heaters | A/C - Front Whse<br>Area & Offices; Gas<br>Unit Heaters |
| <b>Roof</b>                   | Rubber Membrane                             | Metal                                     | Metal       | Metal            | Metal            | Metal            | Metal   |
| <b>Construction</b>           | Pre-Engineered Steel                        | Post & Beam                               | Post & Beam | Post & Beam      | Post & Beam      | Post & Beam      | Post & Beam   |
| <b>Sprinkler</b>              | Wet   | None                                      | None        | None             | None             | None             | None  |
| <b>Year Built</b>             | 1980/1995                                   | 1988                                      | 1988        | 1988             | 1988             | 1988/2002        | 1993  |

©2026 Cushman & Wakefield. All rights reserved. The information contained in this communication is strictly confidential. This information has been obtained from sources believed to be reliable but has not been verified. NO WARRANTY OR REPRESENTATION, EXPRESS OR IMPLIED, IS MADE AS TO THE CONDITION OF THE PROPERTY (OR PROPERTIES) REFERENCED HEREIN OR AS TO THE ACCURACY OR COMPLETENESS OF THE INFORMATION CONTAINED HEREIN, AND SAME IS SUBMITTED SUBJECT TO ERRORS, OMISSIONS, CHANGE OF PRICE, RENTAL OR OTHER CONDITIONS, WITHDRAWAL WITHOUT NOTICE, AND TO ANY SPECIAL LISTING CONDITIONS IMPOSED BY THE PROPERTY OWNER(S). ANY PROJECTIONS, OPINIONS OR ESTIMATES ARE SUBJECT TO UNCERTAINTY AND DO NOT SIGNIFY CURRENT OR FUTURE PROPERTY PERFORMANCE.

# PROPERTY AERIAL



# SUBSTATION PROXIMITY

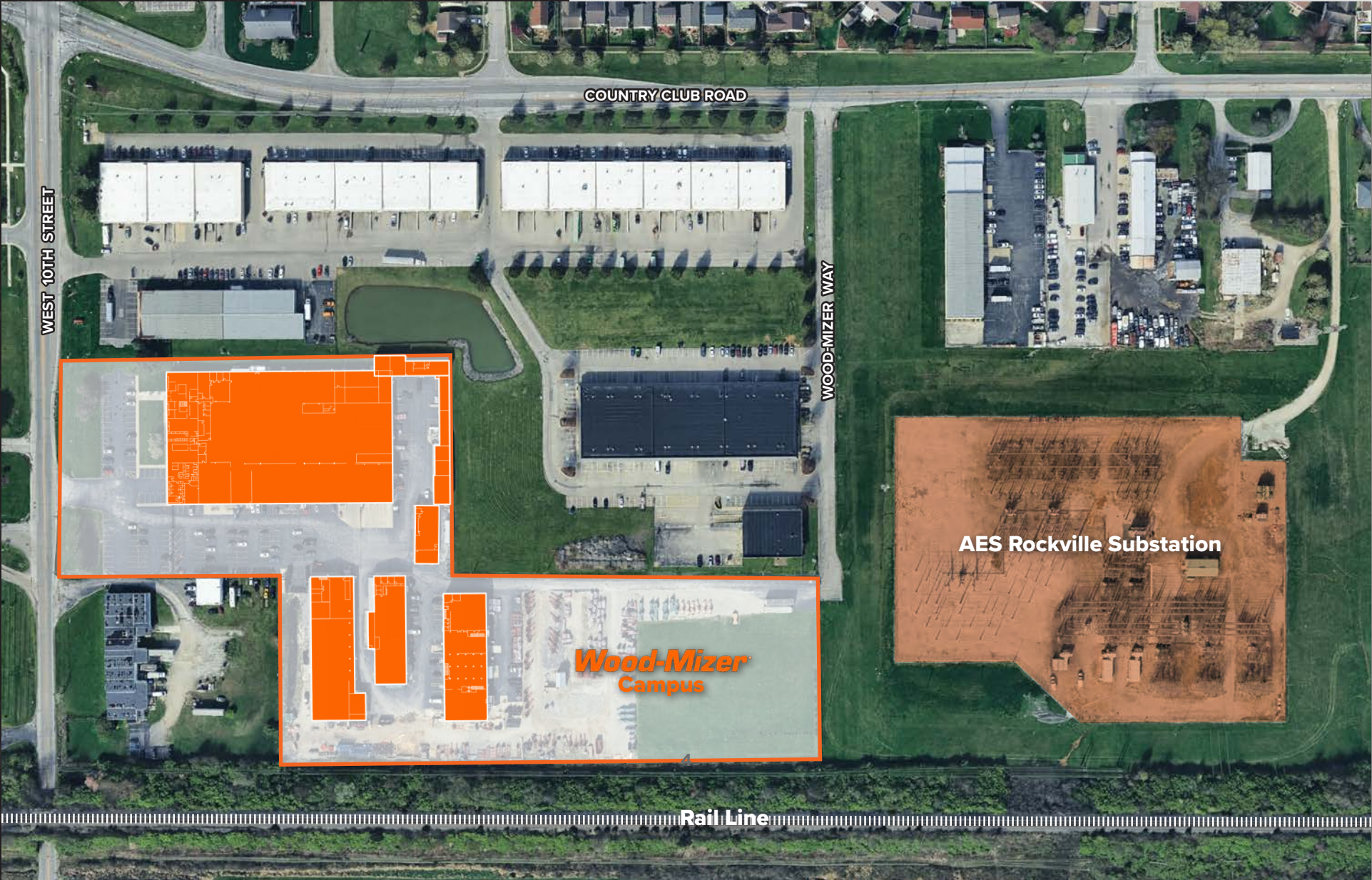

# EXTERIOR PHOTOS



# INTERIOR PHOTOS

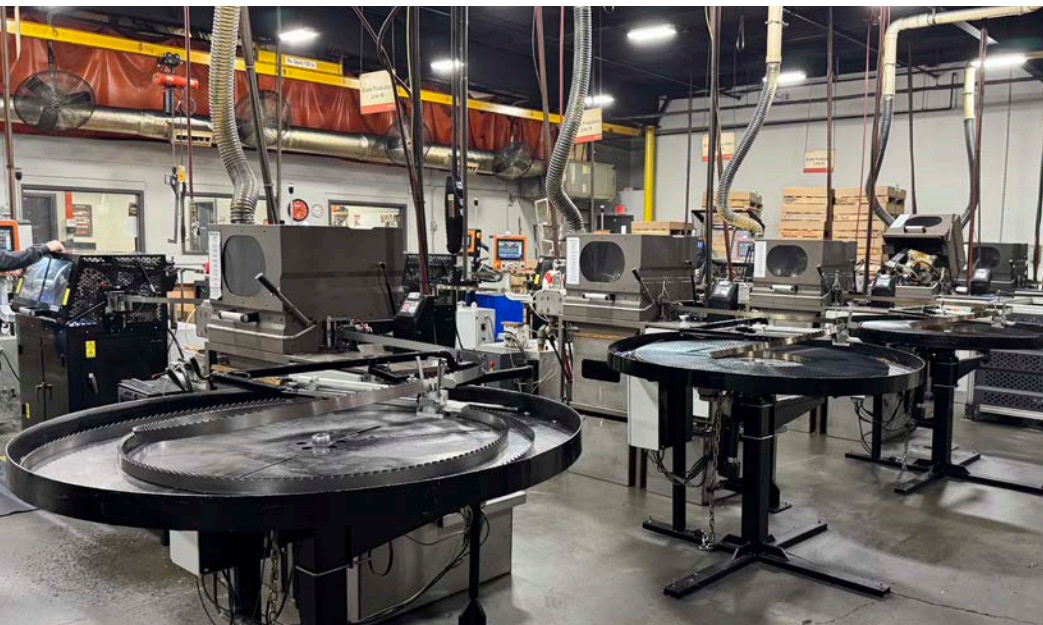
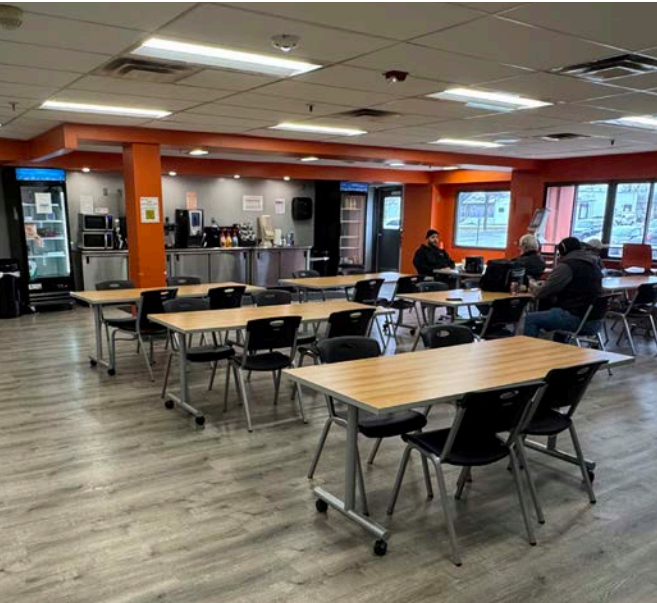

# INDIANA ADVANTAGE

Fast-paced and research-forward, Indiana has one of the best business climates in the nation. Known as the **CROSSROADS OF AMERICA**, more interstate highways converge in Indianapolis than any other city in the US, offering a strong competitive advantage by connecting the state with North America and world markets.

## THE FUNDAMENTALS

- AAA bond rating
- 1-3% Capped Property Taxes
- Right to Work State
- 4.9% Corporate Income Tax Rate
- No Inventory Tax
- No Manufacturing Equipment Sales Tax

## RICH IN RESOURCES

**#3**  
**INFRASTRUCTURE**  
America's Top States for Business

**1 in 5**  
**HOOSIERS**  
Work in Advanced Manufacturing

**#2**  
**IN U.S. FOR**  
Worldwide life-sciences exports



### BUSINESS TAX CLIMATE

**#1** in Midwest      **#9** in the U.S.



### BEST STATE FOR BUSINESS

**#1** in Midwest      **#5** in the U.S.



### BEST AIRPORT

**#1**  
Indianapolis International Airport, Best Airport in North America 13 years running  
- Airports Council International World

# Wood-Mizer

## INDUSTRIAL CAMPUS

### FOR SALE

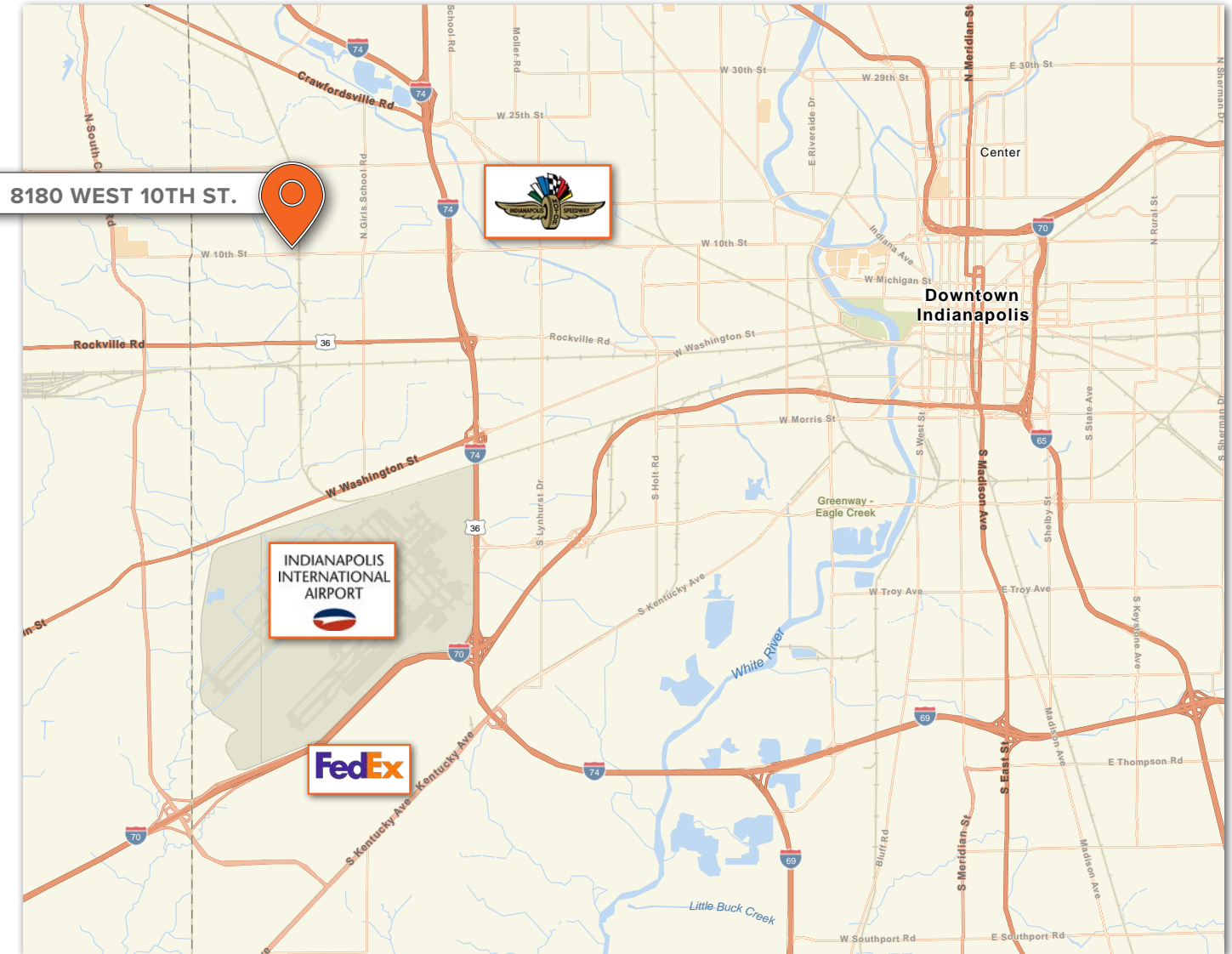

8180 WEST 10TH ST.

### CONTACTS

**KEVIN W. ARCHER**

Managing Director  
Mobile: +1 317 809 4142  
kevin.archer@cushwake.com

**Fritz KAUFFMAN, SIOR**

Executive Director  
Mobile: +1 317 753 4444  
fritz.kauffman@cushwake.com