



FOR SUBLEASE

2123 Bering Drive

San Jose, CA



INDUSTRIAL SPACE FOR SUBLEASE

Unit B: ±1,200 SF

Property Highlights:

- 1 Office & Restroom
- Insulated Warehouse
- Grade Level Door
- ±12' Clear Height
- 100 Amps @ 120/208 Volts
- Easy Access to HWY 87, US 101, & I-880
- 2.5/1,000 Parking
- LED 7/31/2028
- Longer Term & Direct Lease Possible
- Rate: \$1.80 IG + \$0.18 CAM

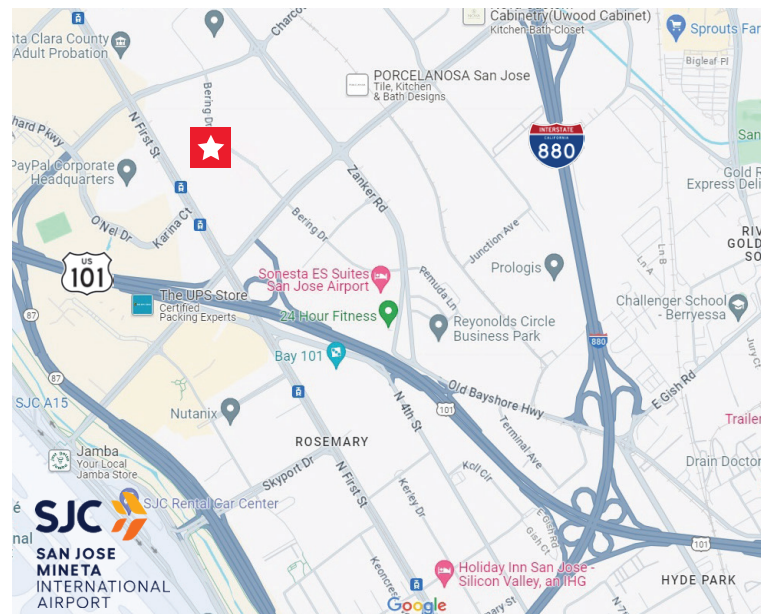

MIKE BAKER
Senior Director
+1 408 615 3406
mike.baker@cushwake.com
Lic. #01884037

JACOB BIDER
Senior Associate
+1 408 572 4138
jacob.bider@cushwake.com
Lic. #02110355

300 Santana Row, Fifth Floor
San Jose, CA 95128
T +1 408 615 3400
cushmanwakefield.com

FLOOR PLAN
UNIT B | ±1,200 SF

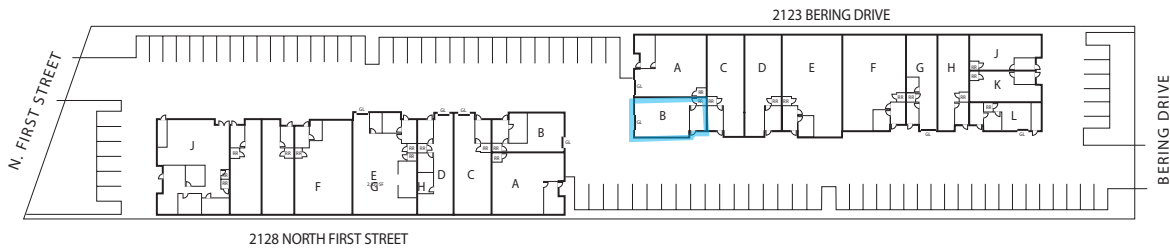

 AVAILABLE

MIKE BAKER
Senior Director
+1 408 615 3406
mike.baker@cushwake.com
Lic. #01884037

JACOB BIDER
Senior Associate
+1 408 572 4138
jacob.bider@cushwake.com
Lic. #02110355

300 Santana Row, Fifth Floor
San Jose, CA 95128
T +1 408 615 3400
cushmanwakefield.com