

# 3000 Earhart Ct.

Hebron, KY 41048

Brookfield  
Properties

11,148 SF  
Industrial Space  
for Lease



## Facility Highlights

- Available SF: 11,148 SF
- Clear Height: 22' - 24'
- One Dock Door
- One Door with Ramp
- Tilt-up Concrete Construction
- Light Industrial Zoning
- Minutes to Cincinnati/Northern Kentucky International Airport (CVG)

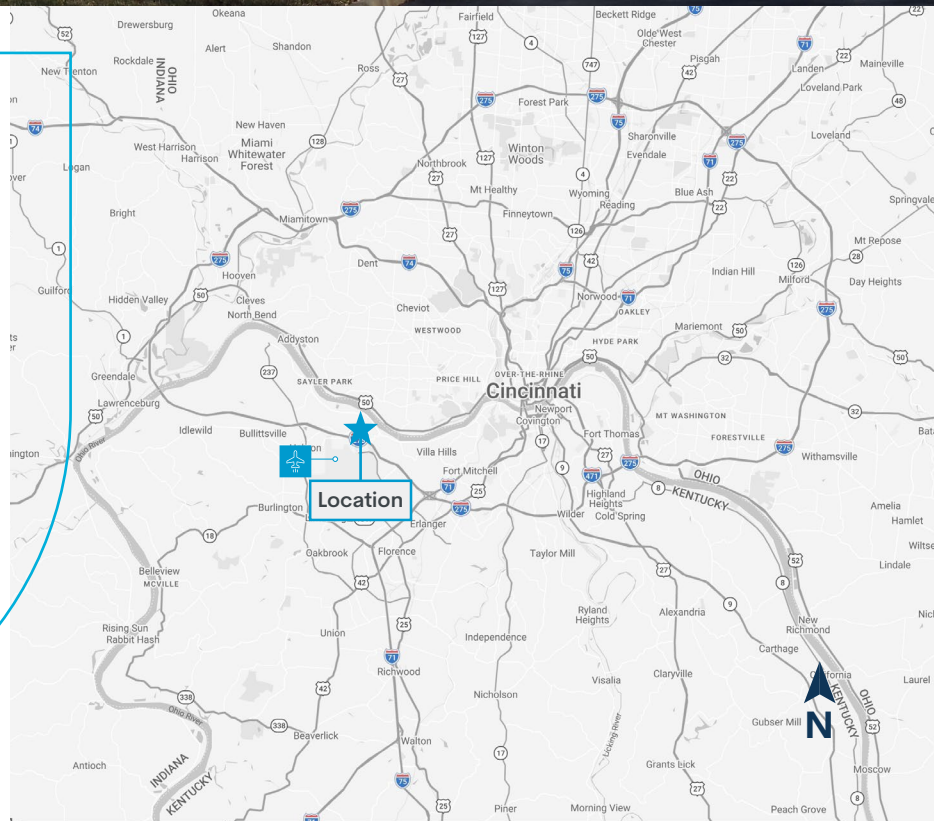

## Leasing Contacts

Seattle Stein  
513.763.3027  
seattle.stein@cushwake.com

Jeff Bender, SIOR, CCIM  
859.653.8944  
jeff.bender@cushwake.com



# 3000 Earhart Ct.

Hebron, KY 41048

**Brookfield  
Properties**



## Building Specifications

|                           |   |
|---------------------------|---|
| <b>Building Size</b>      | <b>69,888 sq. ft.</b>                       |
| <b>Available</b>          | <b>11,148 sq. ft.</b>                       |
| <b>Office Space</b>       | <b>7,581 sq. ft.</b>                        |
| <b>Clear Height</b>       | <b>22' - 24'</b>                            |
| <b>Typ. Bay Size</b>      | <b>42'w x 127'd</b>                         |
| <b>Column Spacing</b>     | <b>42' x 42'6"</b>                          |
| <b>Dock Doors</b>         | <b>1 door</b>                               |
| <b>Drive-ins</b>          | <b>1 drive-in door</b>                      |
| <b>Format</b>             | <b>rear load</b>                            |
| <b>HVAC</b>               | <b>forced air unit heaters</b>              |
| <b>Automobile Parking</b> | <b>88 spaces (approx.)</b>                  |
| <b>Sprinklers</b>         | <b>wet</b>                                  |
| <b>Lighting</b>           | <b>metal halide &amp; strip fluorescent</b> |
| <b>Power</b>              | <b>TBD</b>                                  |

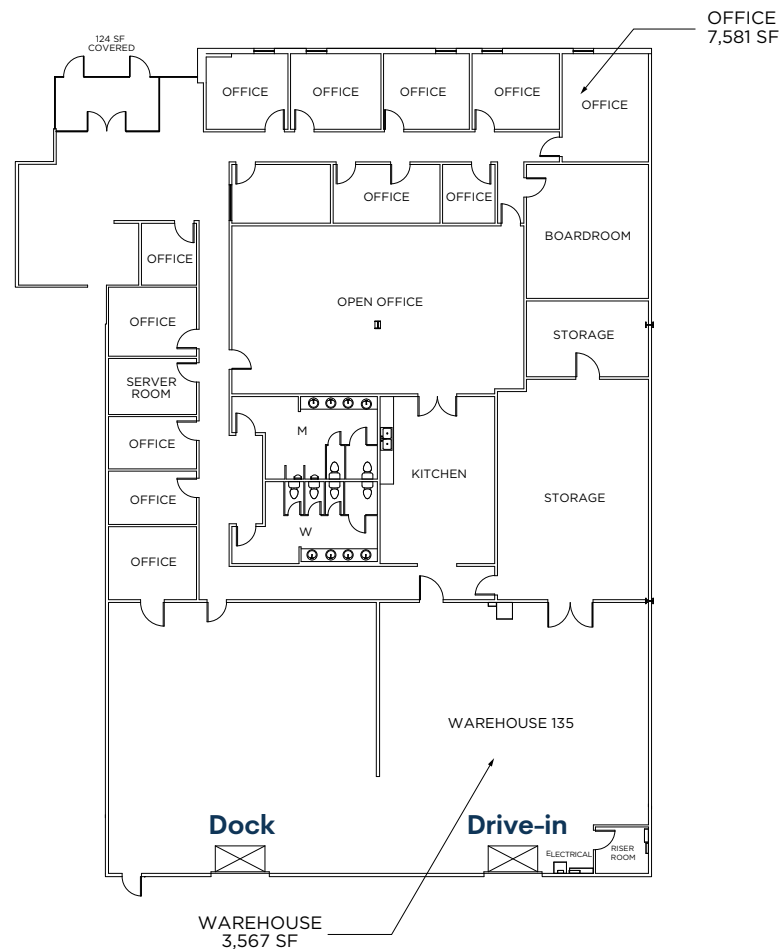

### Leasing Contacts

Seattle Stein  
513.763.3027  
seattle.stein@cushwake.com

Jeff Bender, SIOR, CCIM  
859.653.8944  
jeff.bender@cushwake.com

