

# OFFICE / WAREHOUSE WITH YARD FOR LEASE

## ±3,840 SF AVAILABLE

HOWE ROAD

# 984

Howe Road  
Martinez | CA

FOR INFORMATION PLEASE CONTACT:

**GRADEN TRAVIS**

Senior Managing Director  
925 974 0104  
graden.travis@nmrk.com  
LIC #00871716

**TYLER EPTING**

Managing Director  
925 974 0238  
tyler.epting@cushwake.com  
LIC #01317533



**CUSHMAN &  
WAKEFIELD**

# FLOOR PLAN

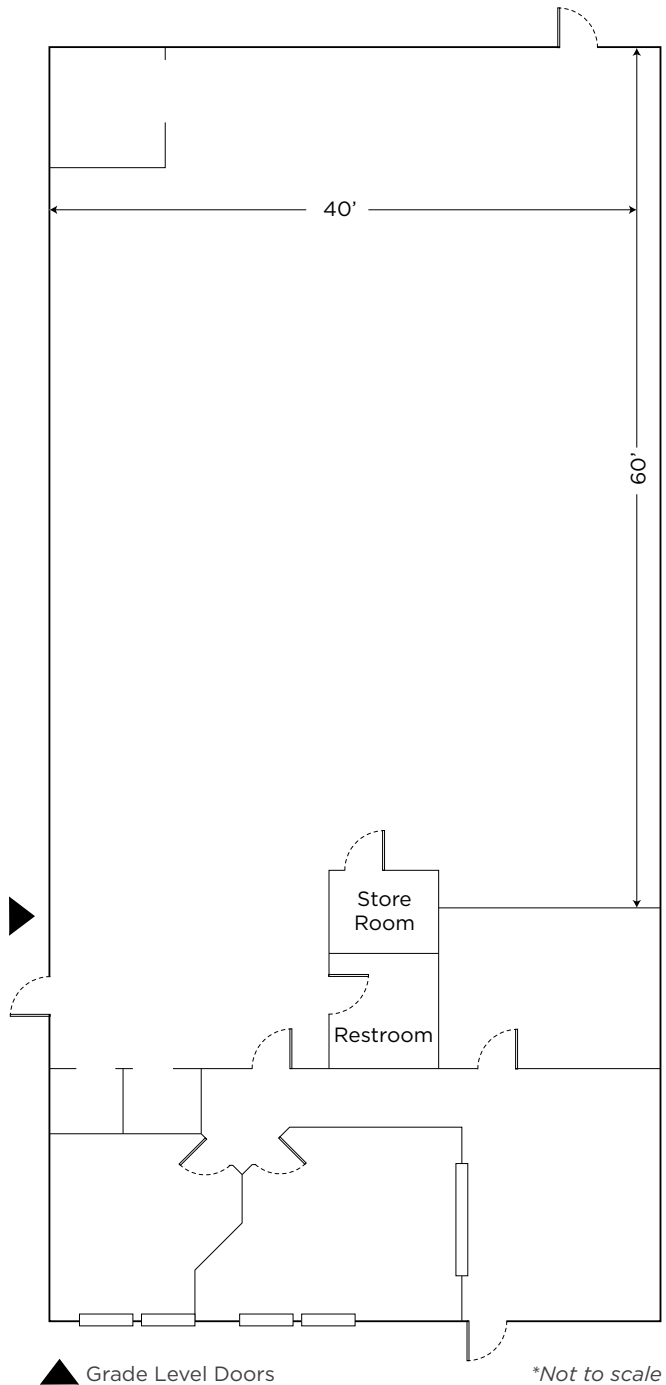

## PROPERTY HIGHLIGHTS

- ±3,840 SF TOTAL
- ±1,000 SF OF OFFICES
- 17' CEILING CLEARANCE
- ONE (1) 12' X 14' GRADE LEVEL ROLL-UP
- 100 AMPS, 120/208V, 3-PHASE ELECTRICAL
- 1.5/1000 PARKING RATIO

# SITE PLAN





# 984 Howe Road Martinez | CA

FOR INFORMATION PLEASE CONTACT:

**GRADEN TRAVIS**

Senior Managing Director  
925 974 0104  
graden.travis@nmrk.com  
LIC #00871716

**TYLER EPTING**

Managing Director  
925 974 0238  
tyler.epting@cushwake.com  
LIC #01317533

©2026 Cushman & Wakefield. All rights reserved. The information contained in this communication is strictly confidential. This information has been obtained from sources believed to be reliable but has not been verified. NO WARRANTY OR REPRESENTATION, EXPRESS OR IMPLIED, IS MADE AS TO THE CONDITION OF THE PROPERTY (OR PROPERTIES) REFERENCED HEREIN OR AS TO THE ACCURACY OR COMPLETENESS OF THE INFORMATION CONTAINED HEREIN, AND SAME IS SUBMITTED SUBJECT TO ERRORS, OMISSIONS, CHANGE OF PRICE, RENTAL OR OTHER CONDITIONS, WITHDRAWAL WITHOUT NOTICE, AND TO ANY SPECIAL LISTING CONDITIONS IMPOSED BY THE PROPERTY OWNER(S). ANY PROJECTIONS, OPINIONS OR ESTIMATES ARE SUBJECT TO UNCERTAINTY AND DO NOT SIGNIFY CURRENT OR FUTURE PROPERTY PERFORMANCE.

