

FOR LEASE : ±46,080 SF END UNIT

26511 Danti Court

Hayward, California



PROPERTY FEATURES

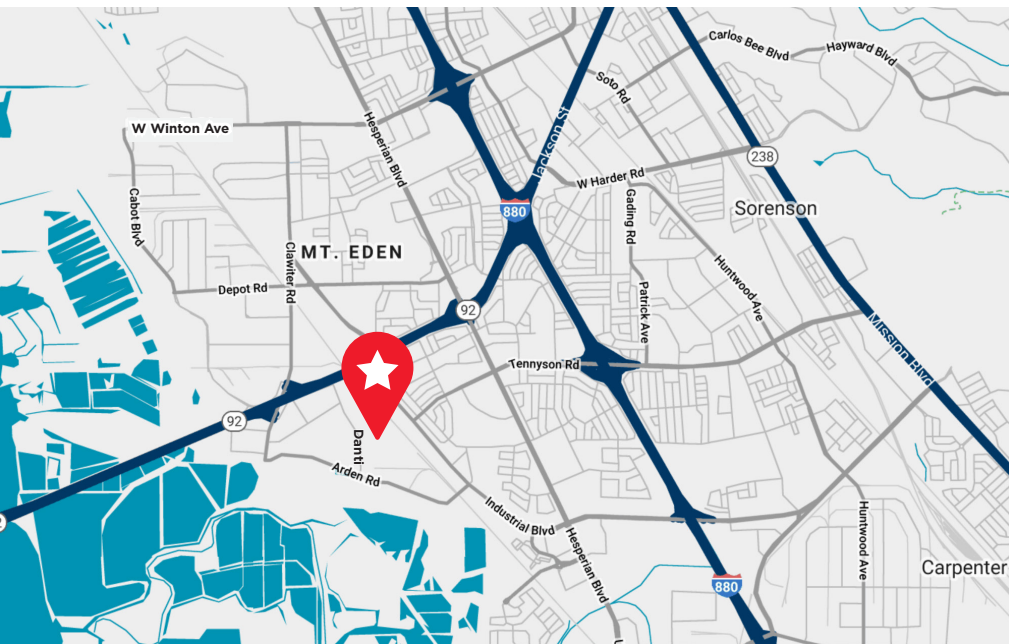

Size:	± 46,080 SF
Office:	± 2,825 SF
Location:	26511 Danti Ct, Hayward End Unit In Bldg M
Docks:	Twelve (12)
Drive-In Doors:	Three (3)
Clear Height:	± 24'
Sprinklers:	0.33/3,750 GPM
Yard:	± 24,000 SF Yard Can be Secured
Business Park:	10 Buildings totaling 1,200,000 SF
Freeway Access:	Hwy 92 & I-880
Lease Rate:	Please Contact Agents
Operating Expenses:	±\$0.25 PSF

SITE PLAN

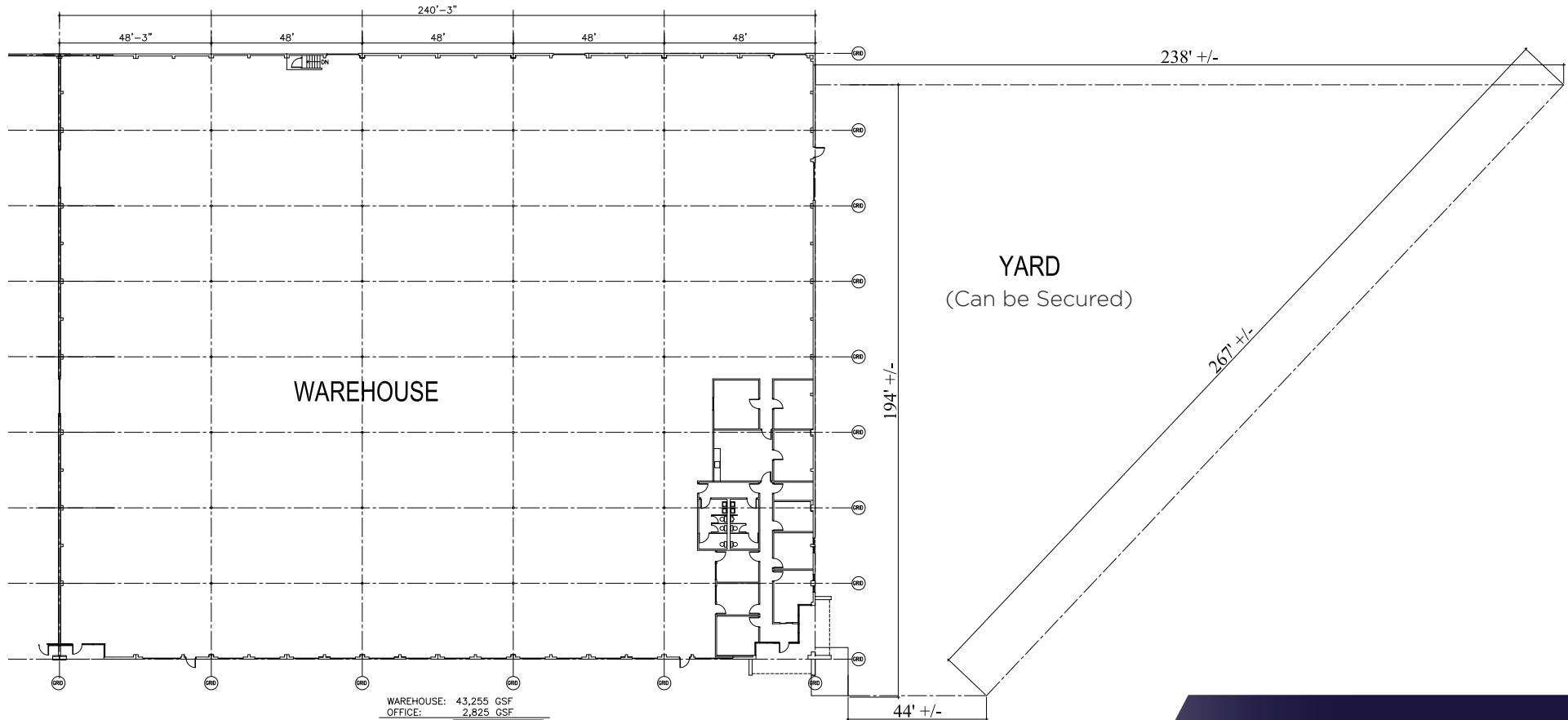

WAREHOUSE: 43,255 GSF
OFFICE: 2,825 GSF
GROSS AREA: 46,080 GSF +/-

1
A1

26511 DANTI COURT

SCALE: 1/16"=1'-0"

**± 46,080 SF
WAREHOUSE**

SITE PLAN

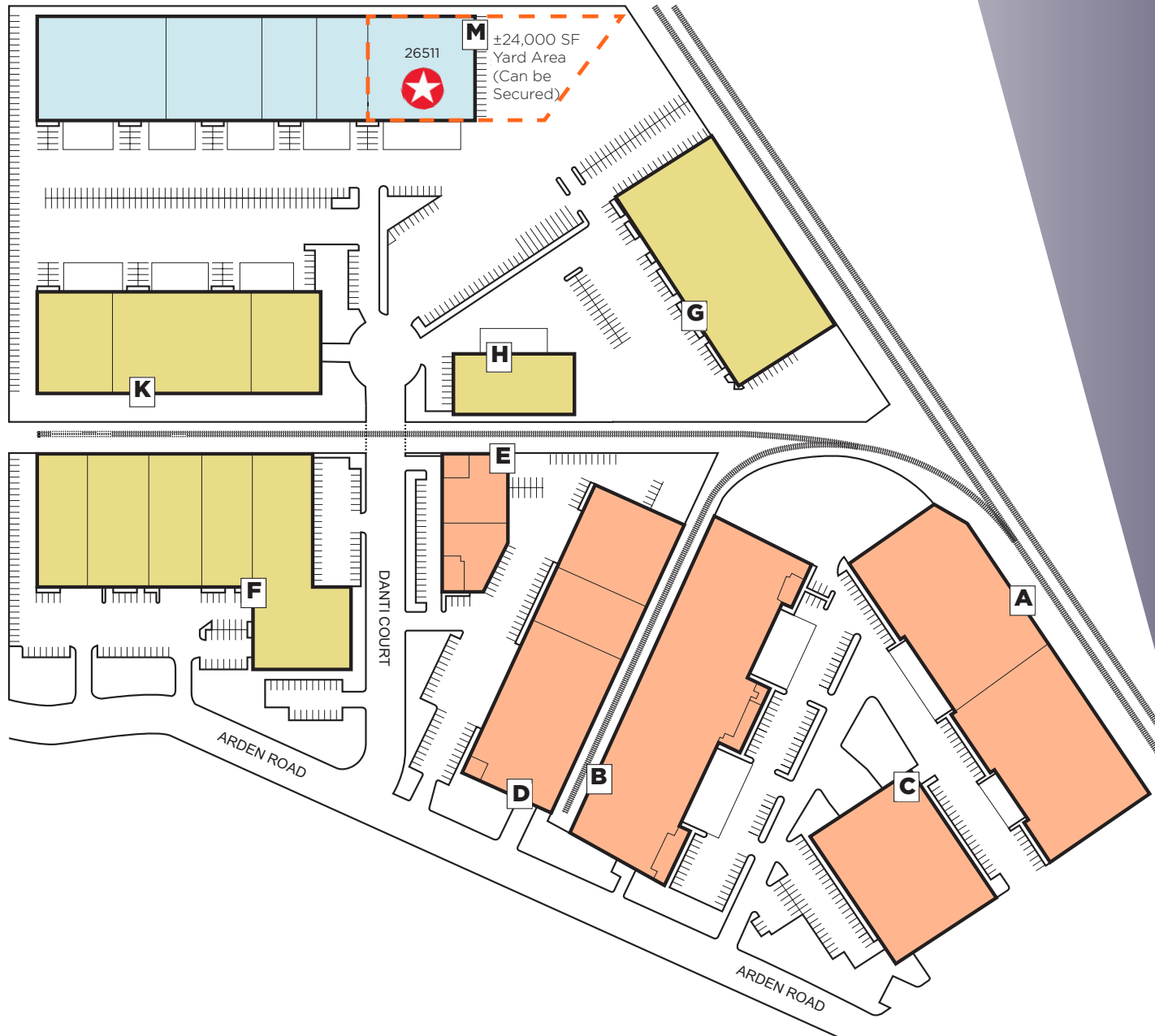

CONTACT

JAY HAGGLUND, SIOR
Executive Managing Director
+1 510 918 7922
jay.hagglund@cushwake.com
LIC #00888011

JEFF STARKOVICH, SIOR
Executive Managing Director
+1 510 267 6020
jeff.starkovich@cushwake.com
LIC #00644571

KATE WOODCOX, SIOR
Managing Director
+1 925 785 5425
kate.woodcox@cushwake.com
LIC #01809900