

FOR LEASE

17005 Westfield Park Road
Westfield, IN 46074

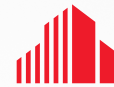

CUSHMAN &
WAKEFIELD



Property Highlights

Total Building SF	±45,166 SF	Clear Height	±19'-21' to bottom of beams
Available SF	±23,350 SF	HVAC	Gas-fired heating units
Office	±2,850 SF	Zoning	EI (Enclosed Industrial)
Acreage	±2.7 acres	Parking	17 spaces for tenant
Drive-ins	One ±12' wide x ±14' tall drive-in door	Base Rent/SF	\$8.50/SF NNN
Docks	Two 8' wide x 10' tall	Est. Opex	\$2.00/SF
Electrical	<u>Two (2) Panels</u> 1) 277/408V, 200 amp panel (42 circuits) feeding a transformer to a 120/208V, 200 amp panel 2) 277/408V, 200 amp panel (42 circuits) feeding a transformer to a 120/208V, 200 amp panel		

FOR LEASE

17005 Westfield Park Road
Westfield, IN 46074

SITE PLAN

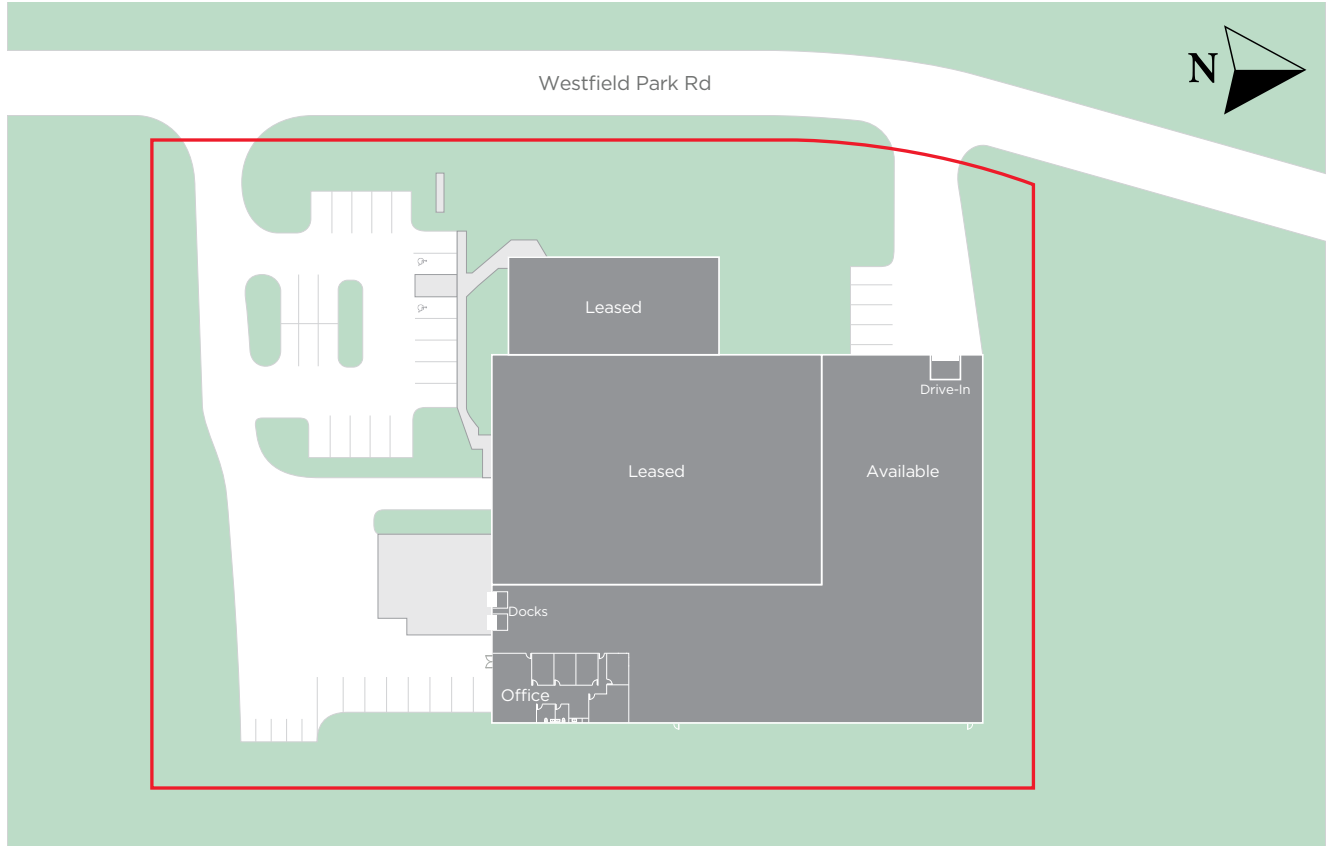



FOR LEASE

17005 Westfield Park Road
Westfield, IN 46074

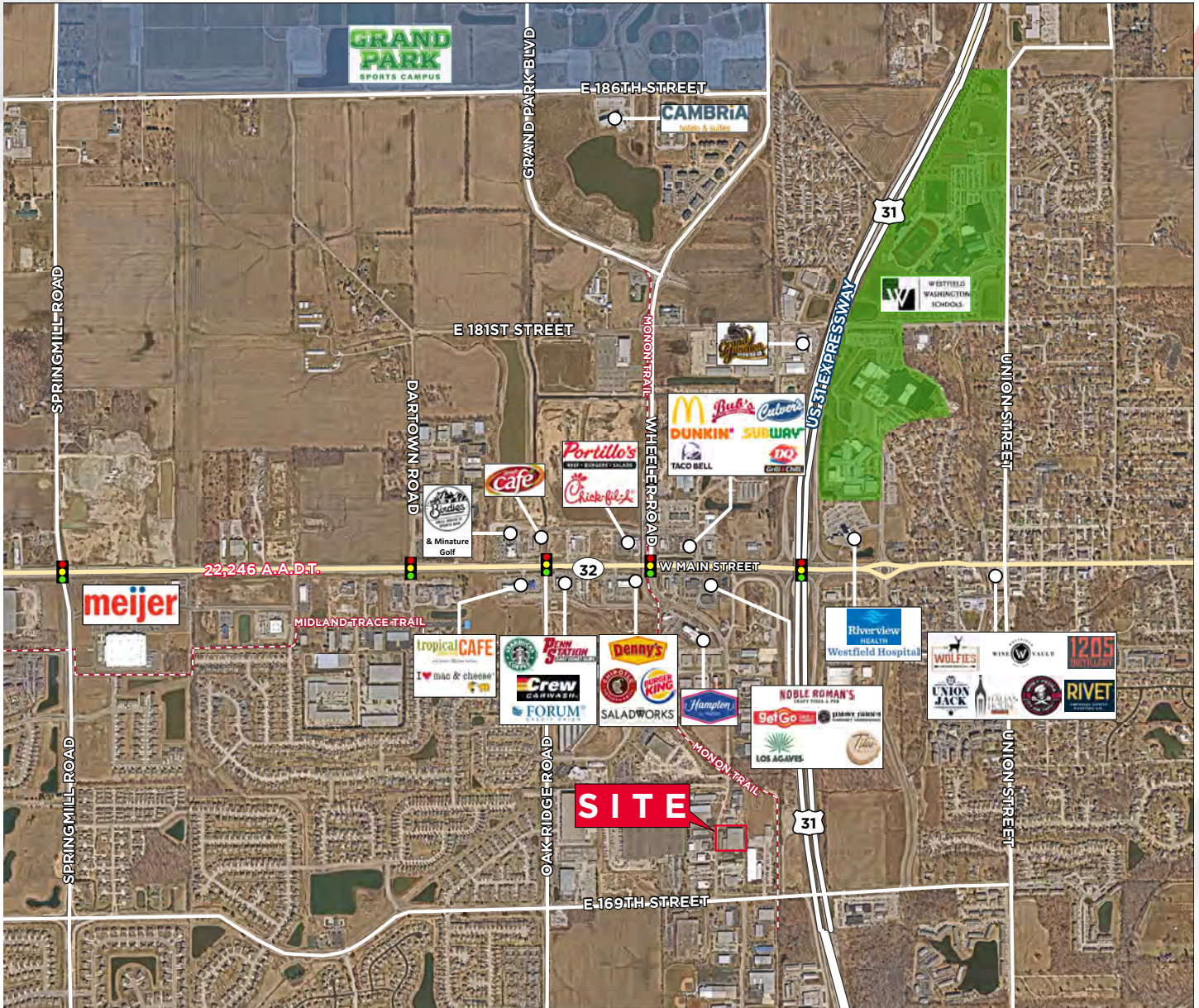

Contact

RYAN E. BAKER, SIOR, CCIM
Executive Managing Director
Certified Supply Chain Professional
+1 317 352 5428
ryan.baker@cushwake.com

One American Square, Suite 1800
Indianapolis, IN 46282
Main +1 317 634 6363
Fax +1 317 639 0504
cushwake.com