

*FOR SUBLEASE*

# 20 QUEEN STREET WEST

---

*TORONTO, ON*



*11,171 RSF*

## Property Highlights

---

**Premises:** Suite 2301A - 11,171 SF

---

**Availability:** Immediately

---

**Term:** October 29, 2029

---

**Net Rent:** Negotiable

---

**Additional Rent:** \$27.20 PSF (2026 Est.)

---

**Comments:**

- Fully furnished, move-in ready premises
- Efficient layout featuring a mix of open workspace with workstations, private offices, meeting rooms, a large kitchen, and a dedicated reception area
- Abundant natural light throughout
- Directly connected to the Eaton Centre and PATH system, providing seamless access to transit, retail, and amenities

11,171 RSF

# Property Photos



11,171 RSF

# Property Photos

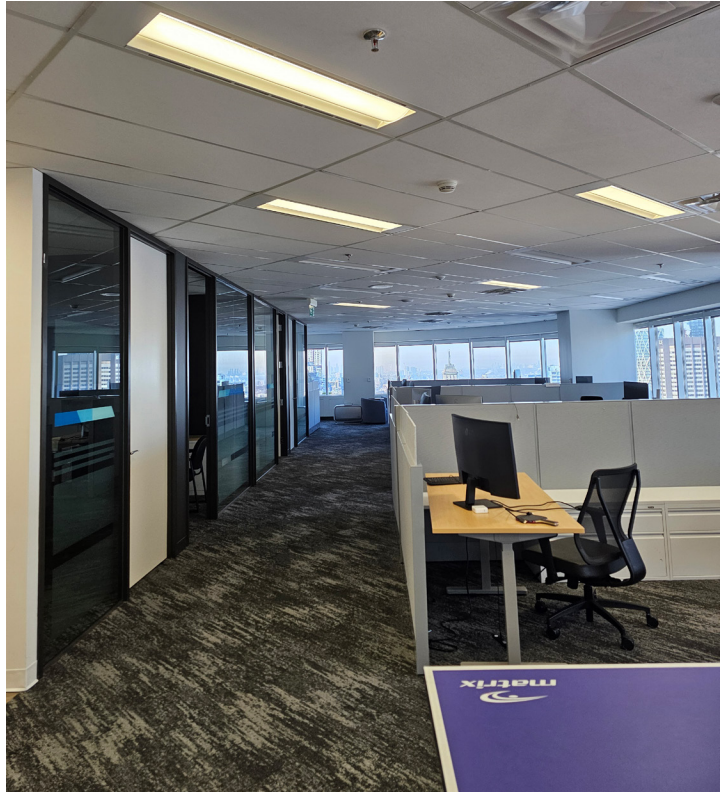

11,171 RSF

# Floor Plan

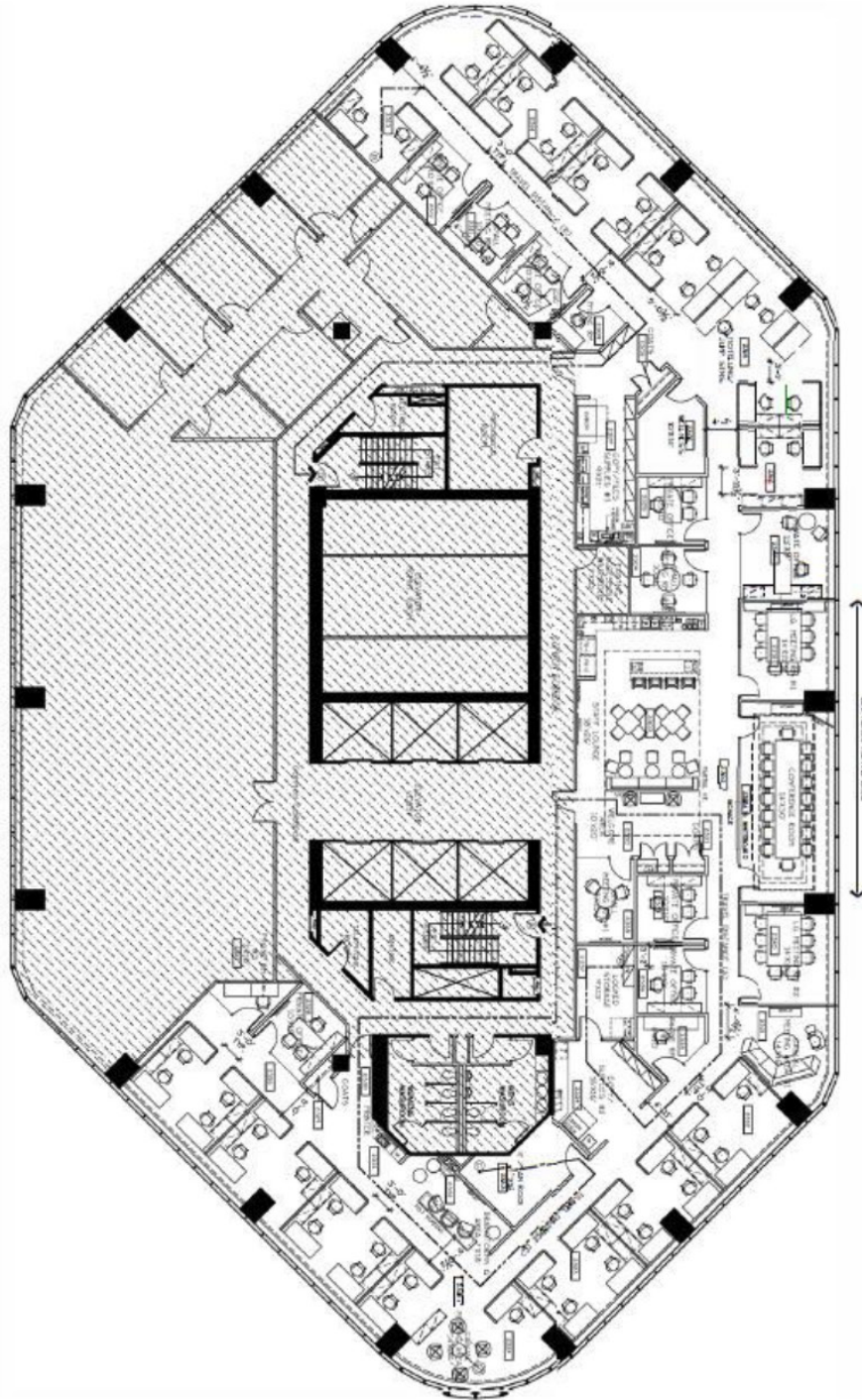

## FULLY FURNISHED OFFICE SPACE INCLUDES:

- o 49 workstations (sit/stand desks)
- o 7 offices
- o 1 large boardroom
- o 4 meetings rooms
- o Kitchen and reception
- o Excellent views and natural light

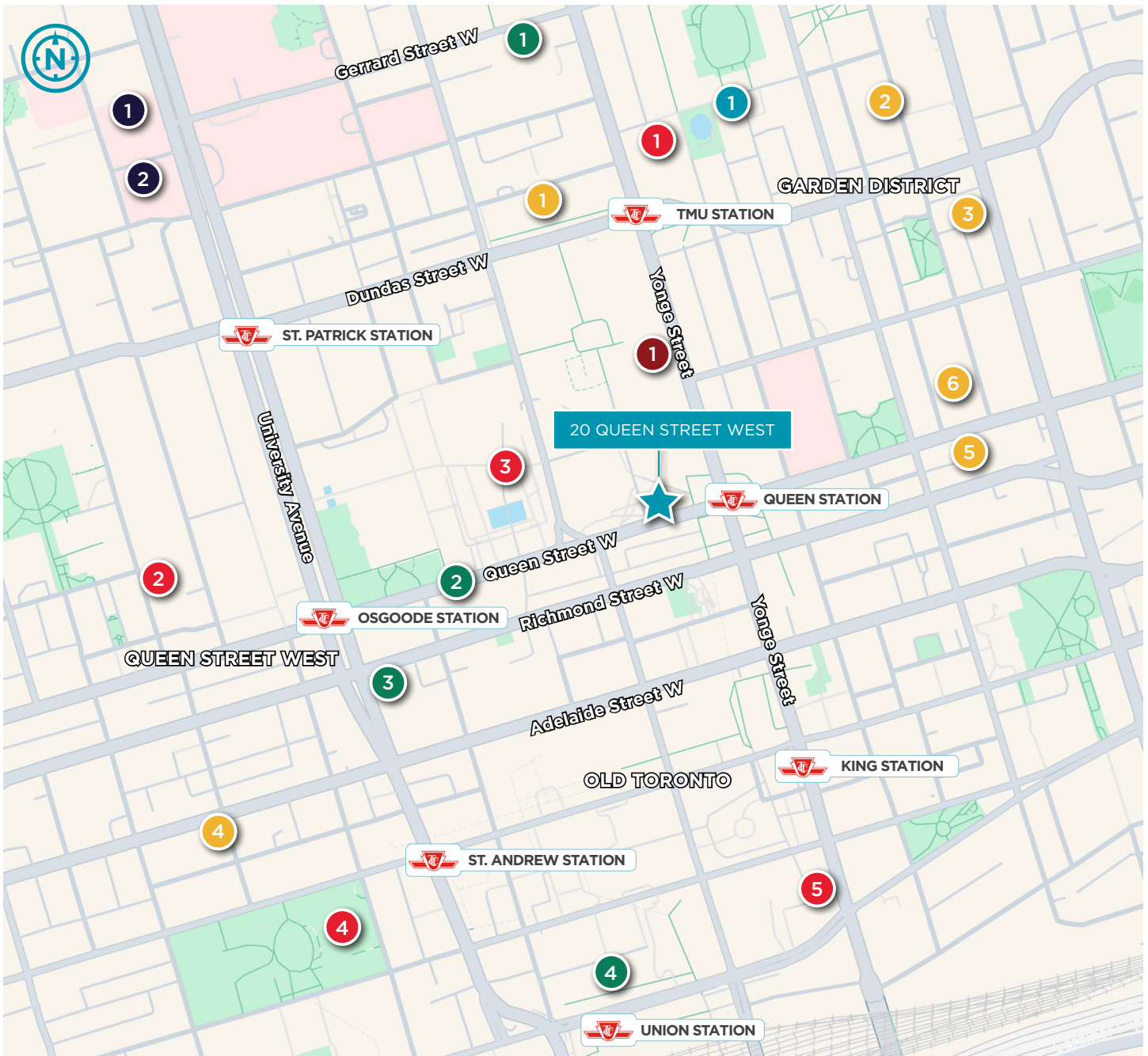

# Area Amenities

## RESTAURANTS

1. Atrium
2. Charcoal Kebab House
3. J San
4. PAI
5. The Carbon Bar
6. 10 Dean

## SCHOOL

1. Toronto Metropolitan University (TMU)

## HEALTH CARE

1. Sinai Health
2. University Health Network (UHN)

## HOTEL

1. Chelsea Hotel
2. Sheraton
3. Hilton
4. Fairmont Royal York

## LANDMARK

1. Little Canada
2. CN Tower
3. Toronto City Hall
4. Roy Thomson Hall
5. Hockey Hall of Fame (HHOF)

## SHOPPING MALL

1. CF Toronto Eaton Centre

## CONTACT INFORMATION

### SABRINA OLIVER

*Associate*

416 359 2758

[sabrina.oliver@cushwake.com](mailto:sabrina.oliver@cushwake.com)

### ERIC SHAW

*Vice Chair*

416 505 0219

[eric.shaw@cushwake.com](mailto:eric.shaw@cushwake.com)

### LEE BILLINKOFF

*Executive Vice Chair*

416 359 2633

[lee.billinkoff@cushwake.com](mailto:lee.billinkoff@cushwake.com)

161 Bay Street  
TD Canada Trust Tower  
Toronto, Ontario M5J 2S1  
[cushmanwakefield.com](http://cushmanwakefield.com)