



99,007 SF AVAILABLE

TAMPA EAST INDUSTRIAL PARK

1801 MASSARO BLVD
TAMPA, FL 33619

FOR MORE INFORMATION, CONTACT:

LISA ROSS, SIOR
Executive Director
+1 813 760 3209
lisa.ross@cushwake.com

TREY CARSWELL, SIOR
Executive Director
+1 813 230 6131
trey.carswell@cushwake.com

SAM KOROLOS
Director
+1 704 989 1327
sam.korolos@cushwake.com

MELISSA WATTERWORTH
Senior Associate
+1 813 599 2190
melissa.watterworth@cushwake.com

1801
MASSARO

PROPERTY FEATURES



AVAILABLE SF 99,007 SF

OFFICE SF 5,012 SF

CLEAR HEIGHT 26' - 33'

LOADING

- Seven (7) Oversized Dock High Doors [14 Trailer Spots]
- Three (3) Grade Level Doors
- Six (6) Rail Served Doors

COLUMN SPACING 50' x 24'

RAIL Rail Served

AVAILABLE 1/1/2027

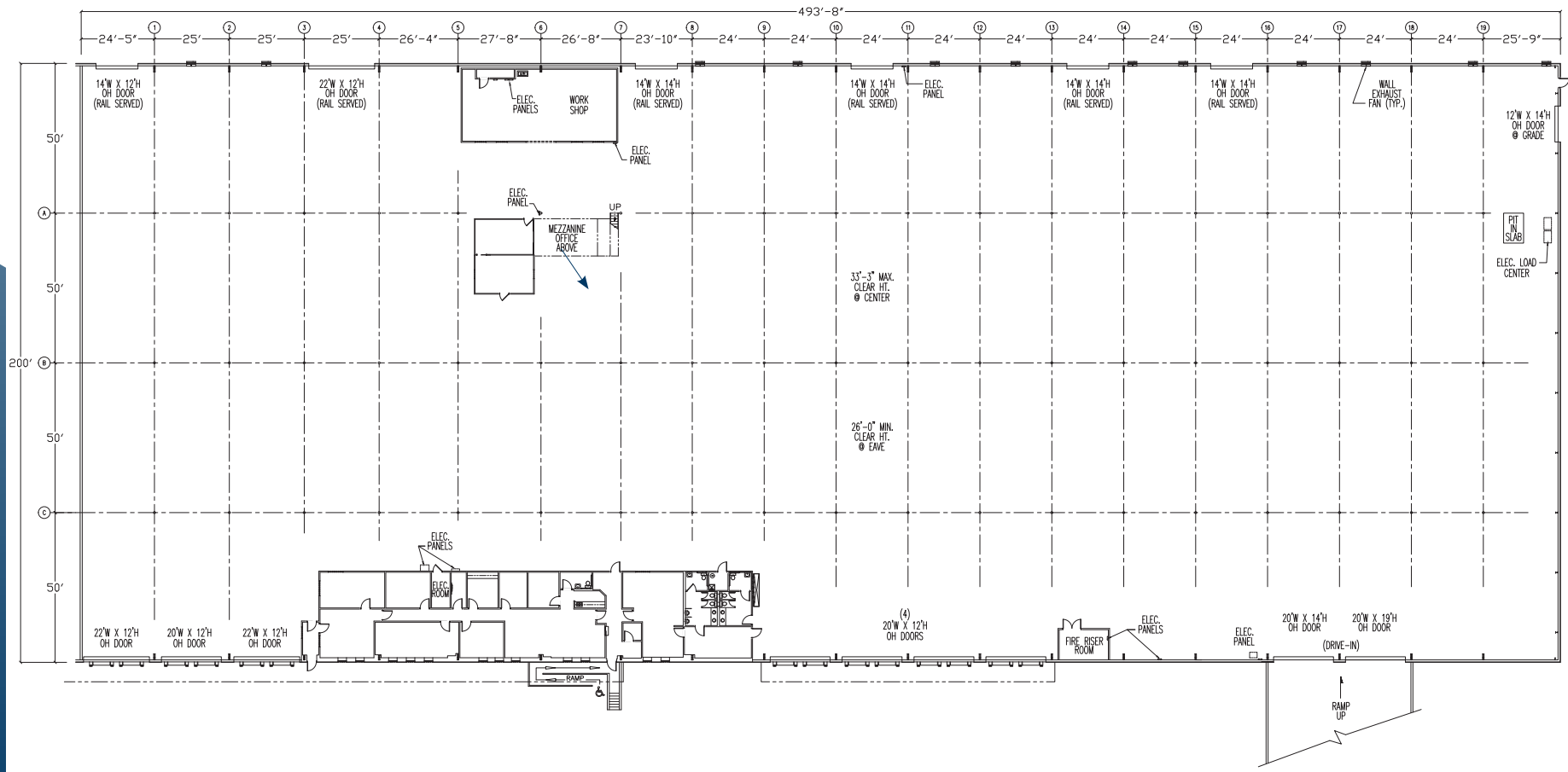

PROPERTY HIGHLIGHTS

2.4 MILES

TO



SELMON EXPRESSWAY

2.8 MILES

TO



0.5 MILES

TO



US HWY 301

3.0 MILES

TO

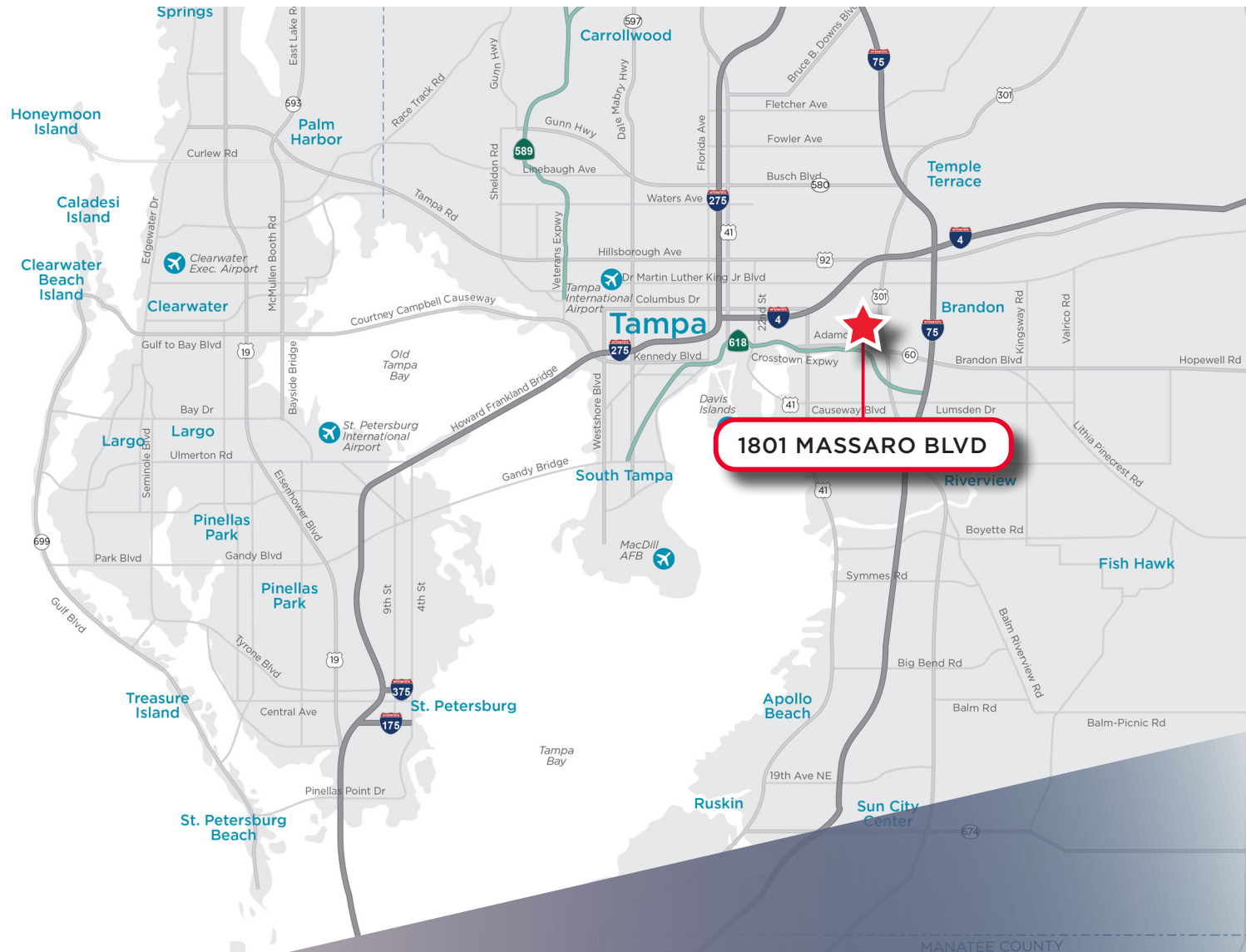

1801 MASSARO BLVD



FOR MORE INFORMATION, CONTACT:

LISA ROSS, SIOR

Executive Director

+1 813 760 3209

lisa.ross@cushwake.com

TREY CARSWELL, SIOR

Executive Director

+1 813 230 6131

trey.carswell@cushwake.com

SAM KOROLOS

Director

+1 704 989 1327

sam.korolos@cushwake.com

MELISSA WATTERWORTH

Senior Associate

+1 813 599 2190

melissa.watterworth@cushwake.com

©2026 Cushman & Wakefield. All rights reserved. The information contained in this communication is strictly confidential. This information has been obtained from sources believed to be reliable but has not been verified. NO WARRANTY OR REPRESENTATION, EXPRESS OR IMPLIED, IS MADE AS TO THE CONDITION OF THE PROPERTY (OR PROPERTIES) REFERENCED HEREIN OR AS TO THE ACCURACY OR COMPLETENESS OF THE INFORMATION CONTAINED HEREIN, AND SAME IS SUBMITTED SUBJECT TO ERRORS, OMISSIONS, CHANGE OF PRICE, RENTAL OR OTHER CONDITIONS, WITHDRAWAL WITHOUT NOTICE, AND TO ANY SPECIAL LISTING CONDITIONS IMPOSED BY THE PROPERTY OWNER(S). ANY PROJECTIONS, OPINIONS OR ESTIMATES ARE SUBJECT TO UNCERTAINTY AND DO NOT SIGNIFY CURRENT OR FUTURE PROPERTY PERFORMANCE.