

FOR LEASE 101,259 SF



2199 HITZERT COURT FENTON, MO 63026



PROPERTY HIGHLIGHTS

TOTAL BUILDING AREA:	534,871 SF
TOTAL AVAILABLE AREA:	101,259 SF
OFFICE AREA:	±5,500 SF
CLEAR HEIGHT:	28'
BUILDING DEPTH:	225'
LOADING:	17 Docks
TRUCK COURT:	130' Deep, Paved Concrete
RAIL SERVICE:	BJRY Rail Spur On Site
FIRE SUPPRESSION:	ESFR
POWER:	800 Amps, 480/277V
LEASE RATE:	\$6.95/SF NNN

LOCATION

Strategically located minutes from I-44, I-270, and Hwy 141

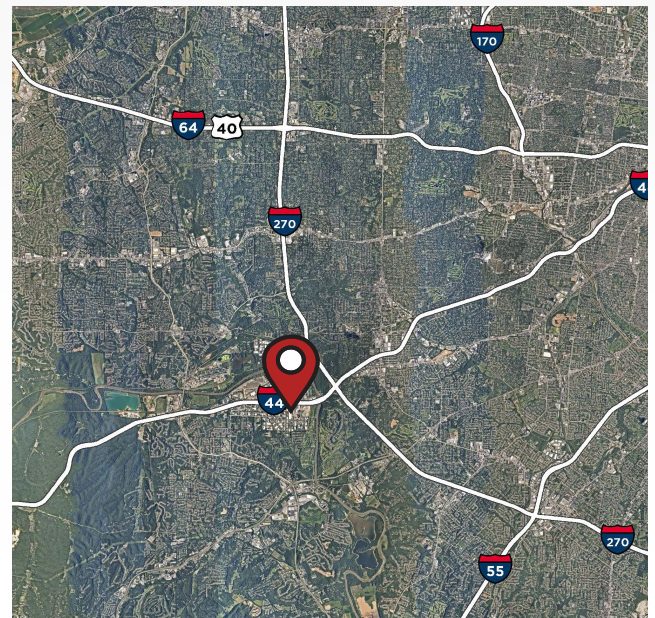

MATT EASTIN, SIOR, CCIM
Executive Director
+1 314 746 0350
matt.eastin@cushwake.com

ED LAMPITT, SIOR, CCIM
Vice Chair
+1 314 746 0383
ed.lampitt@cushwake.com

OWNED & MANAGED BY
 **SEALY & COMPANY**

LEASING BY
 **CUSHMAN & WAKEFIELD**

FOR LEASE 101,259 SF

2199 HITZERT COURT | FENTON, MO

SITE PLAN

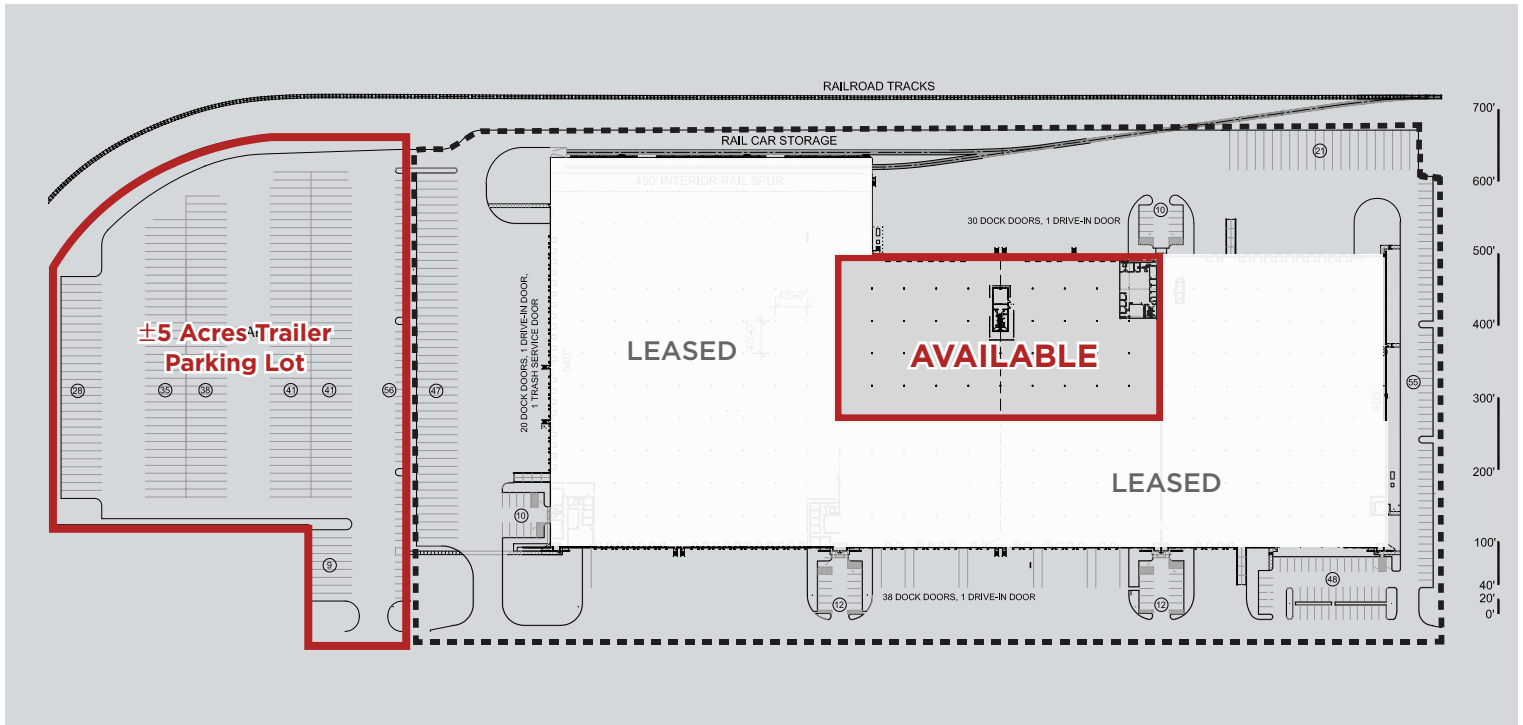

AERIAL & PHOTOS



FOR MORE INFORMATION, PLEASE CONTACT:

MATT EASTIN, SIOR, CCIM
Executive Director
 +1 314 746 0350
 matt.eastin@cushwake.com

ED LAMPITT, SIOR, CCIM
Vice Chair
 +1 314 746 0383
 ed.lampitt@cushwake.com

OWNED & MANAGED BY



LEASING BY

