

OLYMPIC INDUSTRIAL PARK



FOR MORE INFORMATION:

CONNOR CREE

206.521.0289

connor.cree@cushwake.com

PATRICK MULLIN

206.521.0265

patrick.mullin@cushwake.com

ANDREW SHULTZ

206.215.1645

andrew.shultz@cushwake.com

CUSHMAN & WAKEFIELD

601 Union Street, Suite 1100

Seattle, WA 98101

www.cushmanwakefield.com



19111 DES MOINES MEMORIAL DR | SUITE F | SEATAC, WA 98148

PROPERTY FEATURES

- Available Now
- 17,507 SF Available
- 1,406 SF Office
- 8 Dock High Doors
- 1 Ramp Door
- 21'6"-23' Clear Height
- Excellent Regional Access via I-5, Hwy-99, and the Future SR-509 Extension
- Contact Brokers for Rates

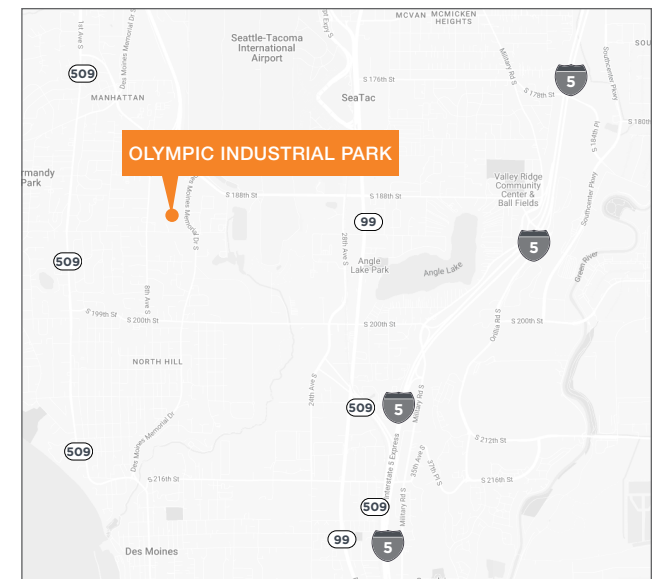

The information contained herein is believed to be accurate but is not warranted as to its accuracy and may change or be updated without notice. Seller or landlord makes no representation as to the environmental condition of the property and recommends purchaser's or tenant's independent investigation.

OLYMPIC INDUSTRIAL PARK

SITE PLAN

UNDER NEW OWNERSHIP

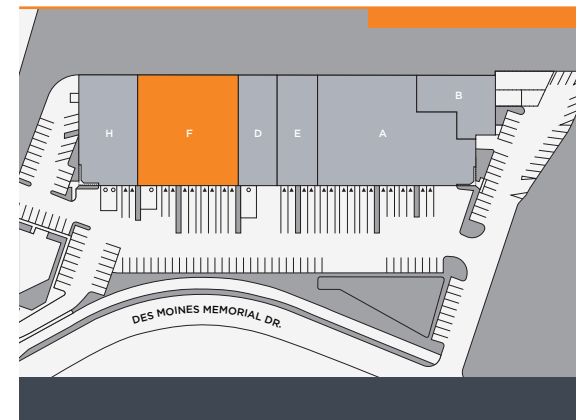
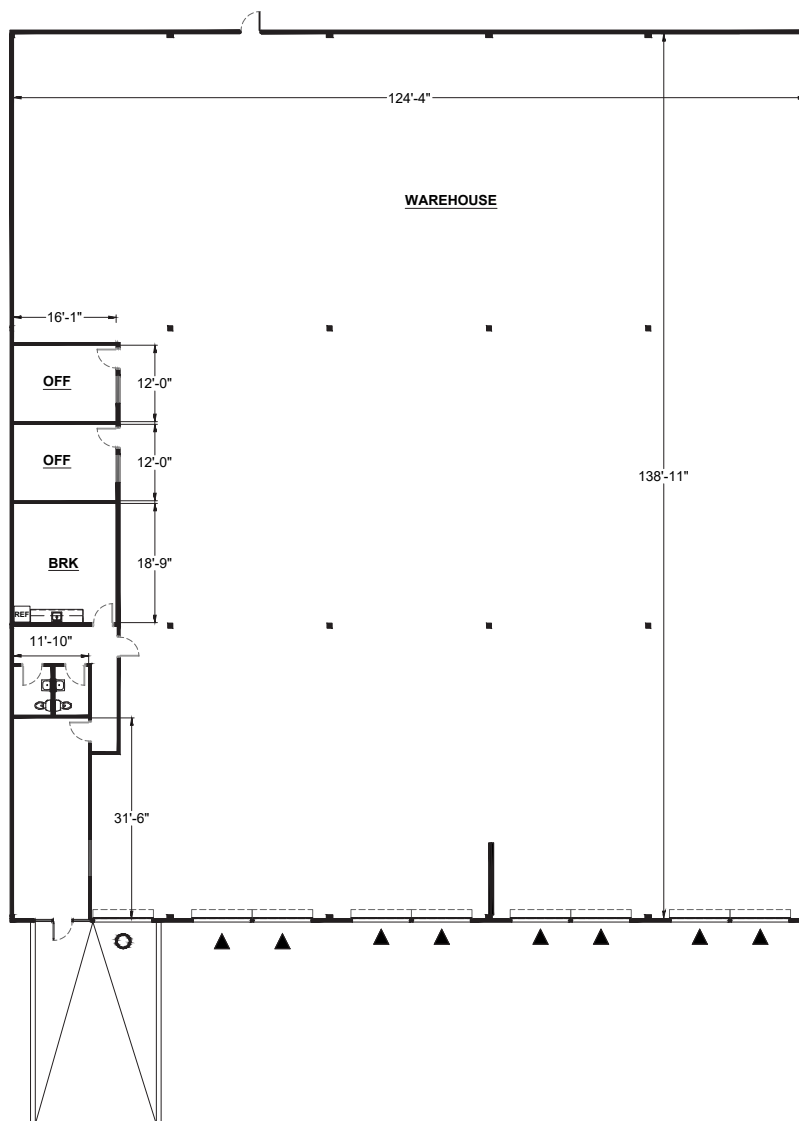

FOR MORE INFORMATION

CONNOR CREE
206.521.0289
connor.cree@cushwake.com

PATRICK MULLIN
206.521.0265
patrick.mullin@cushwake.com

ANDREW SHULTZ
206.215.1645
andrew.shultz@cushwake.com

CUSHMAN & WAKEFIELD
601 Union Street, Suite 1100
Seattle, WA 98101
www.cushmanwakefield.com

OLYMPIC INDUSTRIAL PARK
19111 DES MOINES MEMORIAL DR
SEATAC, WA 98148



AVAILABILITIES

AVAILABLE OCCUPIED

SUITE	TOTAL SF	OFFICE SF	ASKING RATE	AVAILABLE
F	17,507	1,406	Contact Brokers	Now

OLYMPIC INDUSTRIAL PARK

UNDER NEW OWNERSHIP



FOR MORE INFORMATION

CONNOR CREE

206.521.0289

connor.cree@cushwake.com

PATRICK MULLIN

206.521.0265

patrick.mullin@cushwake.com

ANDREW SHULTZ

206.215.1645

andrew.shultz@cushwake.com

CUSHMAN & WAKEFIELD

601 Union Street, Suite 1100

Seattle, WA 98101

www.cushmanwakefield.com



OLYMPIC INDUSTRIAL PARK

19111 DES MOINES MEMORIAL DR

SEATAC, WA 98148



OLYMPIC INDUSTRIAL PARK

AMENITIES & IMPROVEMENTS

UNDER NEW OWNERSHIP

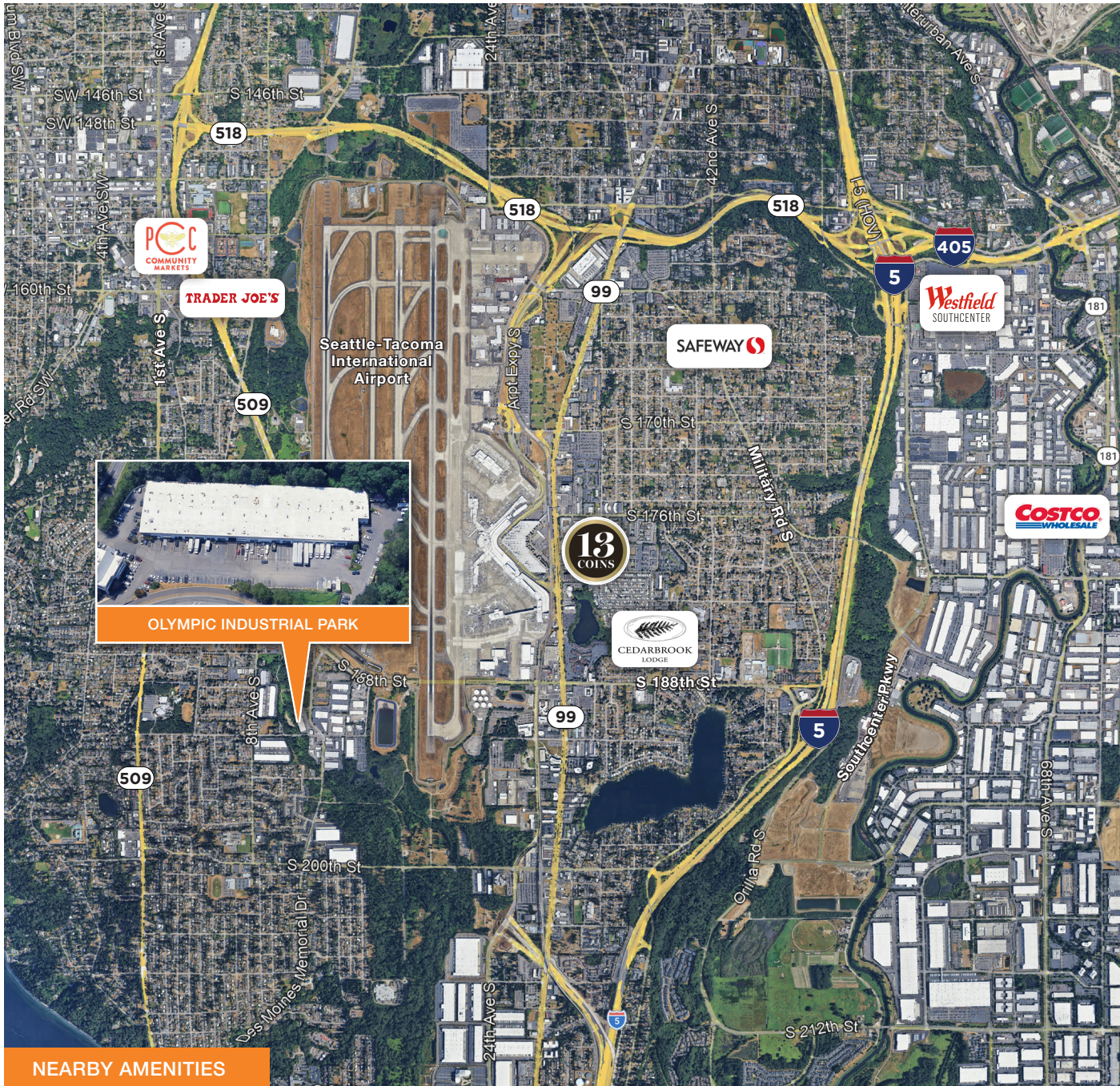

NEARBY AMENITIES

- 13 Coins
- Cedarbrook Lodge
- Costco
- PCC Community Markets
- Safeway
- Trader Joe's
- Westfield Southcenter

FOR MORE INFORMATION

CONNOR CREE

206.521.0289
connor.cree@cushwake.com

PATRICK MULLIN

206.521.0265
patrick.mullin@cushwake.com

ANDREW SHULTZ

206.215.1645
andrew.shultz@cushwake.com

CUSHMAN & WAKEFIELD

601 Union Street, Suite 1100
Seattle, WA 98101
www.cushmanwakefield.com

OLYMPIC INDUSTRIAL PARK
19111 DES MOINES MEMORIAL DR
SEATAC, WA 98148



NEARBY AMENITIES