



CUSHMAN &
WAKEFIELD

261 PRINCESS STREET

Kingston, ON

PRIME RETAIL OPPORTUNITY IN DOWNTOWN KINGSTON

WELCOME TO 261 PRINCESS STREET

Located in the heart of downtown Kingston, 261 Princess Street offers an exceptional retail opportunity in a shopping destination. Previously occupied by Indigo, this prime space is surrounded by top-tier national and independent retailers, benefiting from strong foot traffic and a vibrant downtown atmosphere. With excellent frontage along Princess Street, this location is ideal for a variety of retail uses.

Details

SIZE: Unit A: 1,888 SF

NET RENT: Contact Listing Agents

ADDITIONAL RENT: \$12.00 PSF (Est. 2026)

TERM: 5-10 Years

AVAILABILITY: Immediate

Highlights

- Building exterior work underway to create separate entrances
- Prime visibility with excellent signage opportunities in downtown Kingston
- Municipal and monthly tenant parking available
- Excellent building co-tenants

PROPERTY OVERVIEW



FLOORPLAN

Unit A - 1,888 SF

~~Unit B - 2,166 SF~~ LEASED

~~Unit C - 3,768 SF~~ LEASED

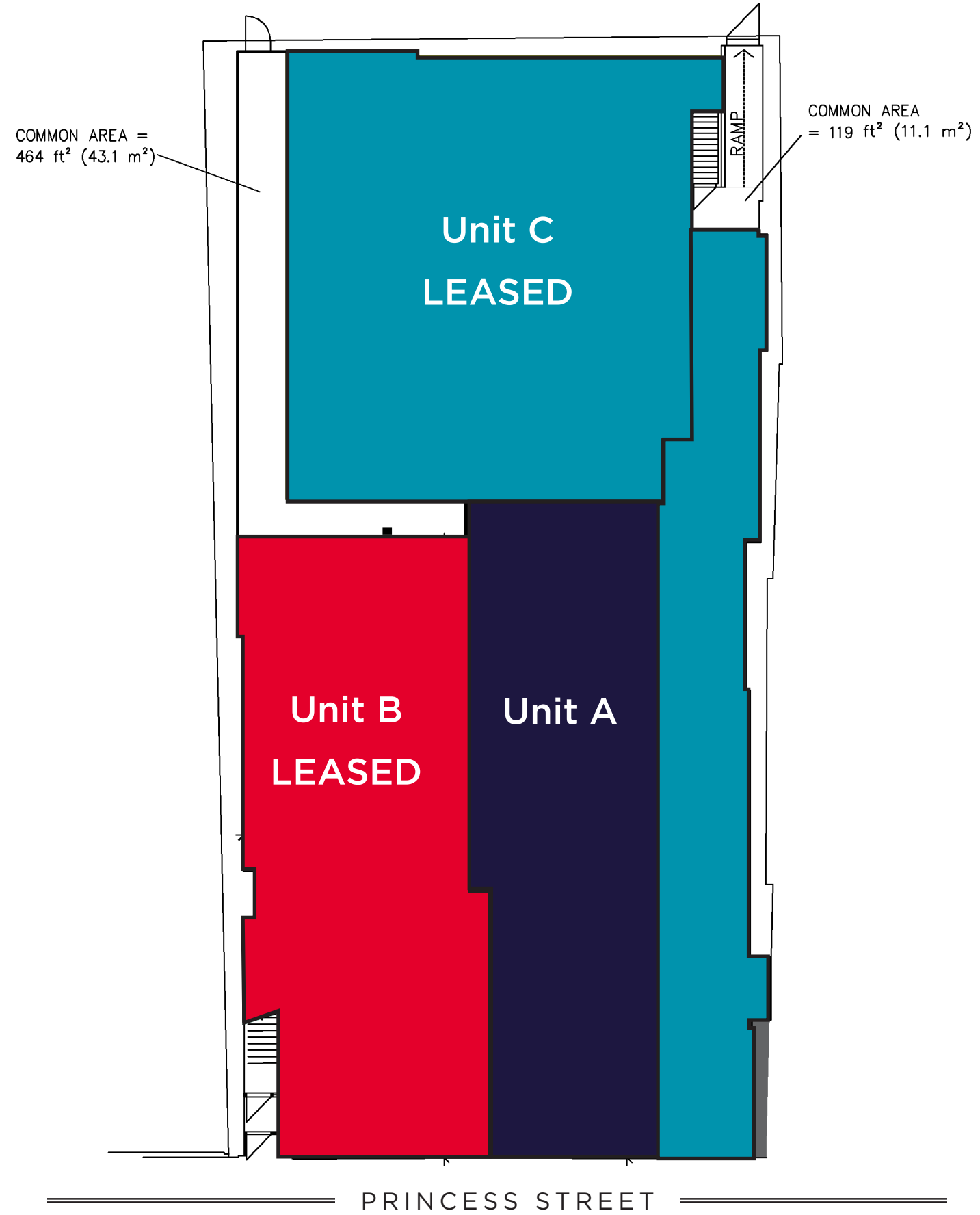

BUILDING RENDERING

EXTERIOR STOREFRONT



NEIGHBOURHOOD OVERVIEW

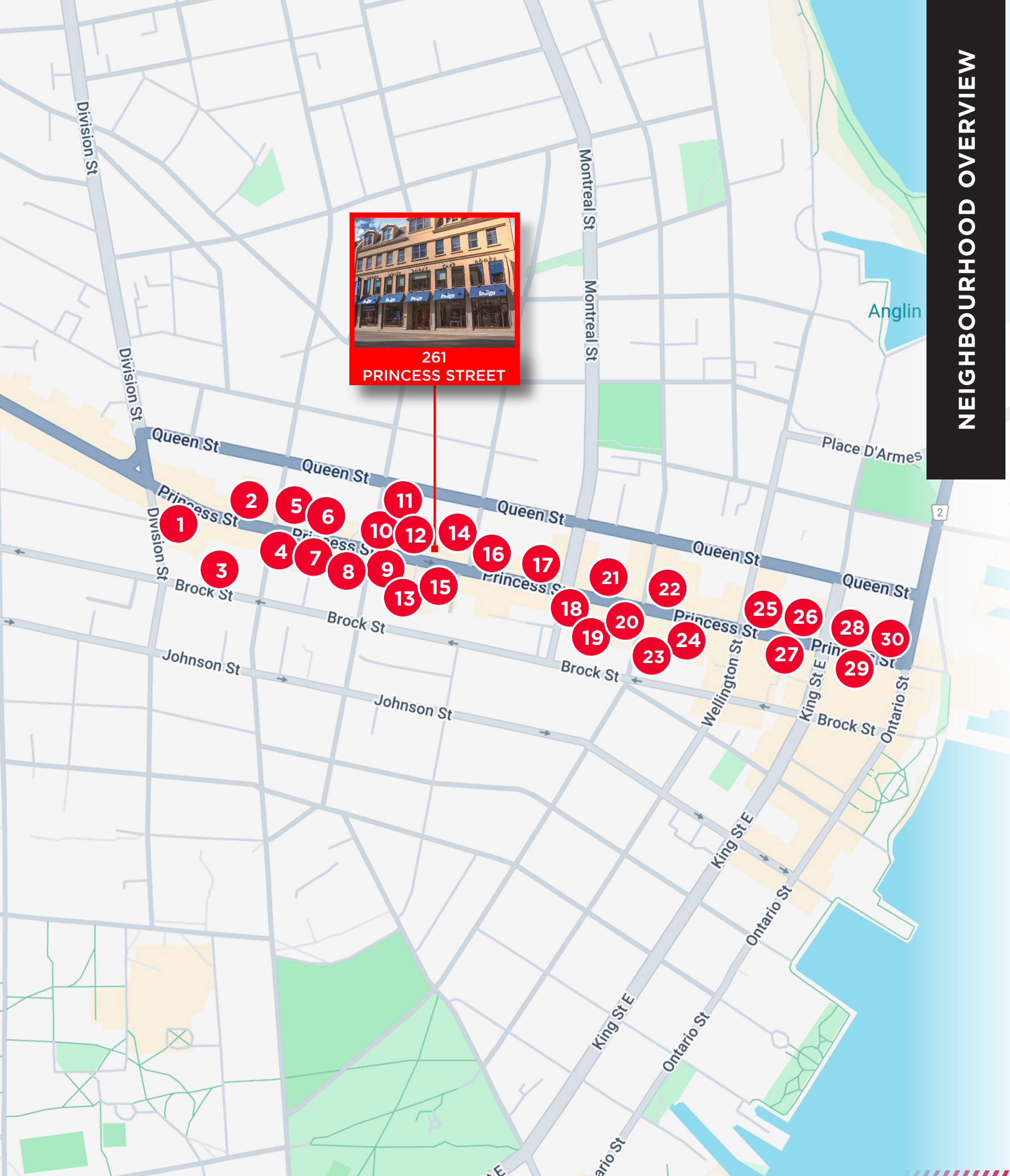

Neighbourhood Amenities

- | | |
|-----------------------------------|---------------------------------|
| 1. Edo Japan | 16. Roots |
| 2. Tommy's | 17. Urban Outfitters |
| 3. Metro | 18. Union Kitchen + Cocktails |
| 4. Pizza Studio | 19. Dollarama |
| 5. Loaded Pierogi | 20. Crave Coffee House & Bakery |
| 6. Osmow's Shawarma | 21. Grecos |
| 7. Tahini's | 22. Bulk Barn |
| 8. McDonalds | 23. Shoppers Drug Mart |
| 9. The WORKS Craft Burgers & Beer | 24. Dollar Tree |
| 10. Northside espresso + kitchen | 25. Starbucks |
| 11. Wine Rack | 26. RBC |
| 12. Freshii | 27. Chez Piggy Restaurant & Bar |
| 13. Lululemon | 28. Coffee & Company |
| 14. Balzac's Kitchen | 29. Pan Chancho Bakery & Café |
| 15. Eggtastic | 30. Milestones |

Demographics (1km)

- | | |
|---|--------------------------------|
| Population within 1 km
11,064 | Traffic Score
80 |
| Daytime Population
42,871.1 | Pedestrian Score
100 |
| Average Household Income
\$78,501 | Transit Score
62 |
| Median Age
37 | |



**CUSHMAN &
WAKEFIELD**

161 Bay Street, Suite 1500
Toronto, ON M5J 2S1 | Canada

CARMEN SIEGEL

Associate Vice President
+1 416 359 2365
+1 416 648 0451
carmen.siegel@cushwake.com

HANNAH KINNEY

Senior Associate
+1 416 359 2390
+1 647 294 0367
hannah.kinney@cushwake.com

CONTACT



©2026 Cushman & Wakefield ULC. All rights reserved. The information contained in this communication is strictly confidential. This information has been obtained from sources believed to be reliable but has not been verified. NO WARRANTY OR REPRESENTATION, EXPRESS OR IMPLIED, IS MADE AS TO THE CONDITION OF THE PROPERTY (OR PROPERTIES) REFERENCED HEREIN OR AS TO THE ACCURACY OR COMPLETENESS OF THE INFORMATION CONTAINED HEREIN, AND SAME IS SUBMITTED SUBJECT TO ERRORS, OMISSIONS, CHANGE OF PRICE, RENTAL OR OTHER CONDITIONS, WITHDRAWAL WITHOUT NOTICE, AND TO ANY SPECIAL LISTING CONDITIONS IMPOSED BY THE PROPERTY OWNER(S). ANY PROJECTIONS, OPINIONS OR ESTIMATES ARE SUBJECT TO UNCERTAINTY AND DO NOT SIGNIFY CURRENT OR FUTURE PROPERTY PERFORMANCE.