



LEASE AVAILABLE

Leased and Managed by:



ARROWRIDGE BUSINESS PARK

8227 Arrowridge Blvd., Charlotte, NC 28273

SUITE I - 4,860 SF



PROPERTY HIGHLIGHTS

- Class A Master Planned Business Park
- Arrowridge III - 48,600 total building SF
- Wet Sprinkler System
- 16' Clear Height
- Rear-Loading Dock Location
- Zoned I-1
- Easy Access to I-77 and I-485
- ±10 Miles from CLT Airport
- ±8 Miles from Uptown

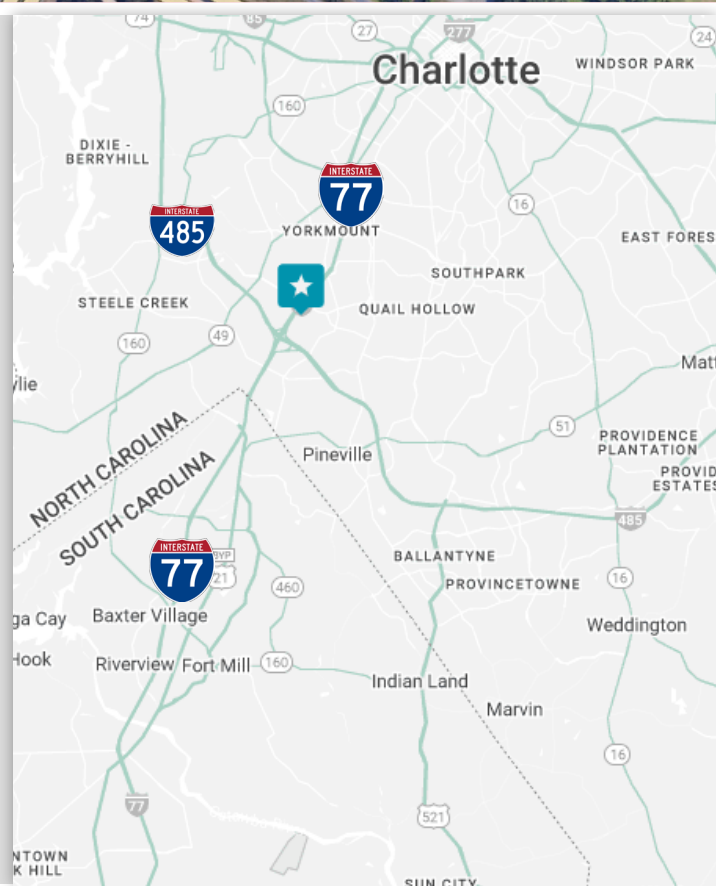

FLOOR PLAN

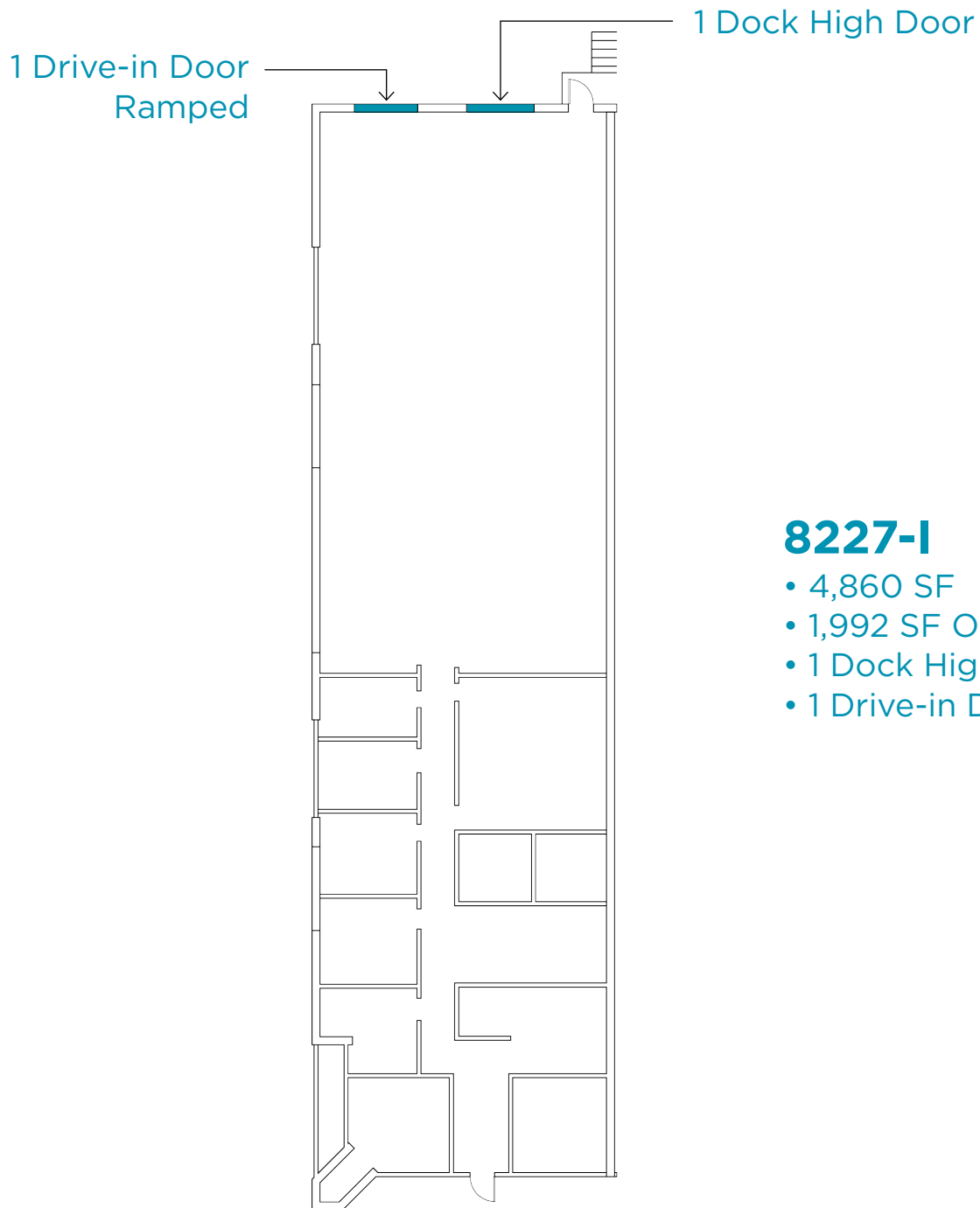

8227-1

- 4,860 SF
- 1,992 SF Office
- 1 Dock High Door
- 1 Drive-in Door

For more information, please contact:

ERIN TURULSKI

Senior Associate
+1 704 916 1565
erin.turulski@cushwake.com

FRANCES CRISLER

Director
+1 704 620 6014
france.crisler@cushwake.com

300 S. Tryon, Suite 1110
Charlotte, NC 28202
cushmanwakefield.com