



Center 53

3RD FLOOR

**UP TO 36,516 RSF
FOR SUBLEASE**

\$28.00 PSF

CENTER 53

433 WEST ASCENSION WAY
MURRAY, UT



**CUSHMAN &
WAKEFIELD**



CAMPUS OVERVIEW

- Newly built high end campus
- Full service fitness center with showers
- Conference center with catering area, vending amenities, and exterior entry points
- Structured parking with covered access
- Centrally located with direct access to I-15 and I-215
- Walking distance to TRAX and FrontRunner stations
- Food truck area with a rotating truck schedule
- On-site property management

CENTER 53 | THIRD FLOOR

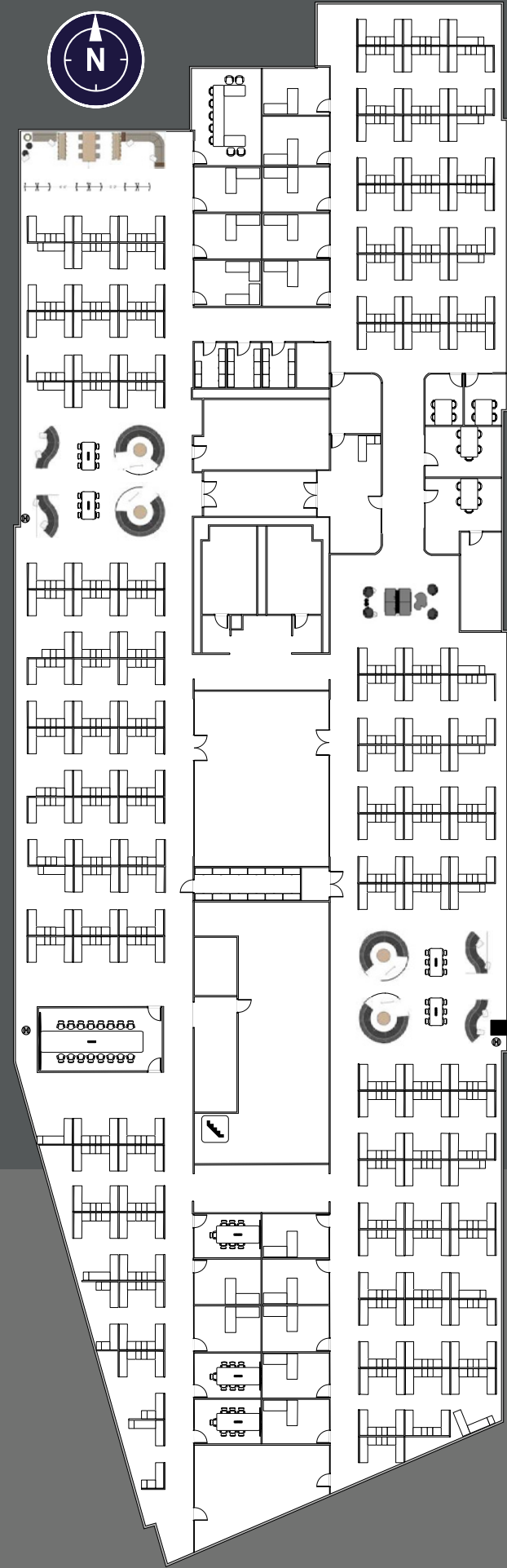
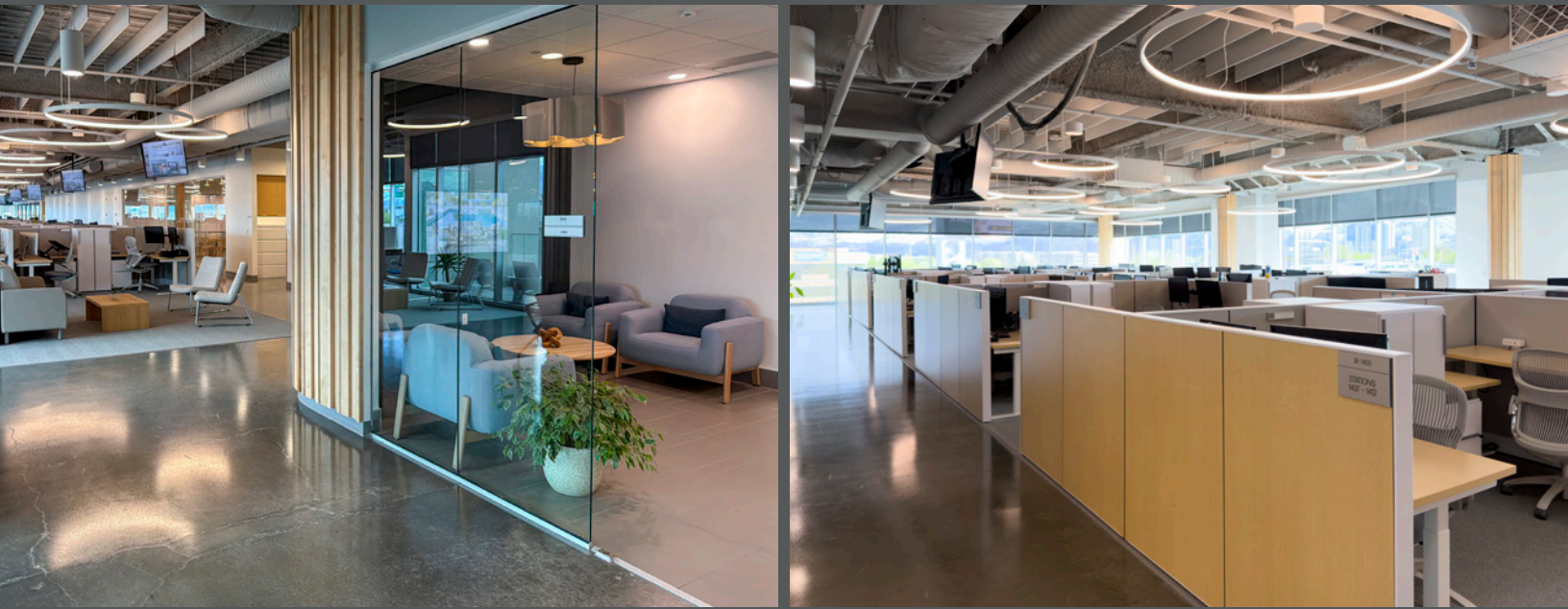

SPACE OVERVIEW

- Newly built out plug n play space
- Healthy mix of open workspace, offices, and collaboration areas
- High tech finishes with glass throughout
- Two break rooms
- Floor to ceiling glass with views of Mount Olympus
- East facing private exterior deck



CENTER 53 | THIRD FLOOR

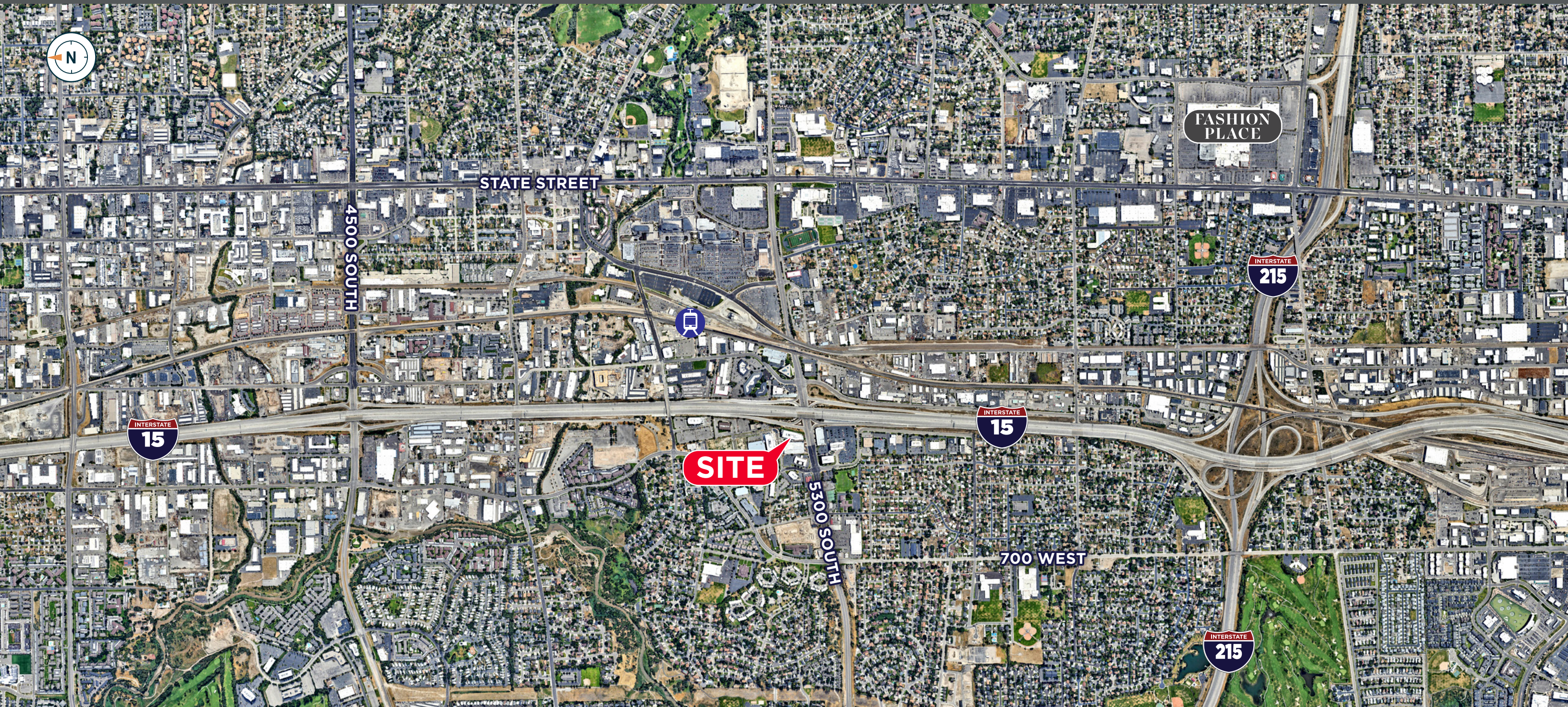

LOCATION HIGHLIGHTS

2 MINUTES FROM



14 MINUTES FROM



SALT LAKE CITY
INTERNATIONAL

12 MINUTES FROM



BIG COTTONWOOD
CANYON

17 MINUTES FROM



LITTLE COTTONWOOD
CANYON

9 MINUTES FROM

FASHION
PLACE

12 MINUTES FROM
FORT UNION AREA
SHOPPING, DINING,
ENTERTAINMENT

15 MINUTES FROM



DOWNTOWN
SALT LAKE CITY

8 MINUTES FROM



MURRAY PARKWAY
GOLF COURSE

CENTER 53

433 WEST ASCENSION WAY
MURRAY, UT

MARKETED BY

DANA BAIRD, CCIM

Executive Managing Director

801 303 5526

dana.baird@cushwake.com

MIKE RICHMOND

Executive Managing Director

801 303 5434

mike.richmond@cushwake.com

HANNAH KING

Associate

801 303 5440

hannah.king1@cushwake.com