

6550 LONG POINT SUITE A-A3

HOUSTON, TX 77055



56,010 SF | FOR LEASE

The property 6550 Long Point is a well located warehouse facility in Houston's Northwest submarket. This building is a dock high, front load facility in close proximity to the 610 Loop, Highway 290, Interstate-10 and Hempstead Highway.

PROPERTY SPECIFICATIONS

Available Space:	56,010 SF
Total Building Size:	97,700 SF
Submarket:	Northwest Houston
Office Space:	7,605
Ceiling Height:	20
Dock High Doors:	12
Ramps	3
Sprinkler:	NonESFR

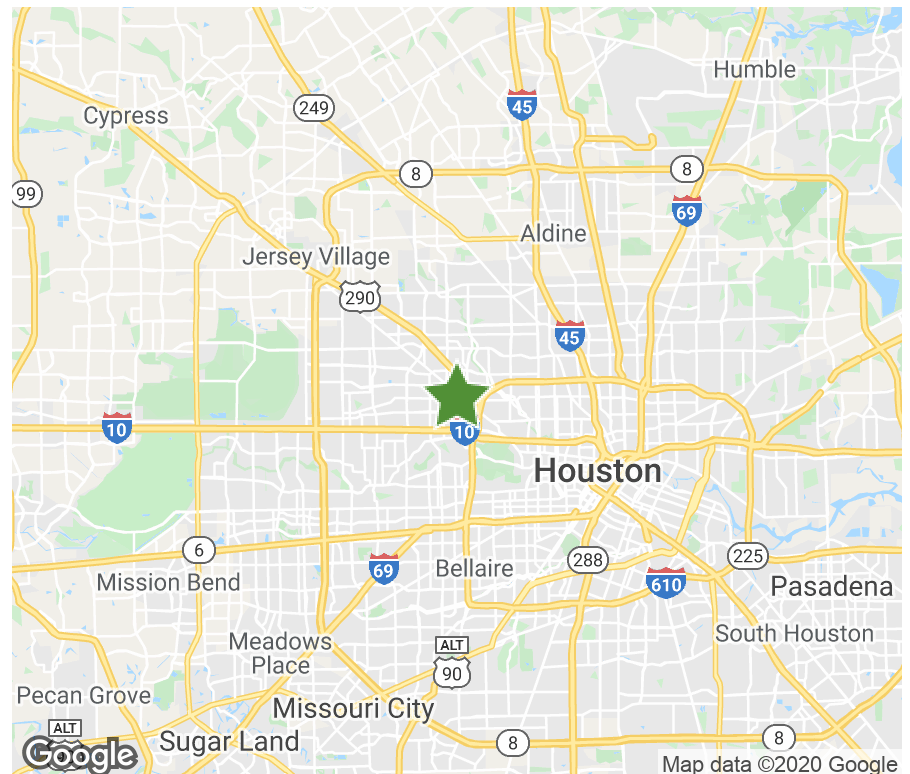

6550 LONG POINT SUITE A-A3

56,010 SF | FOR LEASE

FLOOR PLAN

Suite A2-A3
27,150 SF

Suite A
28,860 SF

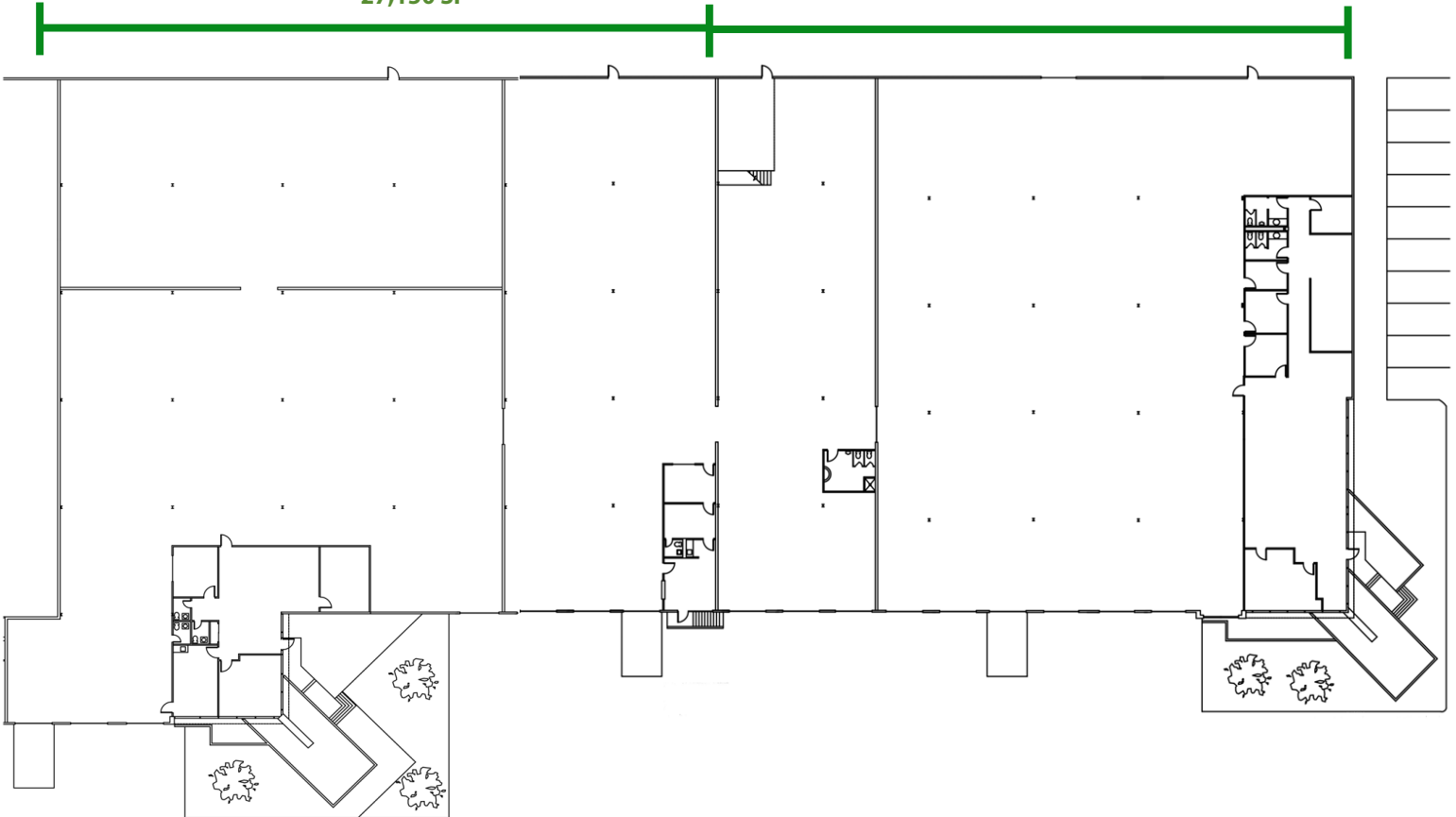

BROKER CONTACT

David Munson, SIOR

Cushman & Wakefield
713.599.3438

david.munson@cushwake.com

BROKER CONTACT

Garrett Thomas

Cushman & Wakefield
713.260.0244

garrett.thomas@cushwake.com

OWNER CONTACT

Jake Allen

Regional Manager
312.344.4331

jallen@FIRT.com



**CUSHMAN &
WAKEFIELD**



**FIRST
INDUSTRIAL
REALTY TRUST**

1225 North Loop West, Suite 700

Houston, TX 77008

713.681.0885

All information furnished regarding the property for sale, rental or financing is obtained from sources deemed reliable. No representation is made to the accuracy thereof and is submitted subject to errors, omissions, change of price rental or other conditions, prior sale, lease, or financing, or withdrawal without notice. First Industrial Realty Trust, Inc. represents the Seller in this transaction and as such owes all duties and obligations thereto.