

## 2,492 RSF Class A Office On The 10th Floor

### Property Highlights

- Available ASAP
- Primarily Open Sublease
- Term Negotiable, Master Lease through 3/31/27
- Rental Rate Negotiable
- 23 workstations, 2 private offices, 10 person conference room, kitchen, reception area
- Furniture available
- \$1.25 per RSF per year of sublease term to Subtenant's broker

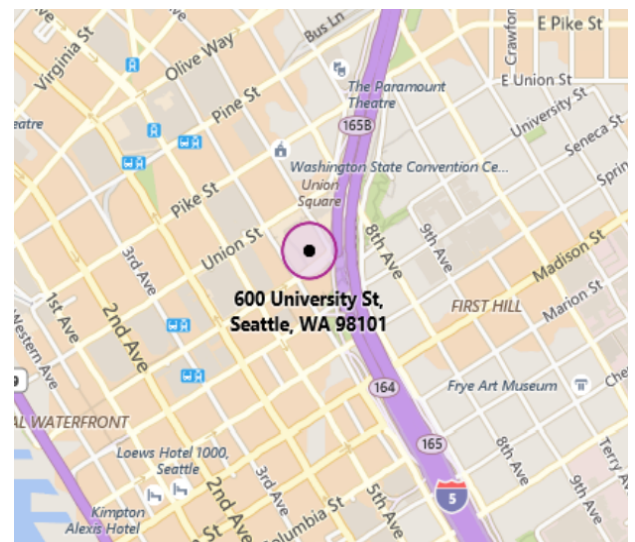

**Hughes McLaughlin**  
+1 206 521 2232  
hughes.mclaughlin@cushwake.com

**Will Carroll**  
+1 206 521 0244  
will.carroll@cushwake.com

1420 Fifth Avenue, Suite 2600  
Seattle, Washington 98101  
Main +1 206 682 0666  
Fax +1 206 521 0298  
**cushmanwakefield.com**



**Floor Plan**

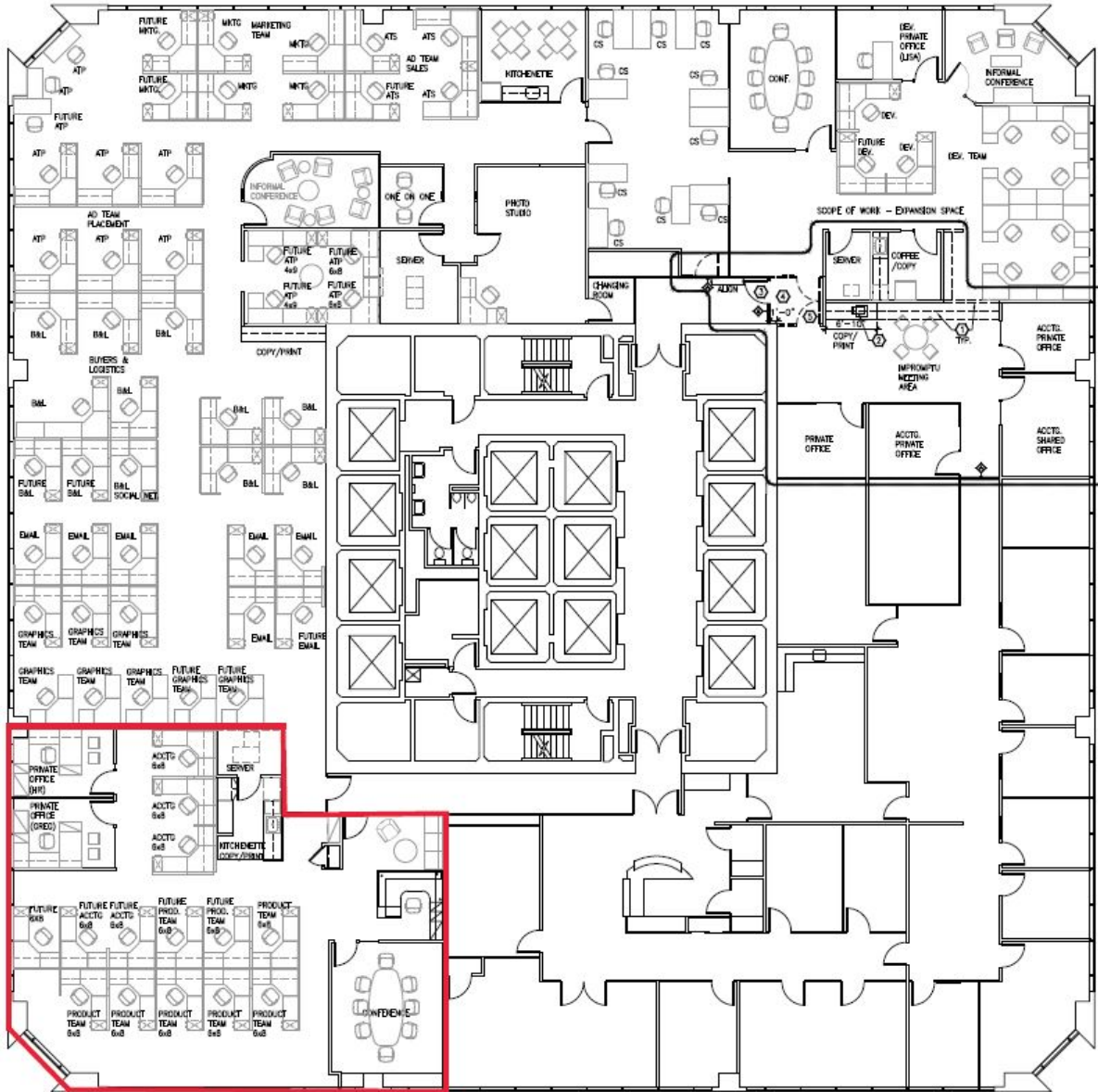

**Hughes McLaughlin**  
+1 206 521 2232  
hughes.mclaughlin@cushwake.com

**Will Carroll**  
+1 206 521 0244  
will.carroll@cushwake.com

1420 Fifth Avenue, Suite 2600  
Seattle, Washington 98101  
Main +1 206 682 0666  
Fax +1 206 521 0298  
**cushmanwakefield.com**