



**12.15 DEVELOPABLE ACRES FOR SALE** | ~~\$3,705,000 (\$7.00/SF)~~  
\$2,950,000 (\$5.58/SF)

**NWC W. 10TH ST. & 71ST AVE.**  
**GREELEY, CO 80634**



# NWC W. 10TH ST. & 71ST AVE.

## GREELEY, CO 80634

12.15 DEVELOPABLE ACRES WITH UP TO  
52 ACRE FEET OF RAW WATER AVAILABLE

**SALE PRICE:** ~~\$3,705,000 (\$7.00/SF)~~  
\$2,950,000 (\$5.58/SF)

### Property Overview

Located at the Northwest Corner of 10th Street and 71st Avenue, this 12.15-acre property offers exceptional potential. With up to 52 acre-feet of raw water available for inclusion in the sale, this site is well-positioned for various development possibilities. The property is also conveniently close to key amenities, including schools, recreational facilities, healthcare, employment hubs, and services. Within just 1/2 mile of the King Soopers grocery-anchored retail center, this location provides unmatched convenience. It presents ideal conditions for various uses such as restaurants, gas stations, retail businesses, hospitality venues, medical facilities, daycare centers, self-storage, and more. This opportunity combines prime positioning with a growing and vibrant community.

- **Zoning:** Multi-Family, Commercial, or Both
- Raw Water Available for Sale at a **25% discount** from Greeley's current cash-in-lieu-fee

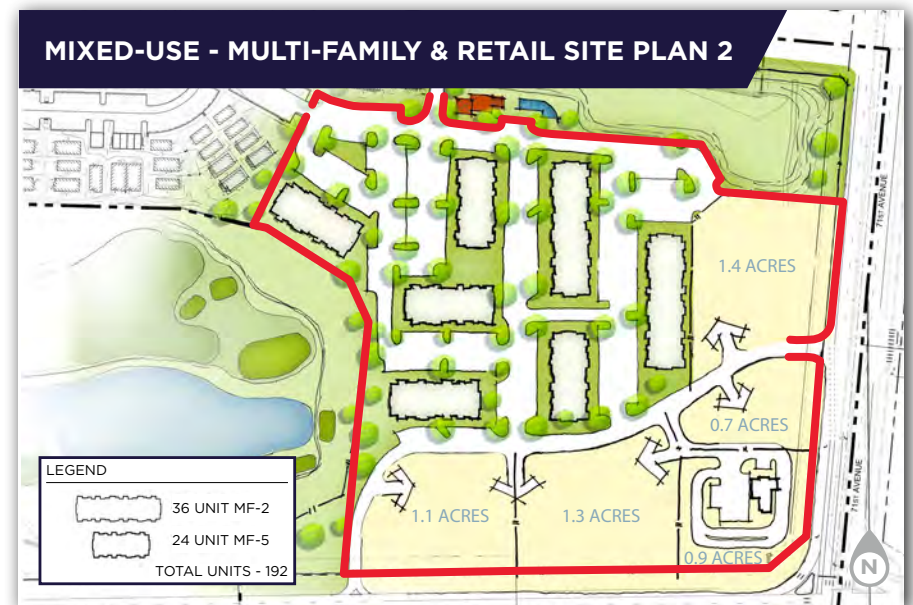

# NWC W. 10TH ST. & 71ST AVE.

## GREELEY, CO 80634

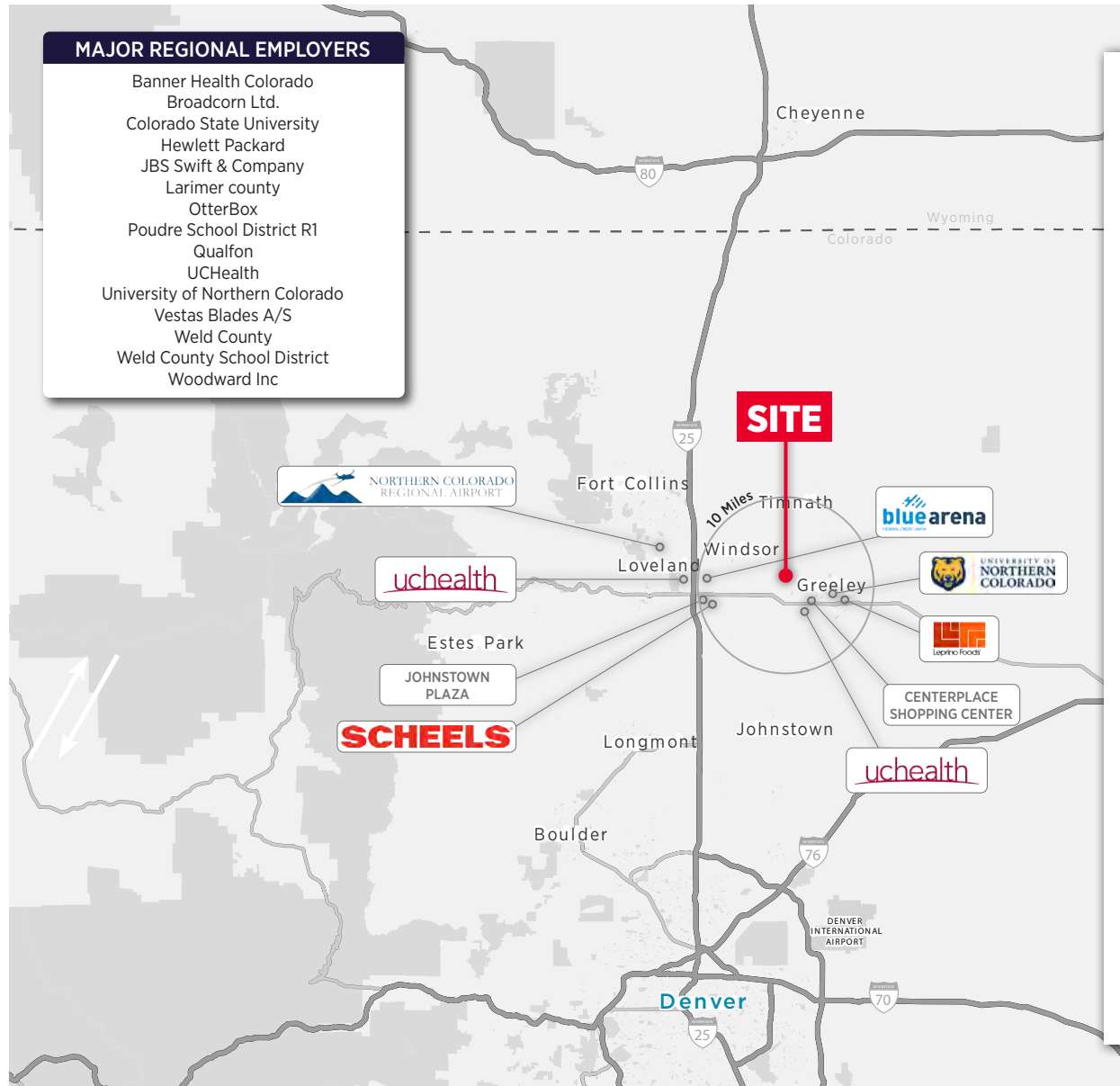

## About Greeley, CO

Located about 60 miles north of Denver in Weld County, Greeley is a college town that's home to both the University of Northern Colorado (UNC) and Aims Community College. The city's thriving economy, which is rooted in agriculture and food processing, has been named a "boomtown" and one of the best places to raise a family in Colorado. Greeley is also ranked 5th in job and economic growth and is the 6th fastest growing community in the U.S. *Source: greeleygov.com*

### TOTAL POPULATION (2025)

106,043 (5 MILES)

### TOTAL HOUSEHOLDS (2025)

38,719 (5 MILES)

### MEDIAN HOUSEHOLD INCOME (2025)

\$80,886 (5 MILES)

### MEDIAN AGE (2025)

35.3 (5 MILES)

### TOTAL EMPLOYEES (2025)

51,658 (5 MILES)

**FOR MORE INFORMATION, CONTACT:**

**AKI PALMER**

Executive Managing Director  
+1 720 299 8733  
aki.palmer@cushwake.com

**COLE VANMEVEREN**

Senior Director  
+1 970 219 3802  
cole.vanmeveren@cushwake.com

772 Whaler Way, Suite 200 / Fort Collins, CO 80525 / +1 970 776 3900 / [cushmanwakefield.com](http://cushmanwakefield.com)

©2026 Cushman & Wakefield. All rights reserved. The information contained in this communication is strictly confidential. This information has been obtained from sources believed to be reliable but has not been verified. NO WARRANTY OR REPRESENTATION, EXPRESS OR IMPLIED, IS MADE AS TO THE CONDITION OF THE PROPERTY (OR PROPERTIES) REFERENCED HEREIN OR AS TO THE ACCURACY OR COMPLETENESS OF THE INFORMATION CONTAINED HEREIN, AND SAME IS SUBMITTED SUBJECT TO ERRORS, OMISSIONS, CHANGE OF PRICE, RENTAL OR OTHER CONDITIONS, WITHDRAWAL WITHOUT NOTICE, AND TO ANY SPECIAL LISTING CONDITIONS IMPOSED BY THE PROPERTY OWNER(S). ANY PROJECTIONS, OPINIONS OR ESTIMATES ARE SUBJECT TO UNCERTAINTY AND DO NOT SIGNIFY CURRENT OR FUTURE PROPERTY PERFORMANCE. PD-89095-V20

