

# 1350 HOLIDAY LANE

Fairfield, CA 94534

±1.94 ACRES AVAILABLE / FOR GROUND LEASE



**Blair J. Wheatley**  
Senior Director  
+1 916 329 1547  
blair.wheatley@cushwake.com  
LIC #01499974

**Mike Clark**  
Senior Director  
+1 858 625 5225  
mike.clark@cushwake.com  
LIC #01192474



©2025 Cushman & Wakefield. All rights reserved. The information contained in this communication is strictly confidential. This information has been obtained from sources believed to be reliable but has not been verified. NO WARRANTY OR REPRESENTATION, EXPRESS OR IMPLIED, IS MADE AS TO THE CONDITION OF THE PROPERTY (OR PROPERTIES) REFERENCED HEREIN OR AS TO THE ACCURACY OR COMPLETENESS OF THE INFORMATION CONTAINED HEREIN, AND SAME IS SUBMITTED SUBJECT TO ERRORS, OMISSIONS, CHANGE OF PRICE, RENTAL OR OTHER CONDITIONS, WITHDRAWAL WITHOUT NOTICE, AND TO ANY SPECIAL LISTING CONDITIONS IMPOSED BY THE PROPERTY OWNER(S). ANY PROJECTIONS, OPINIONS OR ESTIMATES ARE SUBJECT TO UNCERTAINTY AND DO NOT SIGNIFY CURRENT OR FUTURE PROPERTY PERFORMANCE.

[CUSHMANWAKEFIELD.COM](https://www.cushmanwakefield.com)

# 1350 HOLIDAY LANE

Fairfield, CA 94534

## OVERVIEW

FOR GROUND LEASE

### PREMISES

SEC of Holiday Lane and Oliver Road

**±1.94 ACRES AVAILABLE FOR GROUND LEASE**

### ZONING

Commercial

### LEASE TYPE

NNN

### ASKING RENT

Upon Request

### NEIGHBORS

Raley's, Courtyard by Marriott, Denny's, Staples, Dunn-Edwards, Leslie's, Starbucks and many more!

### PROPERTY HIGHLIGHTS

- Adjacent to a Raley's anchored shopping center
- Located right next to a Courtyard by Marriot hotel
- Surrounded by a great mix of regional and neighborhood tenants
- Great ingress/egress
- Ample parking
- Conveniently located within minutes from major highways and commercial arterials
- Freeway visibility
- Freeway pylon signage available



# 1350 HOLIDAY LANE

Fairfield, CA 94534

CONCEPTUAL SITE PLAN

FOR GROUND LEASE

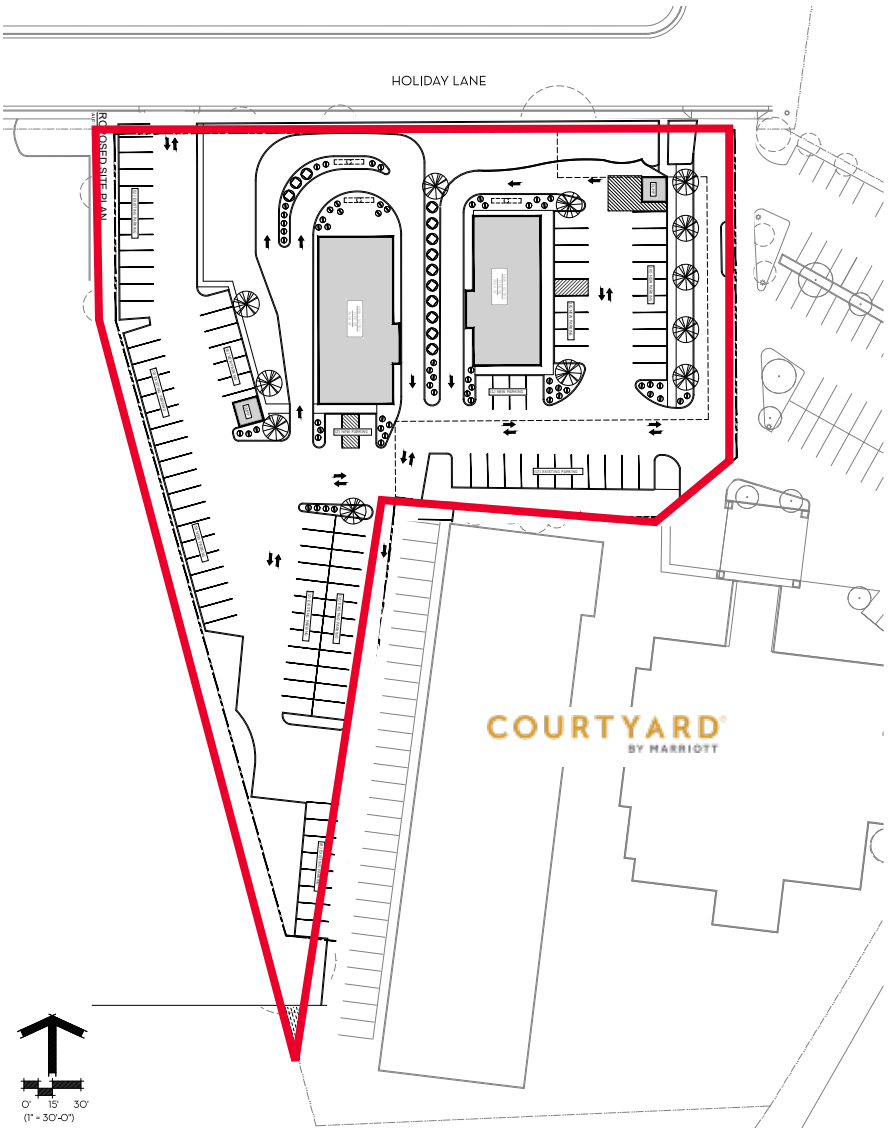

# 1350 HOLIDAY LANE

Fairfield, CA 94534

TRADE AREA MAP

FOR GROUND LEASE



# 1350 HOLIDAY LANE

Fairfield, CA 94534

## DEMOGRAPHICS

FOR GROUND LEASE



### TOTAL POPULATION

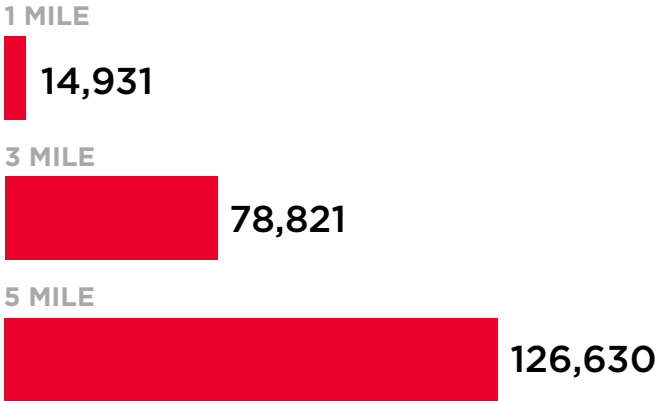

### DAYTIME POPULATION

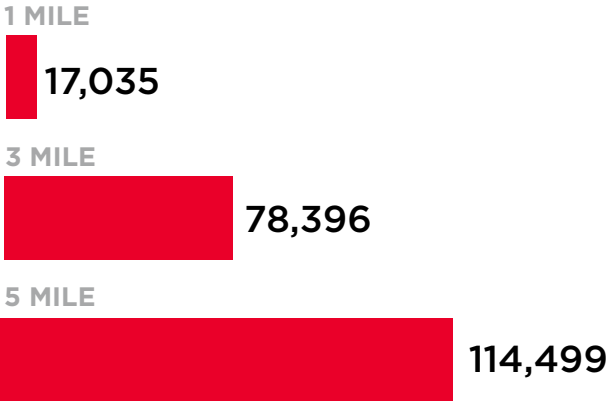

### MEDIAN AGE

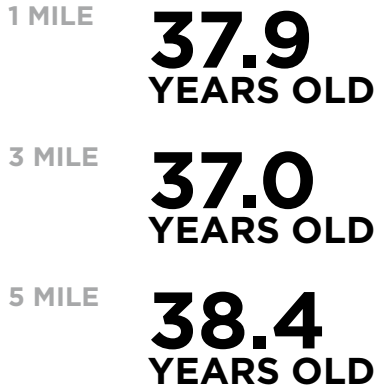

### MED. HOUSEHOLD INCOME

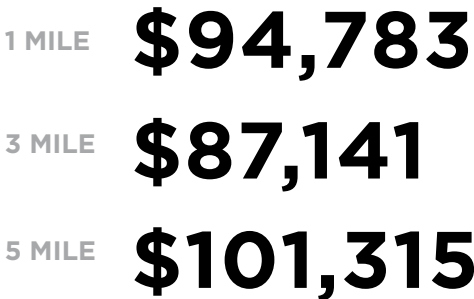

### TRAFFIC COUNTS

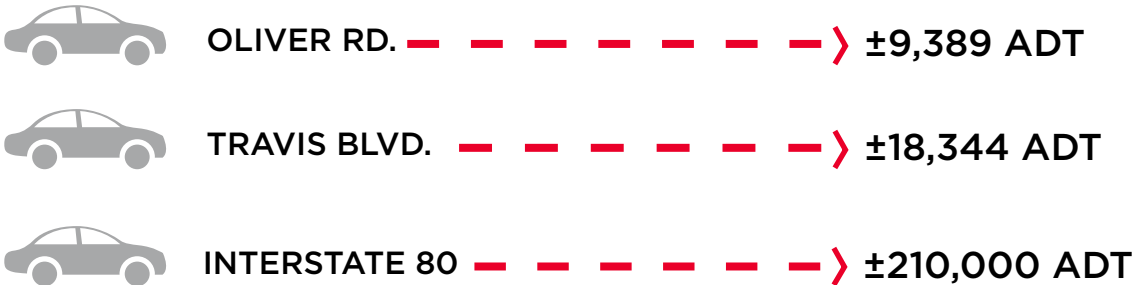

# 1350 HOLIDAY LANE

Fairfield, CA 94534

±1.94 ACRES AVAILABLE / FOR GROUND LEASE

**Blair J. Wheatley**  
**Senior Director**

+1 916 329 1547  
blair.wheatley@cushwake.com  
LIC #01499974

**Mike Clark**  
**Senior Director**

+1 858 625 5225  
mike.clark@cushwake.com  
LIC #01192474

**CUSHMANWAKEFIELD.COM**



©2025 Cushman & Wakefield. All rights reserved. The information contained in this communication is strictly confidential. This information has been obtained from sources believed to be reliable but has not been verified. NO WARRANTY OR REPRESENTATION, EXPRESS OR IMPLIED, IS MADE AS TO THE CONDITION OF THE PROPERTY (OR PROPERTIES) REFERENCED HEREIN OR AS TO THE ACCURACY OR COMPLETENESS OF THE INFORMATION CONTAINED HEREIN, AND SAME IS SUBMITTED SUBJECT TO ERRORS, OMISSIONS, CHANGE OF PRICE, RENTAL OR OTHER CONDITIONS, WITHDRAWAL WITHOUT NOTICE, AND TO ANY SPECIAL LISTING CONDITIONS IMPOSED BY THE PROPERTY OWNER(S). ANY PROJECTIONS, OPINIONS OR ESTIMATES ARE SUBJECT TO UNCERTAINTY AND DO NOT SIGNIFY CURRENT OR FUTURE PROPERTY PERFORMANCE.